



WARNING

Do not install on same side of chair that has a 9A22700x Seat Rail. Remove any Seat Rails before installing the Base Rail. Failure to comply may result in personal injury or equipment damage.

Components:

Base Rail Assembly 1

Special Tools:

Punch (1/8" or smaller) Needle
Nose Pliers 3/8" Wrench
5/32" Hex Allen Wrench

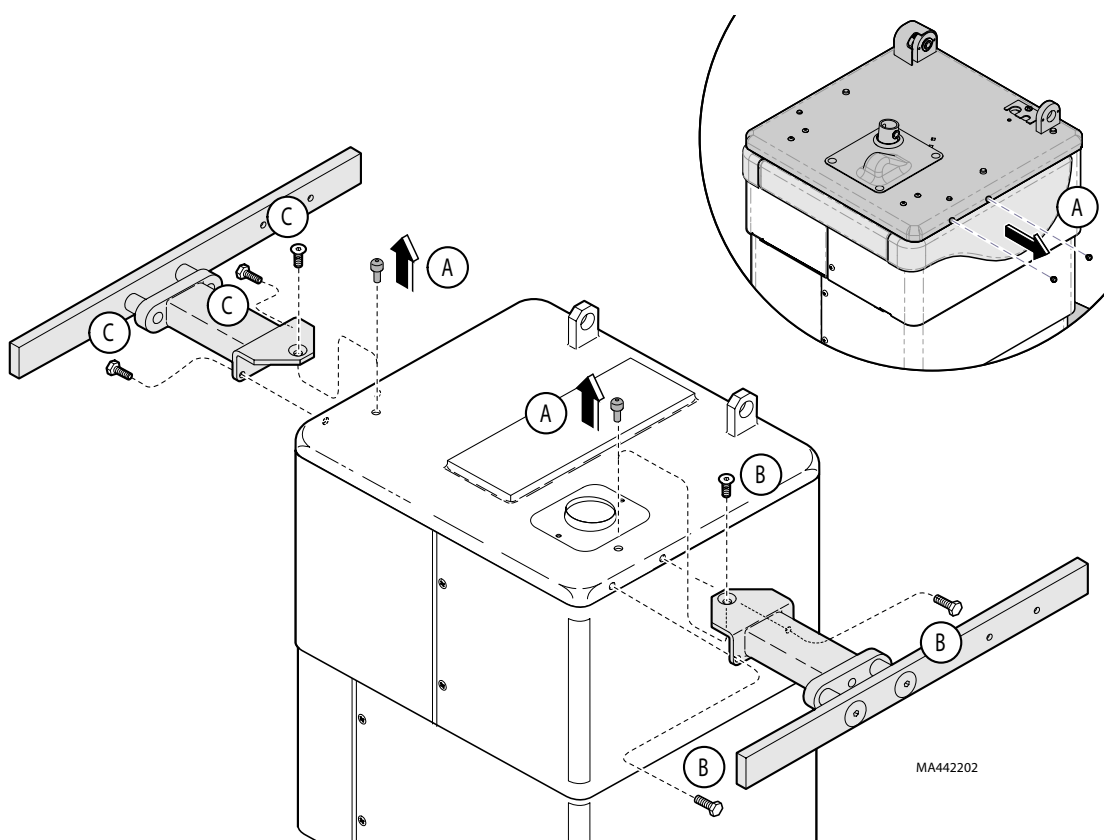

MA442202

Note

For ease of installation, move CHAIR, BACK, TILT and FOOT functions fully UP.

A. Using punch and pliers, remove black nylon rivets from mounting holes.

B. Place left-hand base rail in position and install mounting screws.

C. Install right-hand rail in similar manner.



Equipment Alert

The length of Base Rail that extends farther from base rail weldment must be pointed toward rear of chair when mounting.