

# Monitor Back Cover Replacement [Kit # 002-10087-00]

**Applies to Models:**

153963 (-000 thru -008)

153964 (-010 thru -018)

## Note

Use to install the Monitor Back Cover for a 24" monitor that is replacing a smaller size monitor.

### Step 1: Remove monitor cover.

- Disconnect facility power to the track.
- Remove screws attaching monitor cover to mounting arm.
- Remove existing monitor cover.
- Remove existing cover bracket.
- Disconnect all Audio and Video (A/V) connections.

Note: Metric screws and washers are required to attach the monitor to the mounting arm.  
Standard monitor screws match the outside holes.

### Step 2: Remove monitor from mounting arm.

- Remove and retain screws connecting monitor to mounting arm.
- Remove monitor and place in safe area.

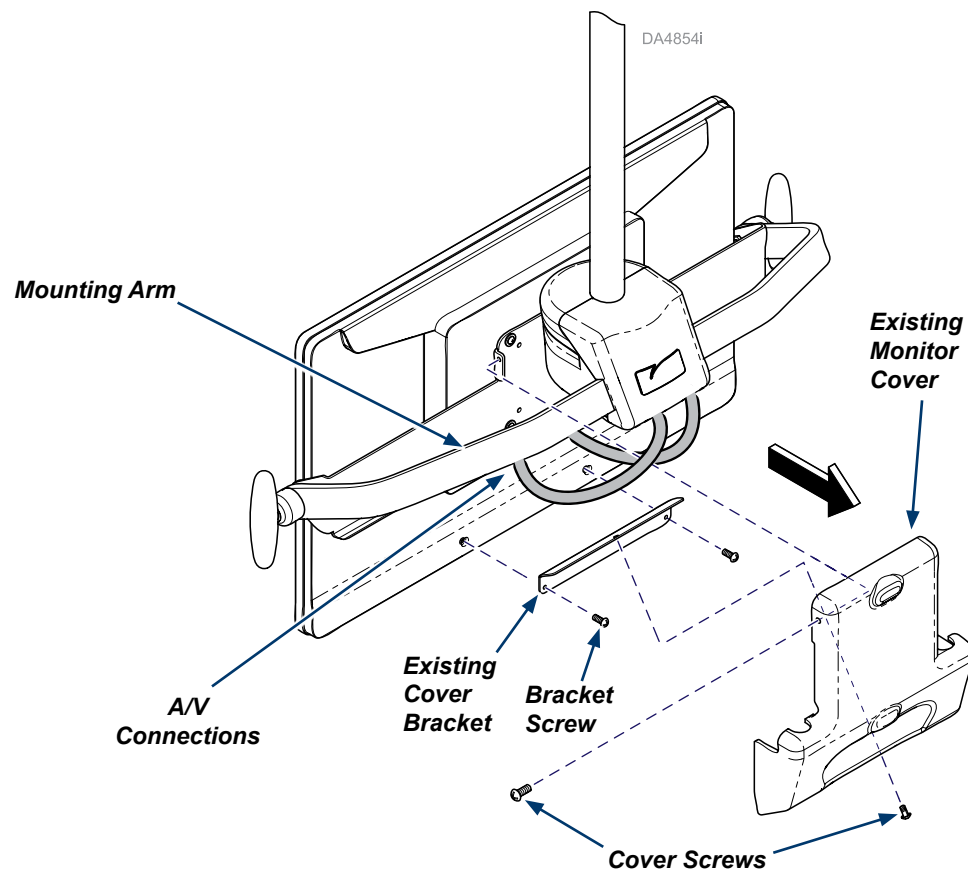

Metric Screw/Washers are included

(002-10087-01 kit can be ordered)

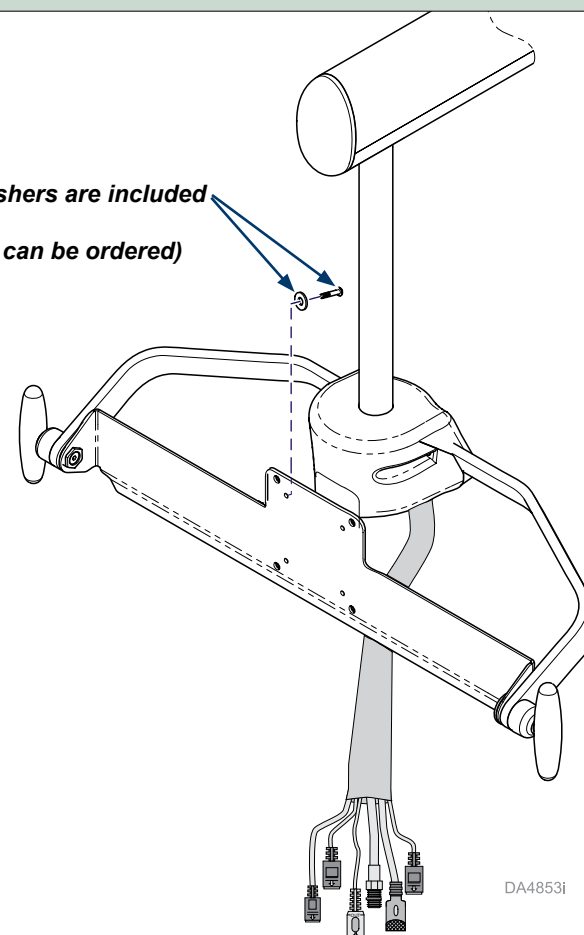

**Step 3: Reuse the bracket screws to attach the new bracket to monitor back.**



**Equipment Alert**

Verify the cover fits.

**Step 4: Connect cables into the back of the monitor.**

*Note: For a clean appearance, attach all connectors to the monitor even though some may not be attached to a source.*



**Equipment Alert**

This document addresses the Midmark monitor. For non-Midmark monitors, refer to that product's manual to ensure equipment functions safely including proper input voltage and is in proper working condition before use.



**Caution**

Do not pinch wiring.

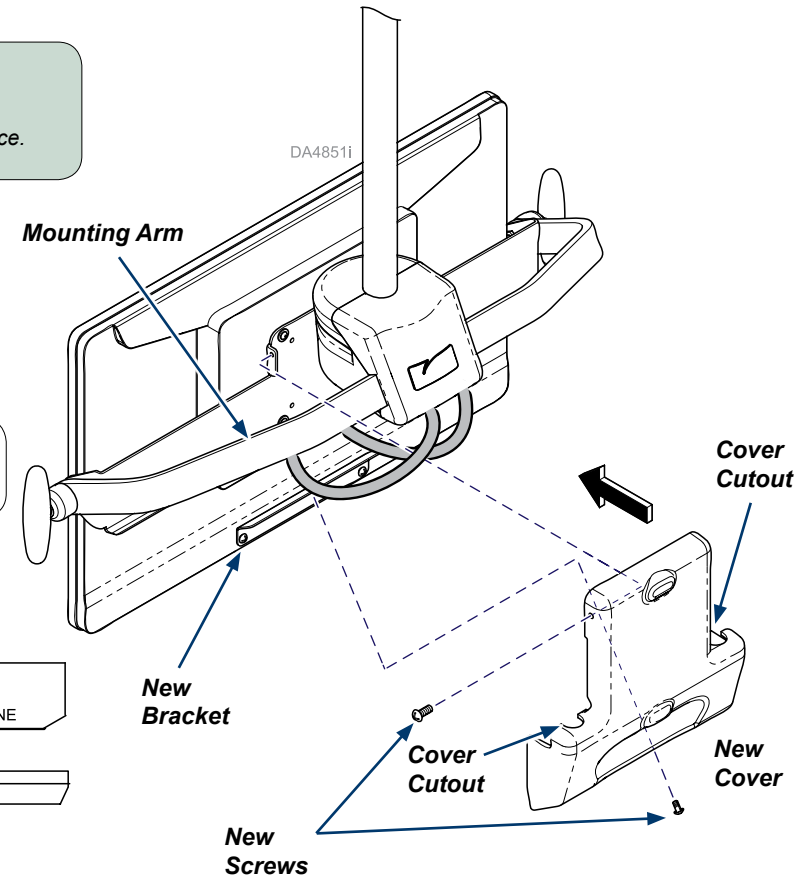
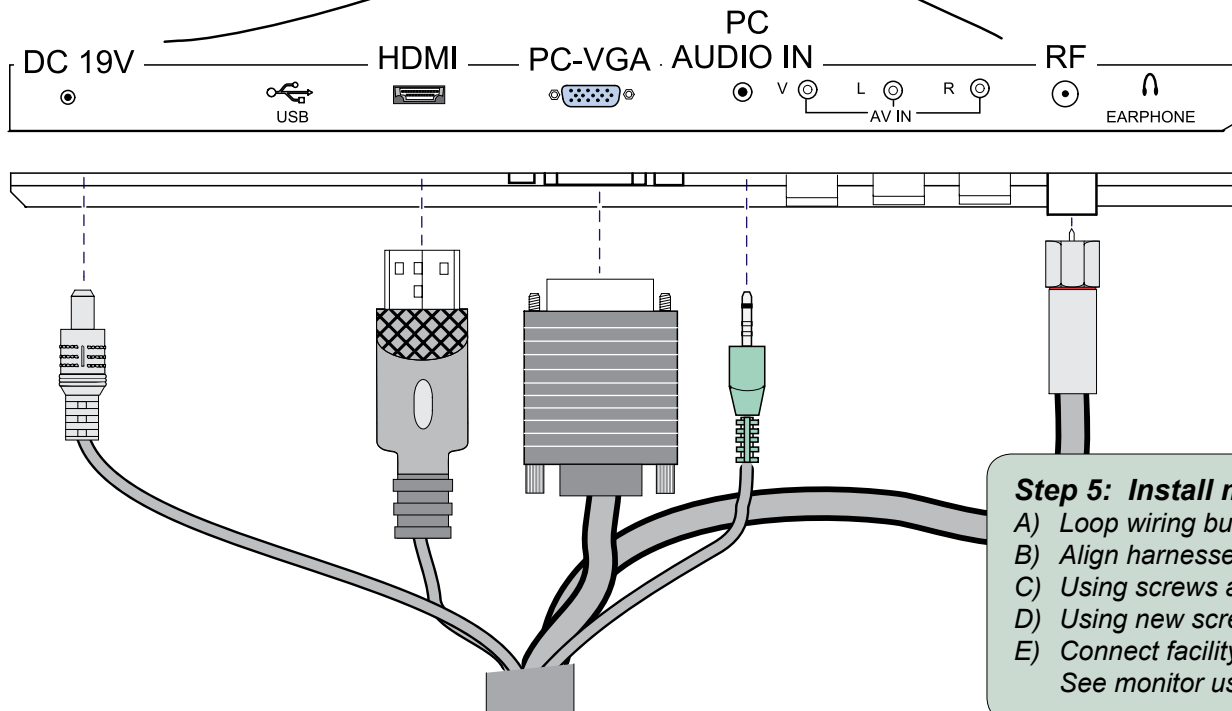

**Step 5: Install monitor and new monitor cover.**

- Loop wiring bundles below connections as shown.
- Align harnesses in cover cutouts.
- Using screws and washers, install monitor to mounting arm.
- Using new screws from kit, install new cover to monitoring arm and bracket.
- Connect facility power to track then verify operation.  
See monitor user guide for operation information.