

# Brake Assembly Linkage Kit [002-2071-01]

**Component:**  
Linkage ..... 1

**Special Tools:**  
Torque wrench

Language of origin: English

**Note**

Torque wrench should be capable of 33 ft-lbs (44.7 Nm).

**Step 1: Inspect components.**

**Step 2: Position chair.**

- A) Move the chair back to FULL DOWN position.
- B) Raise / lower the chair to a comfortable working height.

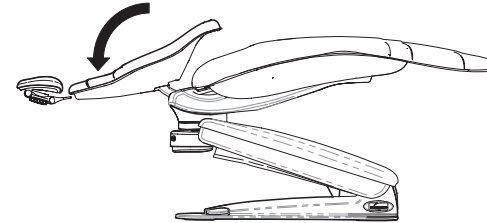

**WARNING**

Always disconnect the power source before removing any covers. Failure to do so may result in personal injury.

**Step 3: Remove seat upholstery.**

- A) Disconnect power source.
- B) Rotate seat locking knob.
- C) Lift seat upholstery, then pull to release tabs from frame.

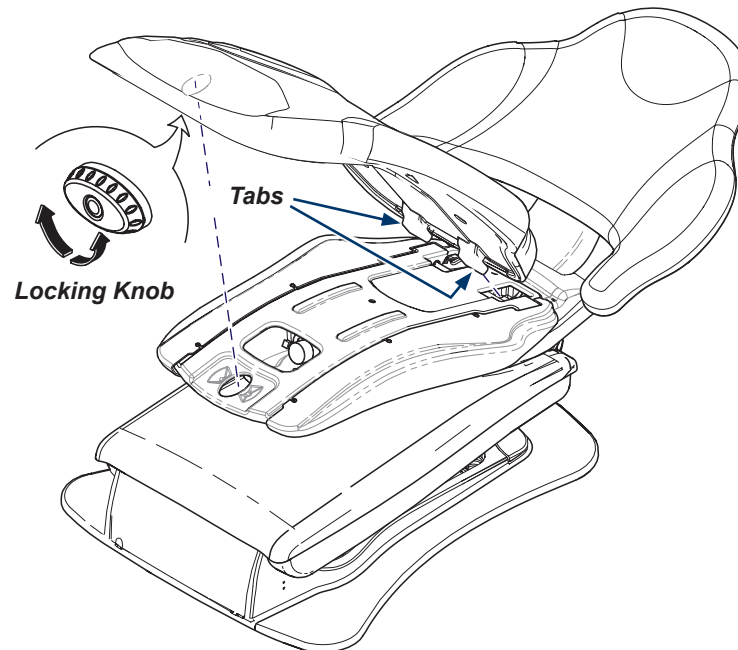

DA4596i

Note: Retain all shrouds, frame and mounting hardware for re-use. Some mounting hardware may not be shown depending on model.

**Step 4: Remove shrouds and frame.**

- A) Remove three screws and washers from each seat shroud.
- B) Remove seat shrouds from right and left sides.
- C) Remove two shoulder screws then seat frame.

Note: Shoulder Screws need torqued down 33 ft-lb when reinstalling seat frame.

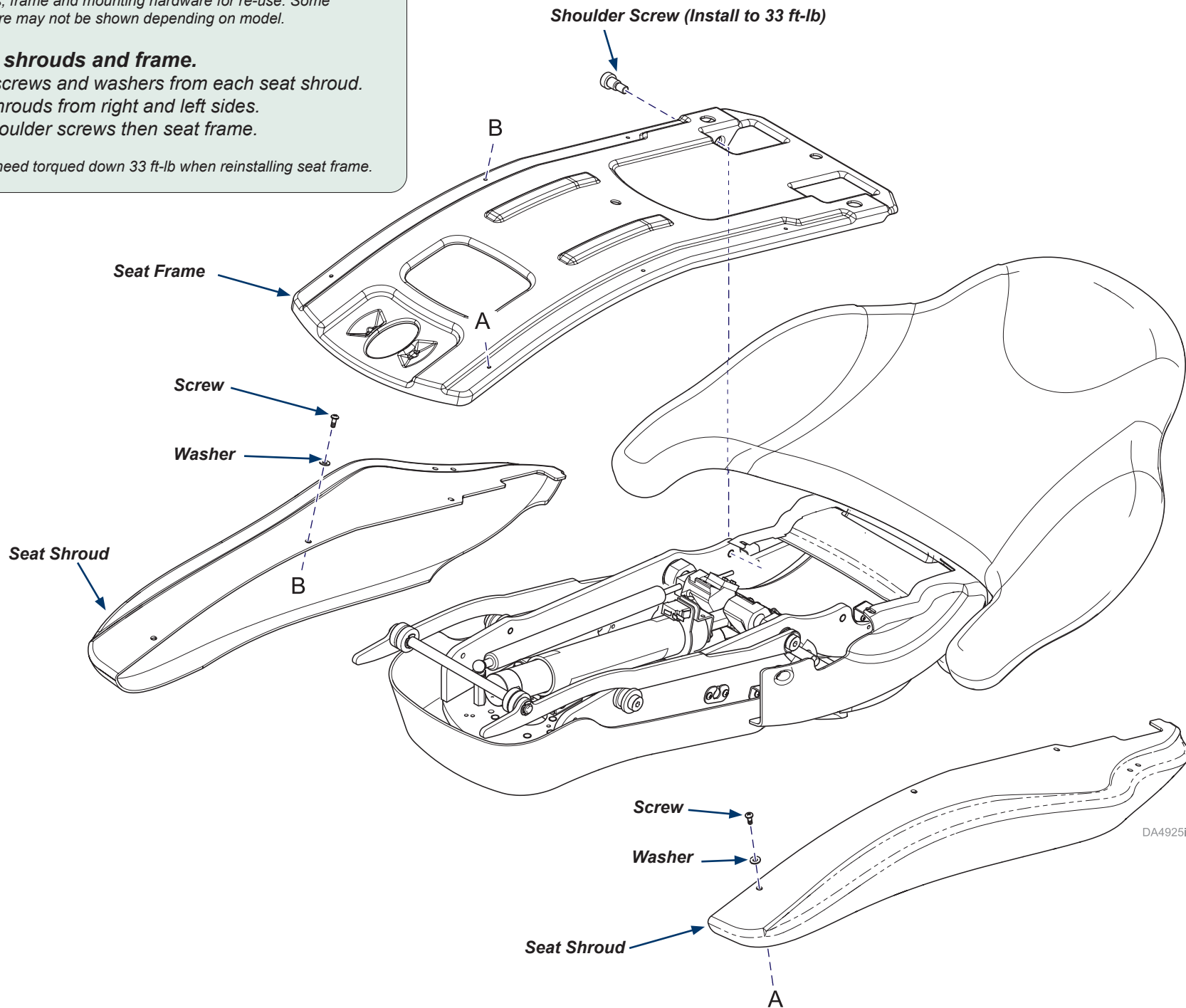

DA4925i

**Step 5: Position chair.**

- A) Connect chair to power source.
- B) Move chair back to FULL UP position.
- C) Disconnect power source.

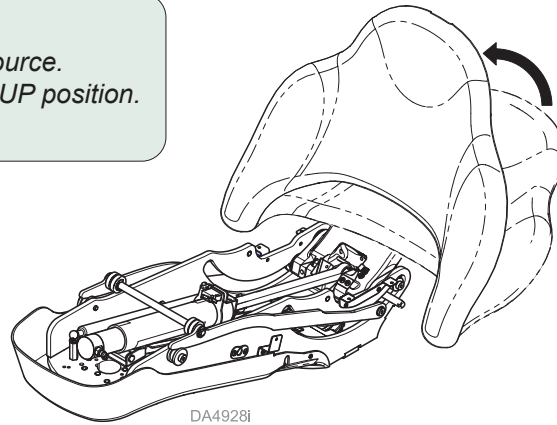

**Caution**

Do not damage or disconnect solenoid assembly wires from solenoid assembly. Ensure wires are secure.

**Step 6: Remove linkage.**

- A) Loosen one screw closest to linkage from solenoid mount.
- B) Remove screw and lockwasher furthest from linkage.
- C) Unhook linkage from solenoid assembly.
- D) Unhook linkage from cylinder assembly.
- E) Remove linkage.

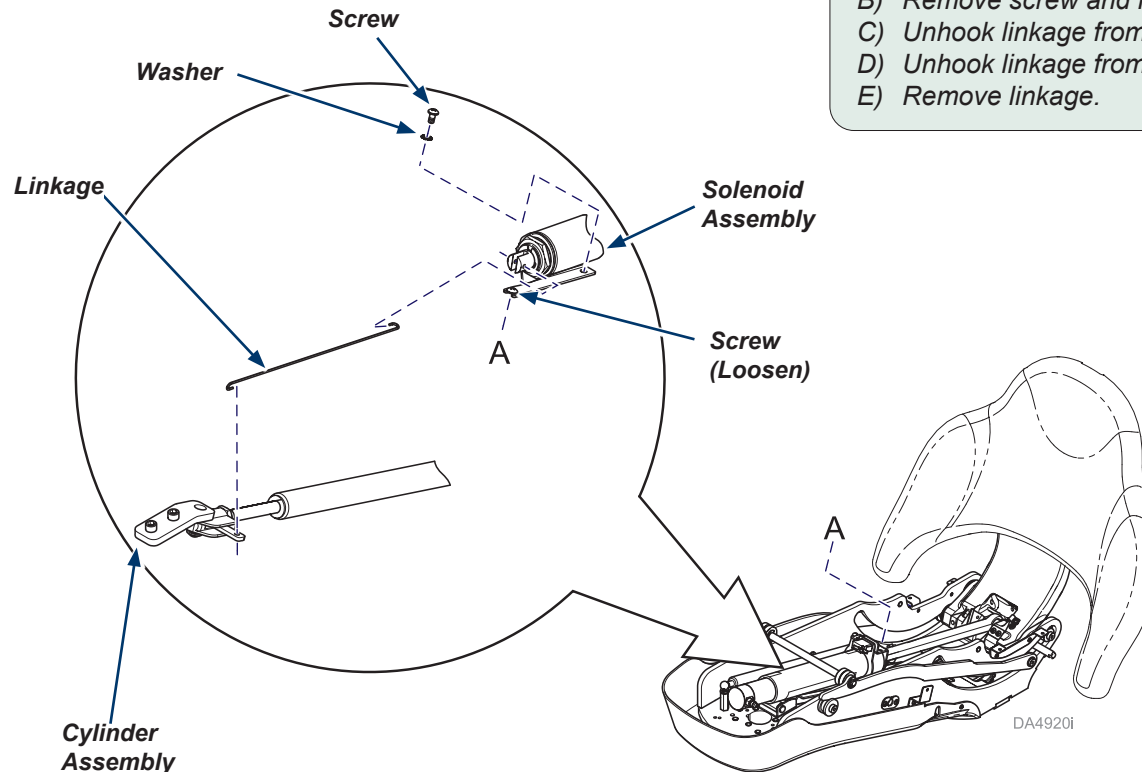

**Step 7: Install new linkage.**

- A) Hook new linkage to cylinder assembly.
- B) Hook new linkage to solenoid assembly end.
- C) Install screw and lockwasher solenoid assembly mount.
- D) Tighten screw to solenoid assembly mount.



**Caution**

Verify frame top cover and frame covers do not contact the carriage casting.

**Step 8: Finalize installation.**

- A) Install any remaining covers/components (reverse Steps 2 through 4).
- B) Connect chair to power source.
- C) Ensure power is restored for hydraulic functions.
- D) Verify operation.



Because we care.