

Brake Assembly Solenoid Kit [002-2071-02]

Note

Torque wrench should be capable of 33 ft-lbs (44.7 Nm).

Components:

Solenoid Assembly	1
Mount.....	1
Screws.....	2
Roll Pin	1
Shims.....	2

Special Tool:

Torque wrench

Language of origin: English

Step 1: Inspect components.

Step 2: Position chair.

- Move the chair back to FULL DOWN position.
- Raise / lower the chair to a comfortable working height.



WARNING

Always disconnect the power source before removing any covers. Failure to do so may result in personal injury.

Step 3: Remove seat upholstery.

- Disconnect power source.
- Rotate seat locking knob.
- Lift seat upholstery, then pull to release tabs from frame.

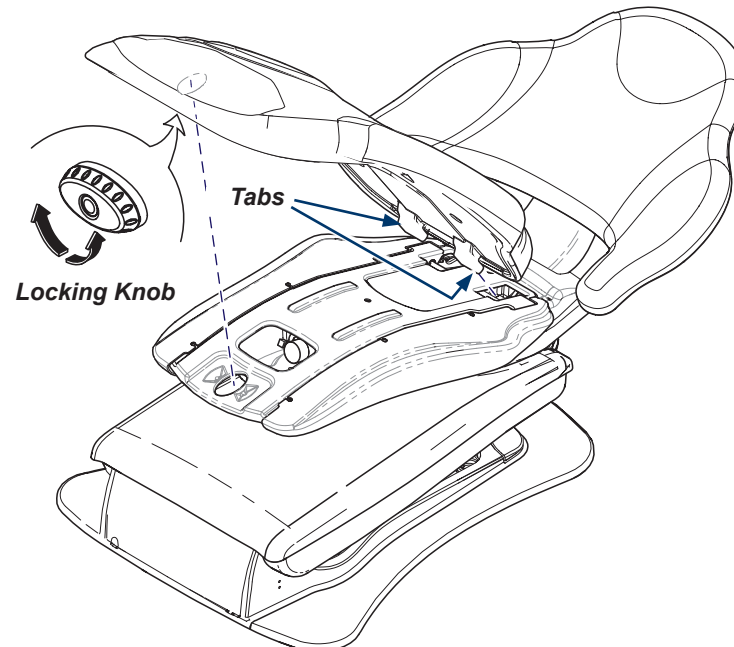
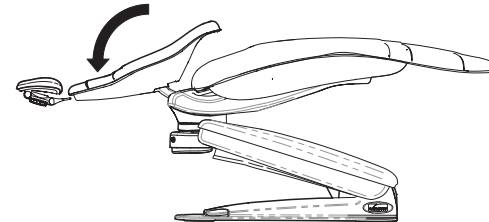

DA4596i

Note: Retain all shrouds, frame and mounting hardware for re-use. Some mounting components may not be shown depending on model.

Step 4: Remove shrouds and frame.

- A) Remove three screws and washers from each seat shroud.
- B) Remove seat shrouds from right and left sides.
- C) Remove two shoulder screws then seat frame.

Note: Shoulder Screws need torqued down 33 ft-lb when reinstalling seat frame.

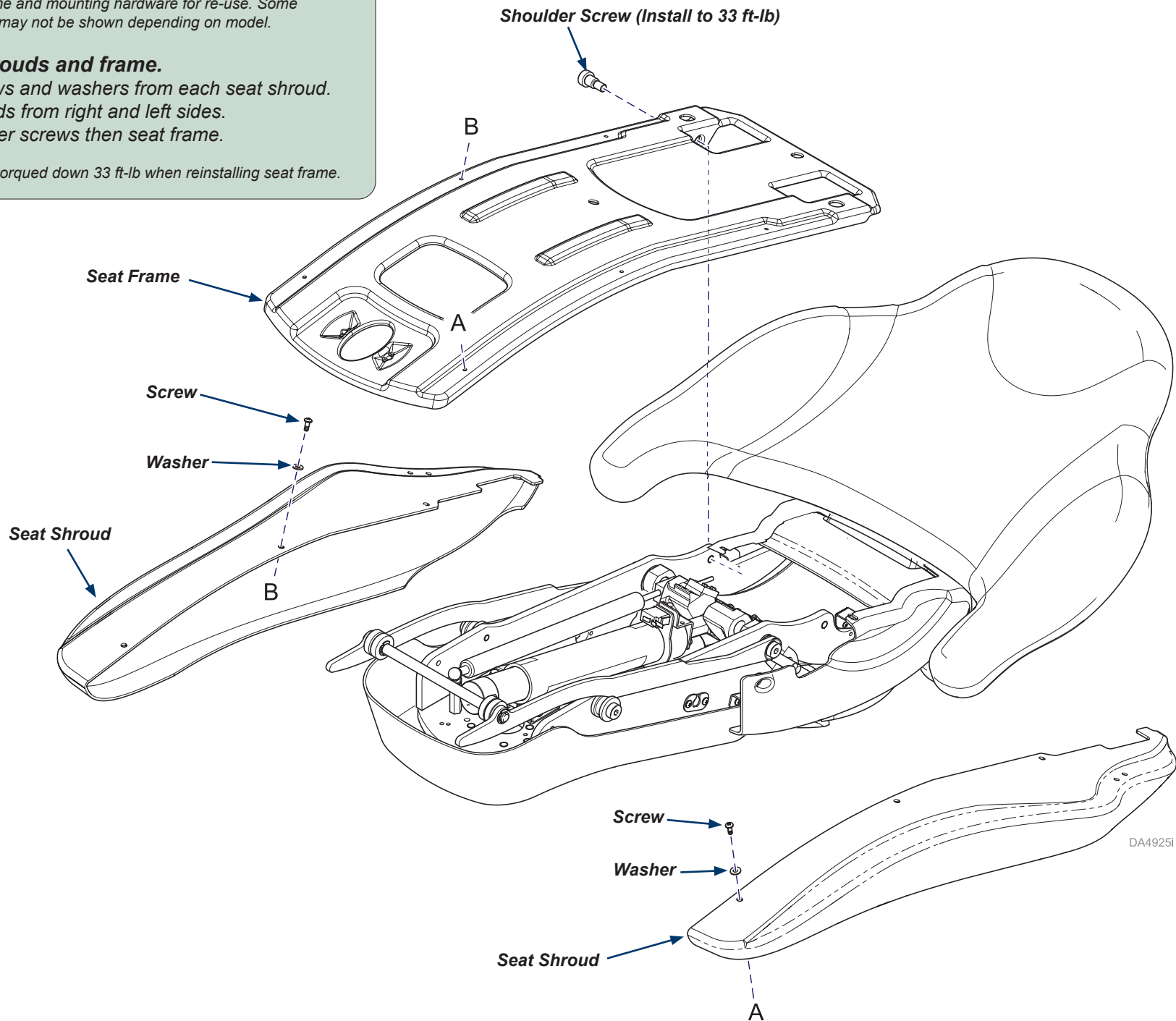

Step 5: Position chair.

- A) Connect chair to power source.
- B) Move chair back to FULL UP position.
- C) Disconnect power source.

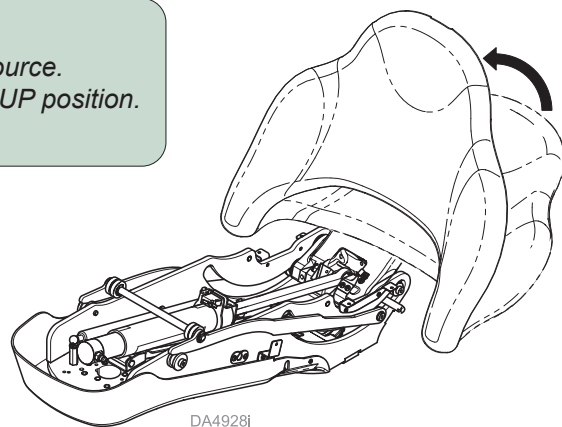

Caution

Do not damage or disconnect solenoid assembly wires from solenoid assembly. Ensure wires are secure.

Step 6: Remove linkage.

- A) Loosen one screw closest to linkage from solenoid mount.
- B) Remove screw and lockwasher furthest from linkage.
- C) Disconnect linkage from solenoid assembly.
- D) Disconnect linkage from cylinder assembly.
- E) Remove linkage then retain for re-use.

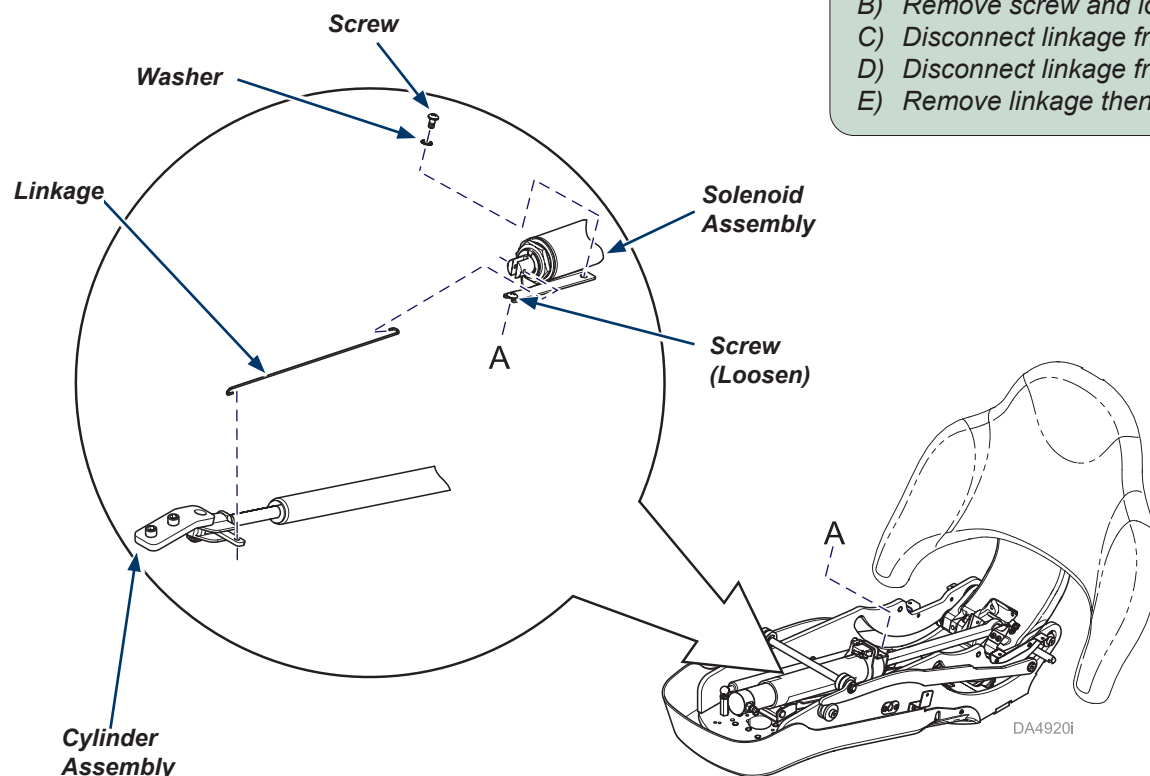

**Caution**

Do not damage or disconnect solenoid assembly wires.
Ensure e-ring and plastic washer are secure on plunger end.
Ensure all wires are secure.

Step 7: Remove solenoid assembly.

- A) Disconnect wiring from solenoid assembly.
- B) Remove one previously loosened screw from solenoid mount.
- C) Remove solenoid assembly.

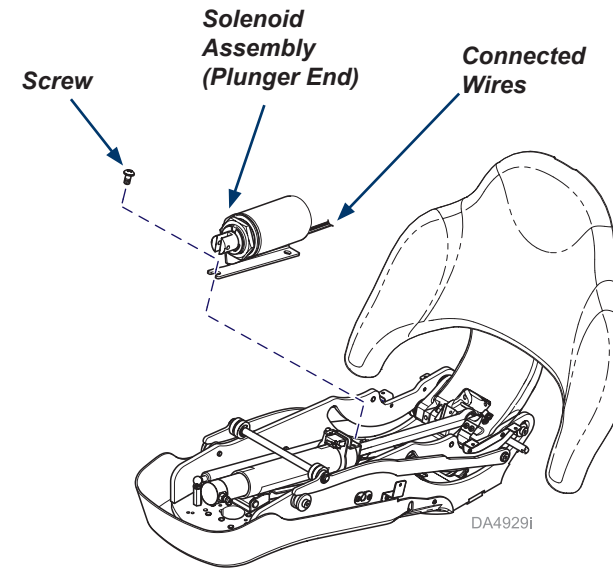

Because we care.

Step 8: Install previously removed linkage.

- A) Connect linkage to cylinder assembly.
- B) Connect linkage to solenoid assembly end.

**Caution**

Do not damage or disconnect solenoid assembly wires.
Ensure e-ring and plastic washer are secure on plunger end.
Ensure all wires are secure.

Step 9: Install new solenoid assembly.

- A) Install solenoid assembly to weldment using two screws and lockwasher.
- B) Connect wiring to solenoid assembly.
- C) Secure wiring connector under solenoid assembly.
- D) Secure any loose wiring.

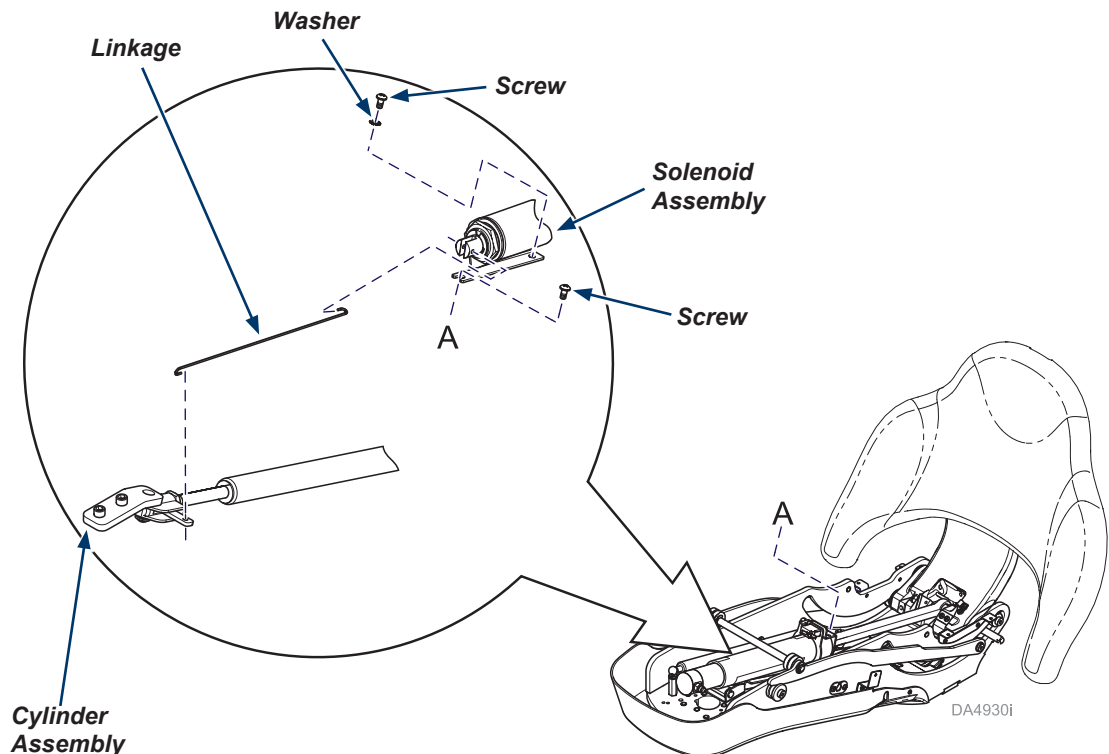
**Caution**

Verify frame top cover and frame covers do not contact the carriage casting.

Step 10: Finalize installation.

- A) Install any remaining covers/components (reverse Steps 2-4).
- B) Connect chair to power source.
- C) Ensure power is restored for hydraulic functions.
- D) Verify operation.