

626 Shroud Assembly Installation

Outer Shroud RH
1st Mid Shroud Set
3rd Mid Shroud Set

(002-10047-01)
(002-10273-00)
(002-10275-00)

Complete Shroud Kit
Mid Shroud Assembly (1 - 4)
Outer Shroud LH
2nd Mid Shroud Set
4th Mid Shroud Set

(002-10031-01)
(002-10032-01)
(002-10048-01)
(002-10274-00)
(002-10276-00)



Caution

Always disconnect power to chair before removing covers or performing any service procedures.

Step 1: Remove Top Cover

- Position chair to approximately 16" from the top of chair frame to floor.
- Unplug chair.
- Remove two screws from back of Top Cover.
- Pull cover toward head end to disengage tabs, then lift up to remove cover.

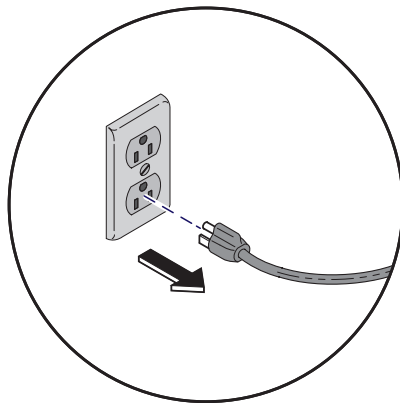

Tabs

Screws

16"

MA10555i

Note

For parts list, refer to the 626 Service and Parts manual.

Note

Remove all accessories (ex. chair arms) before performing this procedure.

Step 2: Remove Side Cladding.

- A) Locate tab inside head end of chair. Push tab toward foot end of chair. Pull cladding away from chair.
- B) Pull down on three tabs located at the bottom foot end of the cladding and pull cladding away from chair.
- C) Locate tab inside at center of chair (footrest must be extended) push tab up and pull cladding away from chair.
- D) Push up on Cladding, tip up and remove.
- E) Repeat process for opposite side.

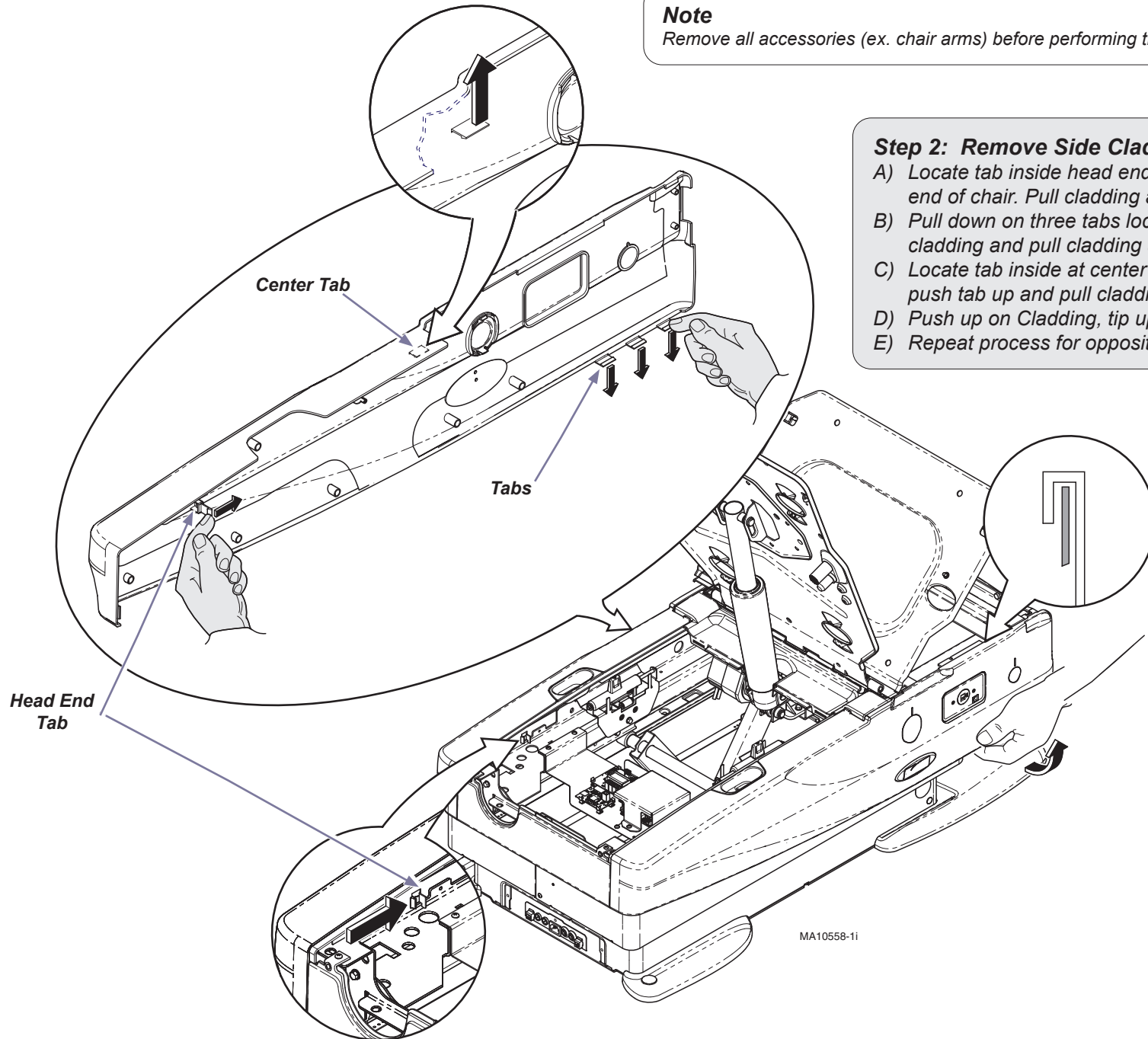

MA10558-1i

Step 3: Remove Rear Cladding

- A) Remove two screws from Rear Cladding.
- B) Squeeze Snap-in Post together on the bottom corners of the Fixed Cover.
- C) Pull upward on Fixed Cover corners.
- D) Remove Rear Cladding.

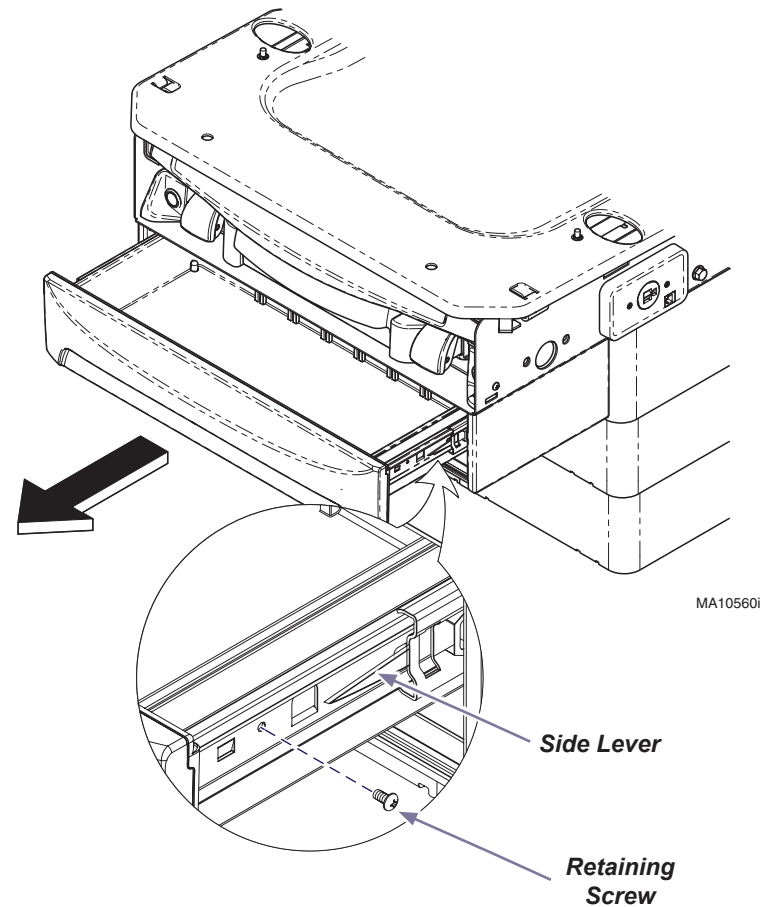
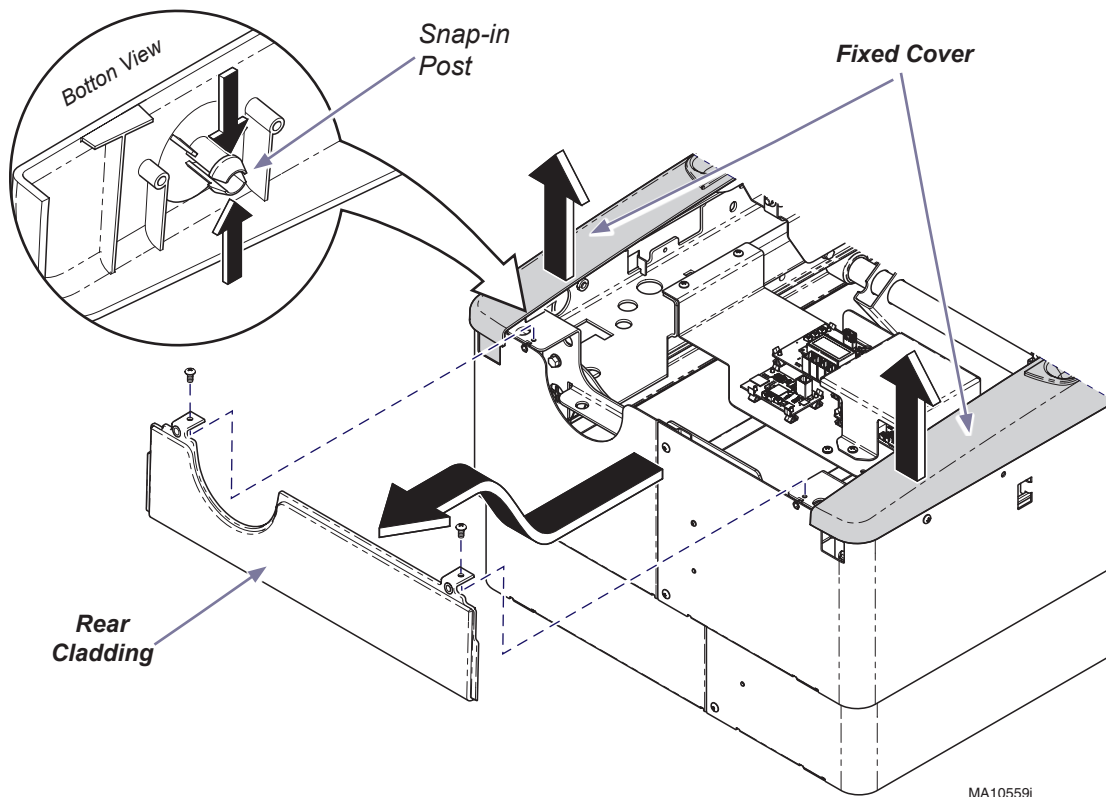

Step 4: Remove front drawer

- A) Remove Retaining Screw. (located on one side only)
- B) Push LH side lever UP and RH side lever DOWN.
- C) Remove drawer by pulling straight out.

Note: Side levers are clear plastic

Step 5: Remove Outer Shroud.

- A) Remove screws from head-end and foot-end of Outer Shrouds.
- B) Remove screws from both sides of Outer Shrouds.
- C) Lift up then out on the side of Outer Shroud to disengage the Side Tab.
- D) Pull Outer Shroud away from chair and lower the Front Tab out of slot.
- E) Remove Outer Shroud, and repeat on opposite side.

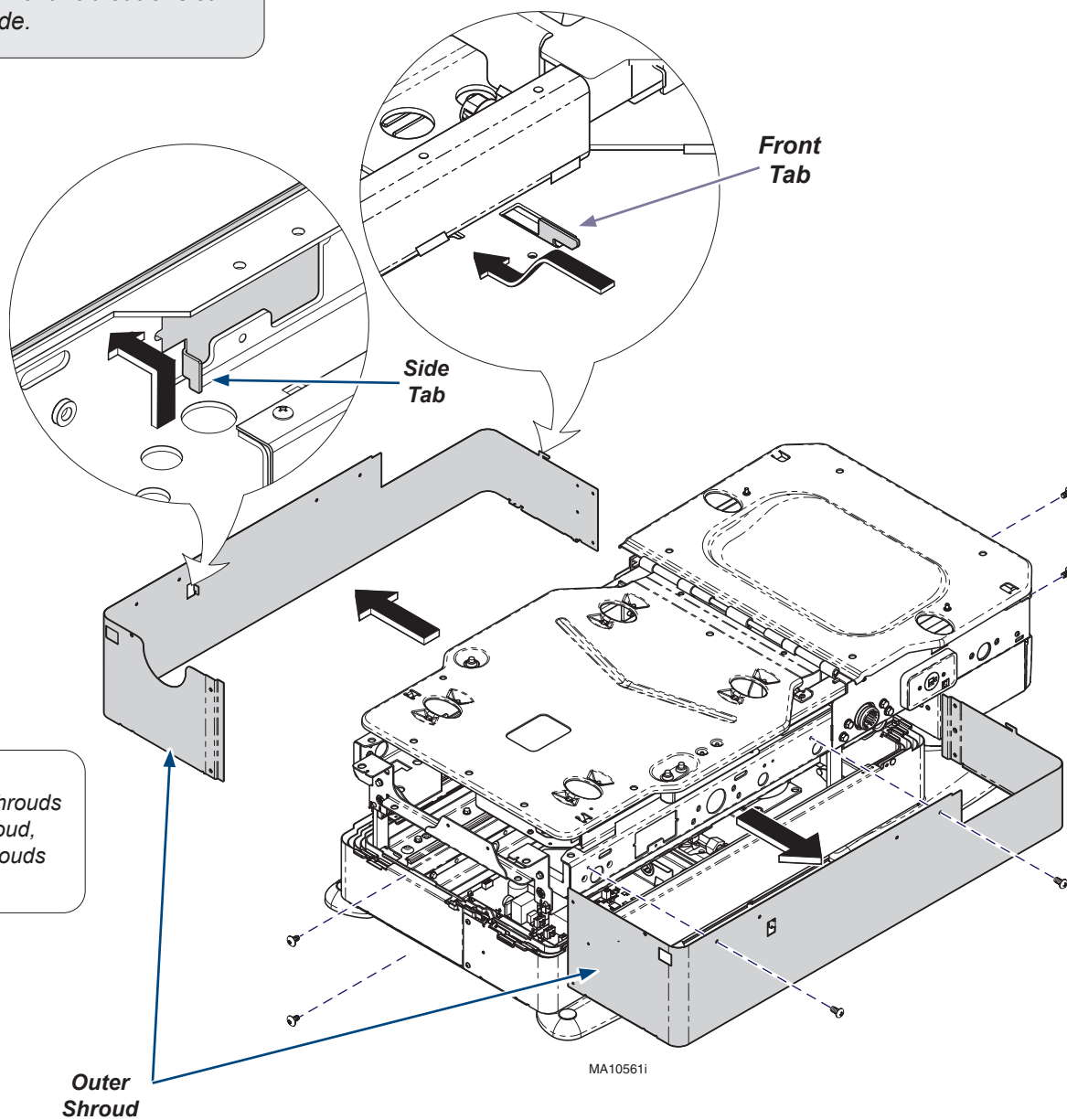

Equipment Alert

If the chair is at a height where the inner shrouds are being lifted/supported by the outer shroud, care must be taken to secure the inner shrouds while removing the outer shrouds.

Step 6: Remove Inner Shrouds.

- A) Remove screws from head-end and foot-end of Inner Shroud.
- B) Pull Inner Shroud away from chair to Remove. Repeat on remaining Shrouds.

Note: Shrouds are marked with 1,2,3 or 4 indicator holes in the top corners to quickly identify the matching shroud and assembly order.

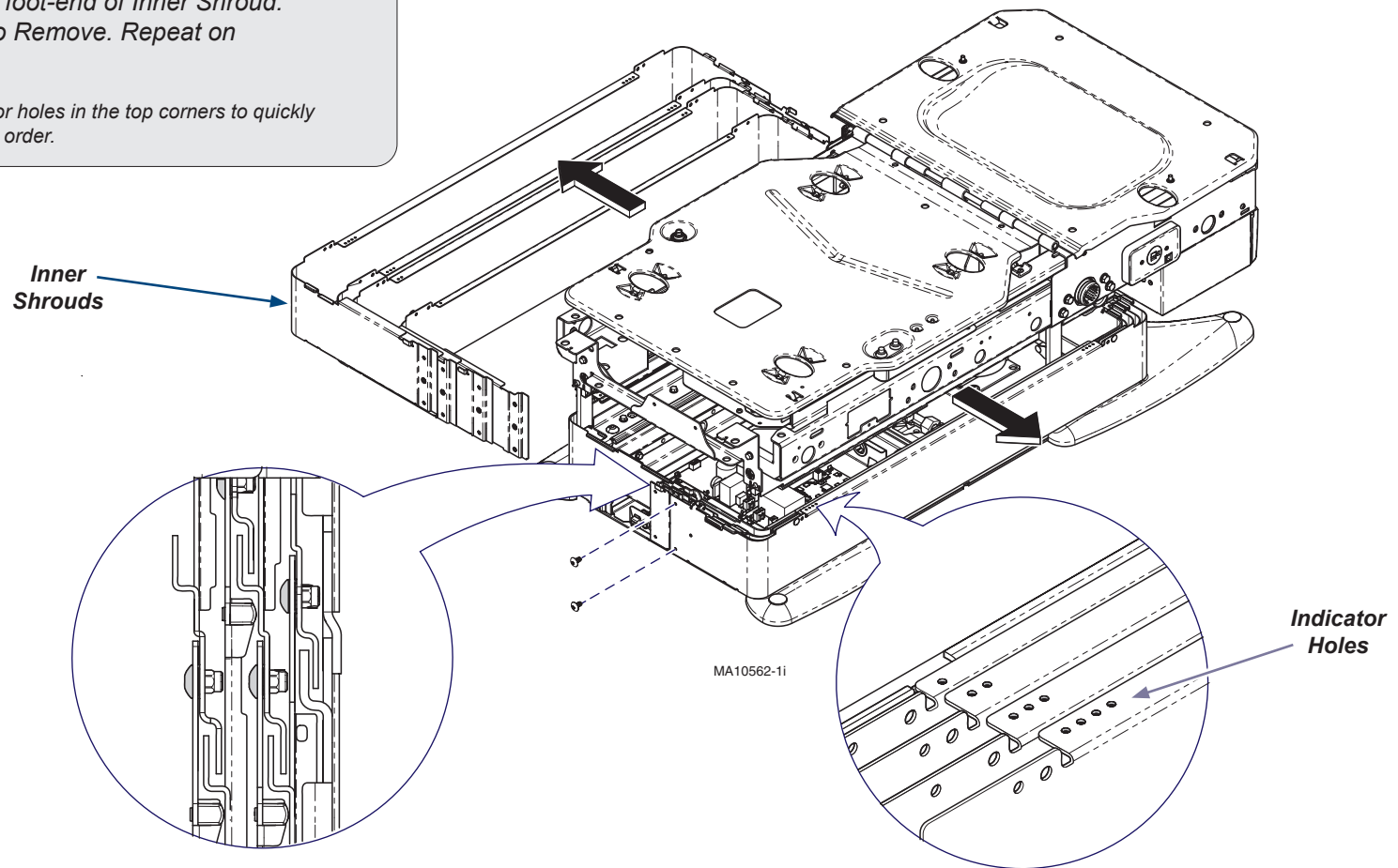

Step 7: Reassemble Chair with New Shrouds (Reverse Order)

- A) Install Inner Shrouds by pairing them up using the Indicator holes and screwing ends together.
- B) Install outer shroud by inserting Front and Side Tabs into chair frame. Install screws into sides of chair frame and ends of shrouds .
- C) Install Front Drawer into slides and secure with retaining screw.
- D) Position and secure Rear Cover with screws, push down on Fixed Cover corners until snap-in post are secured.
- E) Install Side Cladding by hooking top edge onto chair, then pushing in at tab locations until they engage the chair frame.
- F) Position top cover in place while engaging tabs into chair, secure with two screws.