



Caution

Always disconnect power to chair before removing covers or performing any service procedures.

Step 1: Remove Front Drawer

- Remove Retaining Screw. (located on one side only)
- Push LH side lever UP and RH side lever DOWN.
- Remove drawer by pulling straight out.

Note: Side levers are clear plastic.

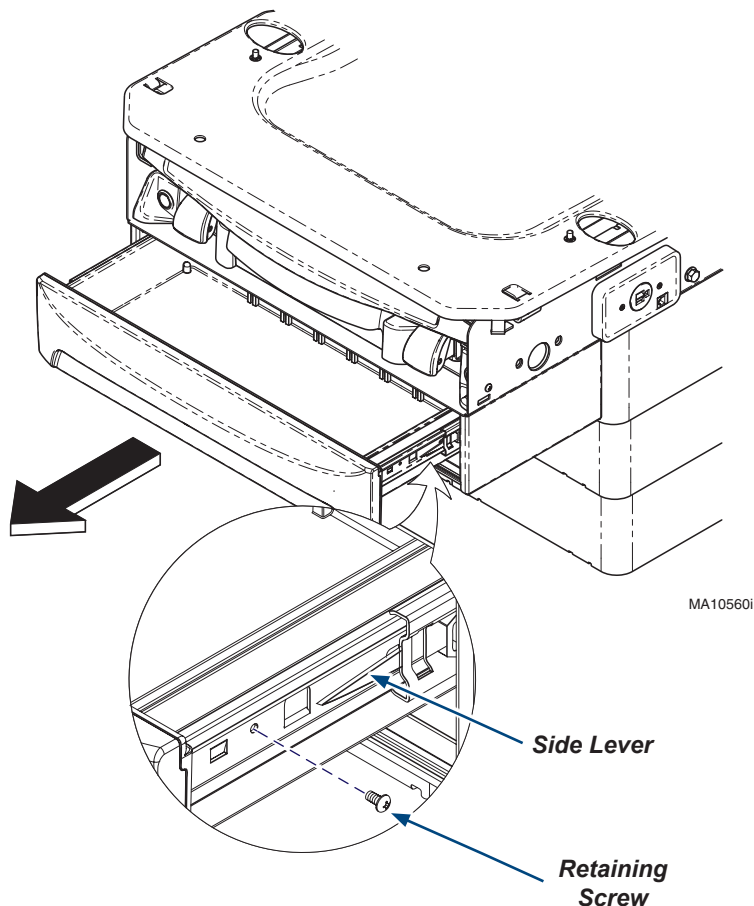

Step 2: Remove Front Storage Bale and Receptacle Cover.

- Push tabs inward and pull down on Front Storage Bale to remove.
- Remove left side (patient position) Receptacle Cover by removing two screws.

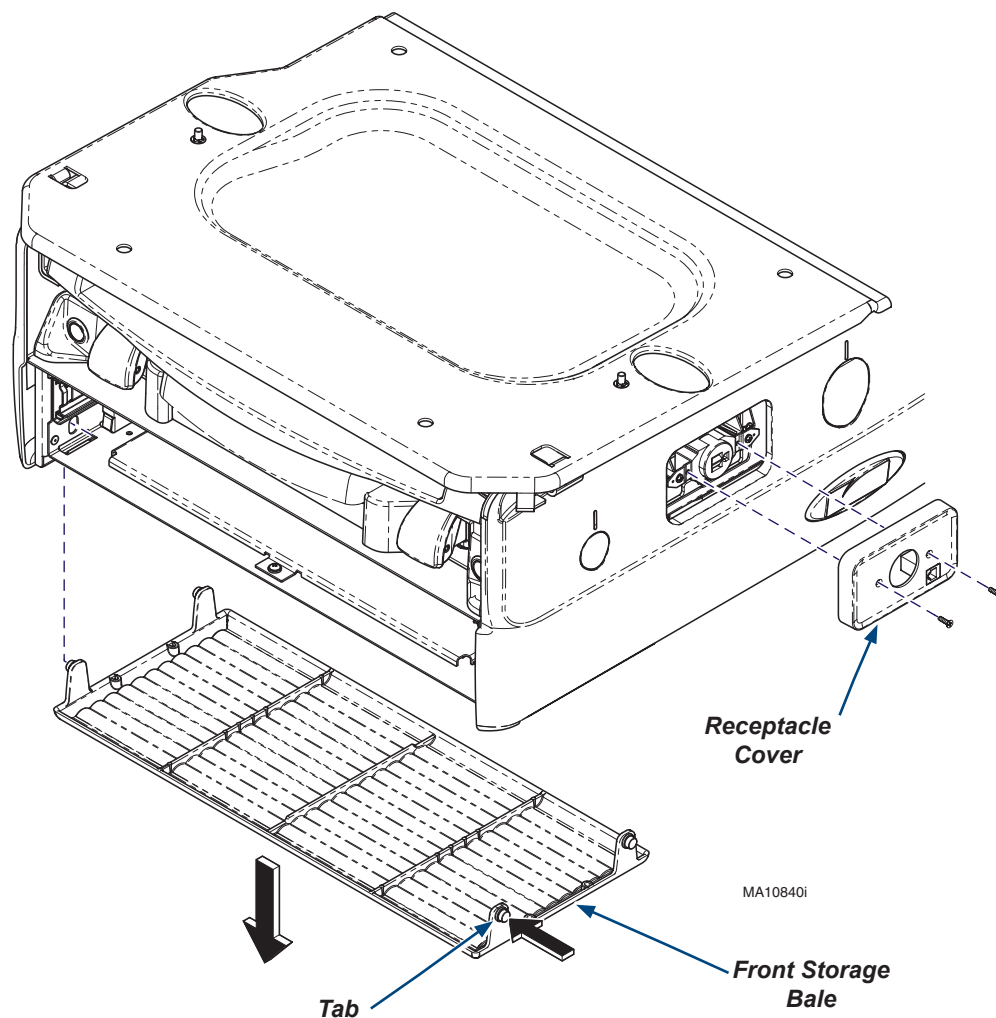

Step 3: Remove Heater Plate Assembly and Receptacle.

- A) Remove screw, nut and Front Isolators from the Heater Plate assembly.
- B) Remove the Receptacle and disconnect the Heater Plate Assembly wire connection located behind the Receptacle.
- C) Remove Heater Plate Assembly by tilting up the front edge and lifting up and out.



Equipment Alert

Failure to install Front and Rear Isolators correctly can cause the chair to overheat.

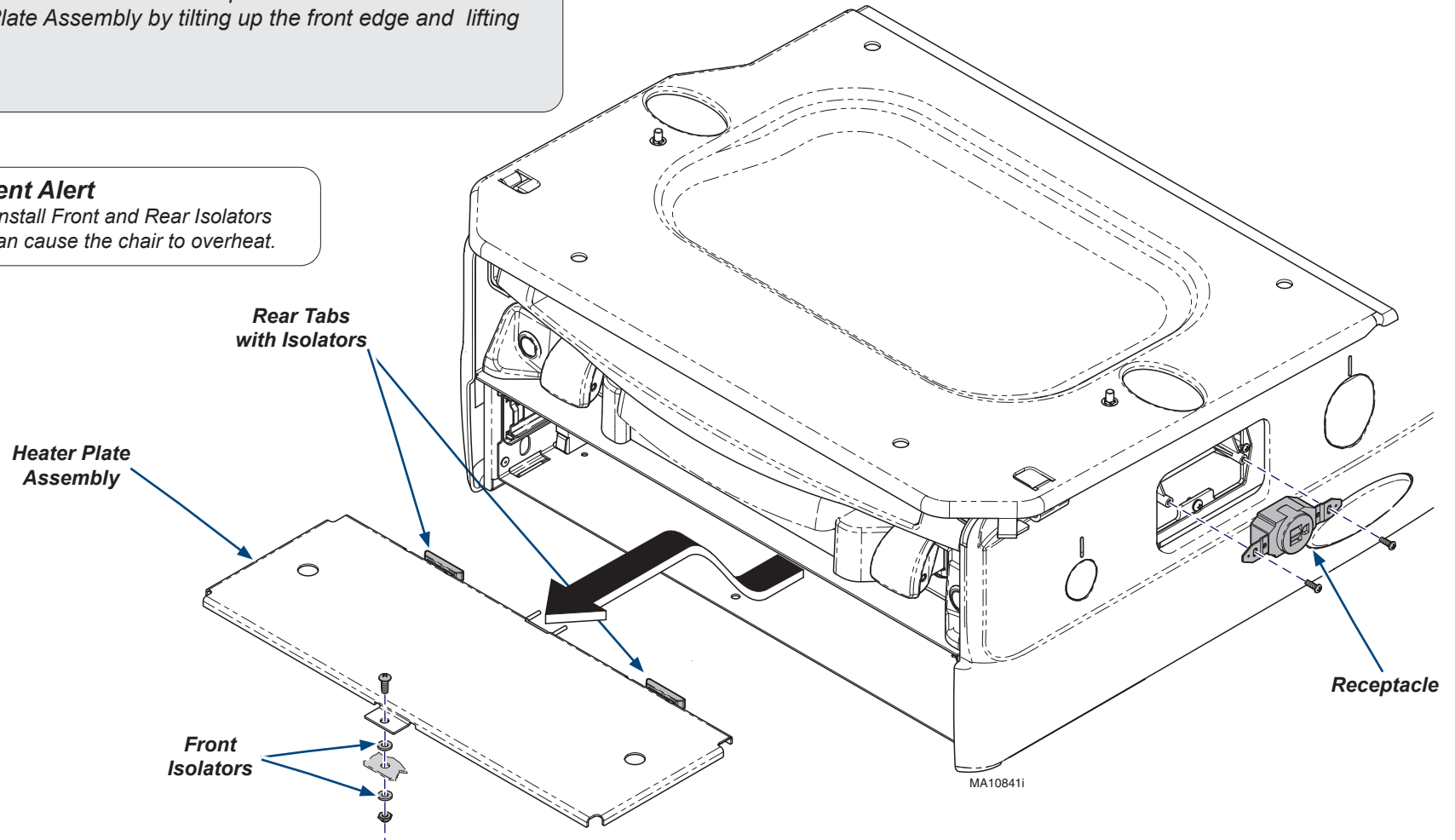

Step 4: Reassemble Heater Plate Assembly. (Reverse Order)

- A) Install Heater Plate Assembly by tilting the Rear Tabs with Isolators down into the slots, lower the front.
- B) Install the Front Isolators on both sides of the chair frame isolating the nut and the Heater plate assembly from the chair. Secure with nut and screw.
- C) Connect wires to the Heater Plate Assembly (Behind the Receptacle).
- D) Install the Receptacle and Receptacle Cover.
- E) Install the Front Storage Bale and the front Drawer.