



Caution

Always disconnect power to chair before removing covers or performing any service procedures.

Step 1: Remove Top Cover

- Position chair to approximately (16" model 626) (21" model 225) from the top of chair frame to floor.
- Unplug chair.
- Remove two screws from back of Top Cover.
- Pull cover toward head end to disengage tabs, then lift up to remove cover.

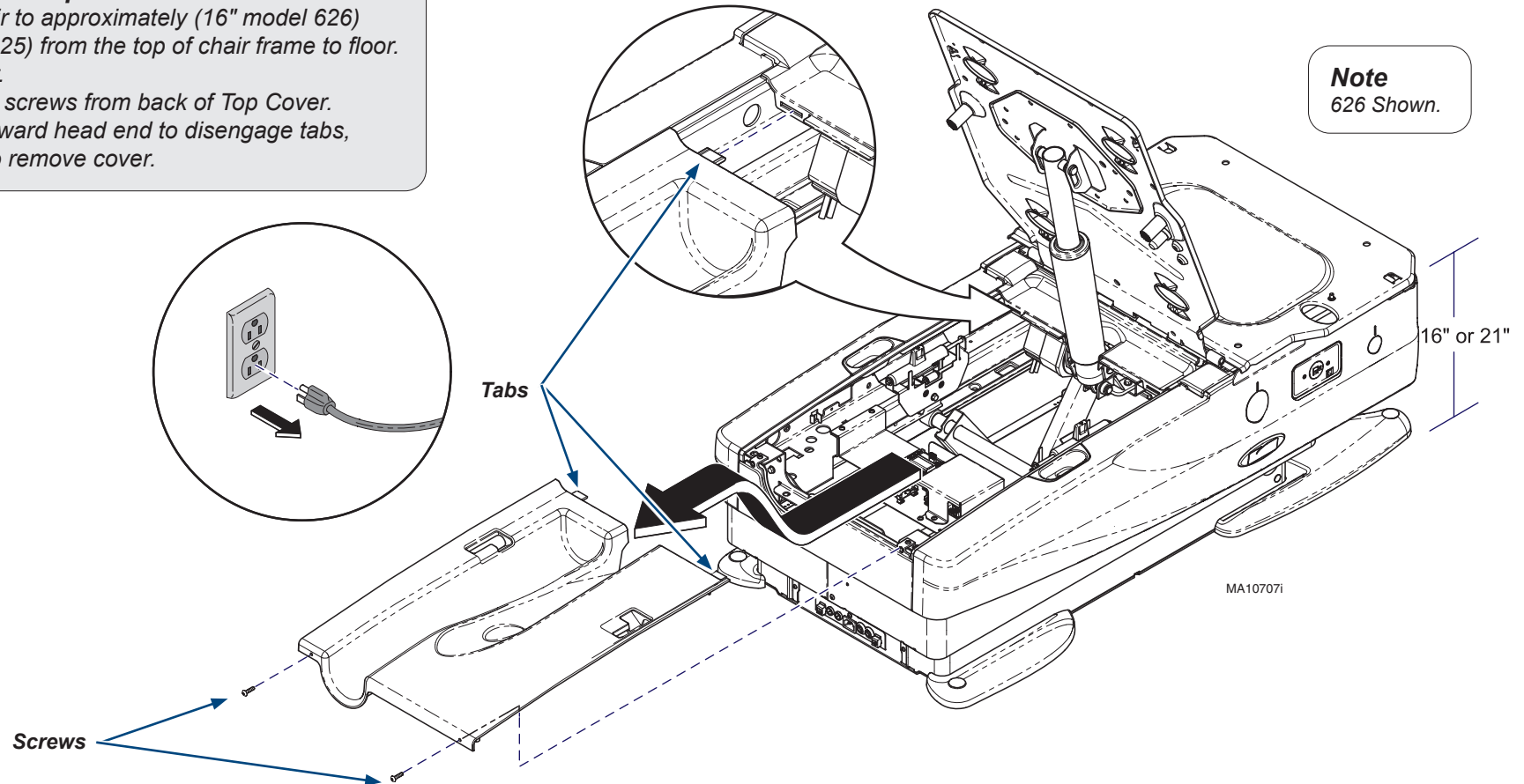

Note
626 Shown.

Note

For parts list, refer to the 626 Service and Parts manual.

Step 2: Remove Side Cladding.

- Pull down on three tabs located at the bottom foot end of the cladding and pull cladding away from chair.
- Locate tab inside head end of chair. Push tab toward foot end of chair. Pull cladding away from chair.
- Locate tab inside at center of chair (footrest must be extended) push tab up and pull cladding away from chair.
- Push up on Cladding, tip up and remove.
- Repeat process for opposite side.

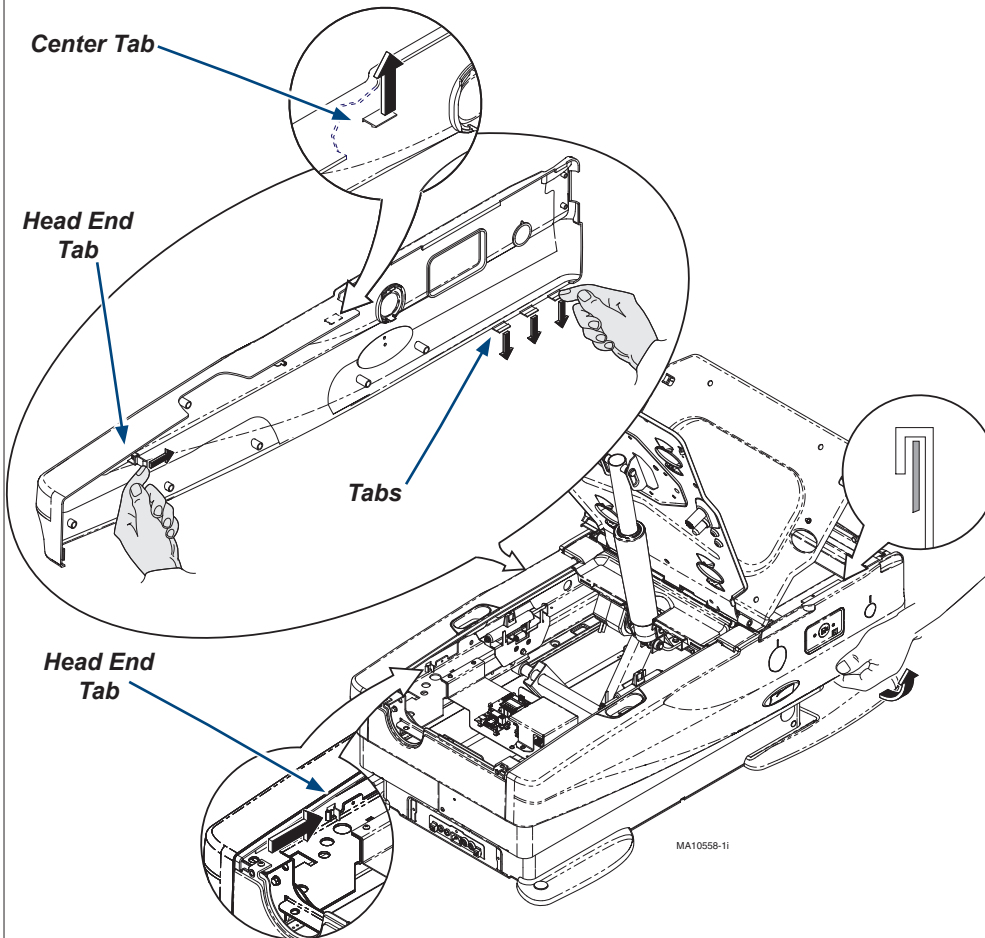
**Step 2: Remove Side Cladding.**

- Locate tabs inside at center of chair (footrest must be extended). Push down on top tab and up on bottom tab. Pull cladding away from chair.
- Pull up on Cladding overhang and remove.
- Repeat process for opposite side.

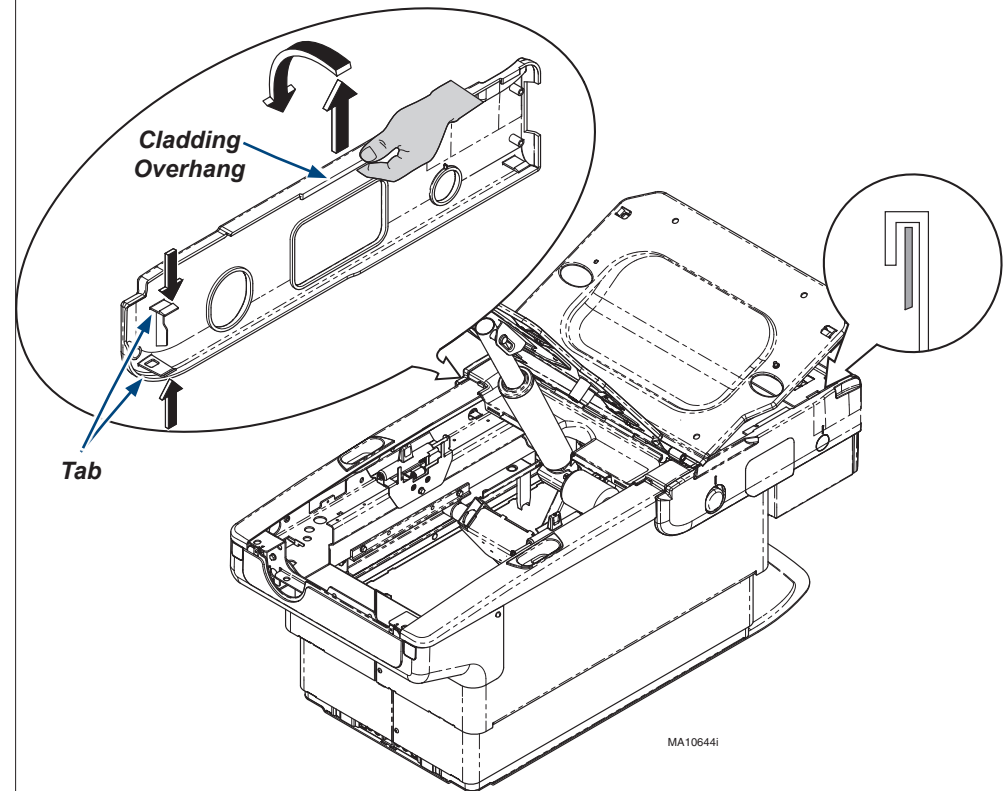
**Note**

Remove all accessories (ex. chair arms) before performing this procedure.

626

Step 3: Remove Rear Cladding

- Remove two screws from Rear Cladding.
- Squeeze Snap-in Post together on the bottom corners of the Fixed Cover.
- Pull upward on Fixed Cover corners.
- Remove Rear Cladding.

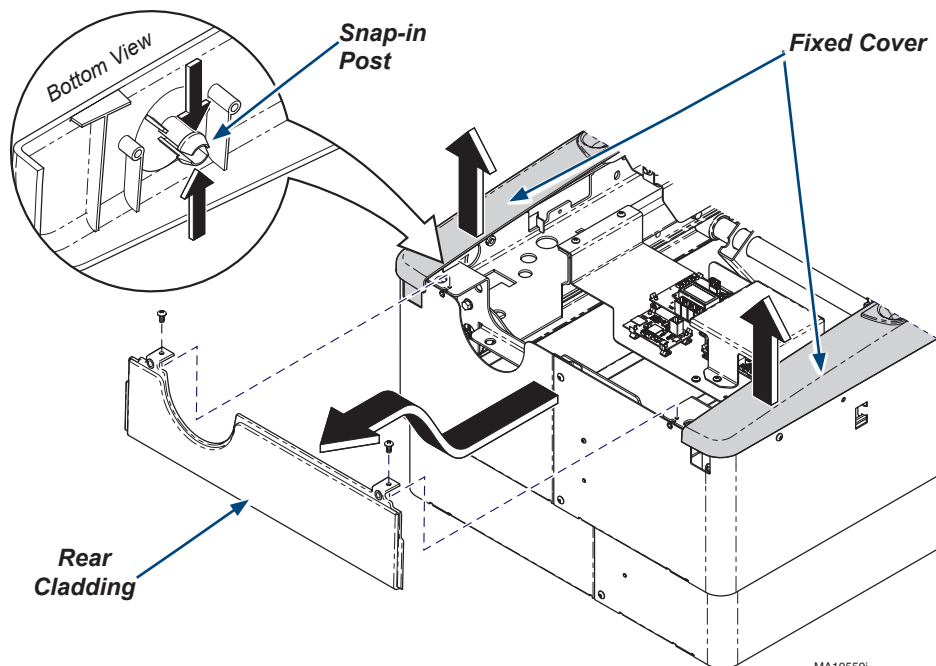
**Step 4: Remove front drawer**

- Remove Retaining Screw. (located on one side only)
- Push LH side lever UP and RH side lever DOWN.
- Remove drawer by pulling straight out.

Note: Side levers are clear plastic

225

Step 3: Remove Rear Cladding

- Remove two screws from outside corners of Rear Cladding.
- Remove two screws from inside center of Rear Cladding.
- Remove Rear Cladding.

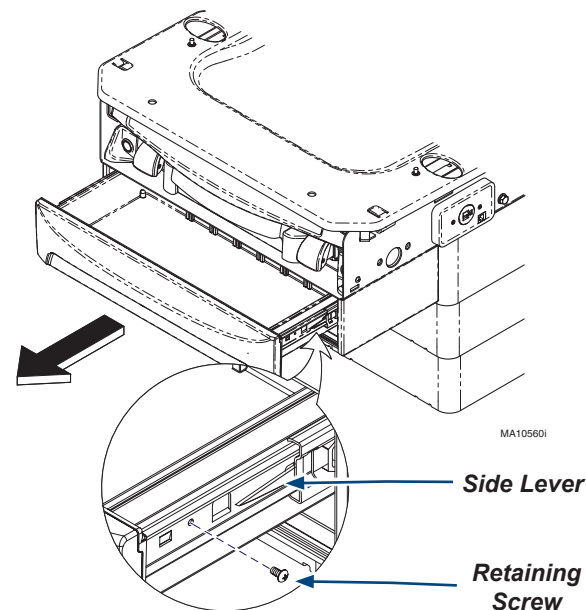
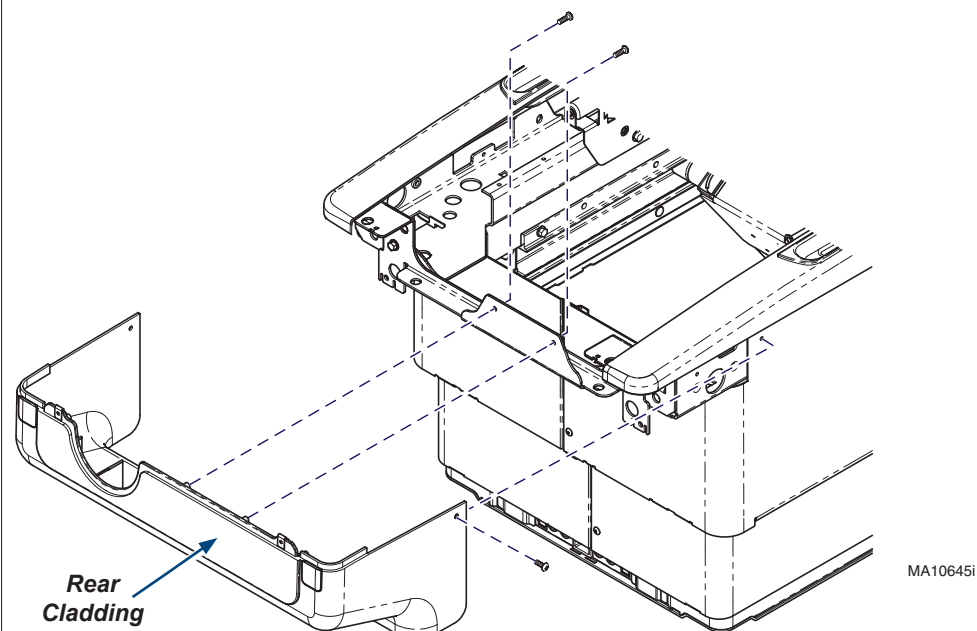

Step 5: Remove Outer Shroud.

- A) Remove screws from head-end and foot-end of Outer Shrouds.
- B) Remove screws from both sides of Outer Shrouds.
- C) Lift up then out on the side of Outer Shroud to disengage the Side Tab.
- D) Pull Outer Shroud away from chair and lower the Front Tab out of slot.
- E) Remove Outer Shroud, and repeat on opposite side.

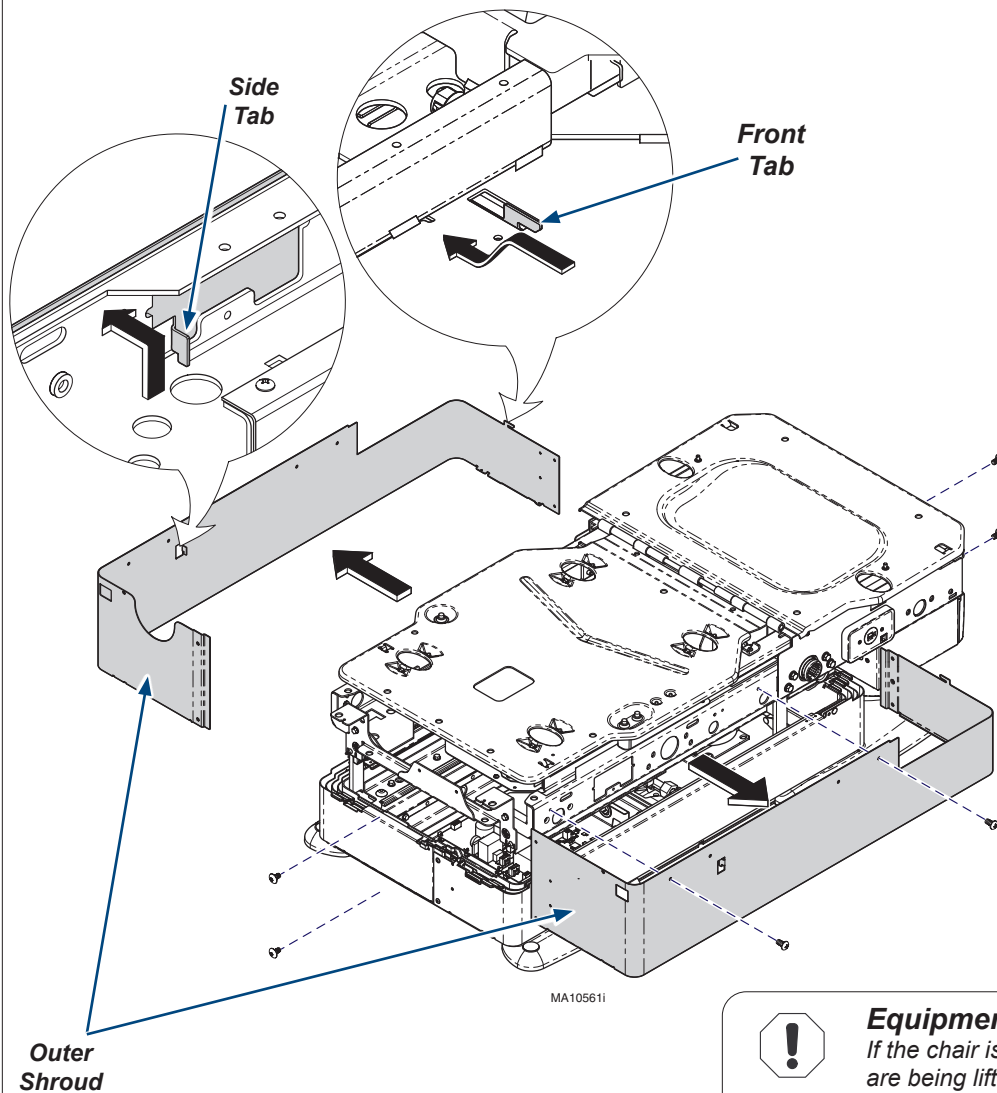
**Step 5: Remove Outer Shroud.**

- A) Remove screws from head-end and foot-end of Outer Shrouds.
- B) Remove screw from foot end of Outer Shrouds.
- C) Pull Outer Shroud away from chair and lower the Tabs out of slots.
- D) Remove Outer Shroud, and repeat on opposite side.

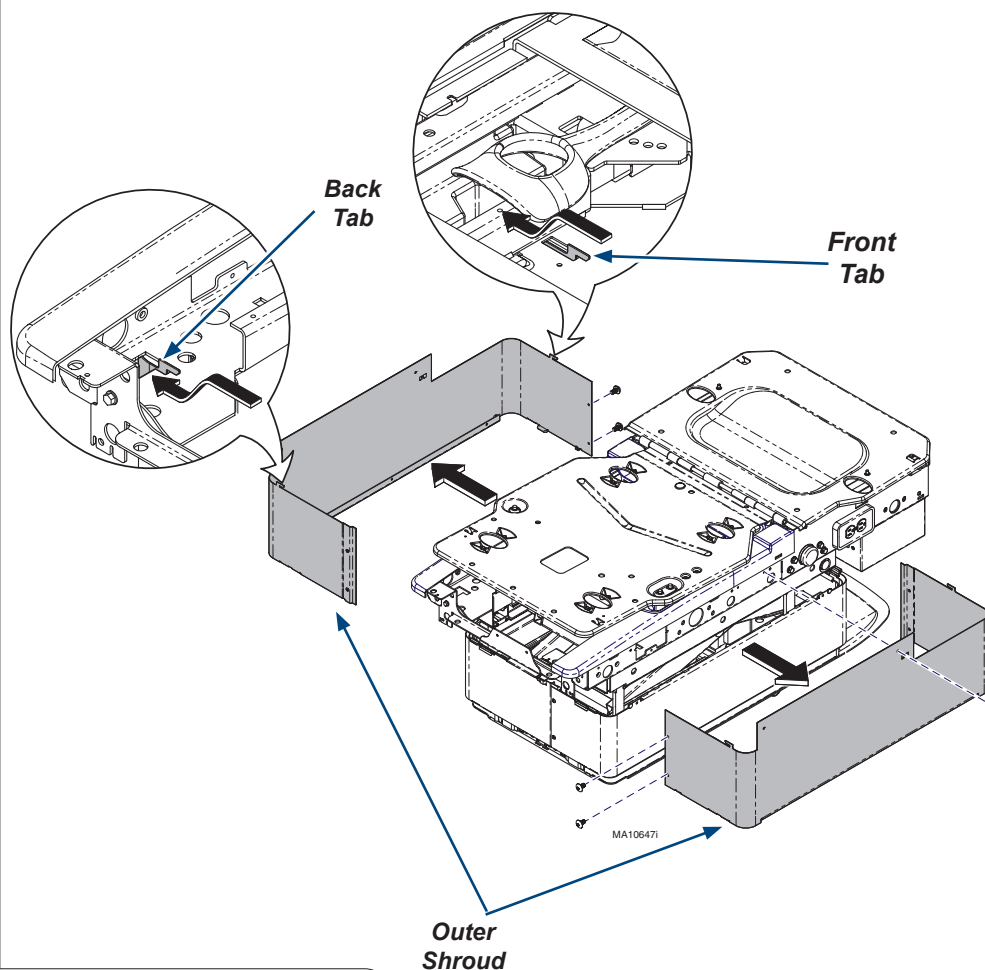
**Equipment Alert**

If the chair is at a height where the inner shrouds are being lifted/supported by the outer shroud, care must be taken to secure the inner shrouds while removing the outer shrouds.

626

Step 6: Remove Inner Shrouds.

- A) Remove screws from head-end and foot-end of Inner Shroud.
- B) Pull Inner Shroud away from chair to Remove. Repeat on remaining Shrouds.

Note: Shrouds are marked with 1,2,3 or 4 indicator holes in the top corners to quickly identify the matching shroud and assembly order.

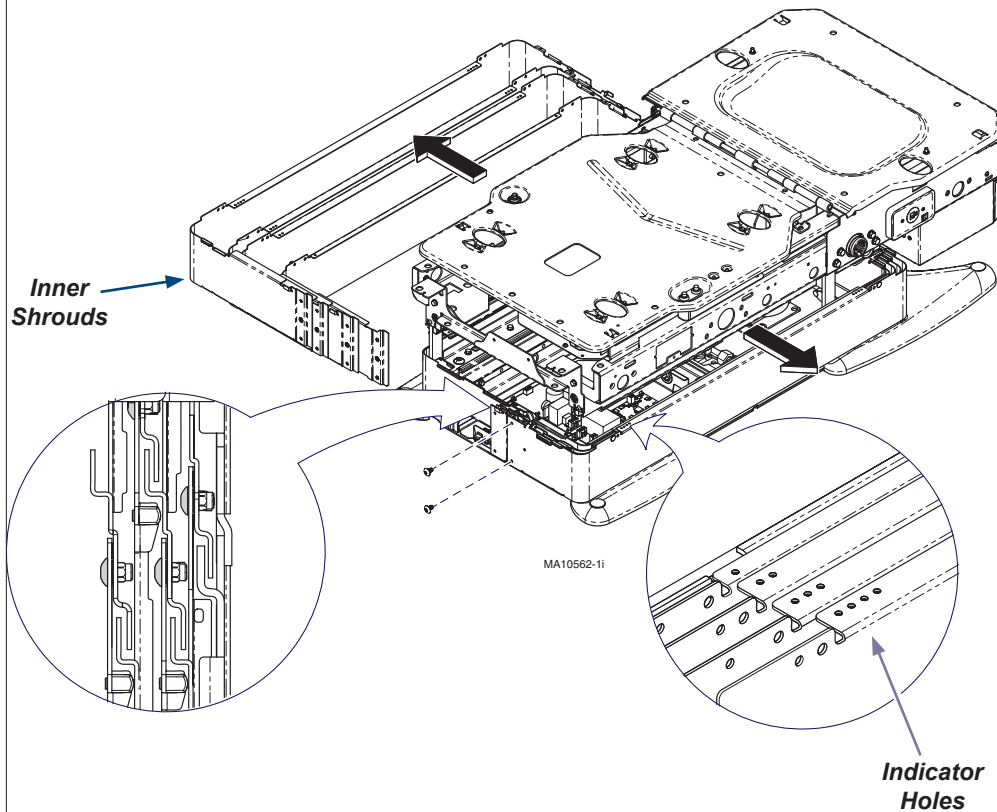

225

Step 6: Remove Inner Shrouds.

- A) Remove screws from head-end and foot-end of Inner Shroud
- B) Pull Inner Shroud away from chair to Remove. Repeat on remaining Shrouds.

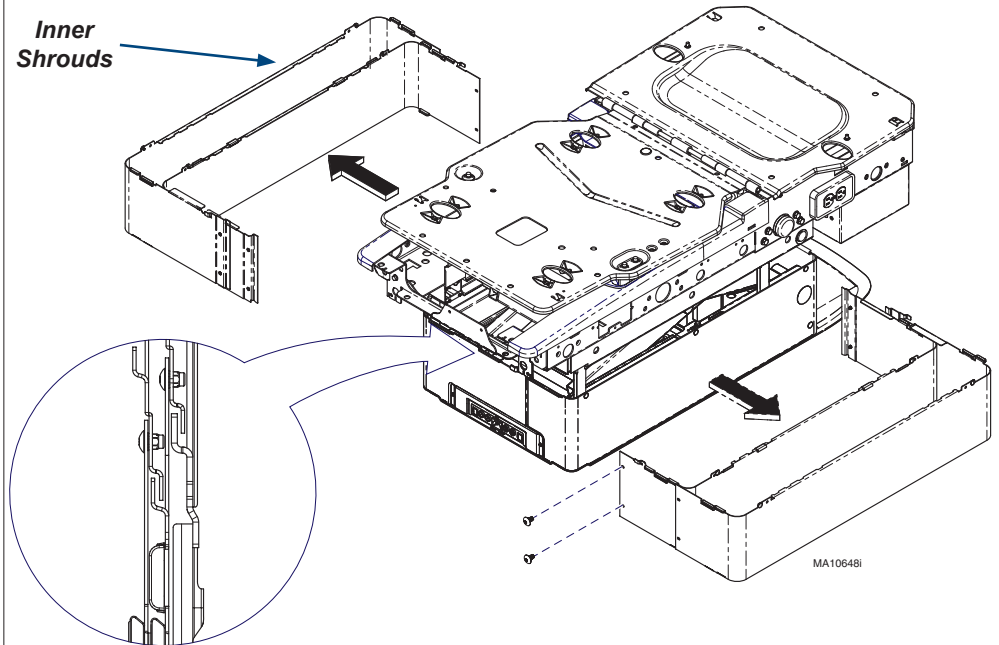

Step 7: Replace Swivel Arm Assembly.

- A) Remove E-clip from Swivel Arm Pivot Pin and remove pin, Flanged Bearing and Spacer.
- B) Drop old Swivel Arm Assembly out the bottom of chair and insert new Swivel Arm Assembly.
- C) Position Spring and Spring Perch Plug with the Swivel Arm Assembly as shown.
- D) Insert Swivel Arm Pivot Pin, Flanged Bearing and Spacer. Secure with E-clip.

Note: Reuse existing Flanged Bearing, Spacer, Swivel Arm Pivot Pin, Spring and Spring Perch Plug.

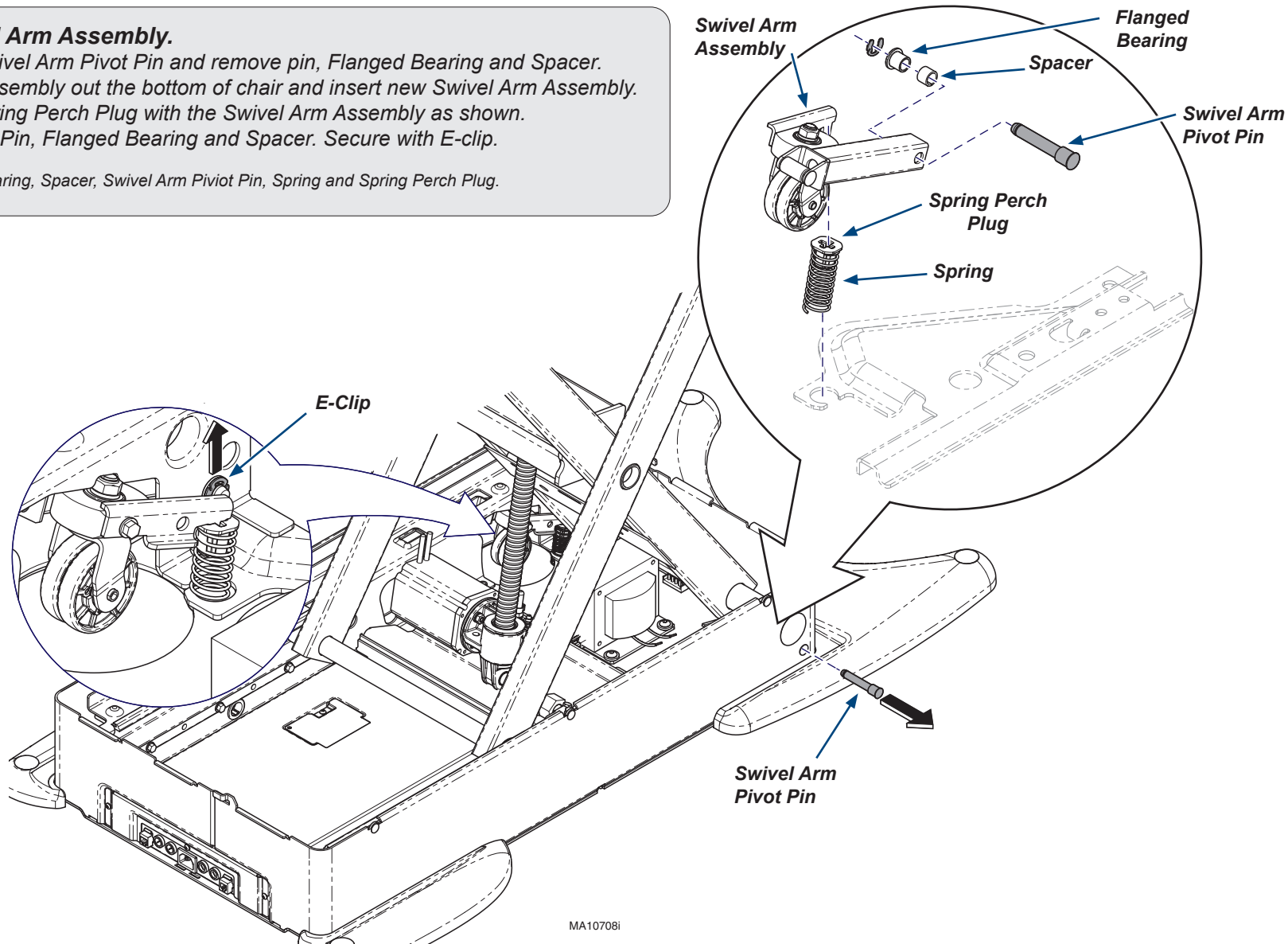

MA10708i

Step 8: Reassemble Chair (Reverse Order)

- A) Install Inner Shrouds by pairing them up (use the Indicator holes on 626) and screwing ends together.
- B) Install outer shroud by inserting Front and Side Tabs into chair frame. Install screws into sides of chair frame and ends of shrouds .
- C) Install Front Drawer into slides and secure with retaining screw.
- D) Position and secure Rear Cladding with screws, push down on Fixed Cover corners until snap-in post are secured.
- E) Install Side Cladding by hooking top edge onto chair, then pushing in at tab locations until they engage the chair frame.
- F) Position top cover in place while engaging tabs into chair, secure with two screws.