

626 Base Actuator Assembly / Base Actuator Motor Installation [002-10093-01 / 002-10094-01]



Caution

Always disconnect power to chair before removing covers or performing any service procedures.

Step 1: Remove Top Cover.

- Position chair to approximately 16" from the top of chair frame to floor.
- Unplug chair.
- Remove two screws from back of Top Cover.
- Pull cover toward head end to disengage tabs, then lift up to remove cover.

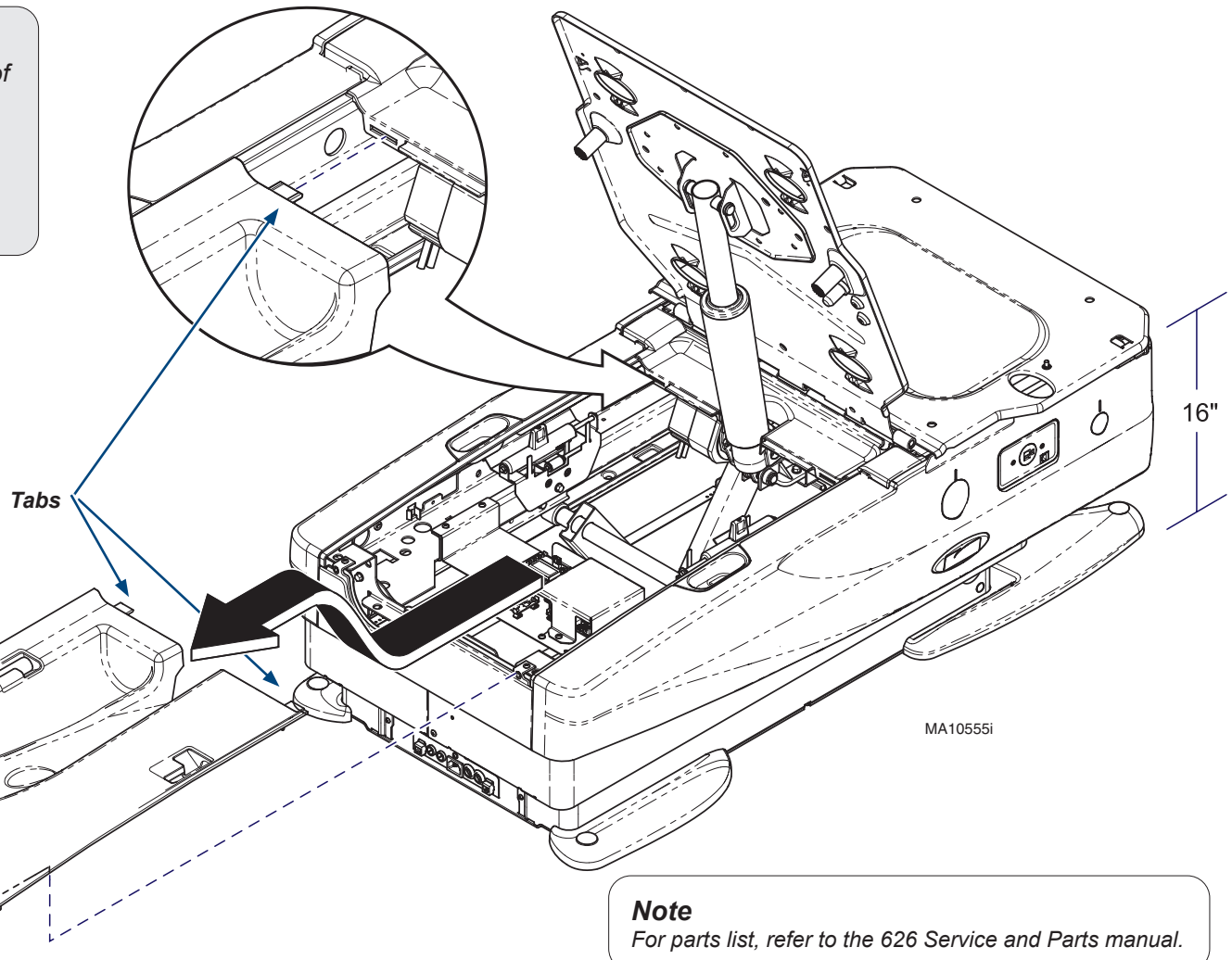
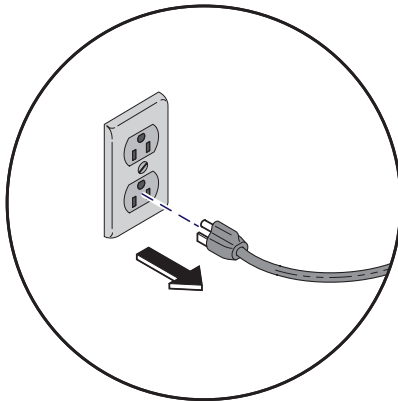

Note

For parts list, refer to the 626 Service and Parts manual.

Note

Remove all accessories (ex. chair arms) before performing this procedure.

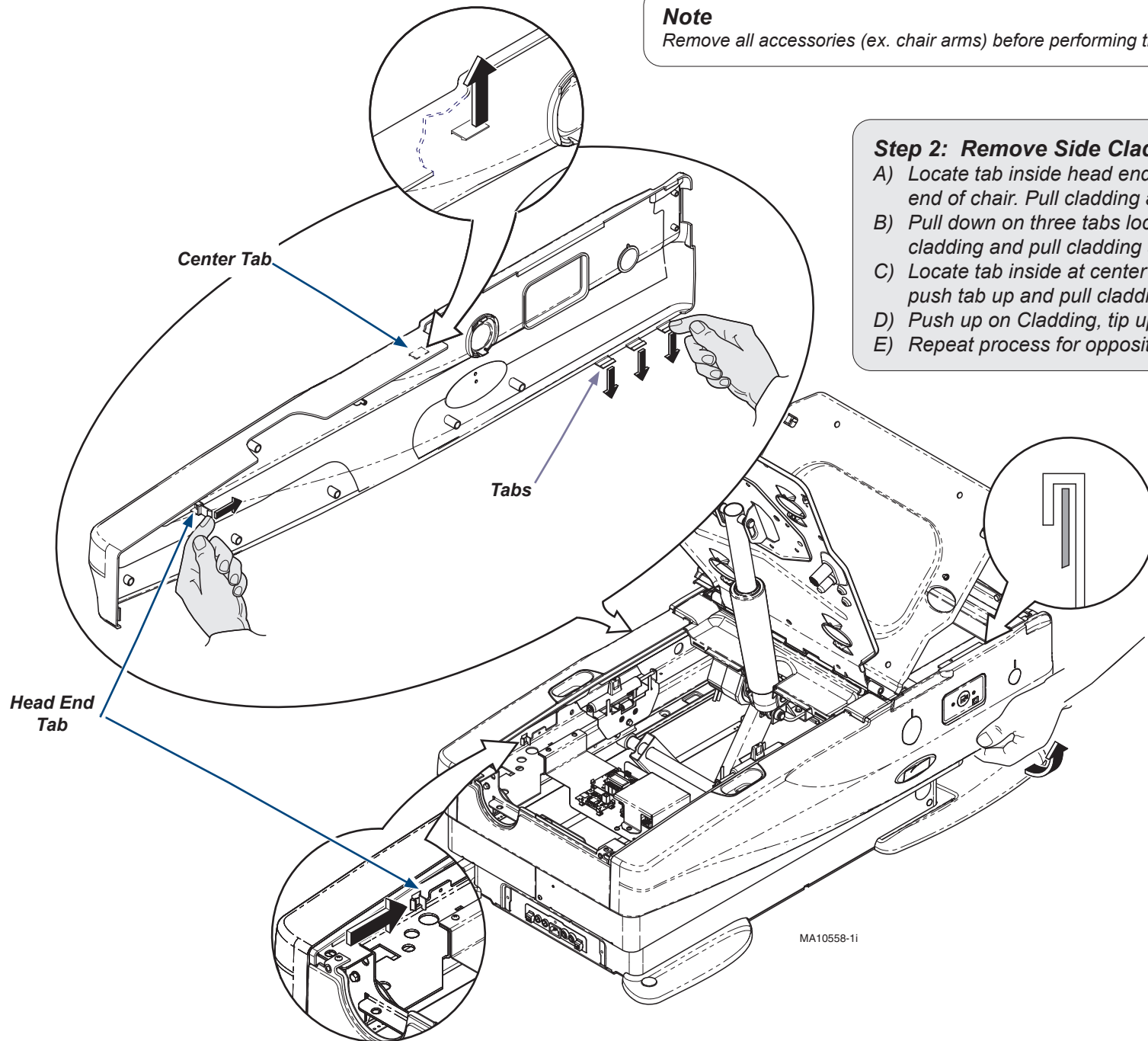

Step 2: Remove Side Cladding.

- A) Locate tab inside head end of chair. Push tab toward foot end of chair. Pull cladding away from chair.
- B) Pull down on three tabs located at the bottom foot end of the cladding and pull cladding away from chair.
- C) Locate tab inside at center of chair (footrest must be extended) push tab up and pull cladding away from chair.
- D) Push up on Cladding, tip up and remove.
- E) Repeat process for opposite side.

MA10558-1i

Step 3: Remove Rear Cladding.

- A) Remove two screws from Rear Cladding.
- B) Squeeze Snap-in Post together on the bottom corners of the Fixed Cover.
- C) Pull upward on Fixed Cover corners.
- D) Remove Rear Cladding.

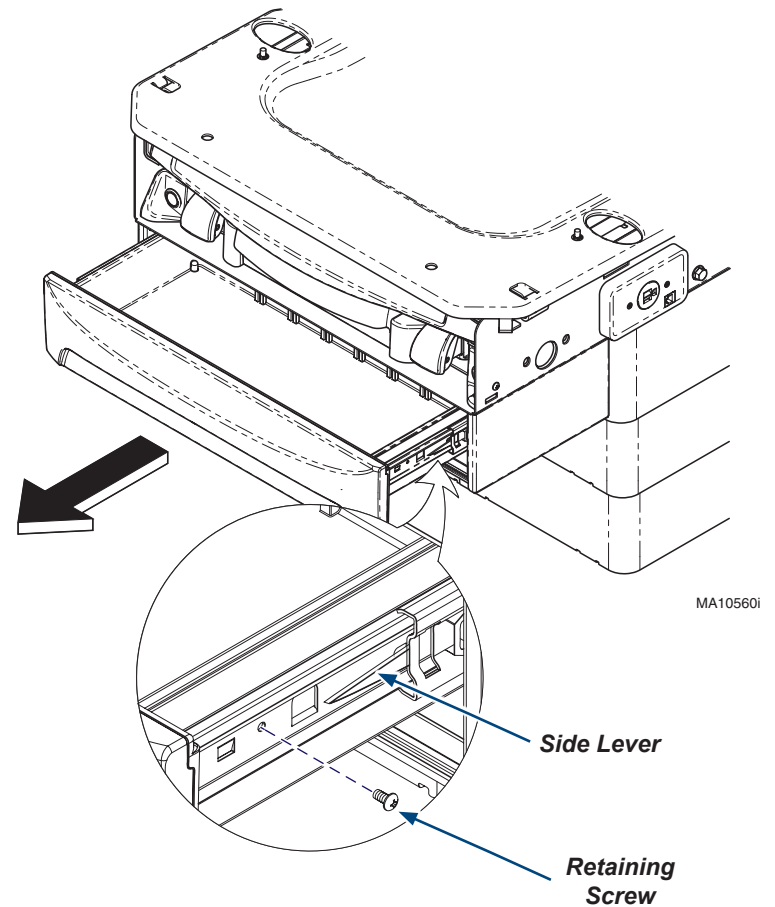
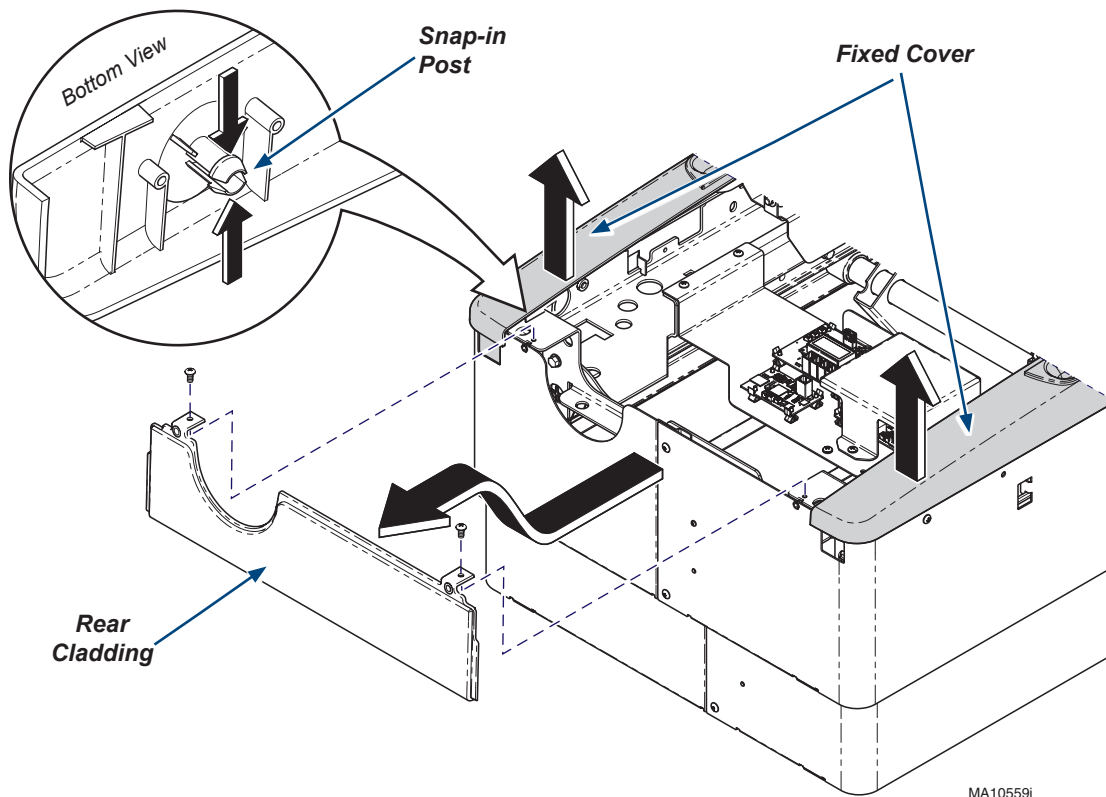

Step 4: Remove Front Drawer.

- A) Remove Retaining Screw. (located on one side only)
- B) Push LH side lever UP and RH side lever DOWN.
- C) Remove drawer by pulling straight out.

Note: Side levers are clear plastic.

Step 5: Remove Outer Shroud.

- A) Remove screws from head-end and foot-end of Outer Shrouds.
- B) Remove screws from both sides of Outer Shrouds.
- C) Lift up then out on the side of Outer Shroud to disengage the Side Tab.
- D) Pull Outer Shroud away from chair and lower the Front Tab out of slot.
- E) Remove Outer Shroud, and repeat on opposite side.

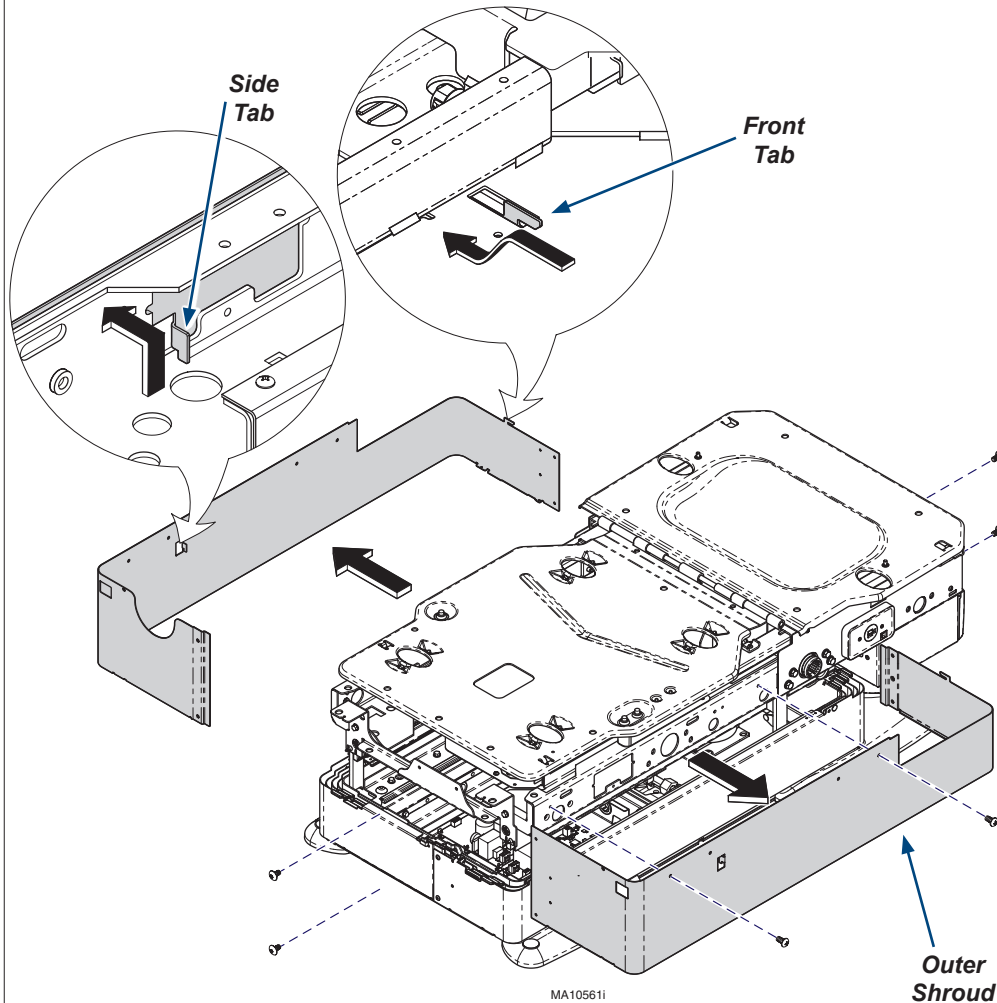

Step 6: Remove Inner Shrouds.

- A) Remove screws from head-end and foot-end of Inner Shroud.
- B) Pull Inner Shroud away from chair to Remove. Repeat on remaining Shrouds.

Note: Shrouds are marked with 1,2,3 or 4 indicator holes in the top corners to quickly identify the matching shroud and assembly order.

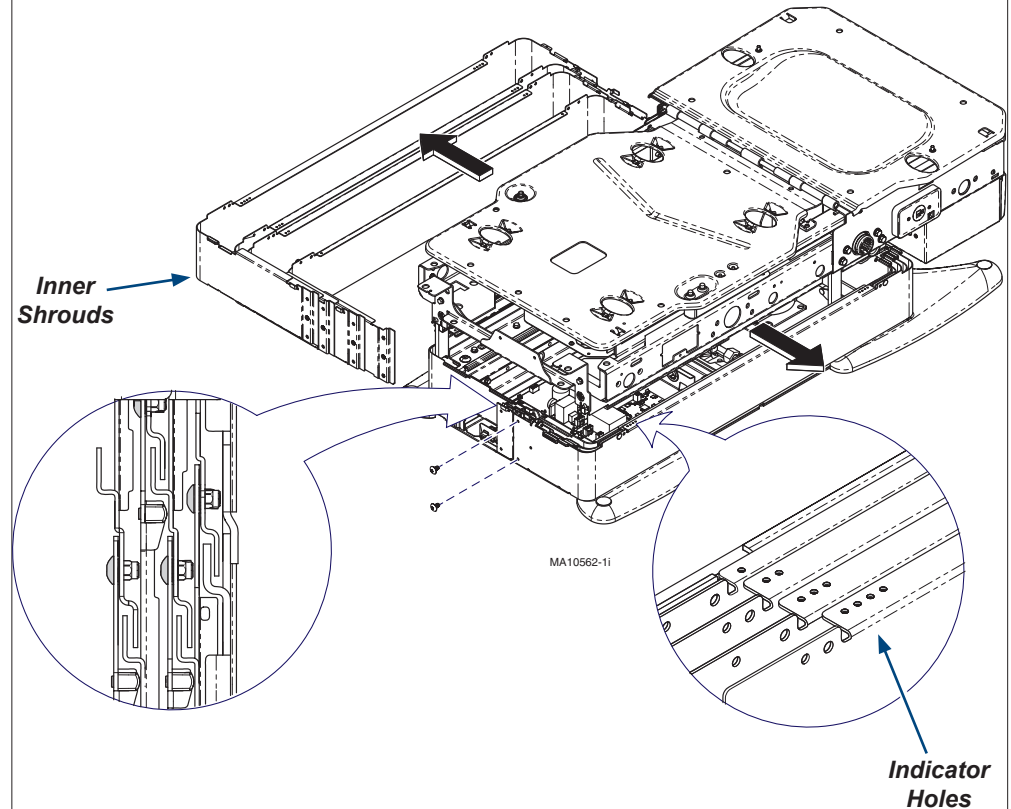

Equipment Alert

If the chair is at a height where the inner shrouds are being lifted/supported by the outer shroud, care must be taken to secure the inner shrouds while removing the outer shrouds.

Step 7: Remove PCB Shelf Assembly.

- A) Remove the four screws holding the PCB Shelf Assembly.
- B) Relocate the PCB Shelf Assembly to a safe area off to the side.
- C) Remove three screws from Control Board Housing Cover and slide halfway out to access base actuator motor wires.

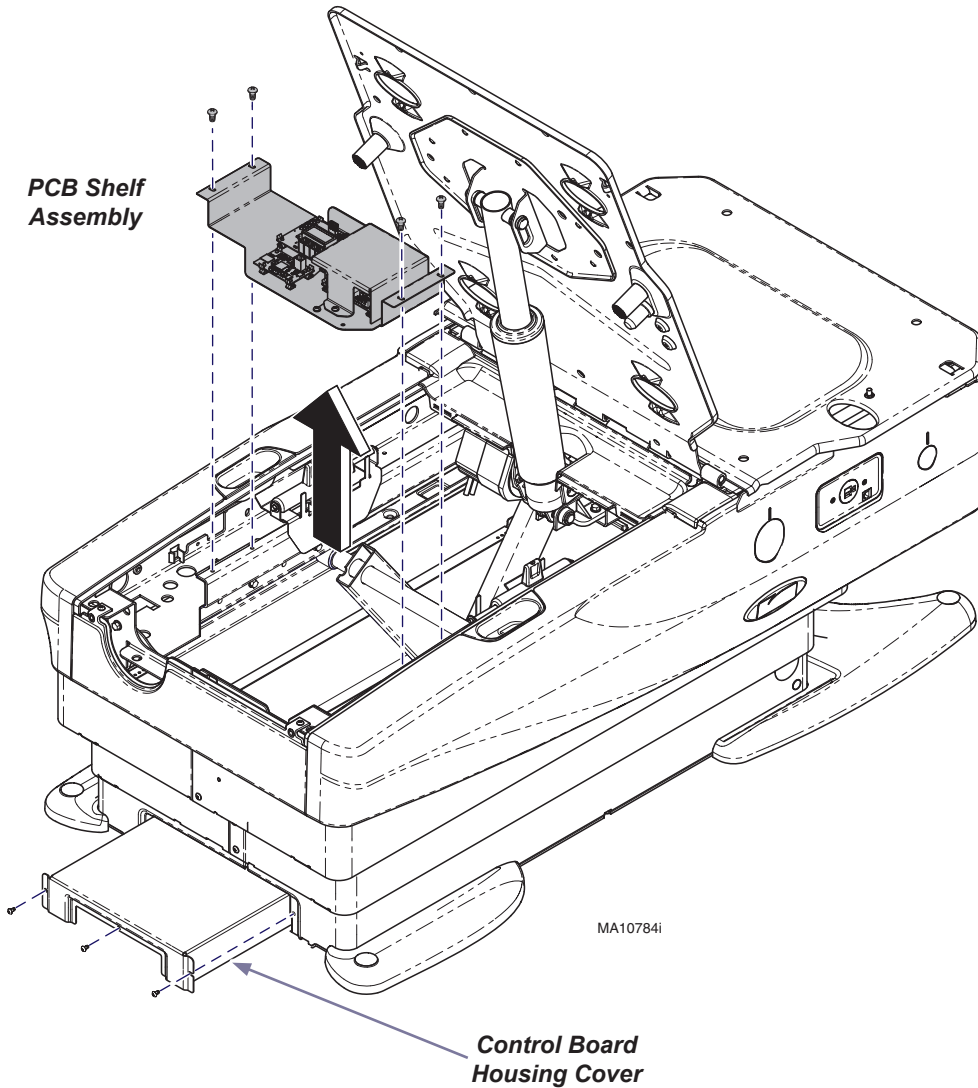

Step 8: Install Scissors Locking Tool.

- A) Raise chair to almost full extension, Place Scissors Locking Tool as shown and secure with provided screws.

Note: Scissors Locking Tool can be installed into either side of the chair.

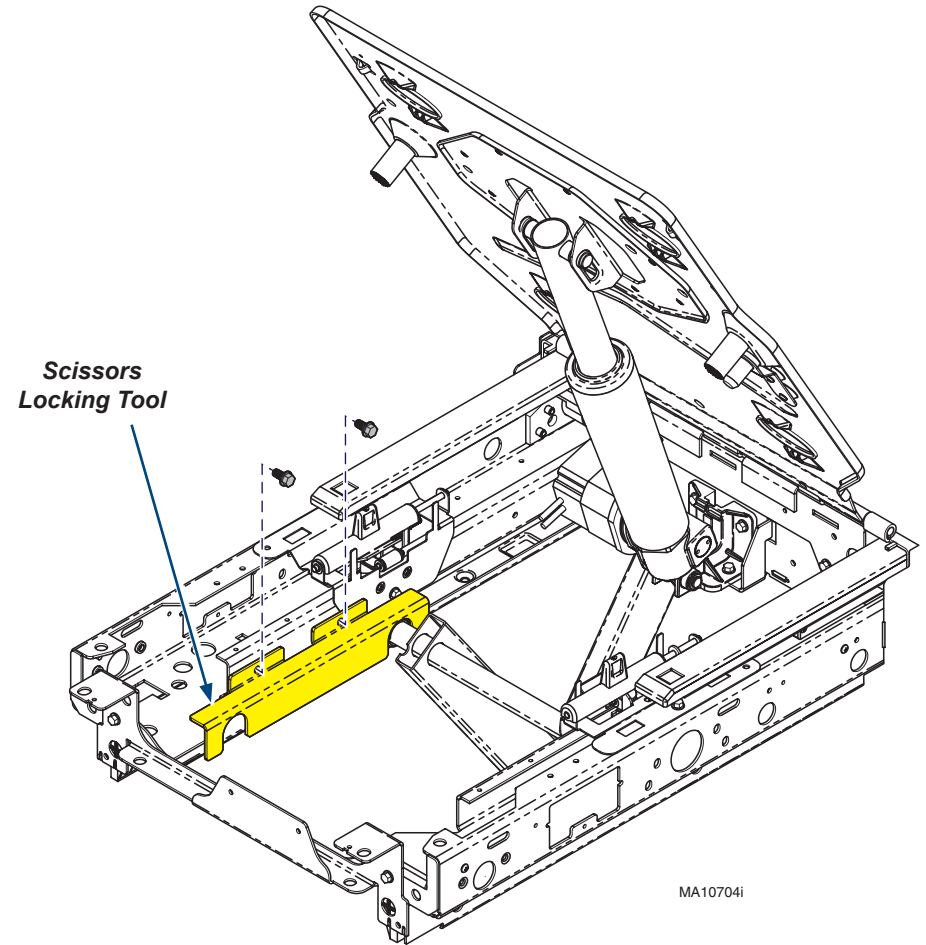

Equipment Alert

Failure to remove the Scissors Locking Tool after Base Actuator Repair could cause damage to the chair.

Actuator Replacement...



Equipment Alert

Do not move chair past limit switches or equipment could be damaged.

Step 9: Remove Base Actuator.

- A) Remove two bolts from Thru Block Weldment.
- B) Lower Ball Screw Assembly by using the base lower function, or manually running the motor clockwise.
- C) Remove the bolt and base actuator pin.
- D) Disconnect wires and remove Base Actuator.
- E) If replacing just the motor proceed to step 10 if replacing the entire actuator assembly proceed to step 11.

Note: The Base Actuator can be raised and lowered by removing the Motor Access Cover and using a drill, 3/16 allen bit and extension. Reverse (CCW) to raise actuator. Forward (CW) to lower actuator.

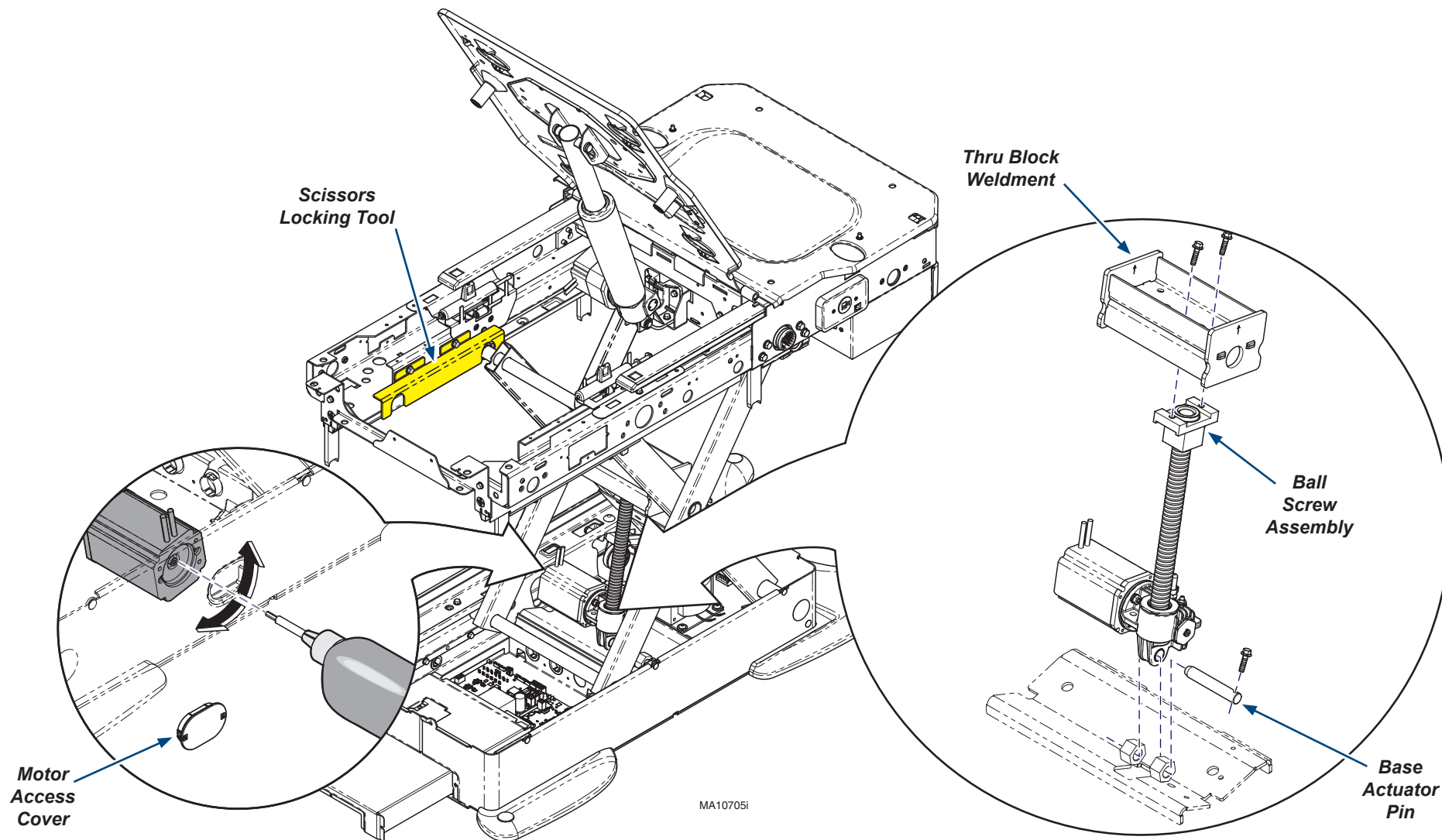

Motor Replacement...

Step 10: Replace Base Actuator Motor.

- A) Remove motor from actuator by removing two Nuts, Washers, and Isolators.
- B) Align Coupler, install new motor, reuse spacer and two isolators, and Washers
- C) Install new Nuts and tighten until Isolator compresses slightly around the washer. Do not over tighten.

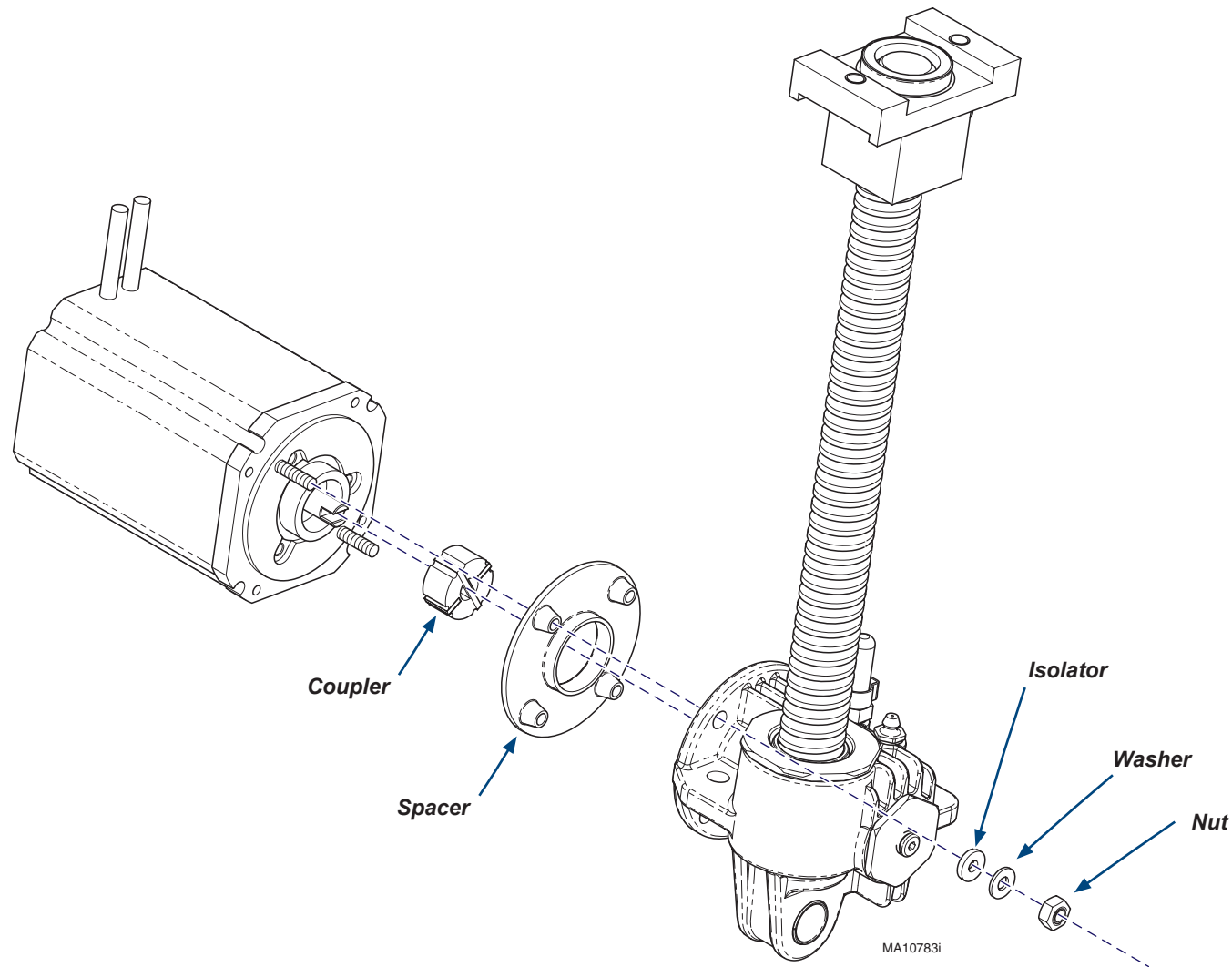

Reassembly



Equipment Alert

Make sure the arrows on the Thru Block Weldment are pointing upward when installing the base actuator or the base will not lower properly.



Equipment Alert

The Ball Screw Assembly Tube must be installed with the Tube facing the foot end of the chair.



Equipment Alert

Failure to remove the Scissors Locking Tool after Base Actuator Repair could cause damage to the chair.

Scissors
Locking Tool

Control Board
Housing Cover

MA10782i

Thru Block
Weldment
Arrow

Ball
Screw
Assembly
Tube

View From
Foot End

Base
Actuator
Pin

Step 11: Reassemble Chair with New Base Actuator/Motor (Reverse Order).

- Install Base Actuator and secure with Base Actuator Pin and bolt. Connect motor wires.
- Rotate Ball Screw Assembly so that the tube faces the foot end of the chair, and raise using the base up function, or manually running the motor counter clockwise.
- Secure Ball Screw Assembly to the Thru Block Weldment with the two bolts. Make sure the arrows are facing up on the Thru Block Weldment.
- Remove two bolts holding the Scissors Locking Tool in place and remove.
- Install PCB Shelf Assembly.
- Install Inner and Outer Shrouds, Control Board Housing Cover and the Drawer.
- Install Rear Cladding, Side Cladding and Top Cover.
- Proceed to chair calibration shown on next page.

Chair Position Calibration Procedure

Step 1:

- A) Power up chair.
- B) Locate the Diagnostic PC Board.

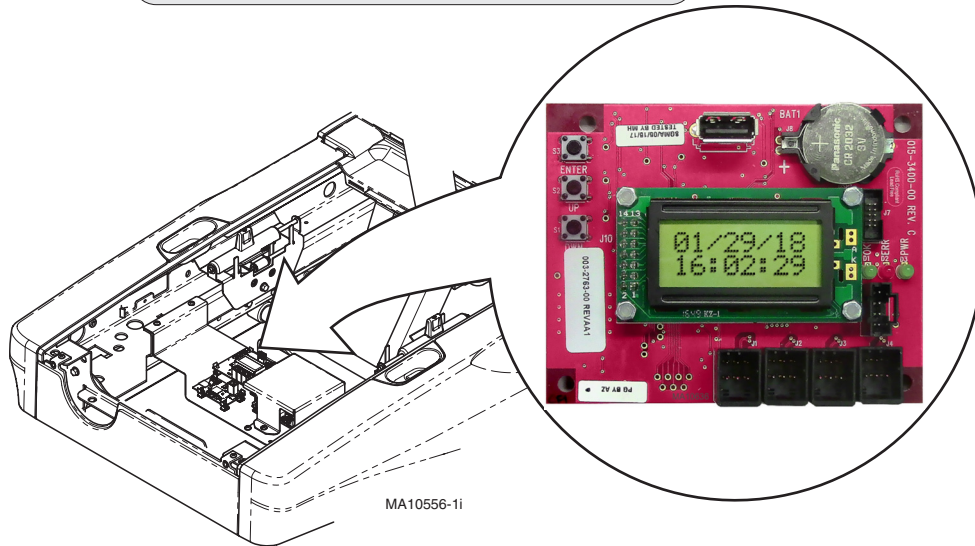

Step 2:

- A) Press and release the UP or DOWN button until "POSITION CALIBRAT(ion)" is displayed.

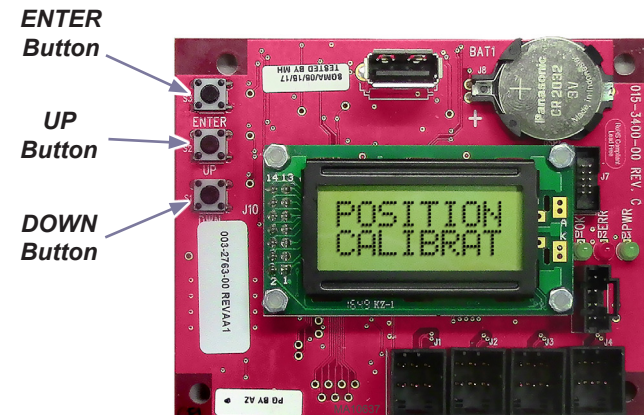

Step 3:

- A) Press ENTER button once. The display will show "CALIBRAT(ion) Start".
- B) Press ENTER button again. The chair base and back will start to cycle up and down and the display will show "CALIBRATING (Scrolling) POSITION."
- C) You will hear a steady pattern of "beeps." When calibration is completed you will hear three short beeps and the display will show "CALIBRAT COMPLETE."

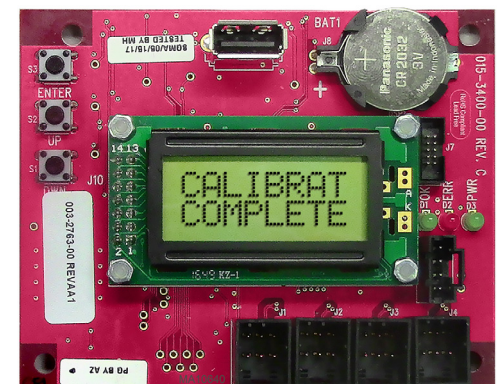
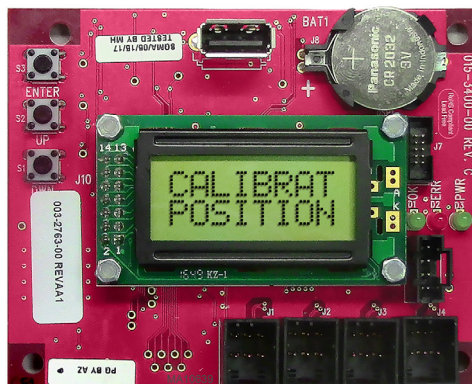
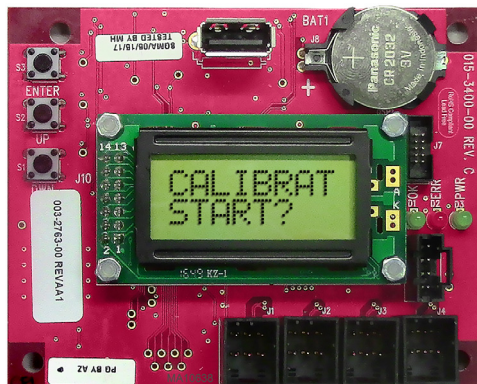

Programmable 'Home' Function

The Home function automatically commands the chair to a programmed position. The Home function is factory preset to automatically raise or lower the chair height to 17 inches (43 cm) and raise the Back angle to 80 degrees.

Note

An audible tone will sound when the Home button is pressed to indicate auto-movement.

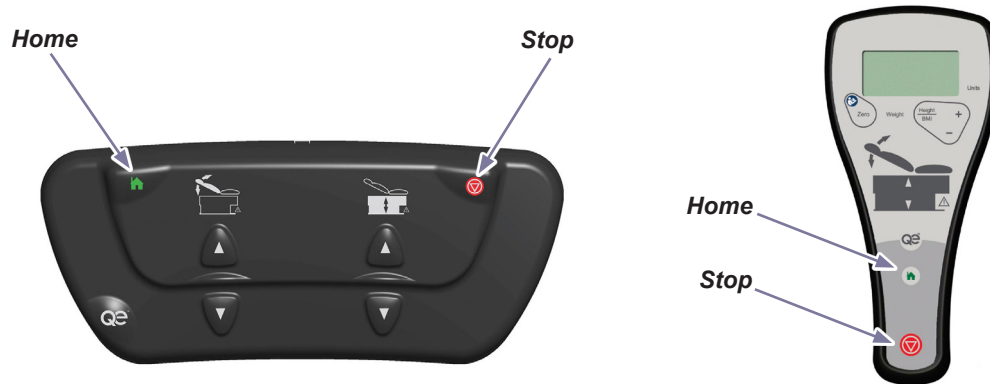

To program the Home function...

- Press the Base Up / Down button to move the Base to the desired height.
- Press the Back Up / Down button to move the Back to the desired angle.
- Press the Stop button, then the Home button and hold simultaneously for three to four seconds.

Note: You will hear an audible tone when the new 'Home' position is saved.

To activate the Home function...

Press and release the Home button.

Note: At any time, ANY button can be pressed to terminate movement.



Equipment Alert

Controllers must be within a Fifteen foot radius of chair to be able to command the chair.

Quick Exam® Function

The Quick Exam function automatically commands the chair to a programmed position. The Quick Exam function is factory preset to automatically raise or lower the chair height to 34 inches (86 cm) and raise the Back angle to 80 degrees.

Note

An audible tone will sound when the Quick Exam® button is pressed to indicate auto-movement.

To activate the Quick Exam function...

Press and release the Quick Exam button.

Note: At any time, ANY button can be pressed to terminate movement.

To program the Quick Exam function...

- Press the Base Up / Down button to move the Base to the desired height.
- Press the Back Up / Down button to move the Back to the desired angle.
- Press the Stop button, then the Quick Exam button and hold simultaneously for three to four seconds.

Note: You will hear an audible tone when the new Quick Exam position is saved.

