

## Step 1:

Turn off, unplug and open door to unit.



### Caution

Always disconnect power from unit before opening or removing covers to perform any service to unit.

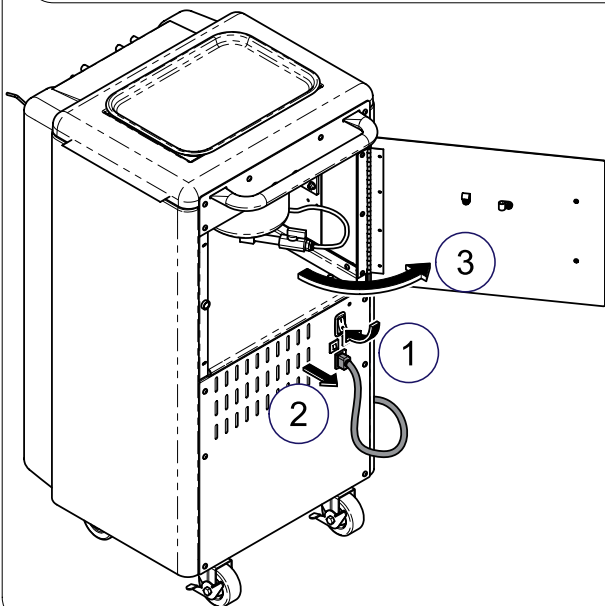

## Step 2:

Remove regulator bowl and remove o-ring. Remove filter from regulator.

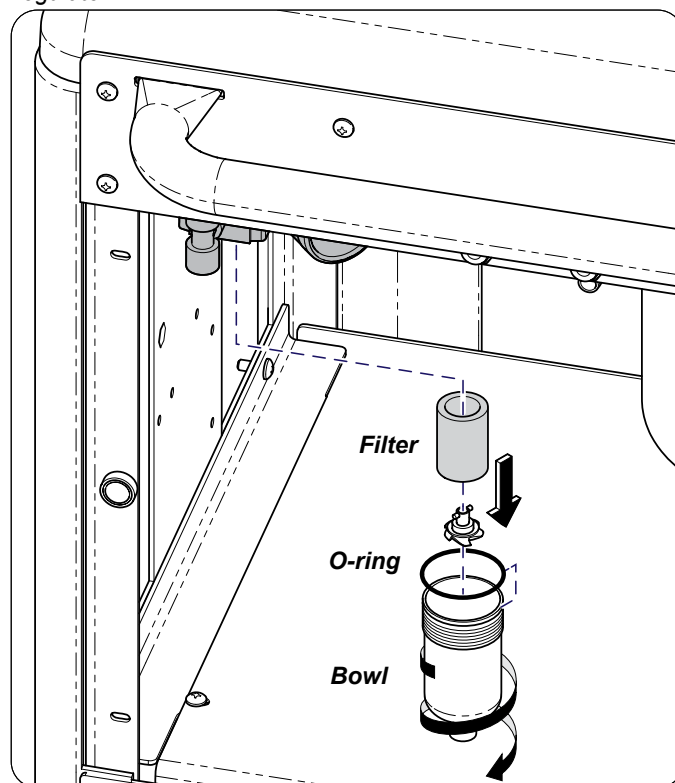

## Step 3:

Install replacement filter. Install replacement o-ring and place regulator bowl onto regulator.

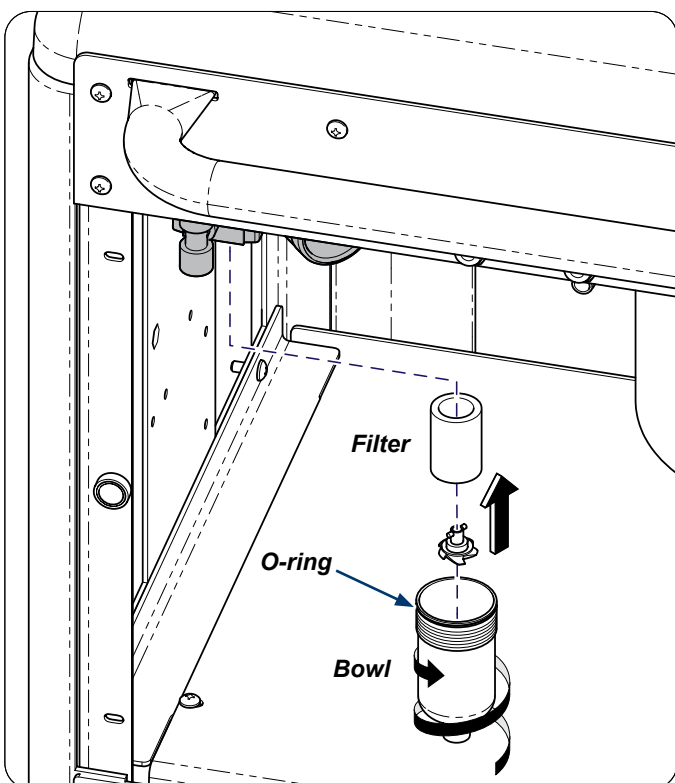

## Step 4:

Remove screws (6) and back cover.

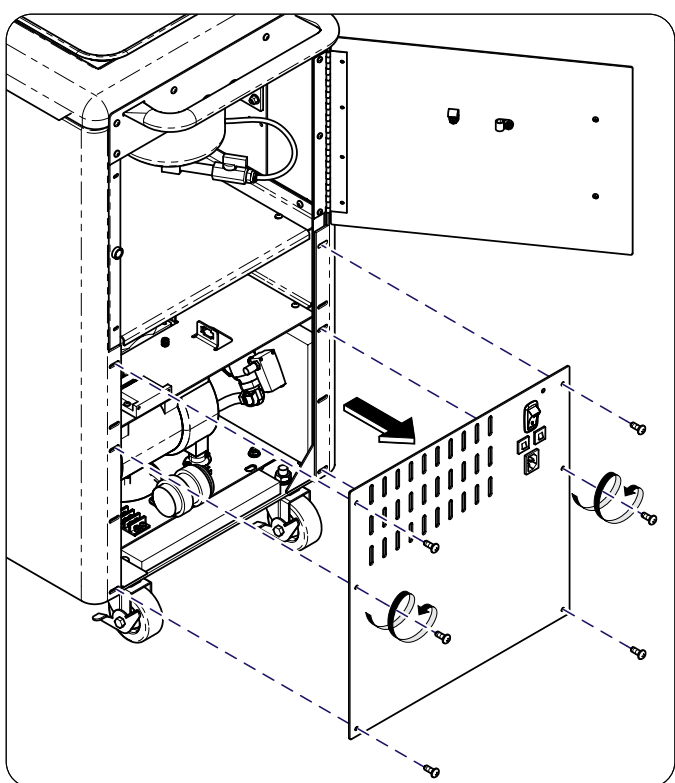

**Step 5:**

Remove bronze muffler from unit.

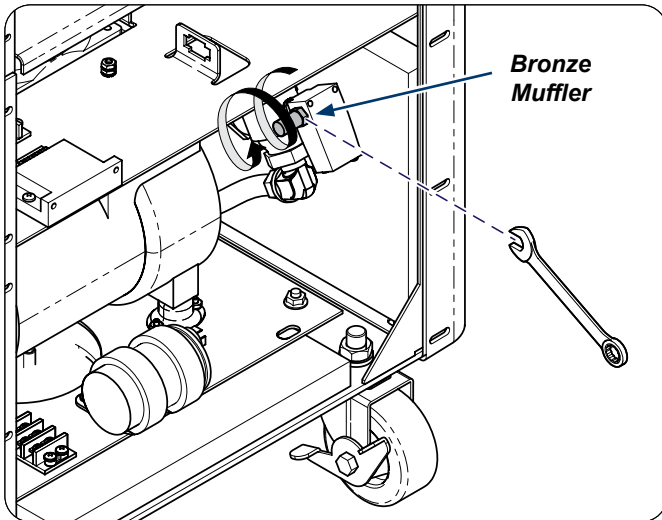
**Step 6:**

Install replacement bronze muffler onto unit.

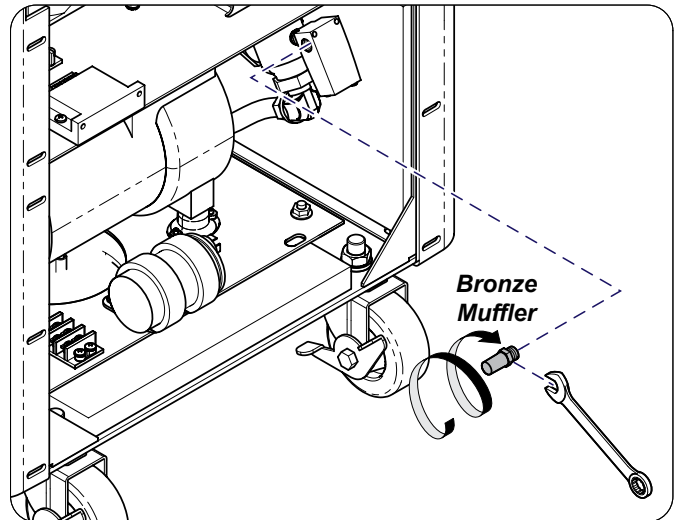
**Step 7:**

Remove plastic muffler and filter.

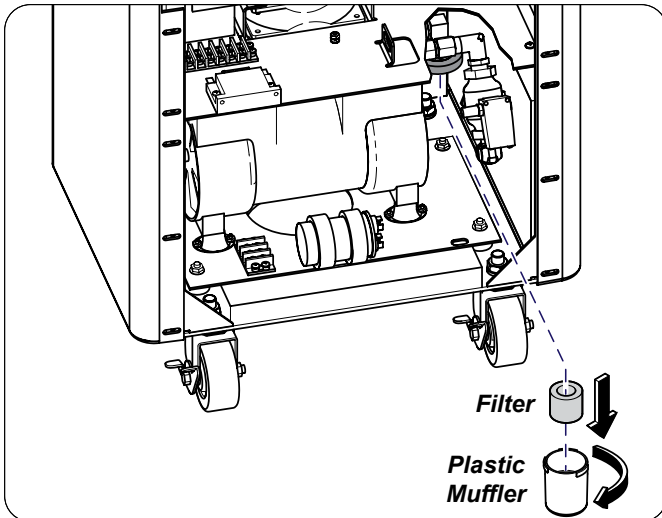
**Step 8:**

Install replacement filter into plastic muffler and secure onto cap.

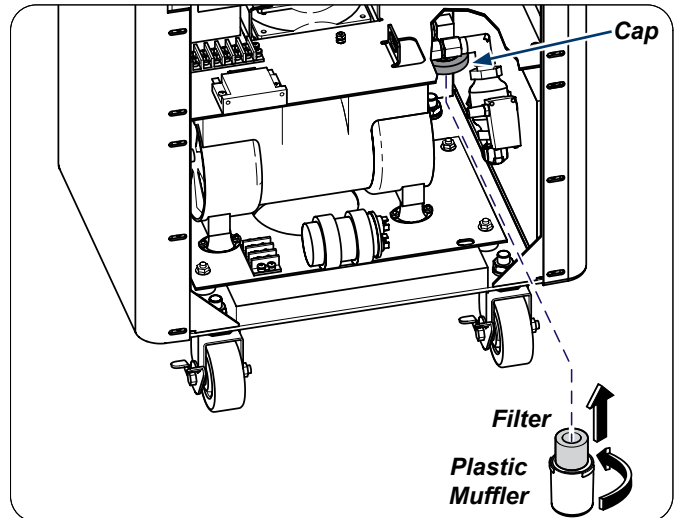
**Step 9:**

Install base cover and secure with screws (6).

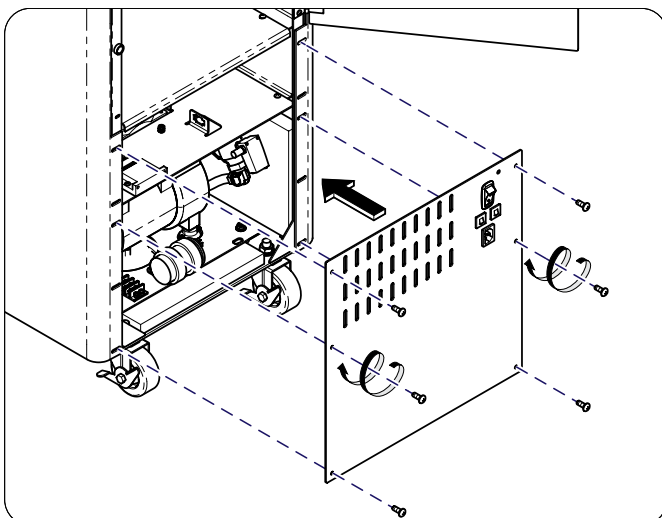
**Step 10:**

Close door, plug in unit and turn on for use.

