

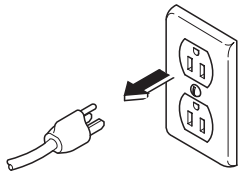

Caution

Always disconnect power to chair before removing covers or performing any service procedures.



Equipment Alert

You must perform Step 2 before cover can be completely removed.

Step 1: Remove two screws, then partially separate cover.

Step 3: Remove wire harness cover. (if necessary)

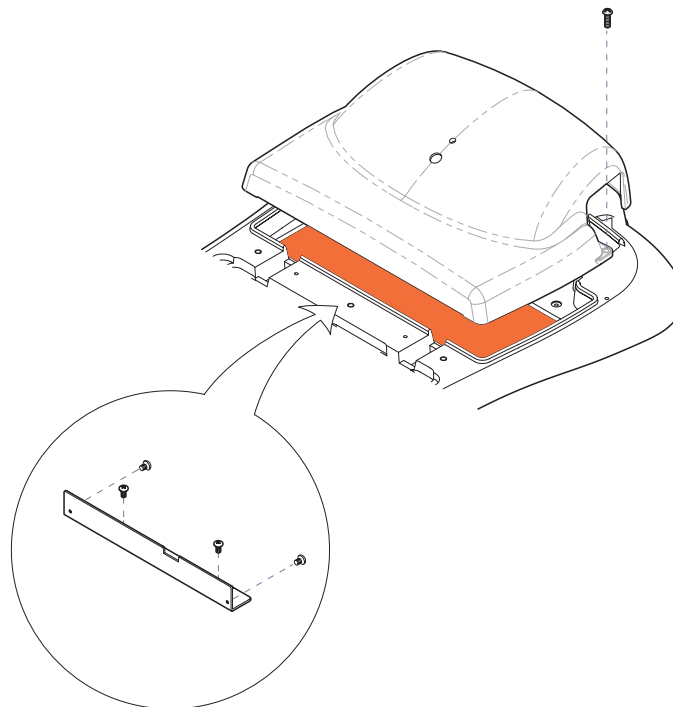

Step 2: Disconnect Power Light harness.

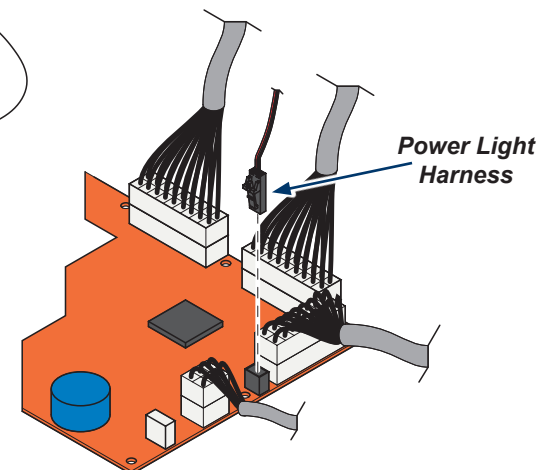



Equipment Alert

Ensure harness connections are tagged for correct installation.
Failure to do so could result in damage to PC Board.

Step 4: Tag and disconnect wires from PC Board.

Step 5: Remove screw to disconnect ground wire from base.

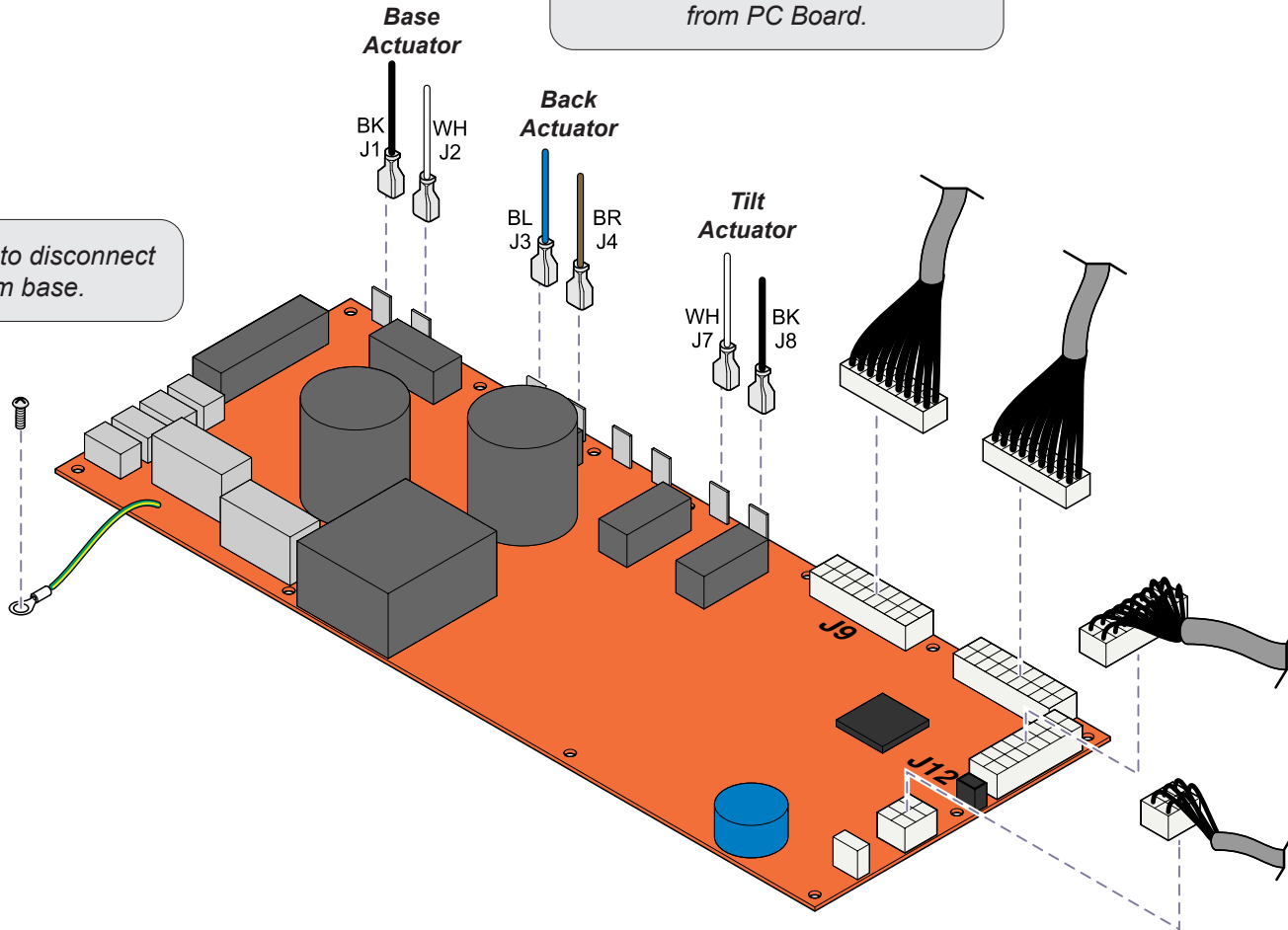



Equipment Alert

Anytime the PC Board is removed you **must** perform the Calibration Procedure. Failure to do so will cause the chair to malfunction.

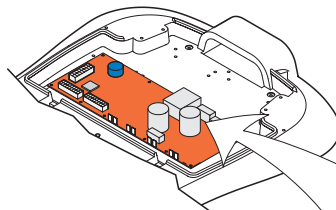

Step 6: Remove PC Board.

- A) Press standoff tabs away from PC Board and lift up.
- B) Remove PC Board.

Standoff
Tab

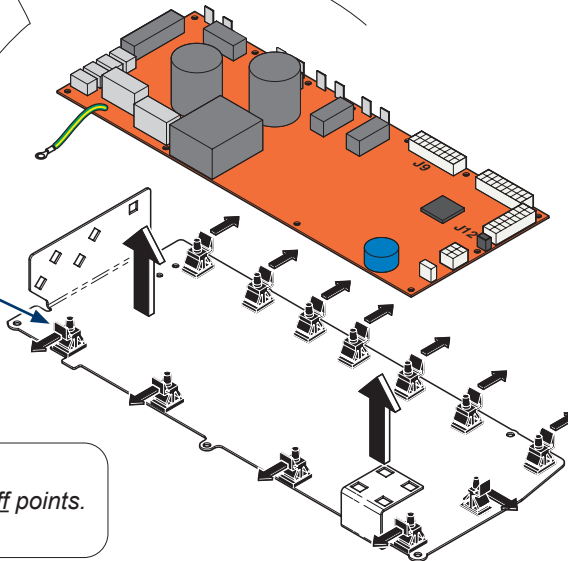

Equipment Alert

When installing new PC Board, only apply pressure at Standoff points. Failure to do so could result in damage to PC Board.



Equipment Alert

Ensure motor harness connections are correct. Failure to do so could result in damage to PC Board.

Step 7: Install New PC Board.

- A) Position the PC Board on the standoffs as shown and press down to secure.
- B) Plug harness connections back into PC Board and connect ground wire to base.
- C) Perform Calibration Procedure (shown on next page).

PC Board Calibration



Equipment Alert

Anytime the PC Board is removed you **must** perform the Calibration Procedure. Failure to do so will cause the chair to malfunction.



Equipment Alert

Check voltage settings on position sensors and that actuator wires are properly connected prior to calibrating. Failure to do so may result in damage to the PC Board and/or mechanical components.

Step 1: Check Position Sensors.

- A) Check voltage settings on position sensors.
- B) Check that actuator wires are properly connected prior to calibrating.

Note

Ensure foot section is in the stowed position.

Step 2: Put PC Board into Calibration Mode.

- A) Move MODE SELECT switch 1 to ON (up).
- B) Move MODE SELECT switch 2 to OFF (down).

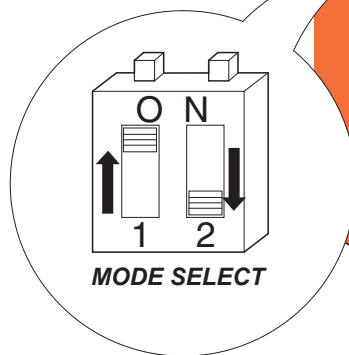

Step 4: Calibrate PC Board.

Wait five seconds, then press and release S2 button.

Note: During calibration, you will hear a steady pattern of “beeps” as each function moves. When successful calibration is complete, the chair will stop moving, and you will hear three “beeps”.

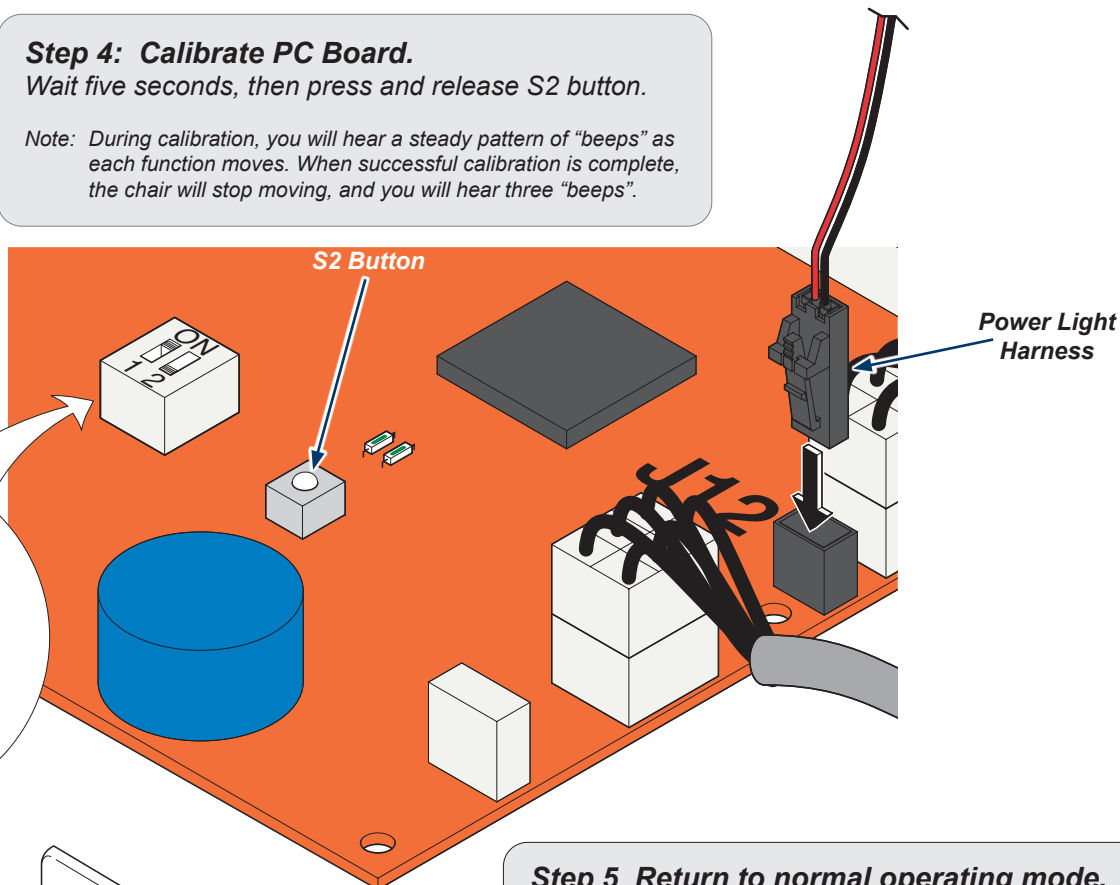

Step 3: Reset PC Board.

- A) Unplug chair for a few seconds.
- B) Plug chair back in.

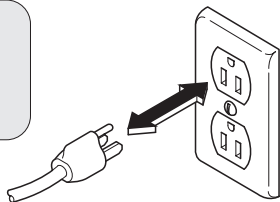

Step 5 Return to normal operating mode.

- A) Move MODE SELECT switches back to original position.
- B) Unplug chair (to reset PC Board).
- C) Connect Power Light harness.
- D) Reinstall covers.
- E) Plug chair back in.

PC Board Cover (models w/ Rotational Base)

Removal / Installation



Caution

Always disconnect power to chair before removing covers or performing any service procedures.



Equipment Alert

You must perform Step 2 before cover can be completely removed.

Step 1: Remove two screws, then partially separate cover.

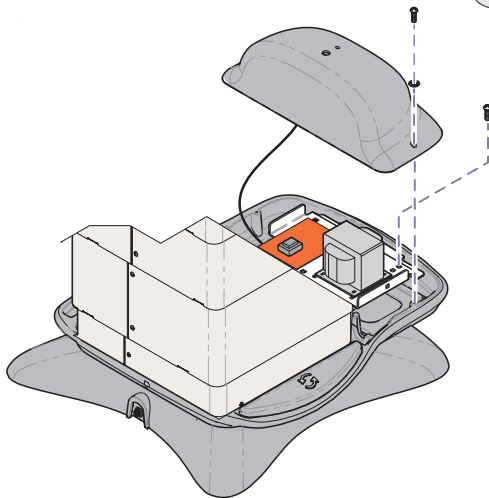

Step 2: Disconnect Power Light harness.

Step 3: Remove two screws from transformer mounting plate.

Step 4: Pull transformer mounting plate out to disengage tab. Prop mounting plate up behind two standoffs as shown.

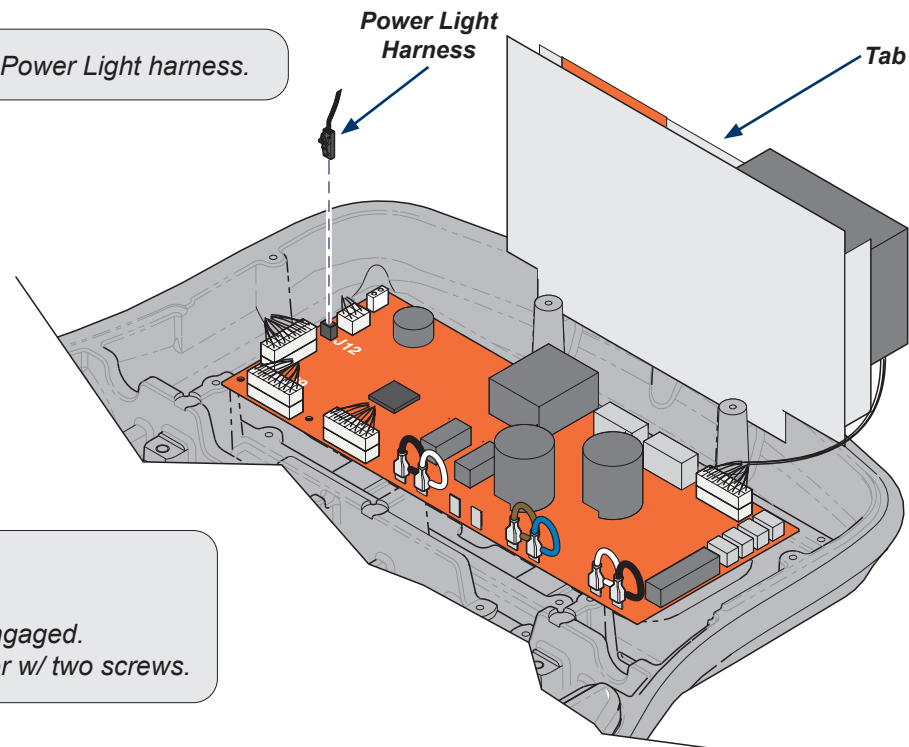

Step 5: Installation.

- A) Connect Power Light harness to J12 on PC Board.
- B) Position transformer mounting plate so that tab is engaged.
- C) Secure transformer mounting plate and secure cover w/ two screws.