

Midmark® 1000 Solenoid Kit (002-10452-00 & 002-1148-00)



Step 1:

Turn off and unplug unit.



Caution

Always disconnect power from unit before opening or removing covers to perform any service to unit.

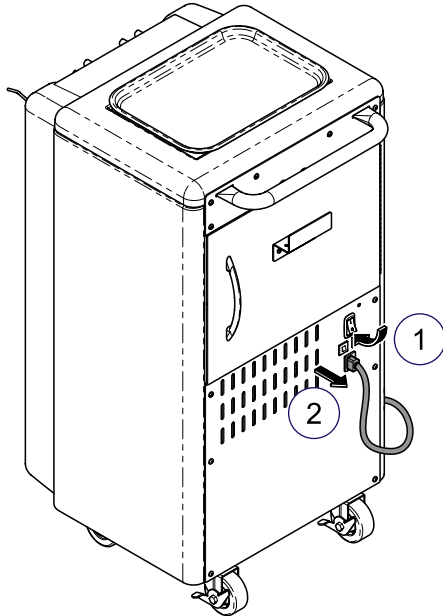

ArtSU3

Step 2:

Remove screws (4) from control panel, screws (2) and top cover, screws (6) and back cover, screws (3) and side cover & insulation.

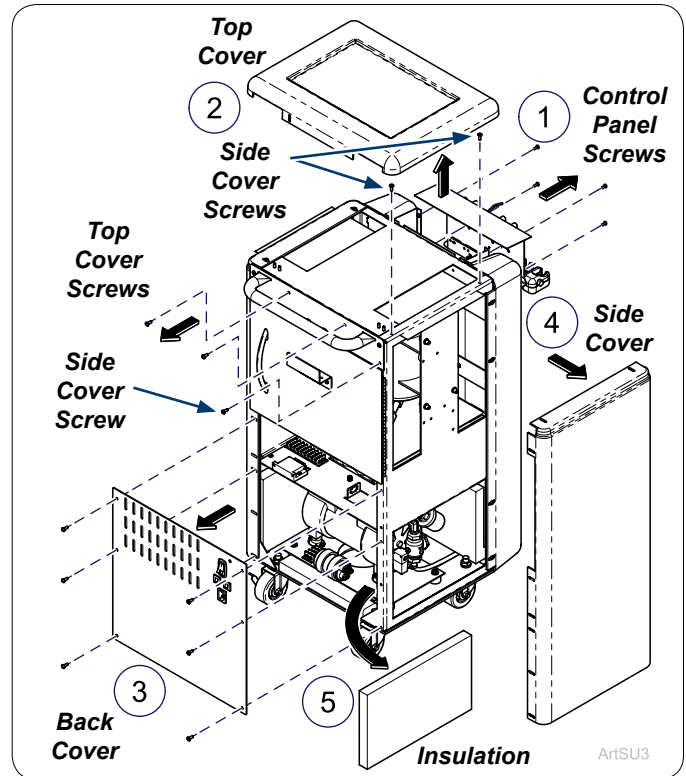

ArtSU3

Step 3:

Unplug and remove solenoid and pipe nipple from check valve and set aside.

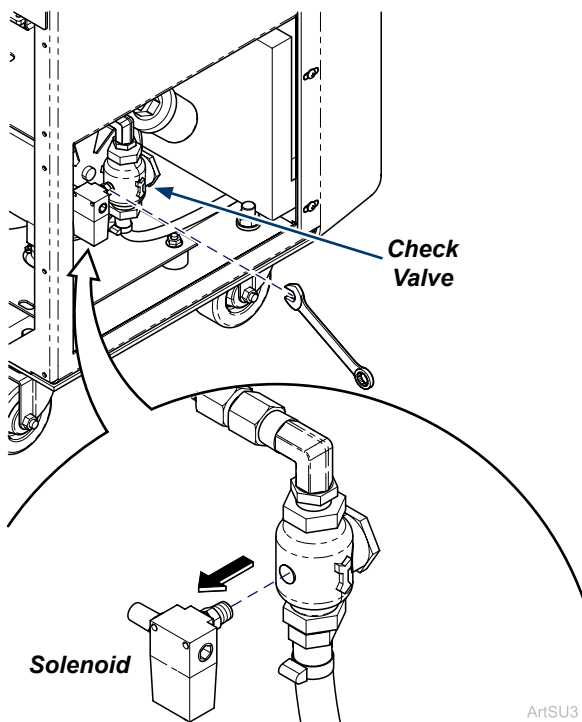

ArtSU3

Step 4:

Remove barb fitting and tubing from check valve.

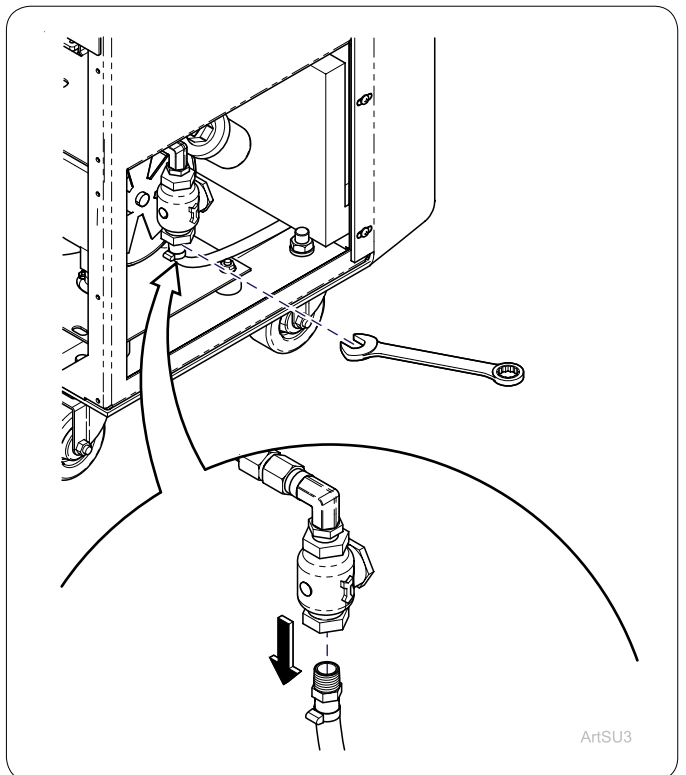

ArtSU3

Step 5:

Adjust elbow and check valve by rotating roughly 45 degrees as shown.

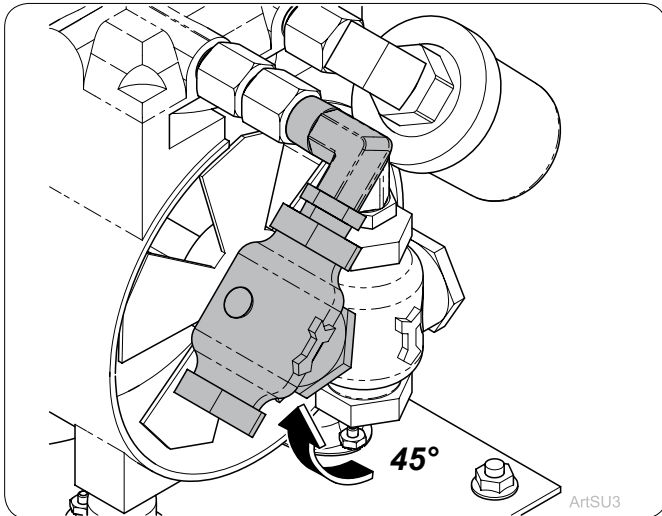
**Step 6:**

Install elbow from kit into check valve and install barb fitting with tubing onto elbow.

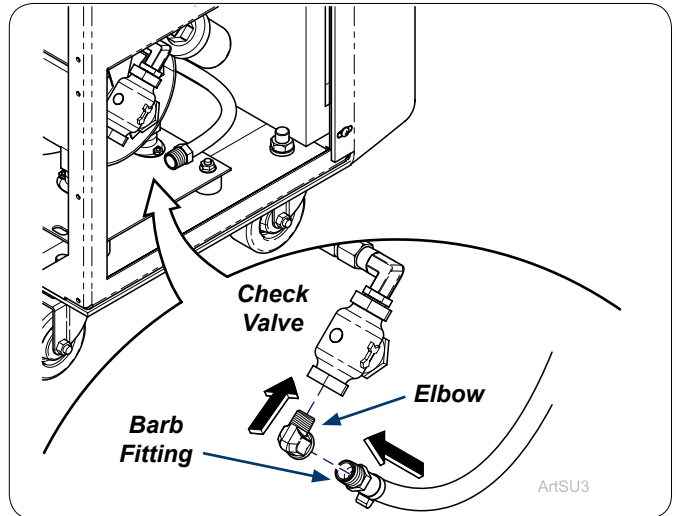
**Step 7:**

Assemble pipe nipple and hole plug onto solenoid. Remove bronze muffler from old solenoid and install onto new solenoid.

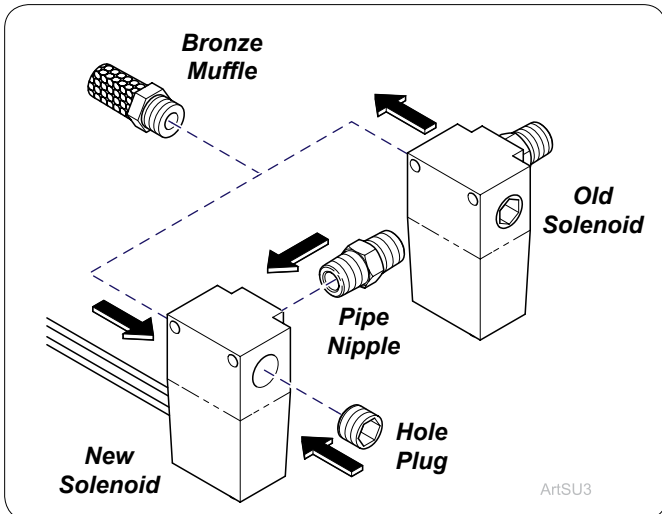
**Step 8:**

Install solenoid with pipe nipple to check valve.

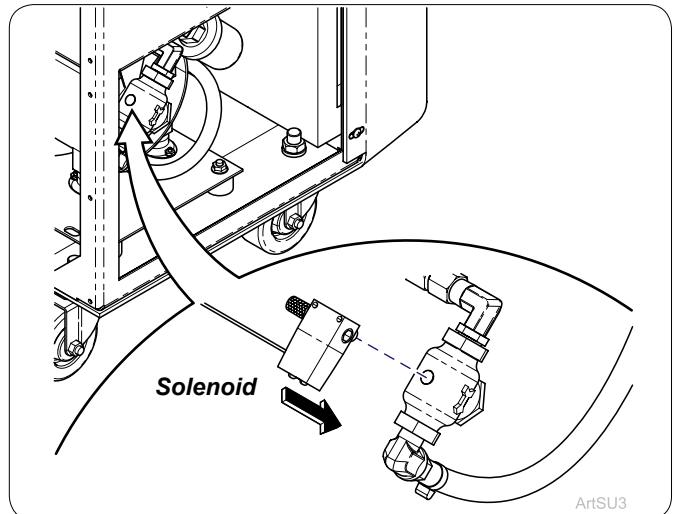
**Step 9:**

Install insulation, side cover with screws (3) top cover with screws (2), control panel with screws (4), & back cover with screws (6).

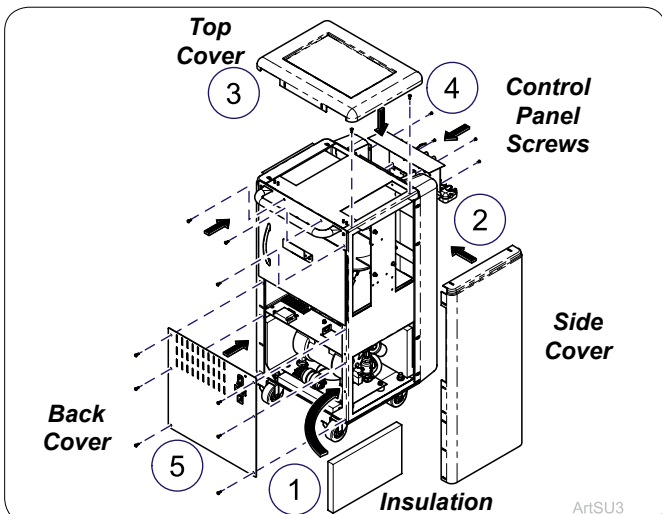
**Step 10:**

Plug in unit and turn on.

