

# Column Assembly Replacement Kit [002-10507-xx]

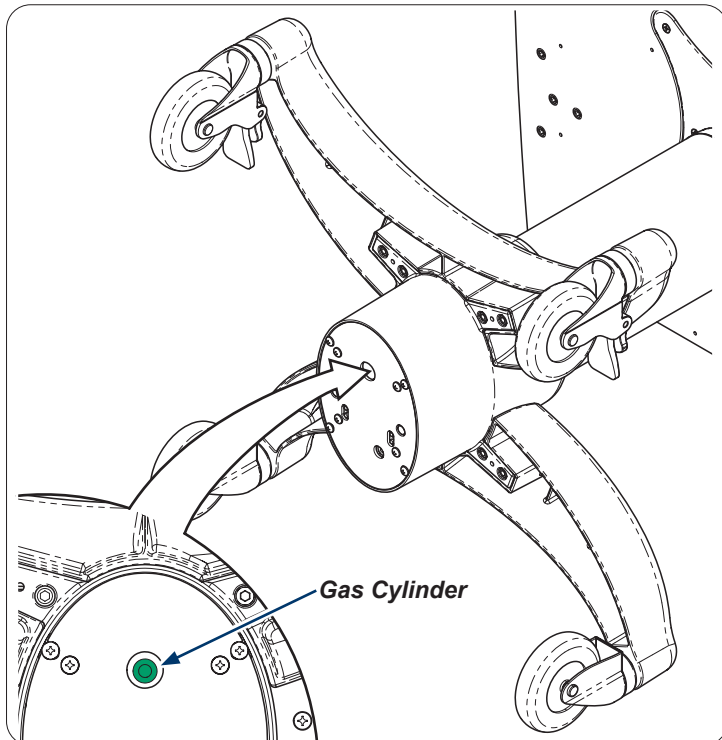

## Step 1:

If possible compress column to lowest position to verify correct kit by matching color on bottom of gas cylinders.



## Step 3:

Remove screws (3) from hand actuator assembly to remove from worksurface or mouse tray.

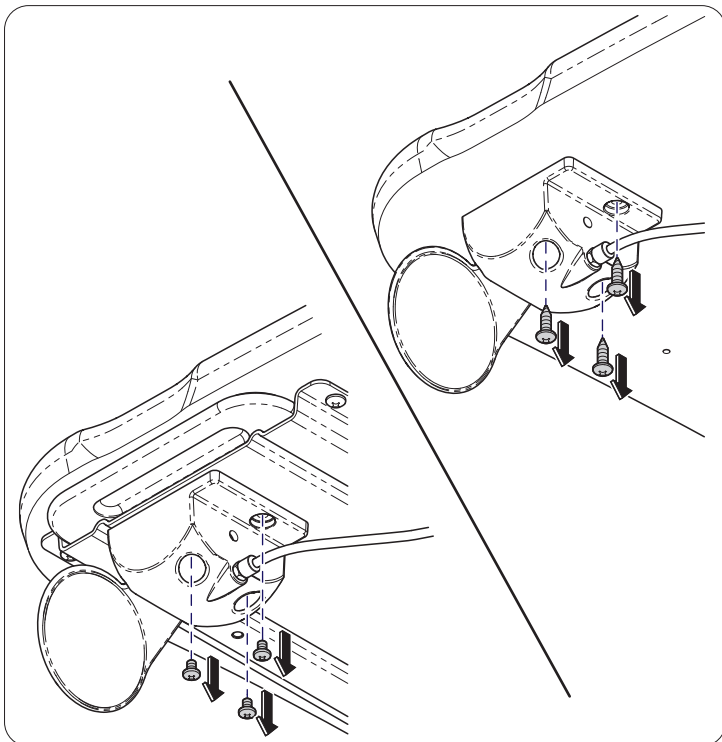

## Step 2:



### WARNING

Raise workstation to highest position. If workstation cannot be raised to highest position, proceed with caution. Pressurized gas cylinder assembled in this workstation.

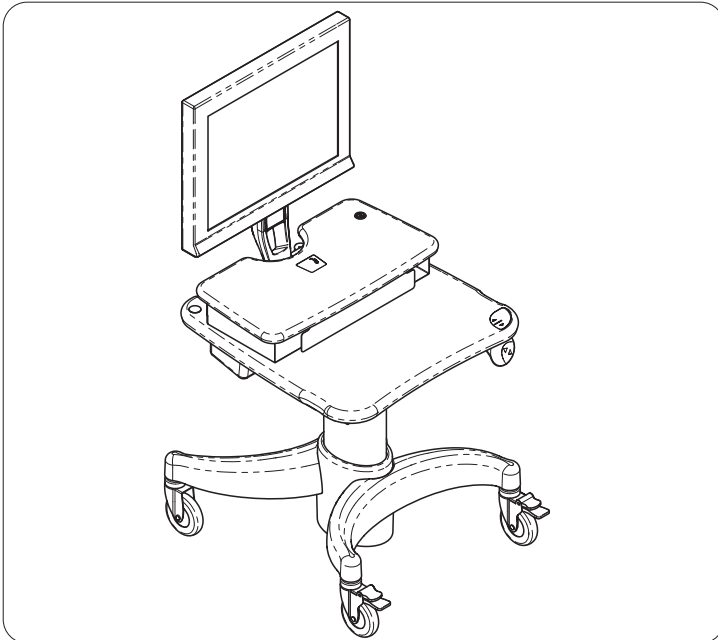

## Step 4:

If necessary remove any accessories blocking access to mounting plate. Refer to [www.midmark.com](http://www.midmark.com) for any accessory for removal as needed.

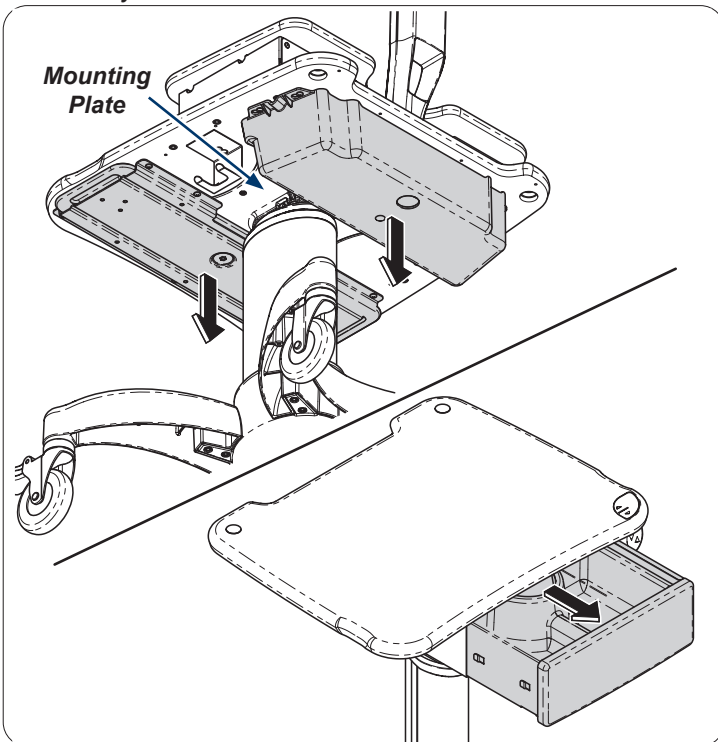

**Step 5:**

Remove screws (6) and worksurface from mounting plate.

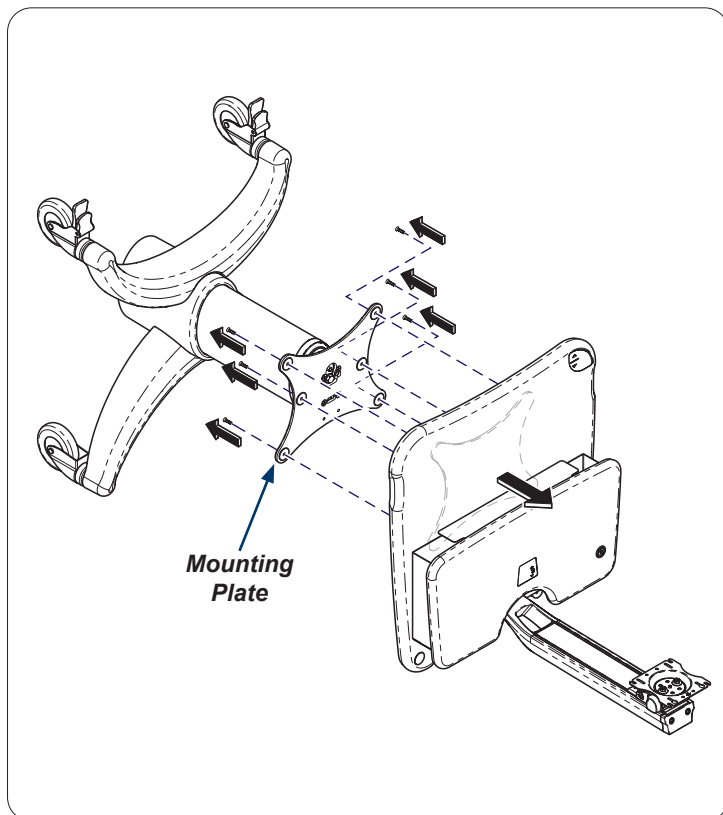
**Step 6:**

If necessary remove any accessories and attached collars from column. Refer to [www.midmark.com](http://www.midmark.com) for any accessory for removal as needed.

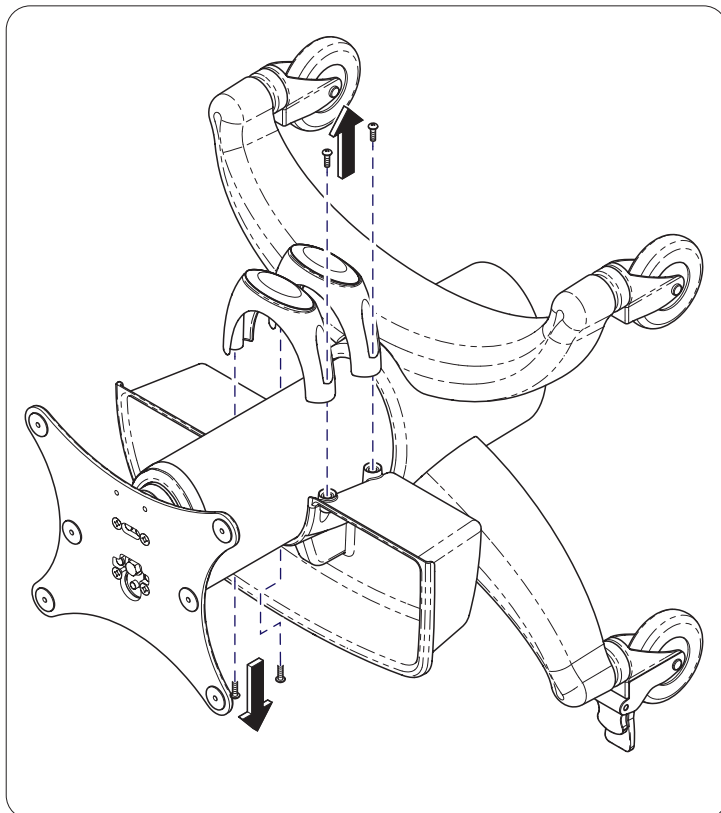
**Step 7:**

Remove inner screws (4) from non functioning column at the bottom of workstation. Leave base plate and outer screws (4) into base assembly.

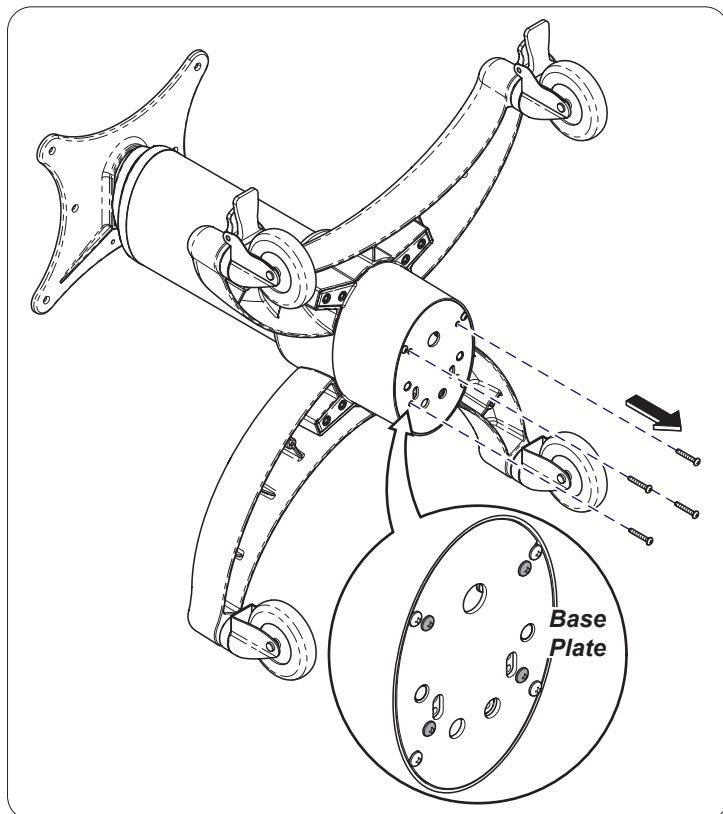
**Step 8:**

Remove non functioning column assembly by shaking column loose from base assembly. Remove screws (4) and mounting plate from column assembly.

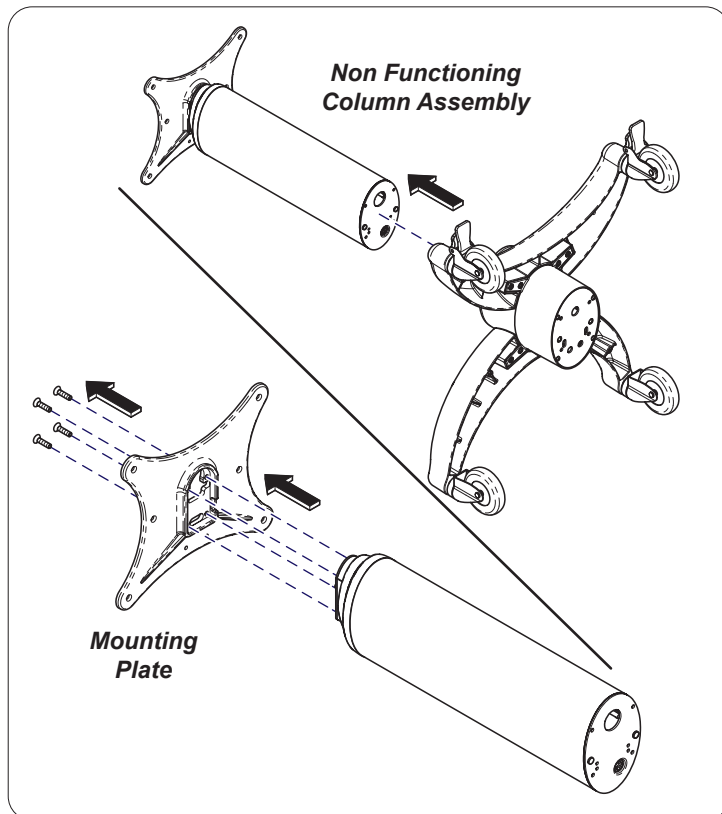

**Step 9:**

Install new column assembly into base assembly of workstation with screws (4).

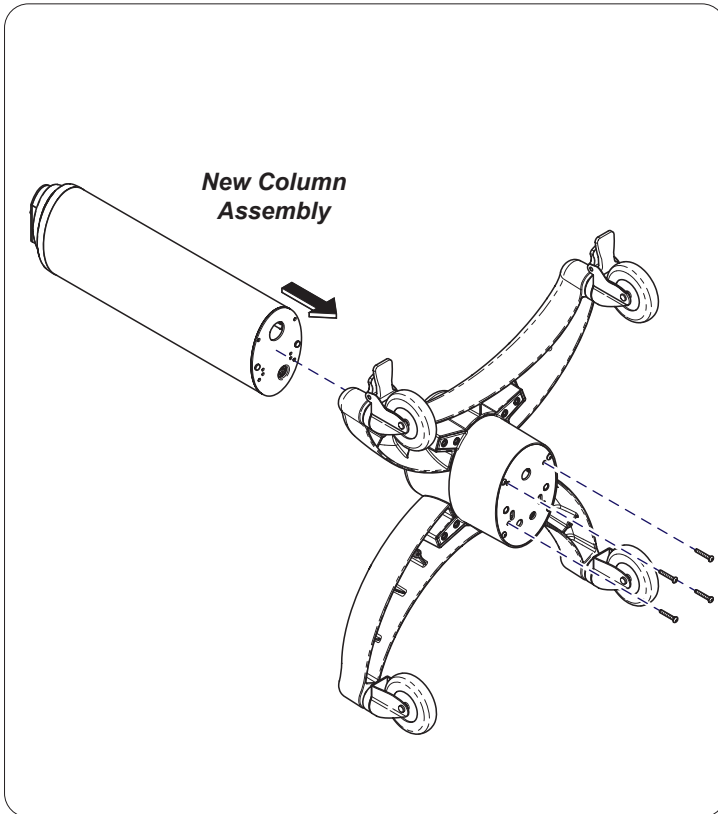
**Step 10:**

Install mounting plate to top of workstation with screws (4). Raise column to max height to install new gas cylinder.

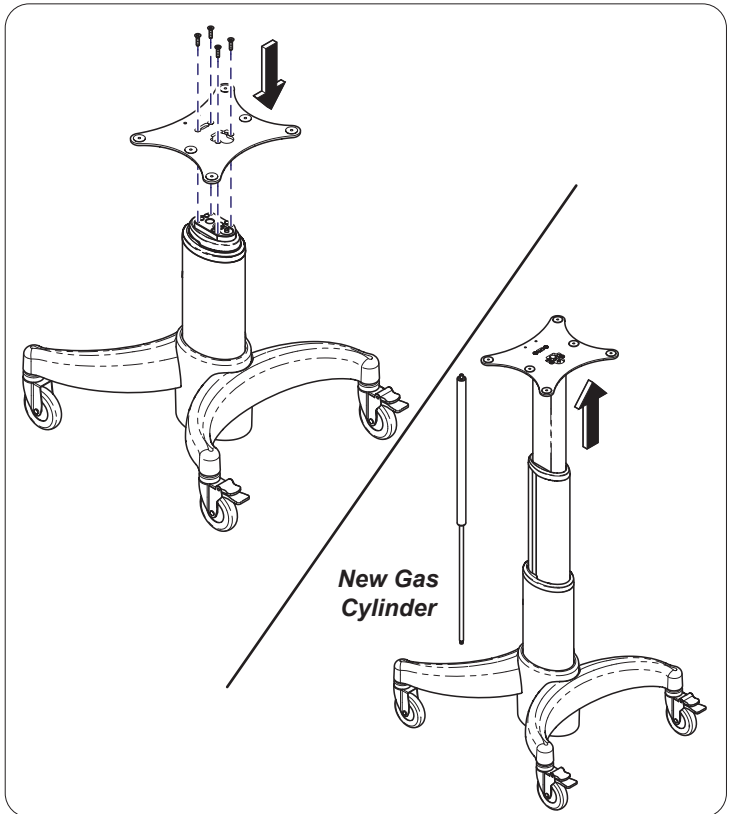
**Step 11:**

Rotate replacement gas cylinder into position in column and tighten. Secure by installing compression plate washer and bolt.

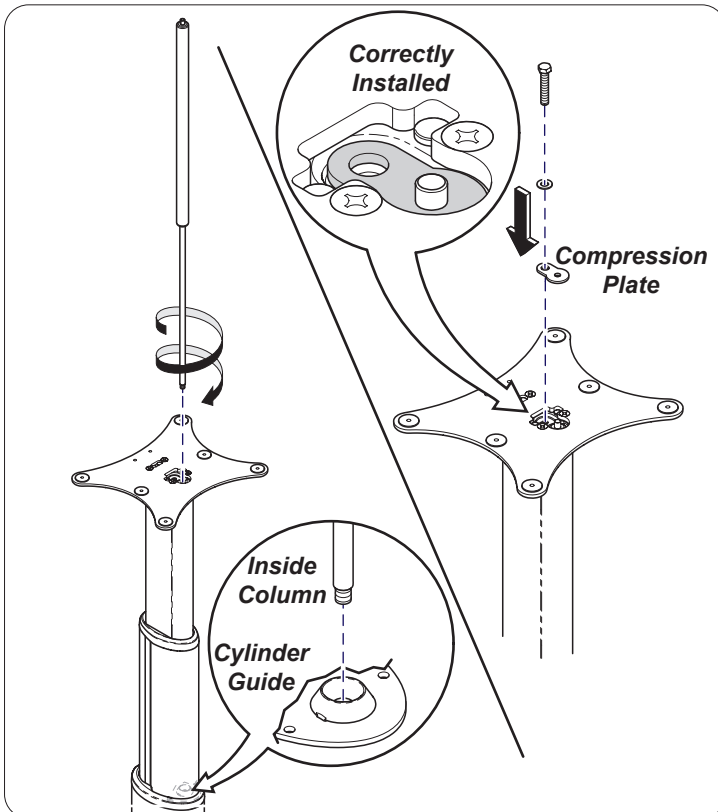
**Step 12:**

Secure worksurface to mounting plate with screws (6).

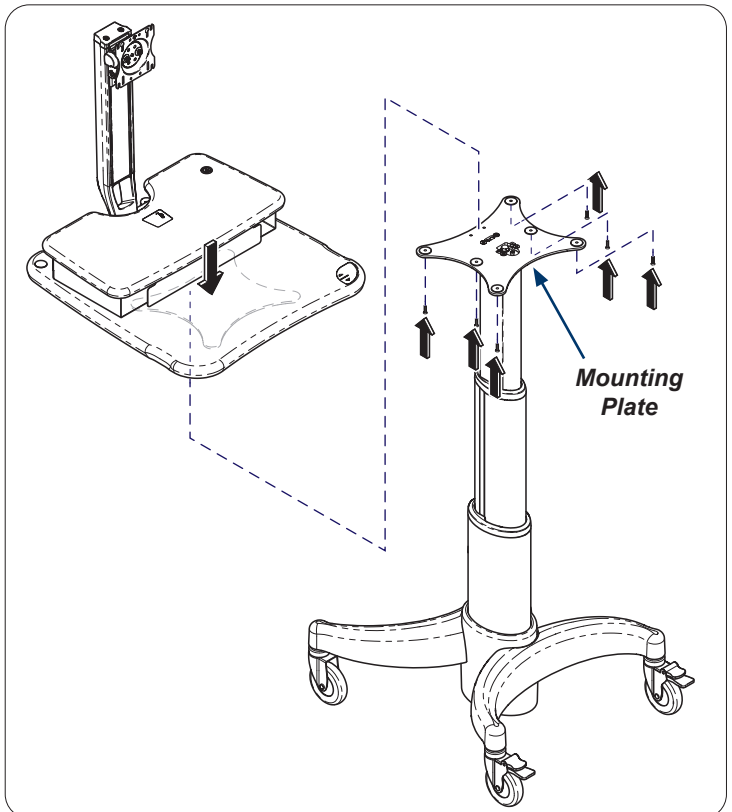

**Step 13:**

Install any accessories and attached collars to column. Refer to [www.midmark.com](http://www.midmark.com) for any accessory for installation as needed.

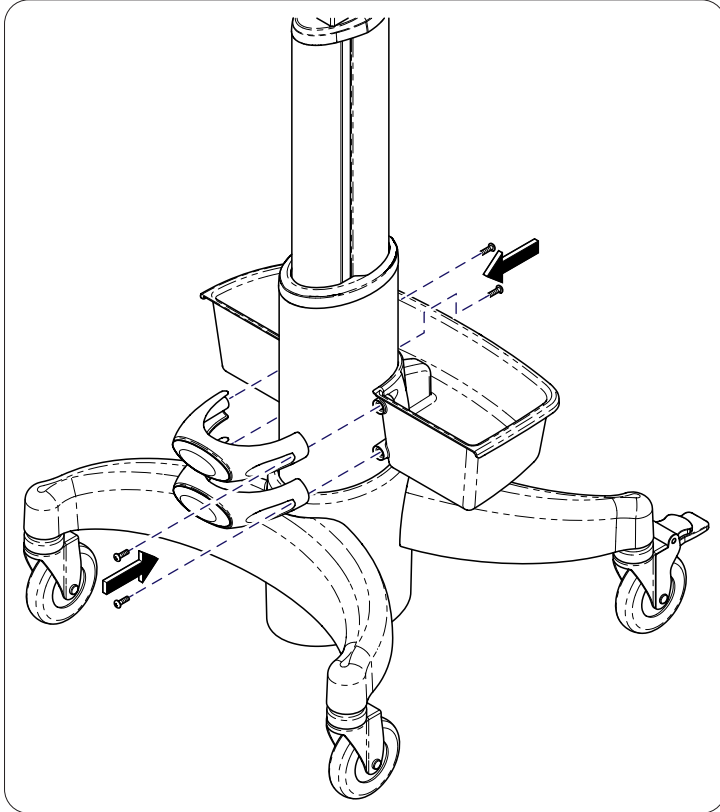
**Step 14:**

If accessories were removed secure as needed into position.

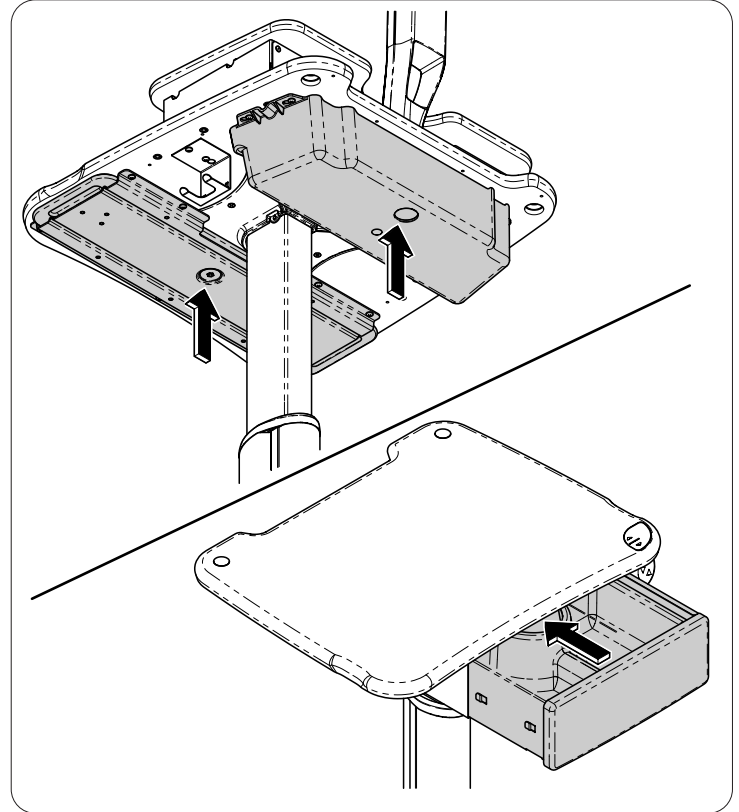
**Step 15:**

Secure hand actuator assembly to worksurface or mouse tray with screws (3).

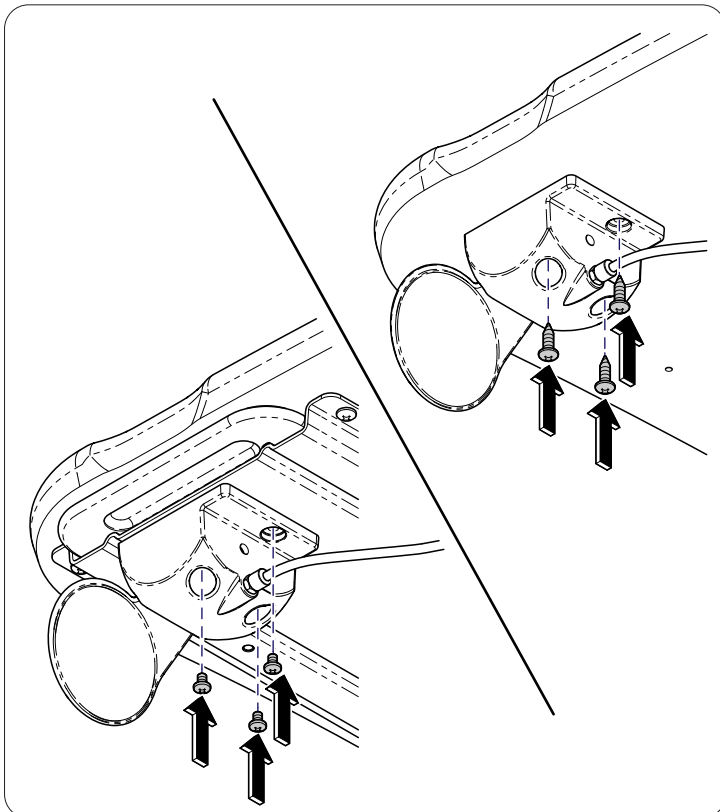
**Step 16:**

Before testing Workstation be sure all components are mounted. Press hand actuator paddle to adjust.

