

Midmark Digital Vitals Signs Device Clamp Installation Instruction [002-10592-00]

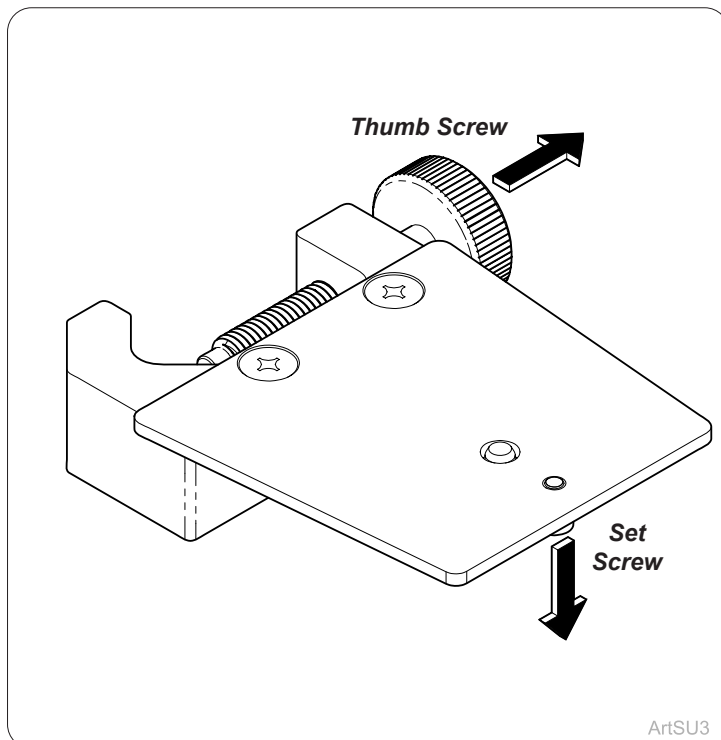

Step 1:

Loosen thumb screw and set screw on clamp.



Step 2:

Assemble Clamp and Digital Vitals Signs Device by sliding onto clamp platform.

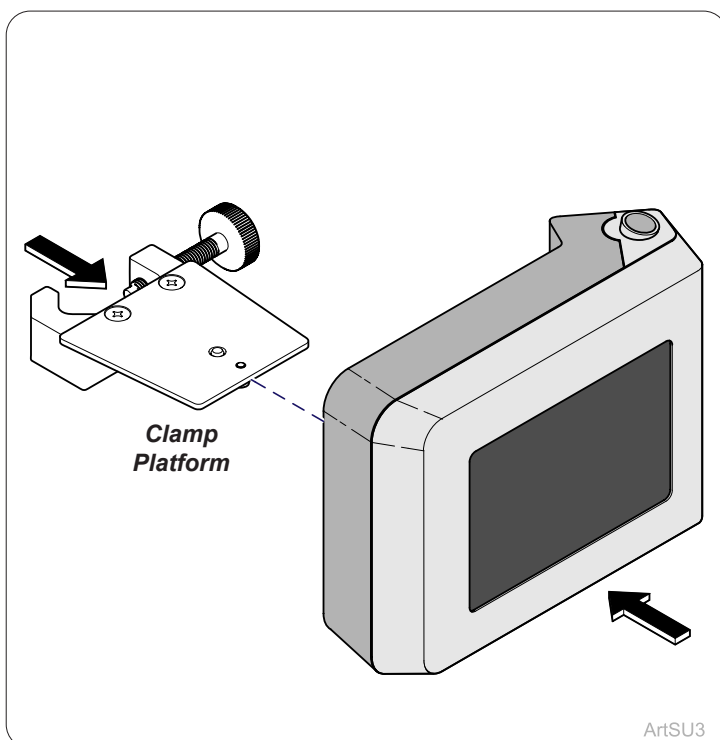

Step 3:

Ensure button snaps into bottom of device and hand tighten set screw may need to tighten with allen wrench.

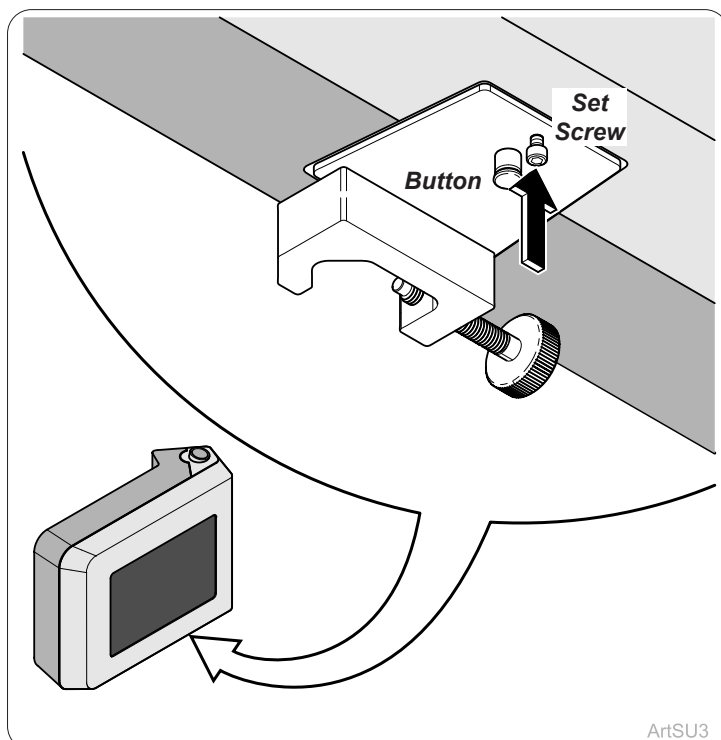

Step 4:

Place clamp onto cuff holder pole and tighten thumb screw.

