

[002-10772-00] L/R Dental Light Kit for Ultra Dental Chair Installation

Contents:
Installation 1-4

Special Tools:
Torque Wrench



Equipment Alert

Midmark recommends two installers to ensure equipment does not get damaged.

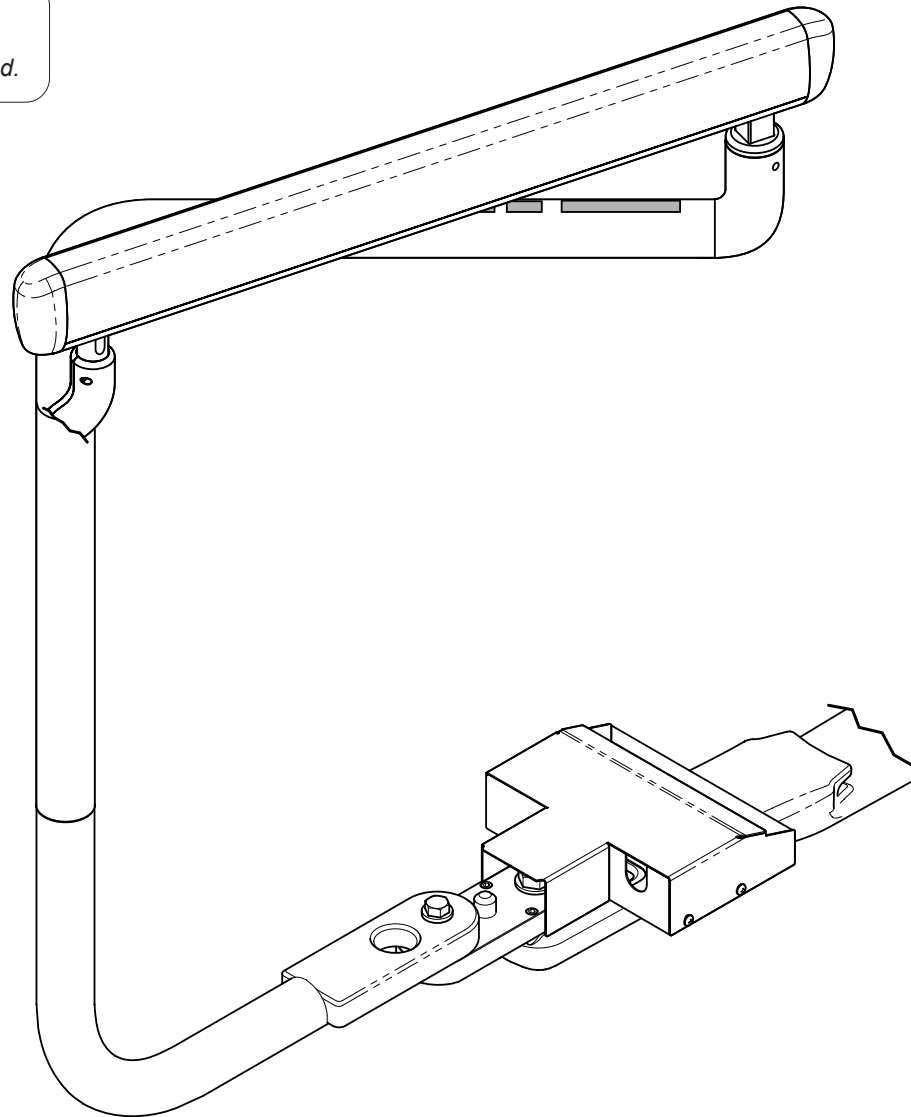

ArtFull

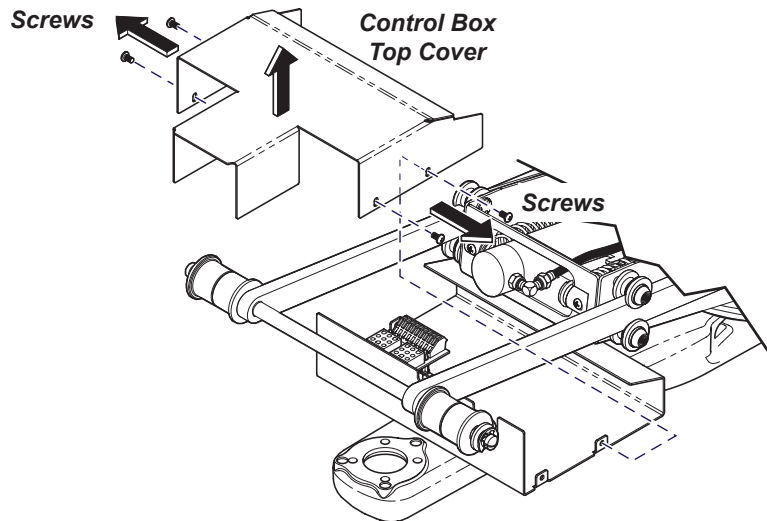

ArtSU5

Step 1:

Remove screws (4) and control box top cover as shown.

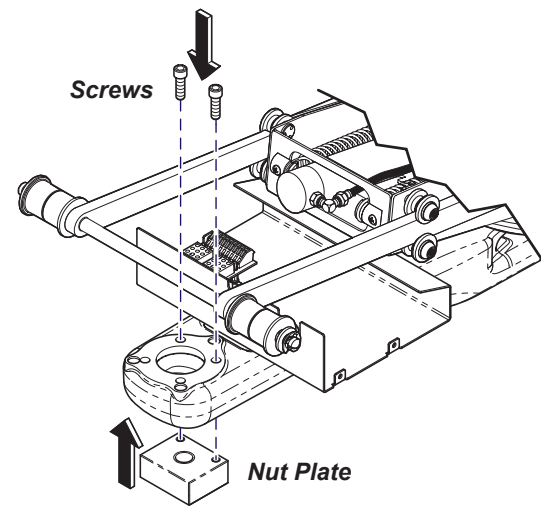

ArtSU5

Step 2:

Install nut plate with thread lock adhesive and screws (2) to underside of L/R Casting as shown.

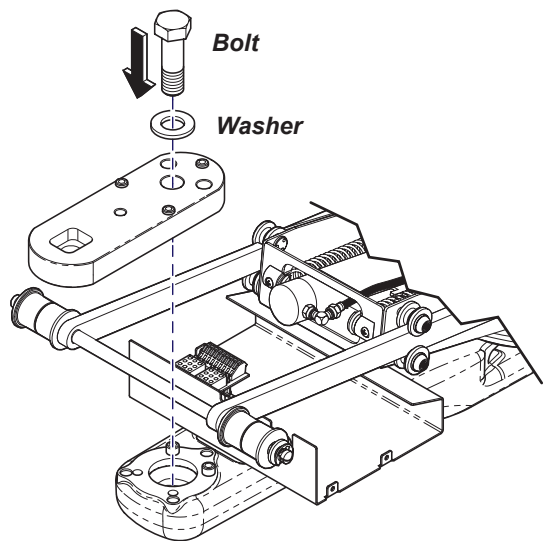

ArtSU5

Step 3:

Secure mounting plate to nut plate with washer and bolt (1). Hand tighten.

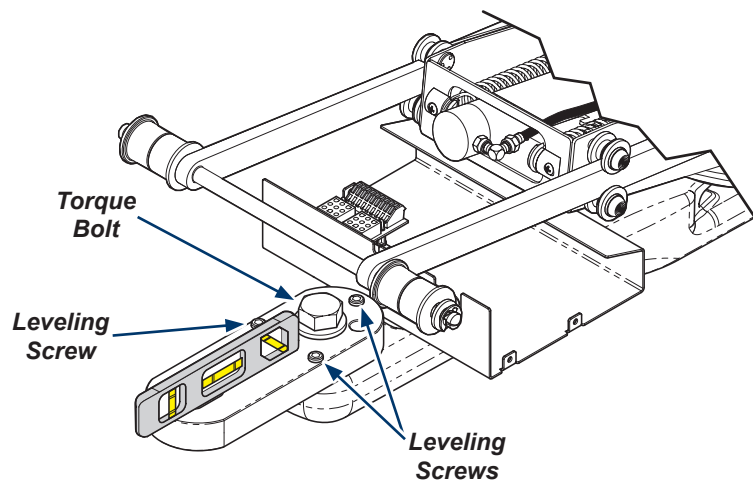

ArtSU5

Step 4:

Use level and leveling screws to level mounting plate.
Note: Torque Bolt to 110-130 ft.-lbs. (149-176 N•M).

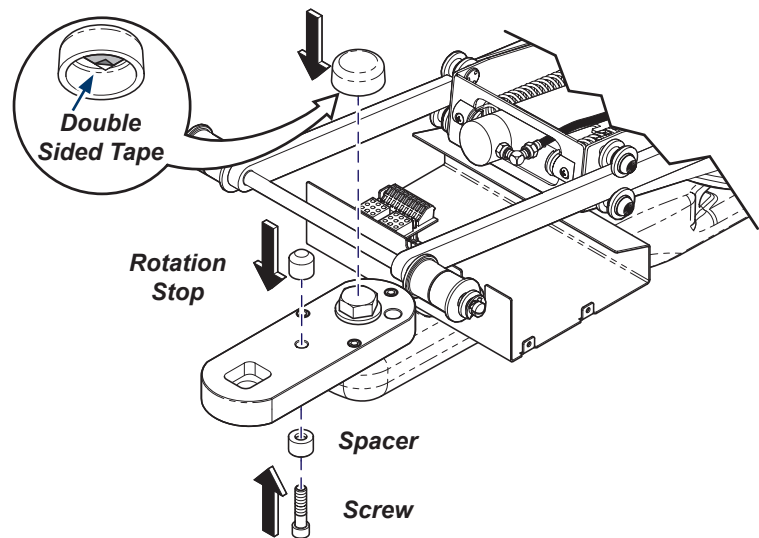

ArtSU5

Step 5:

Install bolt cap cover with double sided tape. Install rotation stop with spacer and screw (1).

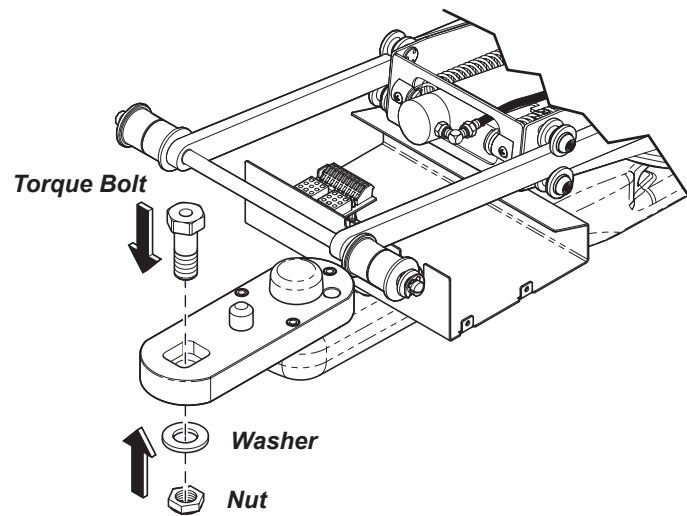

ArtSU5

Step 6:

Install bolt, washer and nut onto mounting plate.

Note: Torque Bolt to NO MORE than 20 ft.-lbs. (27 N•M).

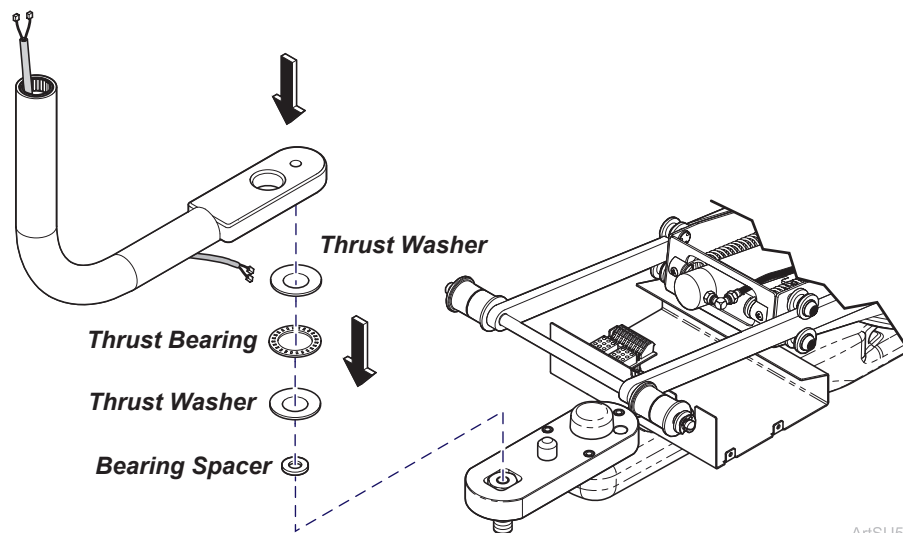

ArtSU5

Step 7:

Place spacer, washers (2), bearing and L/R on mounting plate as shown.

Note: Midmark recommends 2 installers for steps 7 and 8.

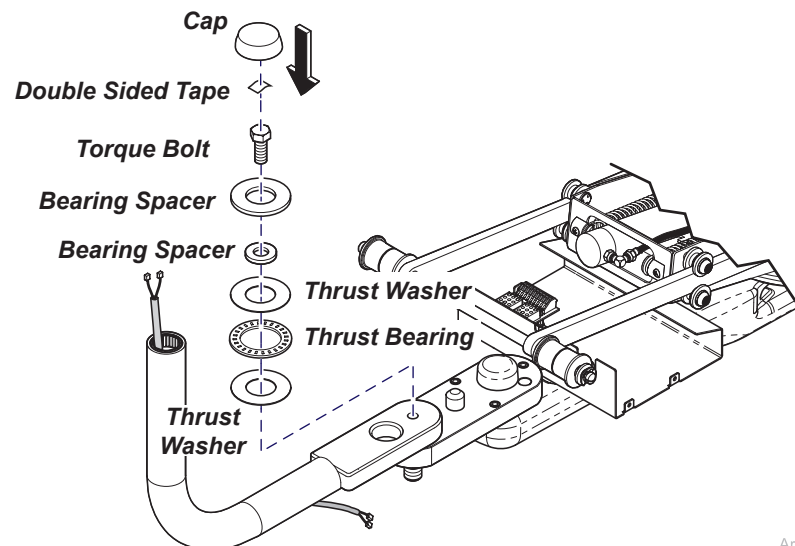

ArtSU5

Step 8:

Install rest of hardware as shown, torque bolt as noted below.

Note: Torque Bolt to NO MORE than 20 ft.-lbs. (27 N•M).



Equipment Alert

Midmark recommends two installers to ensure equipment does not get damaged.

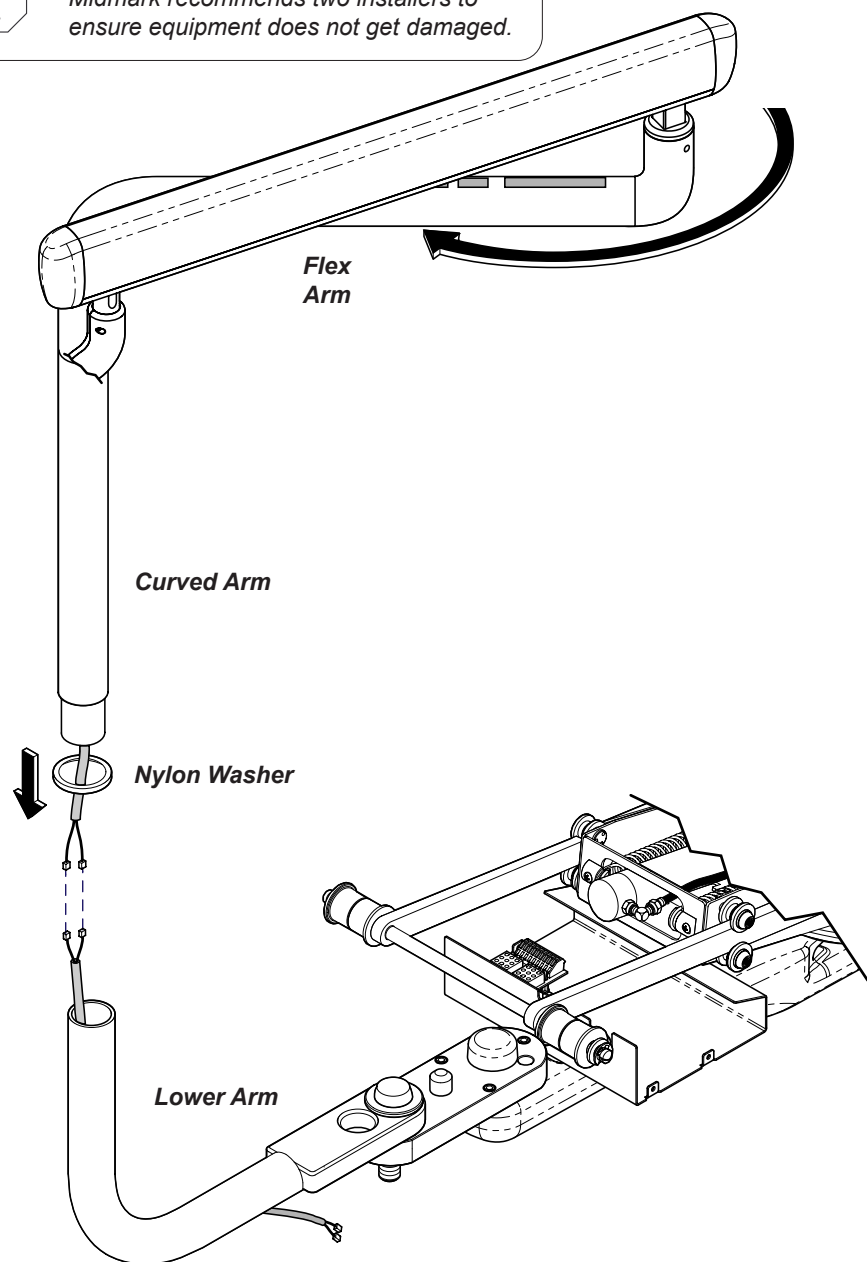

ArtHalf

Step 9:

Swing flex arm toward curved arm, place the large nylon washer in position. Connect wire harnesses and carefully slide the light arm assembly into the lower arm assembly.

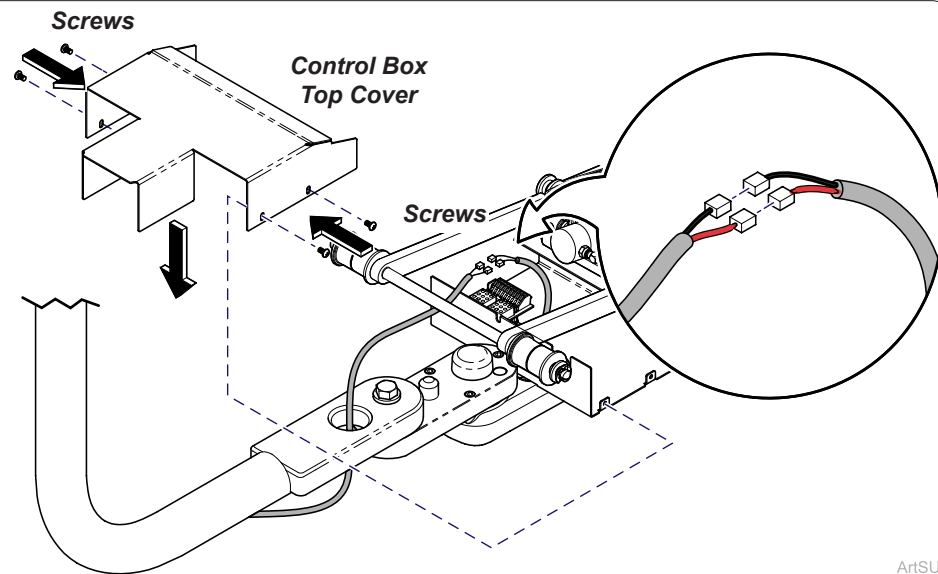

ArtSU5

Step 10:

Connect wiring and install control box top cover with screws (4). Lower seat section and check operation.