

630 Base Actuator Instruction [Full Down Position]

Applies to Models:

630 (-010 thru -013)
630 (-020 thru -023)

Special Tools:

7/32 Allen wrench bit
Ratchet wrench
Impact driver

Note

Some illustrations show components removed for clarity only.



WARNING

Always disconnect power to chair before removing covers or performing any service procedures.

Note

Remove all accessories (ex. chair arms) before performing this procedure.

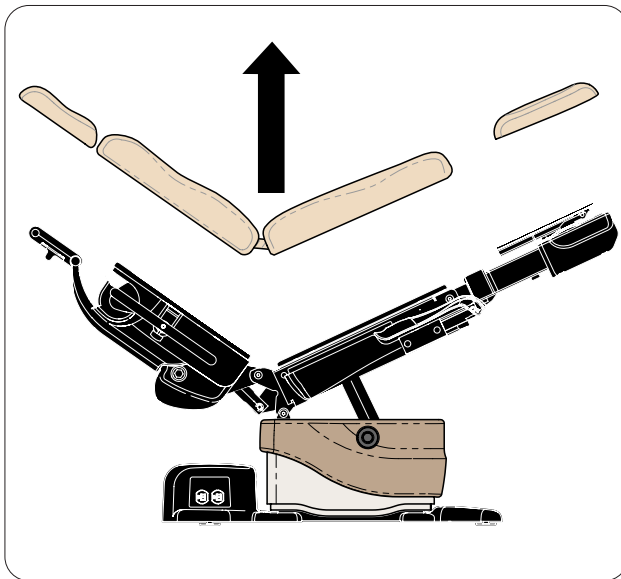

Step 1:

- A) Remove upholstery.
- B) Move Back, Tilt and Foot to the up position.

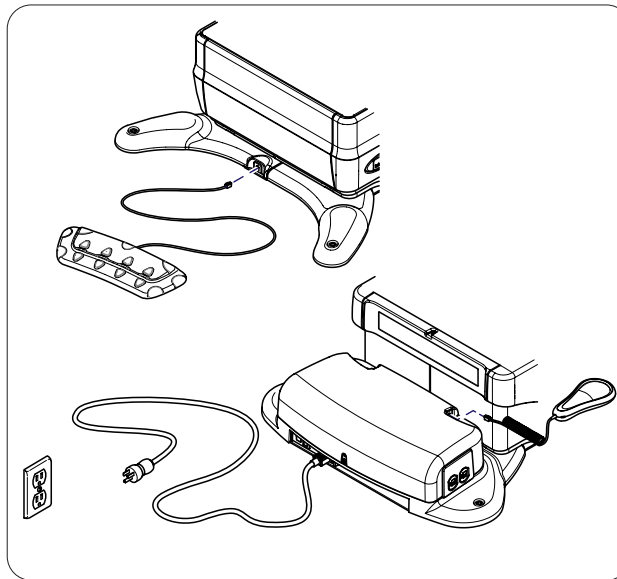

Step 2:

- A) Disconnect power from chair.
- B) Disconnect Hand/Foot controls.

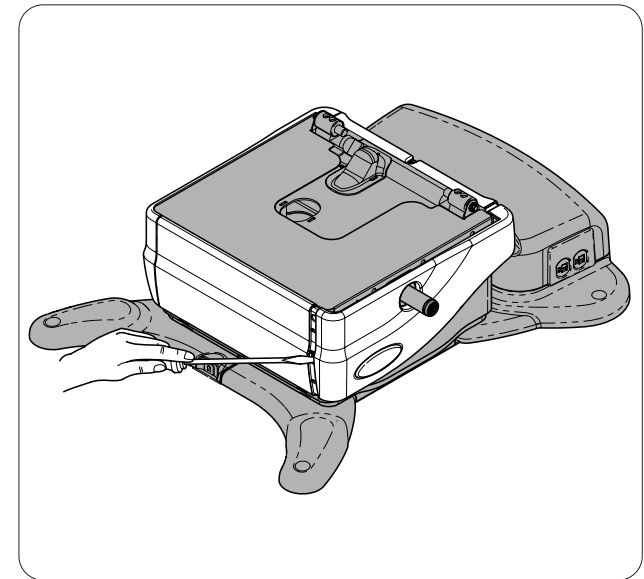

Step 3

Insert large, flat blade screwdriver into slot at the front and the back of side cladding and twist to disengage.

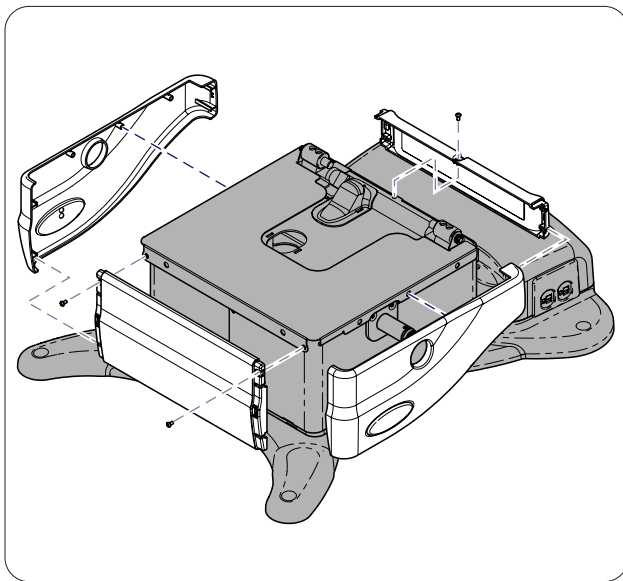

Step 4:

- A) Unsnap side cladding to remove.
- B) Remove two screws from front cladding.
- C) Remove one screw from back cladding.

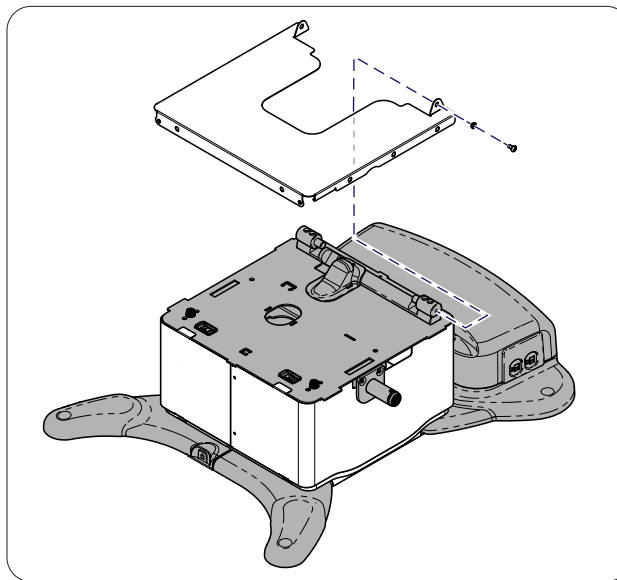

Step 5:

- A) Remove two screws and bushings.
- B) Slide Bail forward and remove.

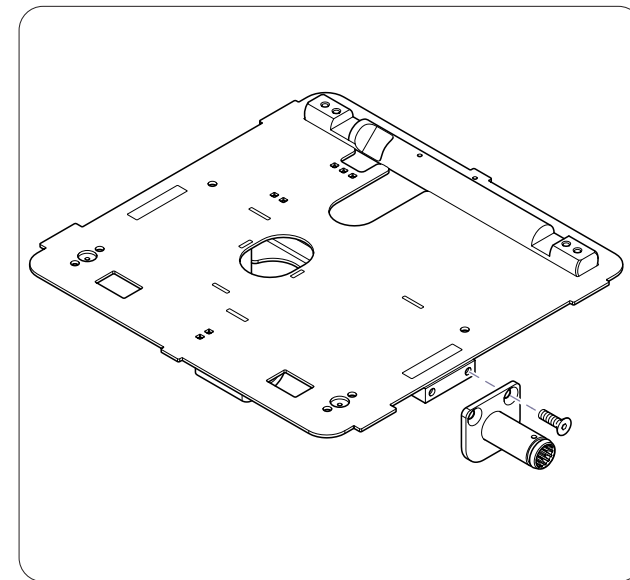

Step 6:

- A) Remove two screws from each Spline Weldement.
- Note: Use a 7/32 Allen bit (standard non ball hex) on an impact driver or large ratchet wrench.

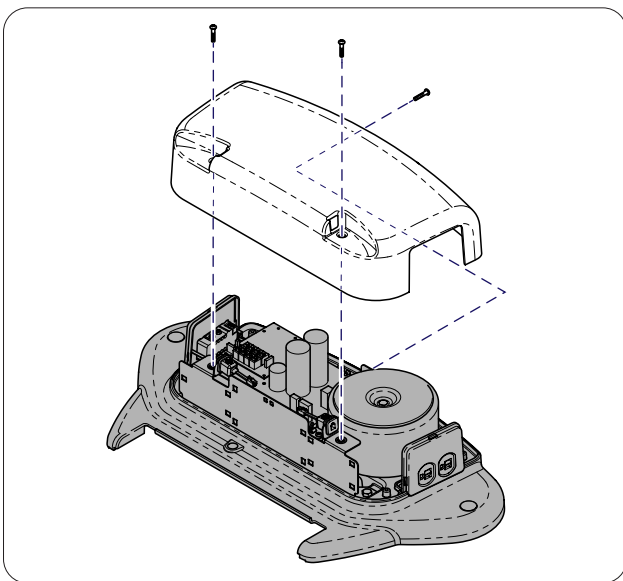

Step 7:

- Remove three screws and PC board cover.

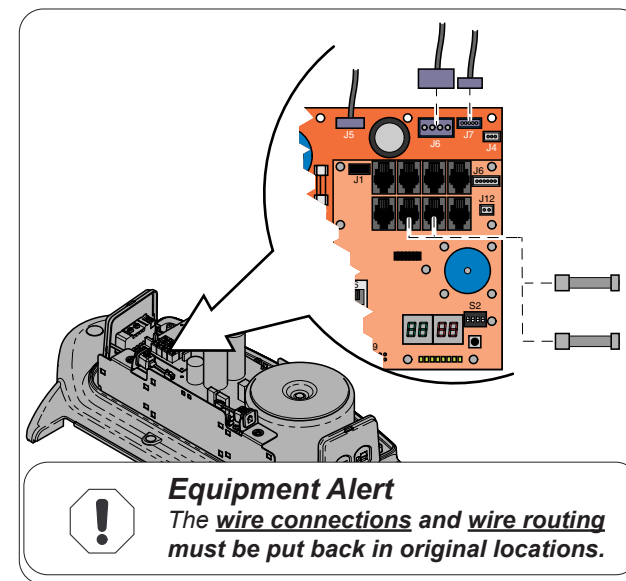

Equipment Alert

The wire connections and wire routing must be put back in original locations.

Step 8:

- A) Disconnect actuator wire connections J6 and J7 from Power Supply PC board.
- B) Disconnect Hand control harnesses from Machine Control PC board.

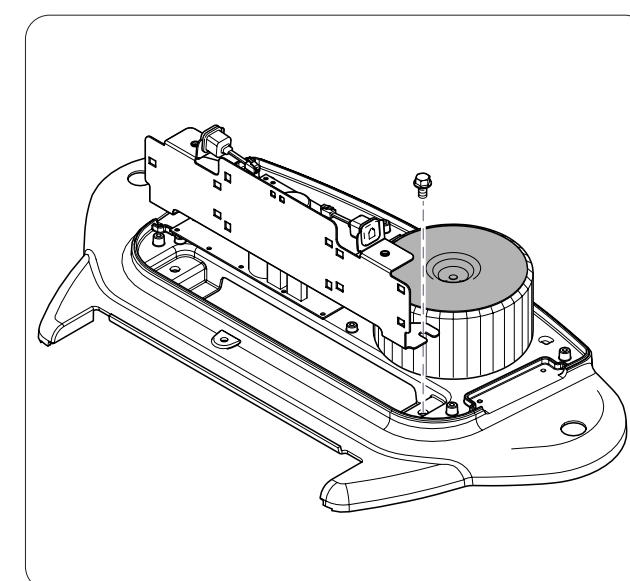

Step 9:

- Remove two screws and Hand control connector bracket.

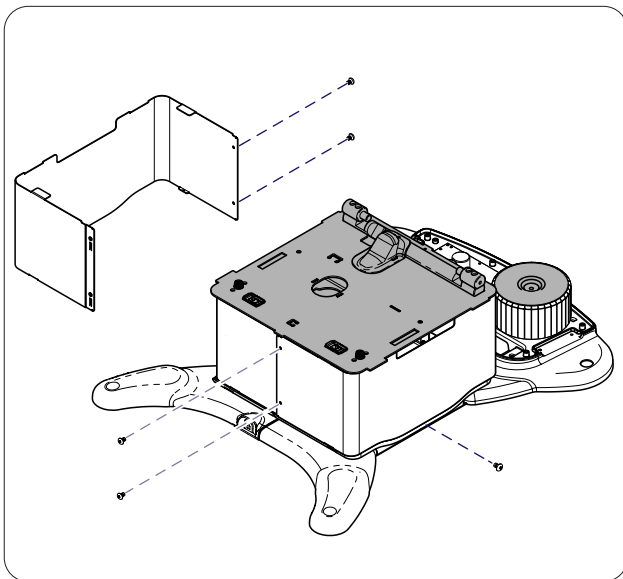

Step 10:

Remove shrouds by removing two screws on the front and rear for each set of shrouds and side screws from inner shrouds.

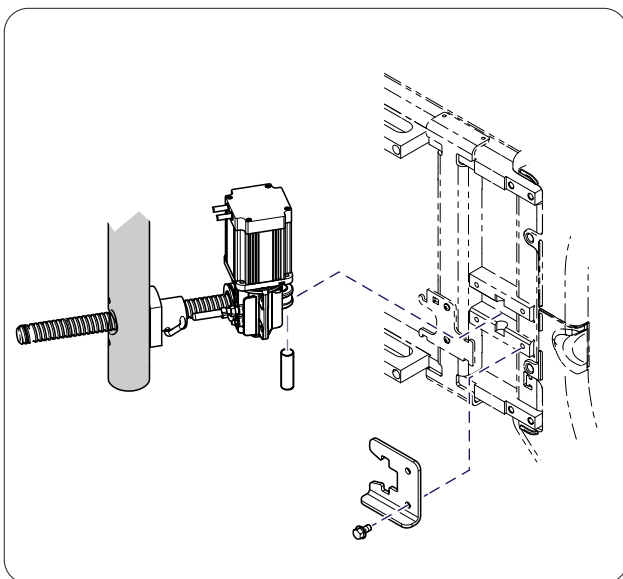

Step 12: Serial Numbers: V2200 thru V1460921

Remove two screws, retaining plate, and actuator pin.



Caution

Use assistance when laying or lifting the chair into position.

630 w/ upholstery (standard base) 475 lbs (215 kg)

630 w/ upholstery (rotational base) 550 lbs (249 kg)

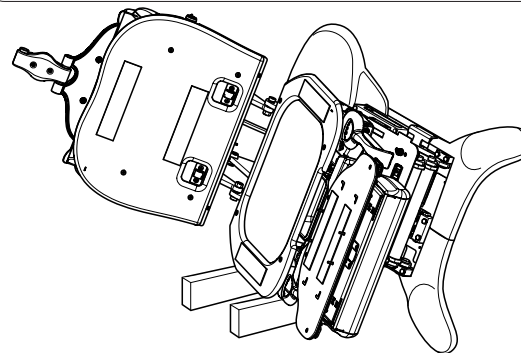

Step 11:

Carefully lay the chair on it's side.

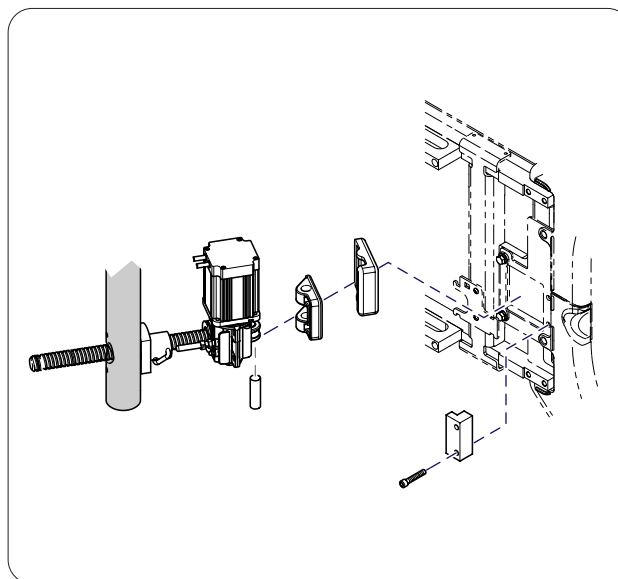

Step 12: Serial Numbers: V1460922 thru Present

A) Remove two screws and heel block.

B) Lift up on Base actuator and remove.

C) Remove isolator from clevis block, then remove actuator pin and clevis block.

**Caution**

Use assistance when laying or lifting the chair into position.

630 w/ upholstery (standard base) 475 lbs (215 kg)

630 w/ upholstery (rotational base) 550 lbs (249 kg)

**Equipment Alert**

The wire connections and wire routing must be put back in original locations.

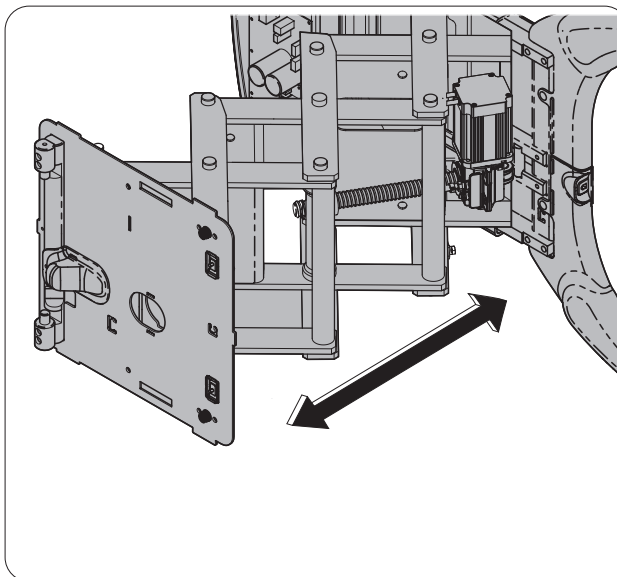
**Step 13:**

Carefully extend scissors assembly manually...

- A. At half scissor extension cut zip ties that are securing Base actuator motor wires (3 in total).
- B. Continue extension of the scissors.

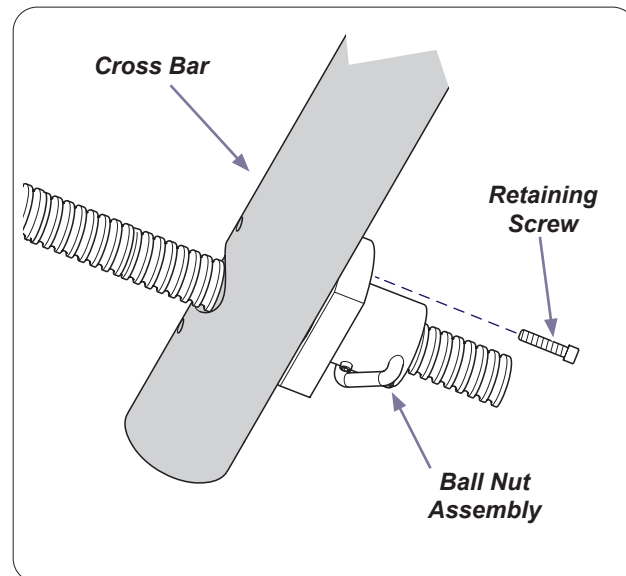
**Step 14:**

- A) Remove two mounting screws securing the ball nut assembly to cross bar.
- B) Remove Base actuator.

**Caution**

Use assistance when laying or lifting the chair into position.

630 w/ upholstery (standard base) 475 lbs (215 kg)
630 w/ upholstery (rotational base) 550 lbs (249 kg)

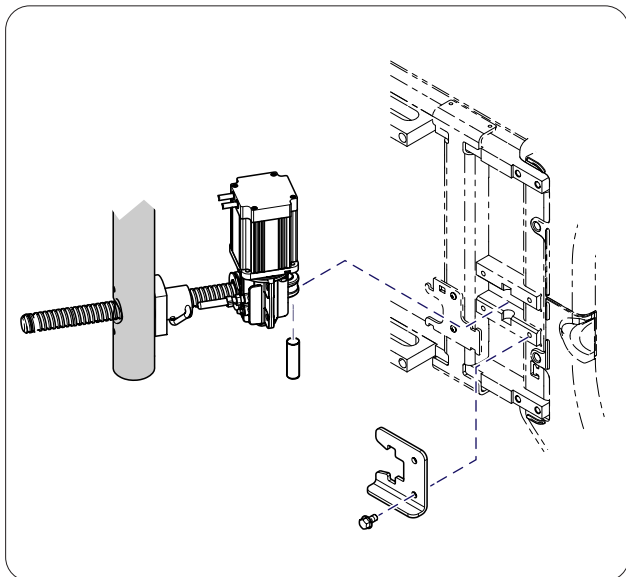
**Step 15: Serial Numbers: V2200 thru V1460921**

Install new actuator...

- A. Insert actuator shaft thru hole in cross bar and secure with two screws.
- B. Manually move the Base toward the actuator.
- C. Position bottom of actuator with pin in slot.
- D. Install retaining plate and secure with two screws.

**Caution**

Use assistance when laying or lifting the chair into position.

630 w/ upholstery (standard base) 475 lbs (215 kg)
630 w/ upholstery (rotational base) 550 lbs (249 kg)

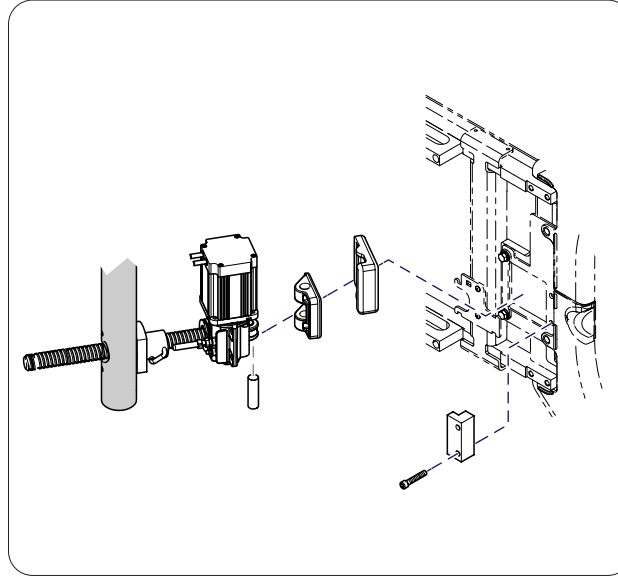
**Step 15: Serial Numbers: V1460922 thru Present**

Install new actuator...

- A. Insert actuator shaft thru hole in cross bar and secure with two screws.
- B. Manually move the Base toward the actuator.
- C. Position bottom of actuator with pin in slot.
- D. Install isolator onto clevis block.
- E. Position bottom of actuator into Base.
- F. Install heel block and secure with two screws.



Caution

Use assistance when laying or lifting the chair into position.

630 w/ upholstery (standard base) 475 lbs (215 kg)
630 w/ upholstery (rotational base) 550 lbs (249 kg)



Equipment Alert

The wire connections and wire routing must be put back in original locations before installing covers.

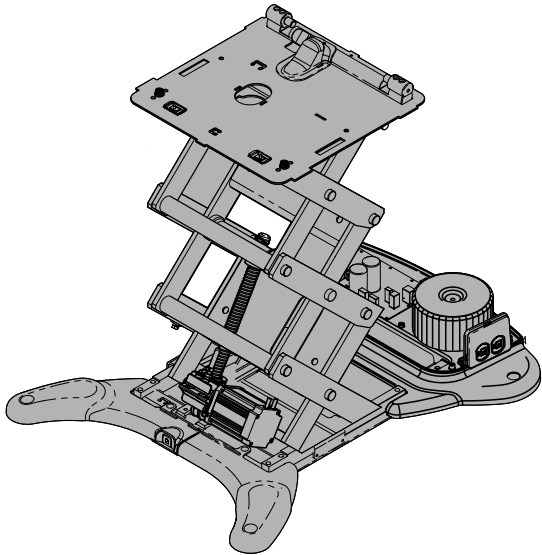

Step 16:

Lift chair to the upright position.

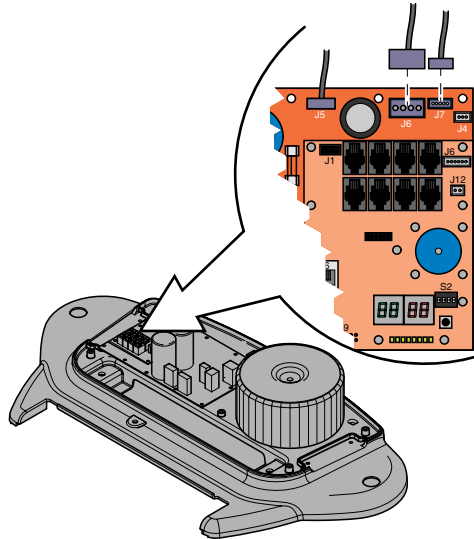

Step 17:

Connect actuator wire connections J6 and J7 to Power Supply PC board.

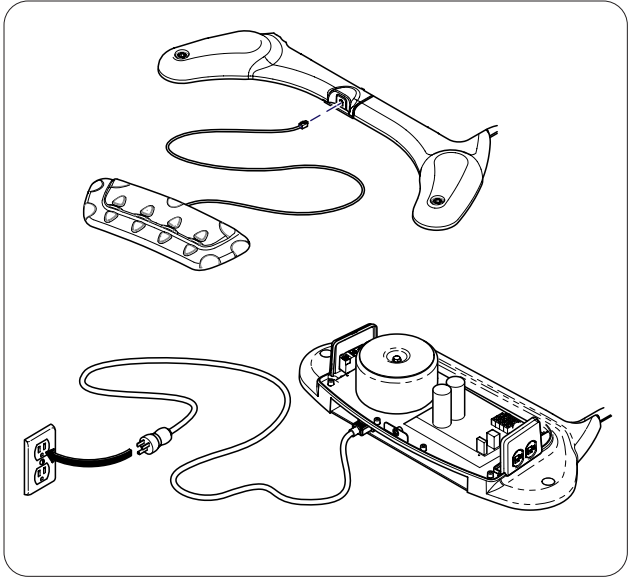

Step 18:

A) Connect controller to Foot end of chair.

B) Connect power to chair.

Note: Power to be supplied to chair temporarily to perform next step.



WARNING

Always disconnect power to chair before removing covers or performing any service procedures.



Equipment Alert

The wire connections and wire routing must be put back in original locations before installing covers.

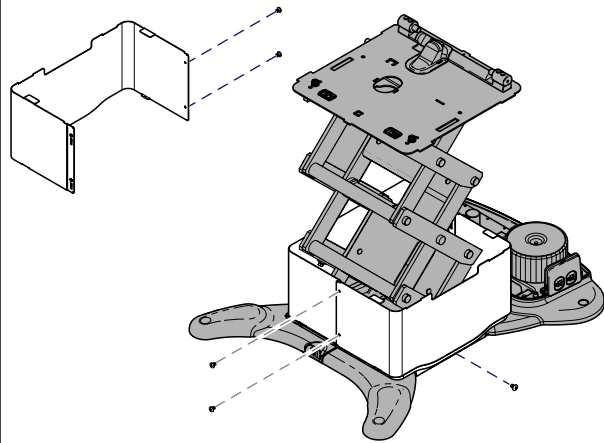

Step 19:

- A) Lower Base completely, then raise four to six inches.
- B) Disconnect Power.
- C) Position inner shrouds and secure with front, rear and side screws.
- D) Position middle and outer shrouds and secure with screws at front and rear.

Note: Be sure shroud tabs stack on top of each other.

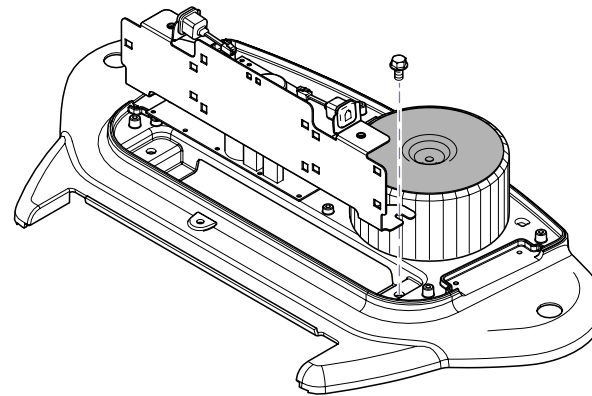

Step 20:

Install Hand control connector bracket and secure with two screws.



Equipment Alert

The wire connections and wire routing must be put back in original locations before installing covers.

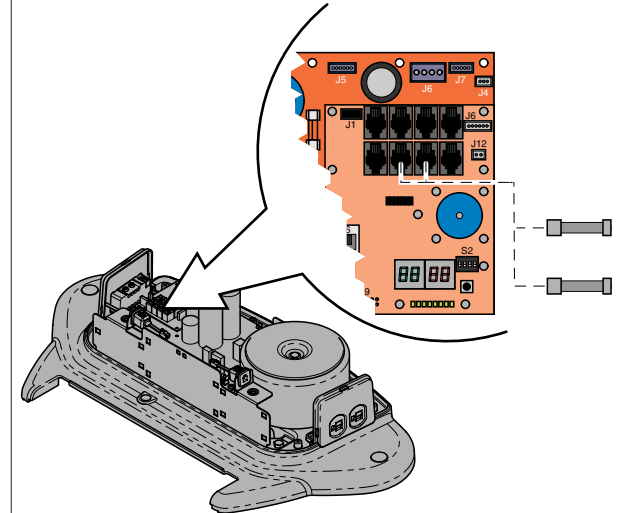

Step 21:

Connect Hand control harnesses to Machine Control PC board.

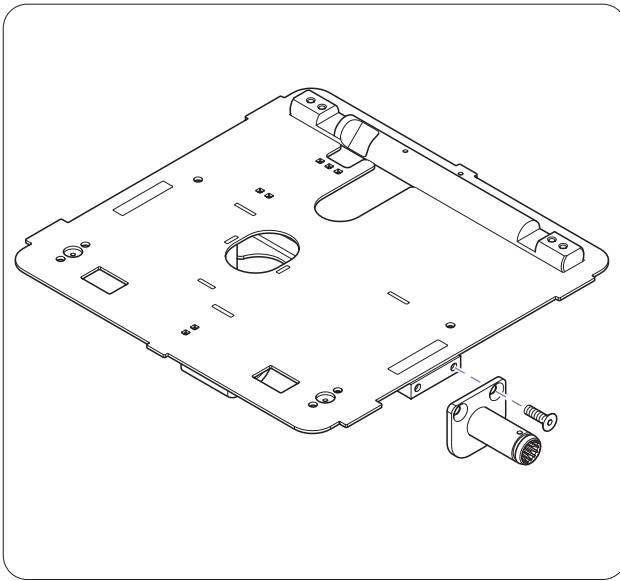

Step 22:
 Position Spline Weldement and secure with two screws.
 Repeat for other side.

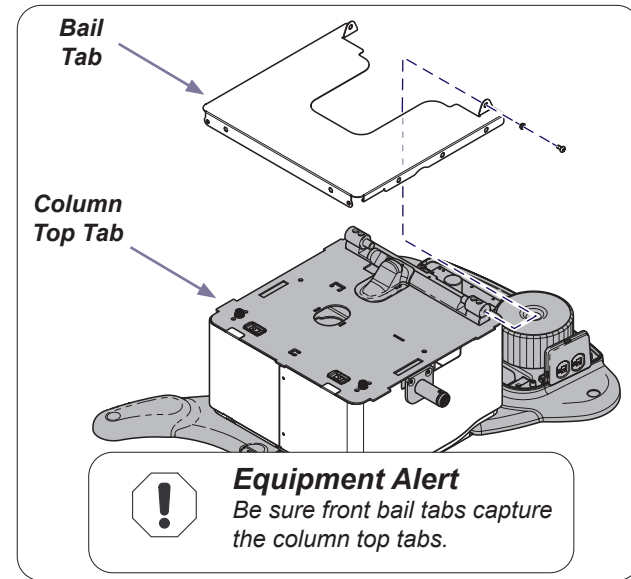

Step 23:
 A) Slide Bail into position.
 B) Secure with two screws and bushings.

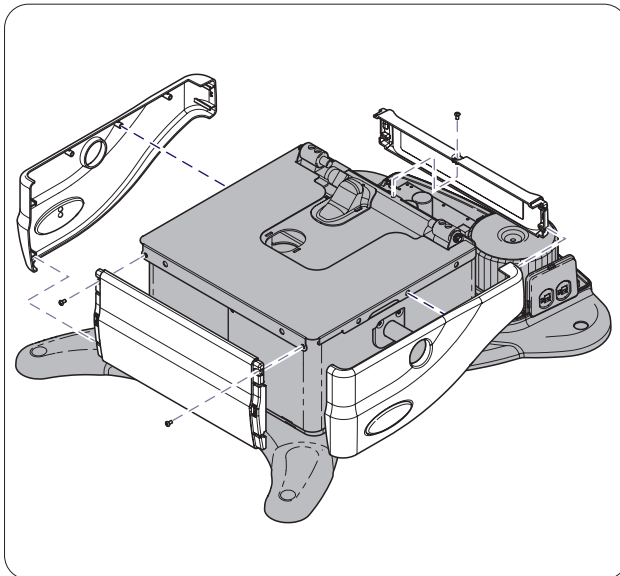

Step 24:
 A) Position back cladding and secure with one screw.
 B) Position front cladding and secure with two screws.
 C) Snap side cladding in place.

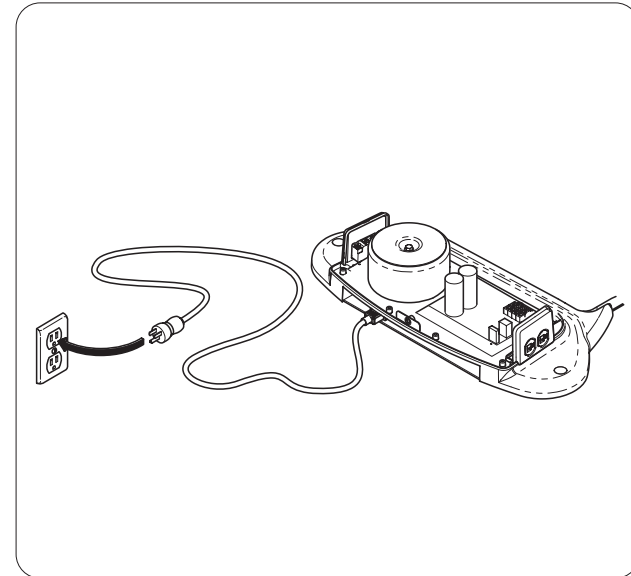

Step 25:
 Connect power to chair.

Step 26:

Perform Calibration Procedure.



Equipment Alert

Anytime the PC Board is removed or the actuator wires are disconnected, the chair must be calibrated.

During the calibration procedure you will hear a steady pattern of “beeps”. The chair will run all functions (base, back, tilt, foot) to their minimum and maximum positions, then return to a lowered flat position. When calibration is complete, the chair will stop moving and you will hear three short “beeps”.

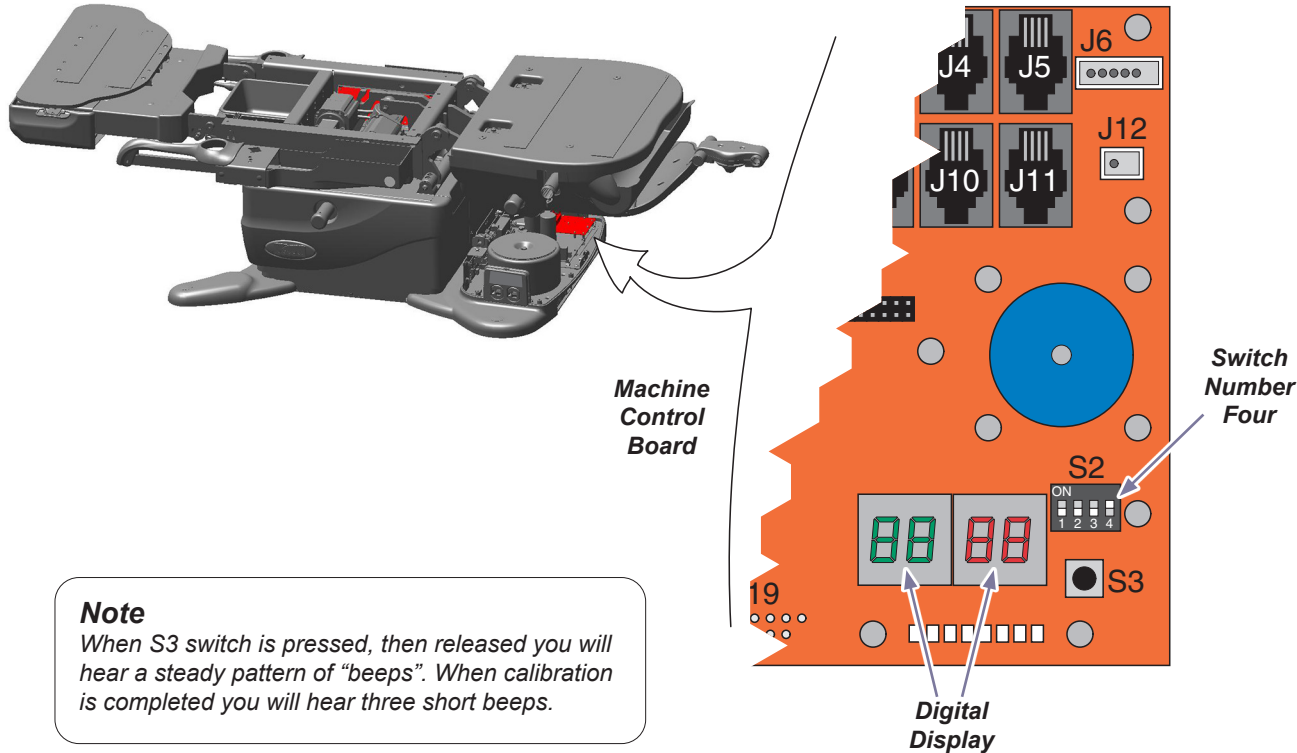

Note

When S3 switch is pressed, then released you will hear a steady pattern of “beeps”. When calibration is completed you will hear three short beeps.

To calibrate...

- Slide foot section to highest stowed position.
- Unplug chair power cord.
- When the digital display darkens, move S2 switch number four to ON (up).
- Plug in chair power cord.
- When the digital display darkens, press and release S3 switch.
- When calibration is complete, unplug chair power cord.
- Move S2 switch number four to OFF (down).
- When the digital display darkens, plug in chair power cord.

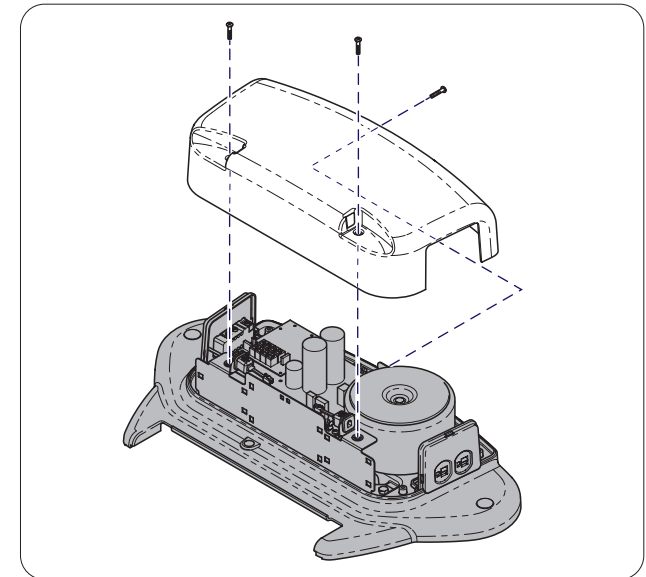

Step 27:

Position PC board cover and secure with three screws.