



WARNING

Always disconnect power to compressor before removing covers or performing any service procedures.

Step 1: Remove hose, bowl and filter from top housing.

- Unthread hose from top housing.
- Press down on lock button, rotate coalescing filter bowl, pull down removing the coalescing filter bowl and unthread filter.

Note

If needed rotate the coalescing filter top housing clockwise a couple degrees to gain access to the hose fitting.

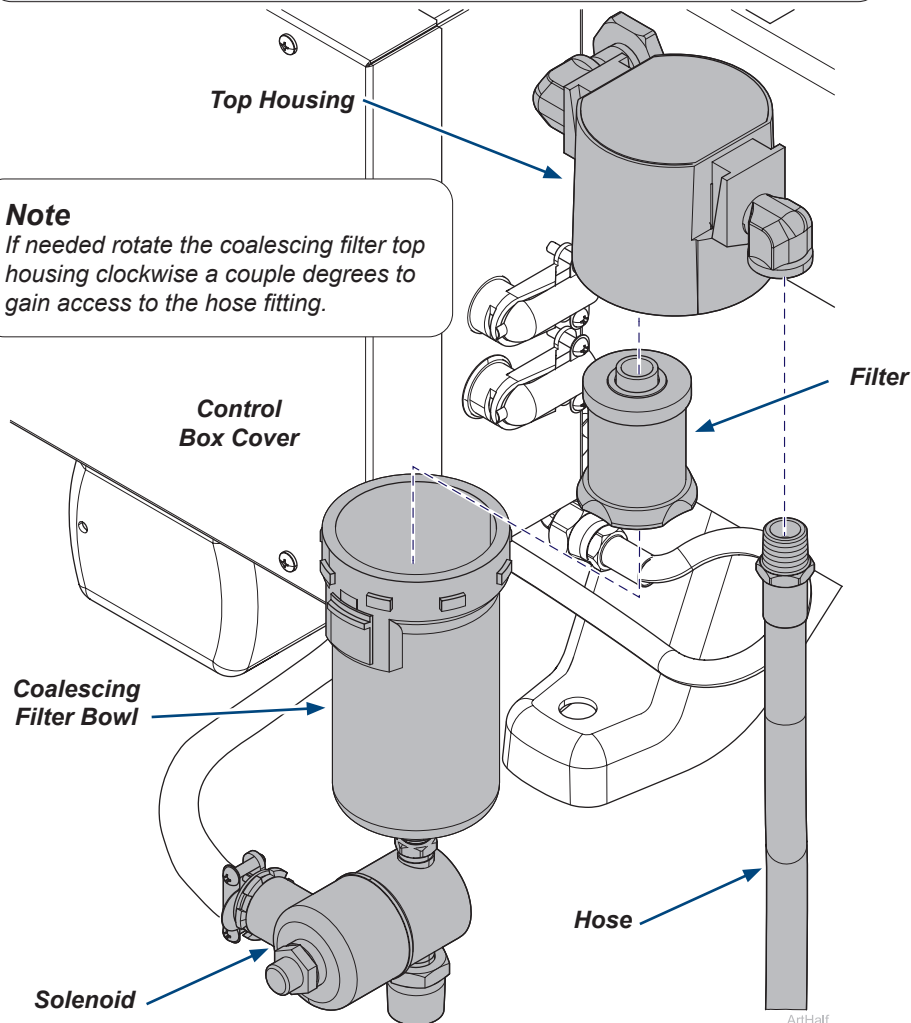

Step 2: Remove control box. (P21&P22 MODELS ONLY!)

- This step is for P21 and P22 models only, proceed to next step for all other models.
- Remove the three nuts from the studs securing the control box.
- Gently remove control box and lower it. Be careful with the wiring and conduit.

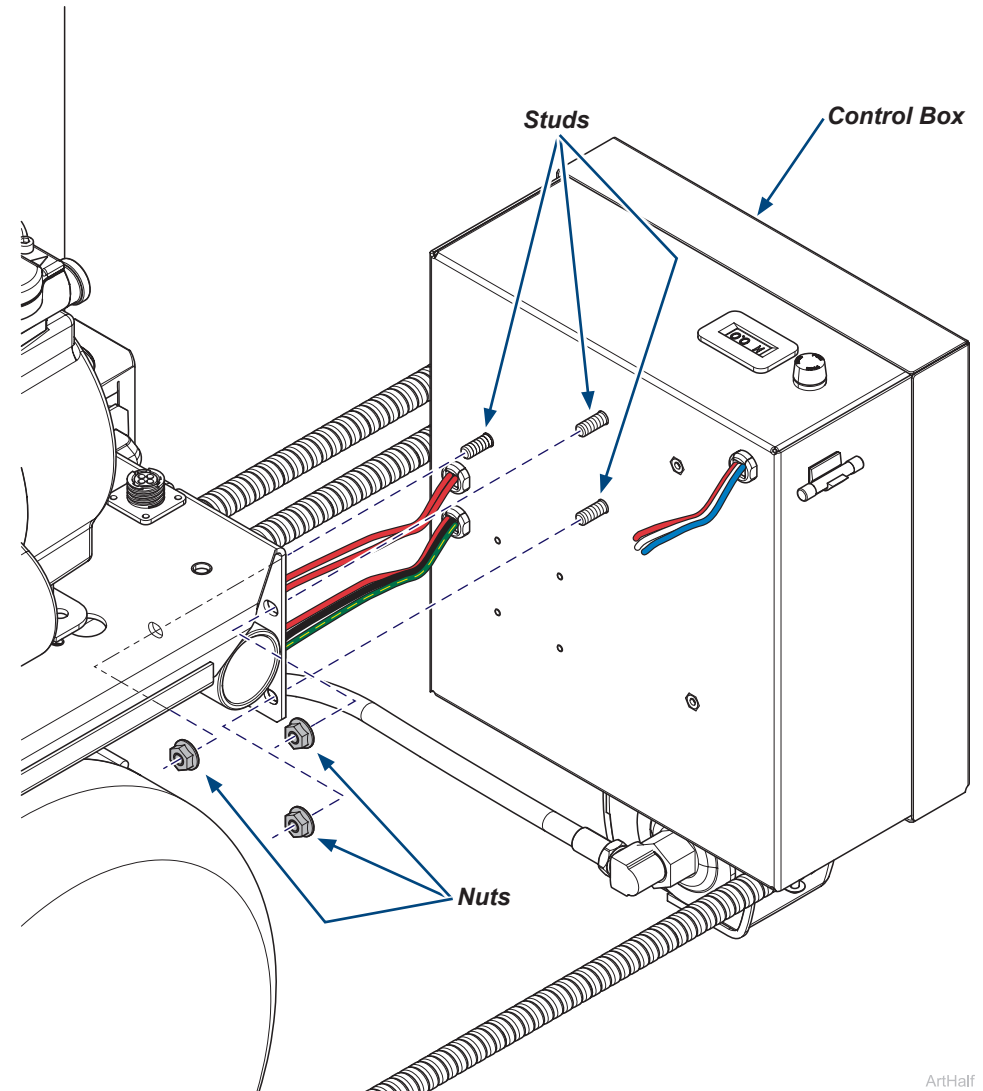

Step 3: Remove top housing.

- A) Unthread top housing from compressor at the elbow by rotating complete top housing and elbow counter clockwise.

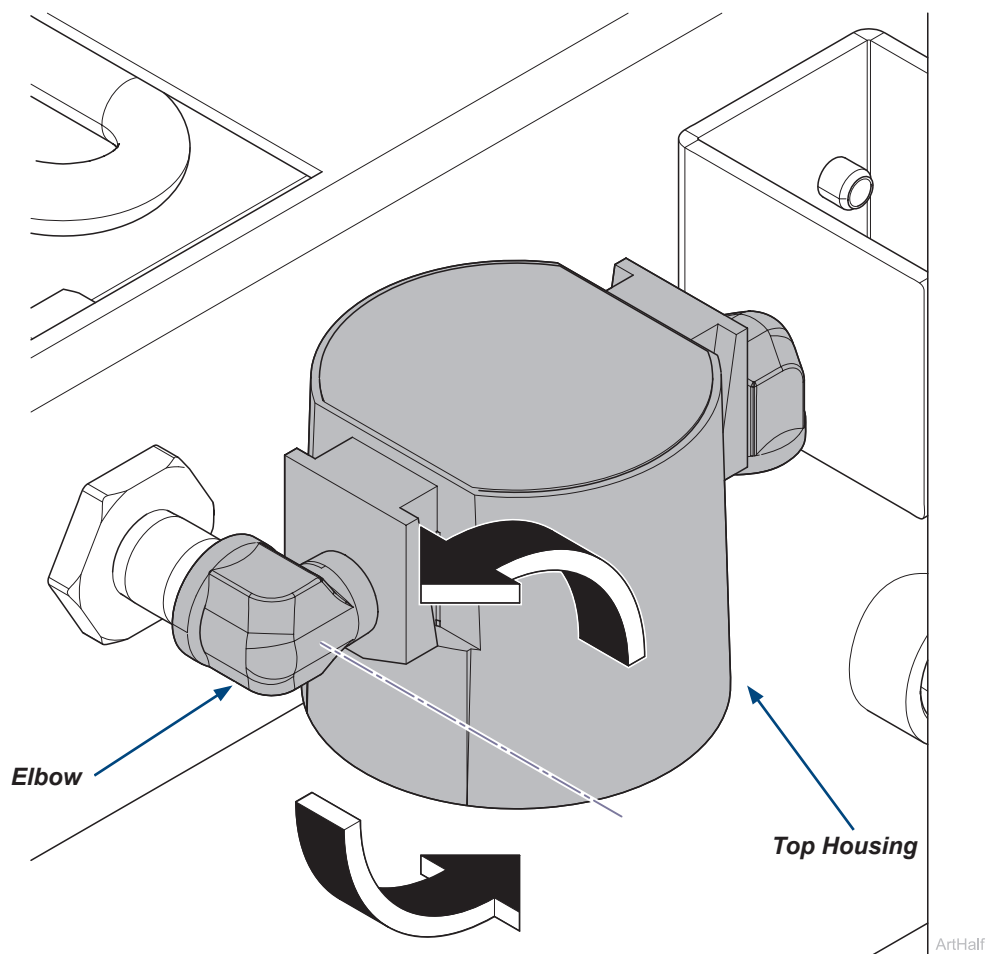

Step 4: Swap solenoid from old filter bowl to new filter bowl.

- A) Unthread filter bowl and fitting from solenoid. Thread new filter bowl and fitting onto solenoid. Be careful not to damage the conduit.

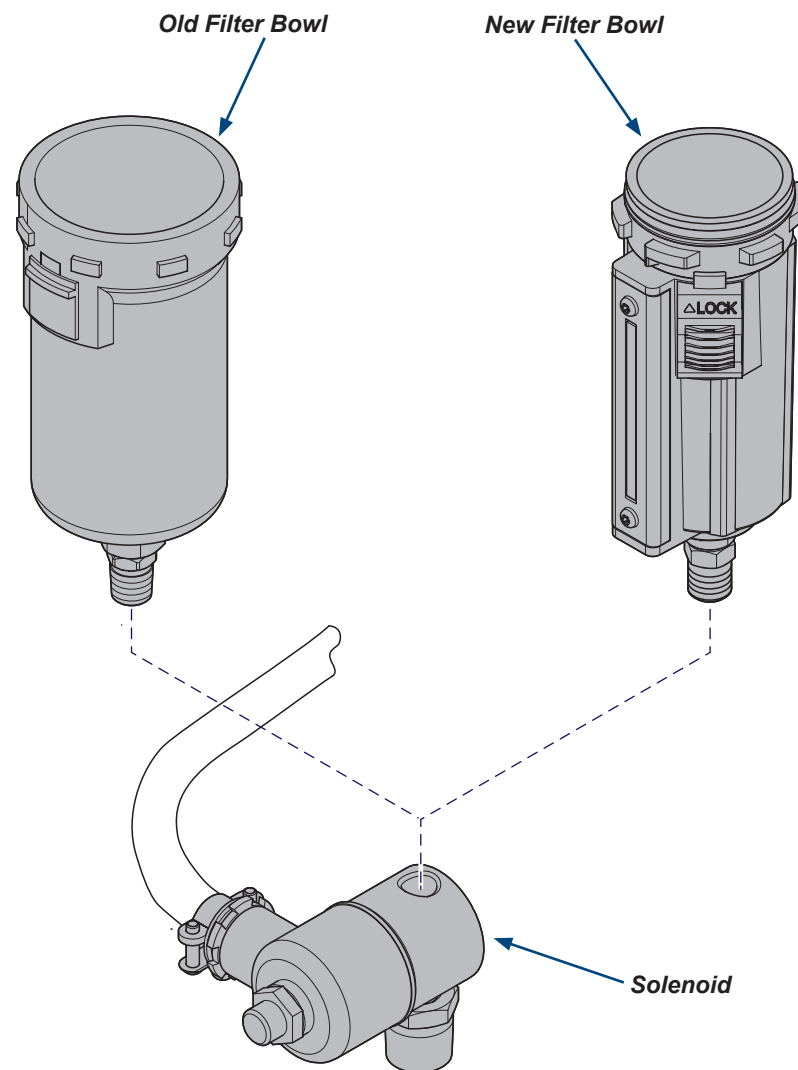

ArtHalf

Step 5: Install new top housing.

- A) Thread new top housing onto compressor at the elbow by rotating complete top housing and elbow clockwise.

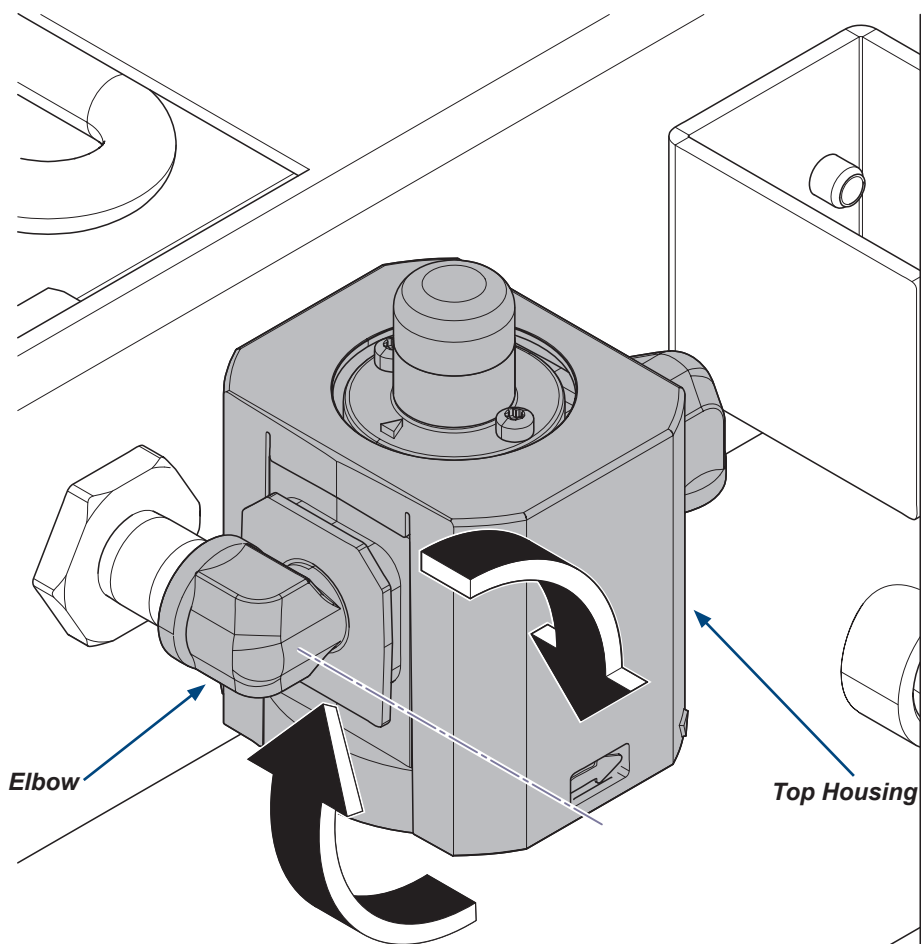

Step 6: Reinstall control box. (P21&P22 MODELS ONLY!)

- A) This step is for P21 and P22 models only, proceed to next step for all other models.
B) Gently line up and insert control box studs into the holes on the compressor, be careful with the wiring and conduit.
C) Install the three nuts on the studs securing the control box.

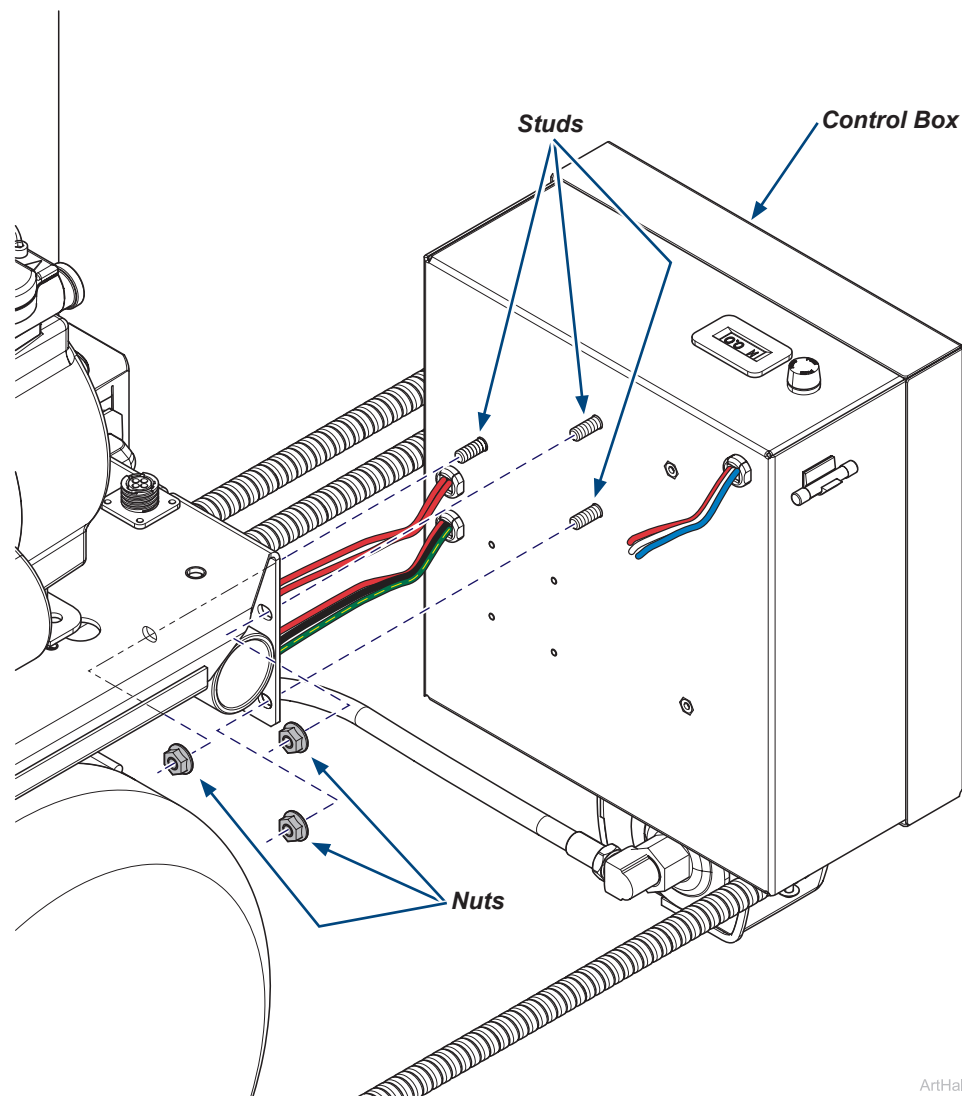

Step 7: Install filter, hose and bowl.

- A) Attach hose onto the right side of the top housing.
- B) Install filter into the filter bowl and press down until it locks in place.
- C) Line up filter bowl with top housing press down on lock button while pushing up on the filter bowl, rotate filter bowl, lock into place.

Note

If needed rotate the coalescing filter top housing clockwise a couple degrees to gain access to the hose fitting.

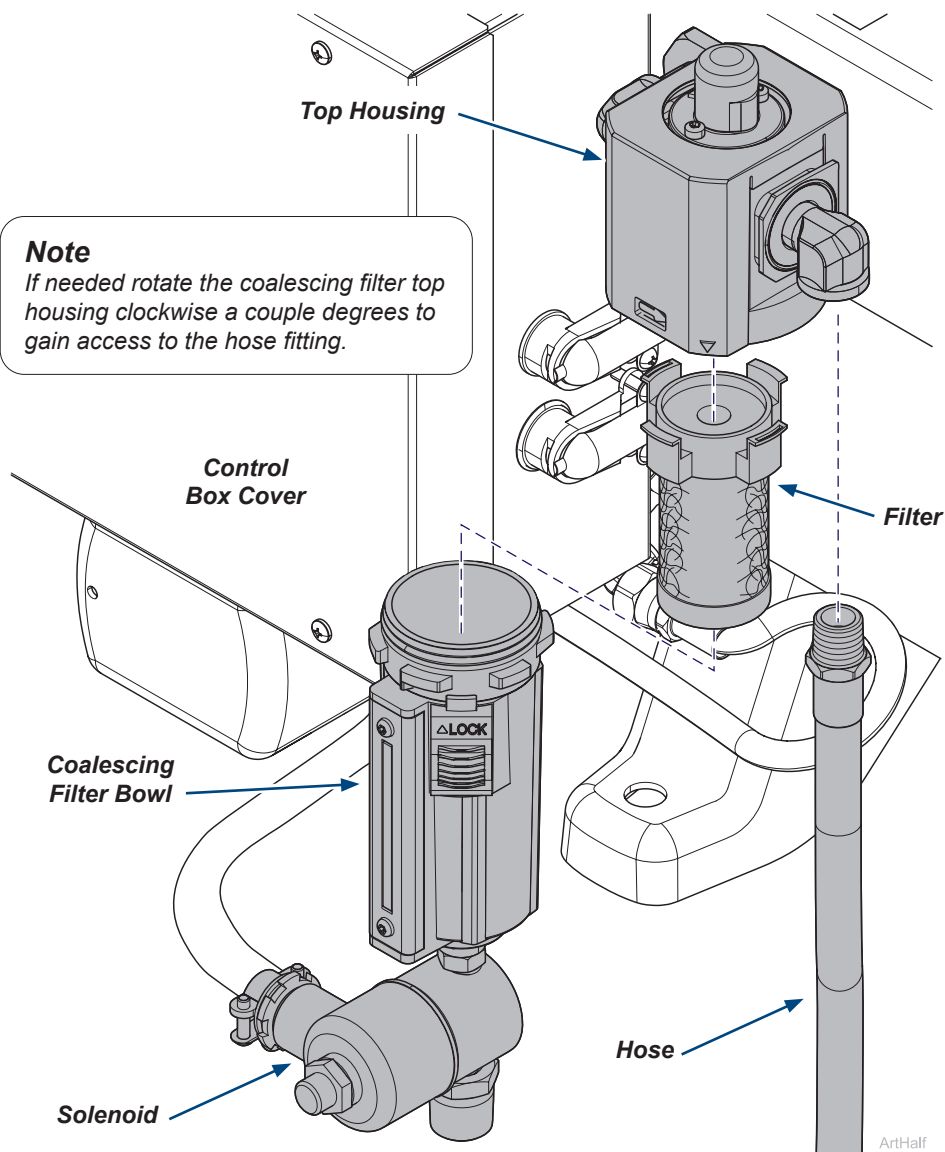

Step 8: Reconnect power and test for air leaks.

- A) Use soapy water to check for air pressure leaks.
- B) Repair any leaks in the system.



Equipment Alert

Verify all leaks are sealed. Air leaks are the main cause of premature compressor failures!