

Flex Arm Post, Neck and Yoke Kit [002-10934-0x]

Applies to Models:
Dental Lights



WARNING

To prevent risk of shock always disconnect power before removing covers or performing any service procedure.

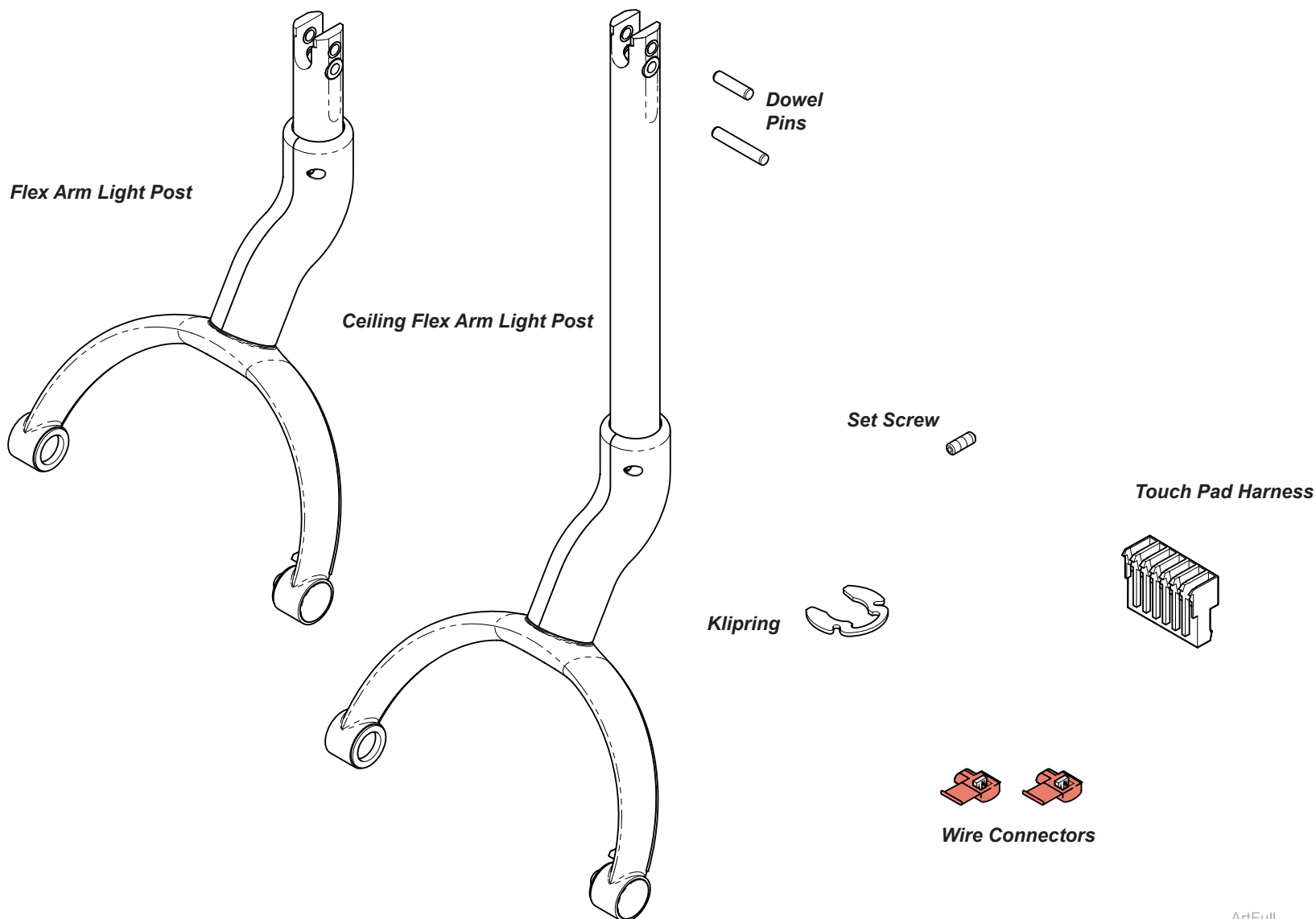

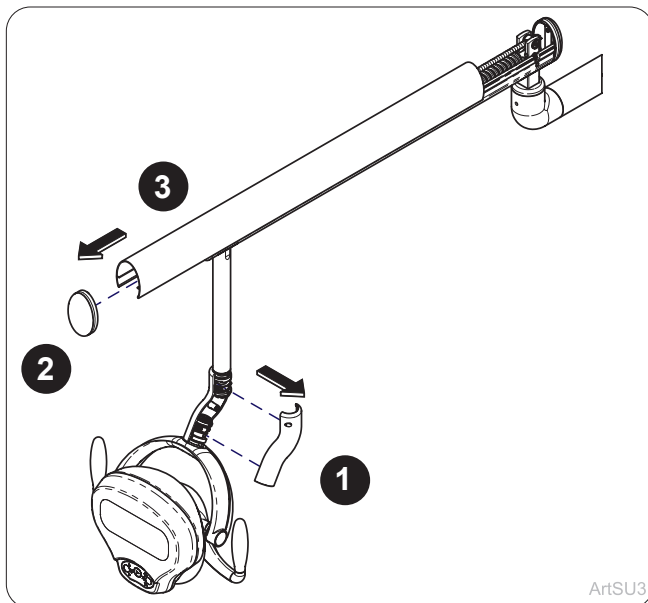

ArtSU3

Step 1:
Remove covers as shown.

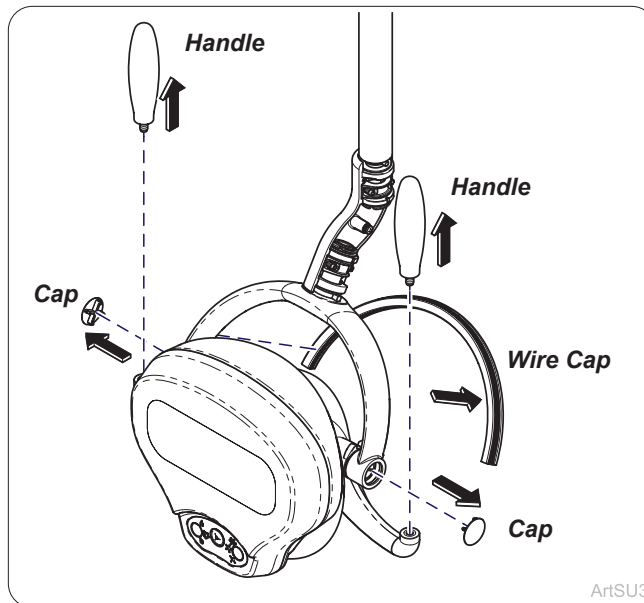

ArtSU3

Step 2:
Remove yoke wire cap, yoke caps (2), and handles (2) from yoke.

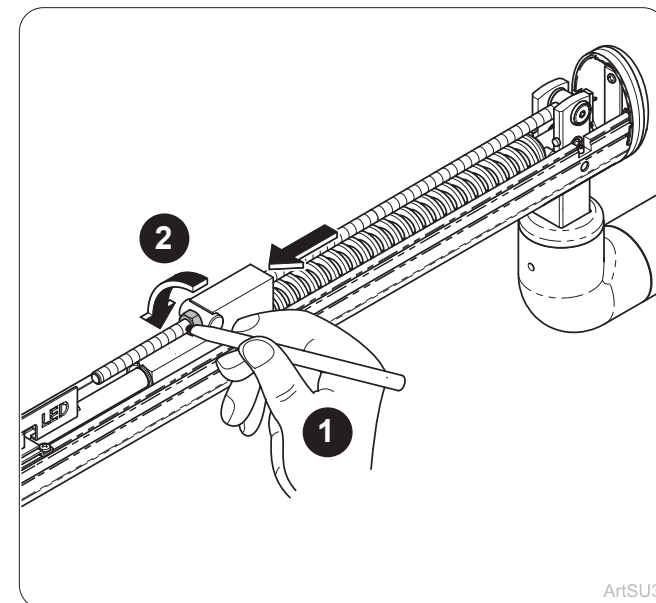

ArtSU3

Step 3:
Mark nut location in front of block and loosen nut to take tension off of spring. Do NOT remove nut.

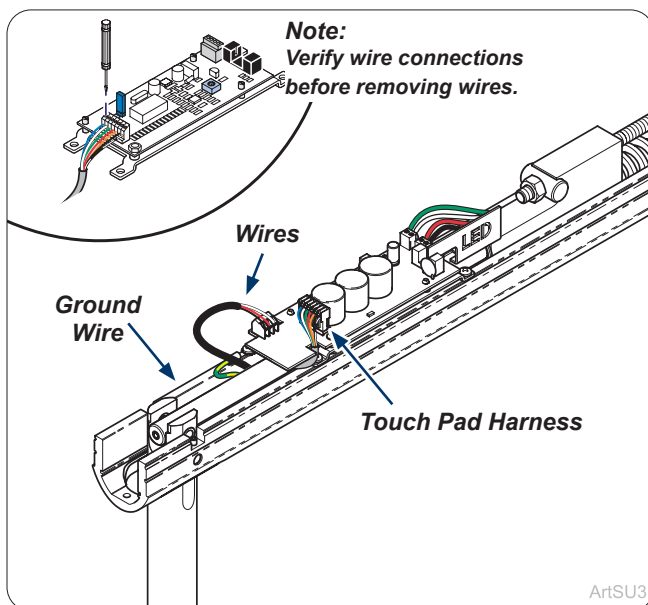

ArtSU3

Step 4:
Remove wiring from the front of PC board leaving rear wires attached.

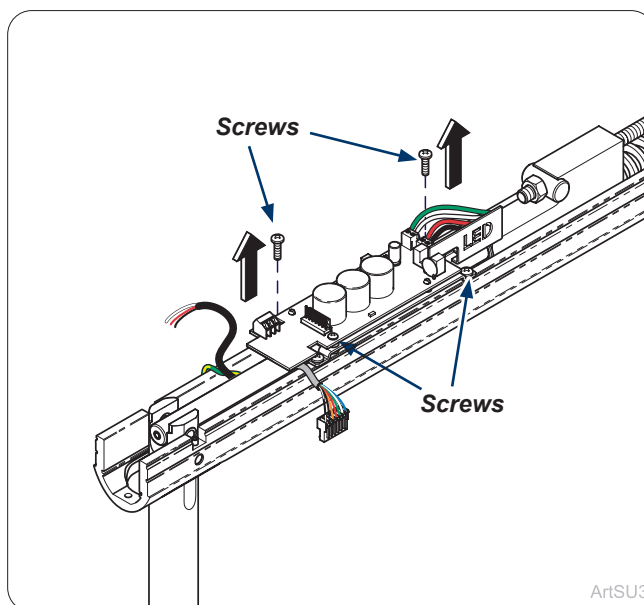

ArtSU3

Step 5:
Remove screws (4) from PC Board mount and move board to the side.

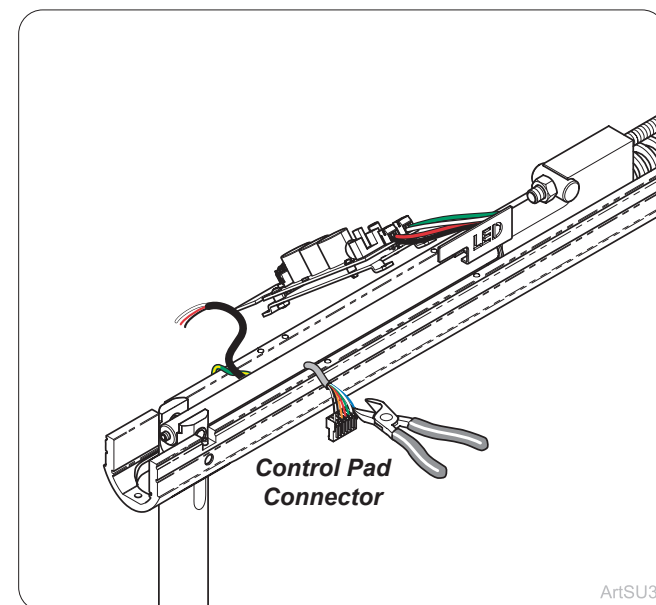

ArtSU3

Step 6:
Remove control pad connector from wires.

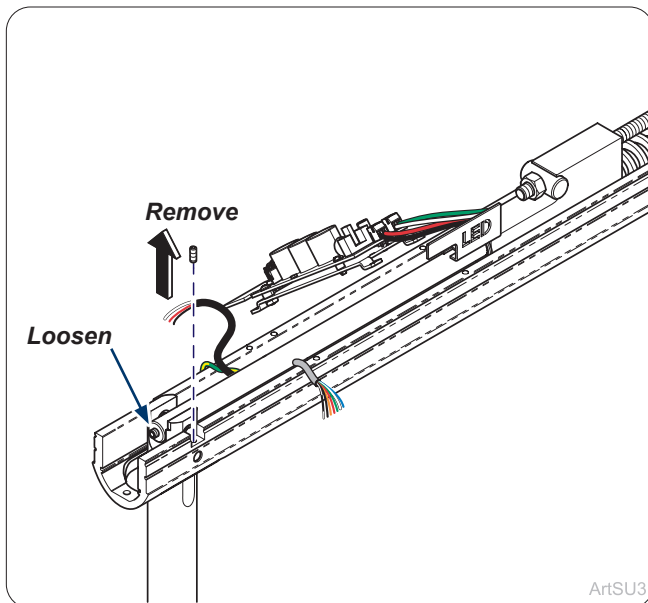

ArtSU3

Step 7:

Remove side set screw and loosen front set screw in mounting rod.

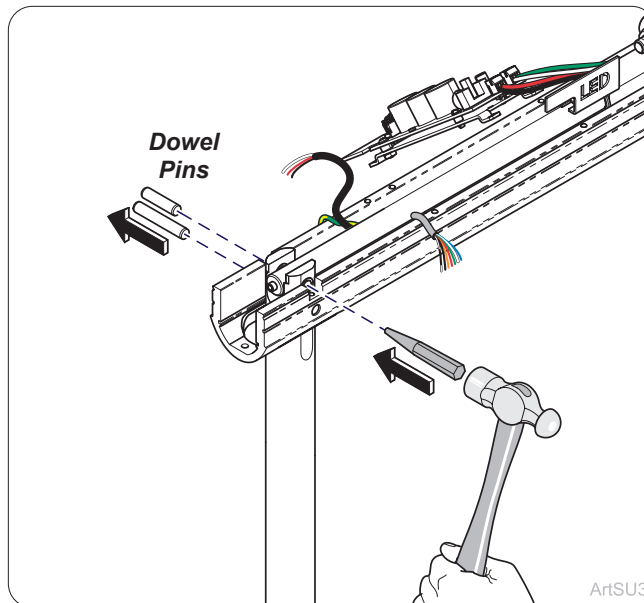

ArtSU3

Step 8:

Remove dowel pins (2) from light head post and flex arm rod.

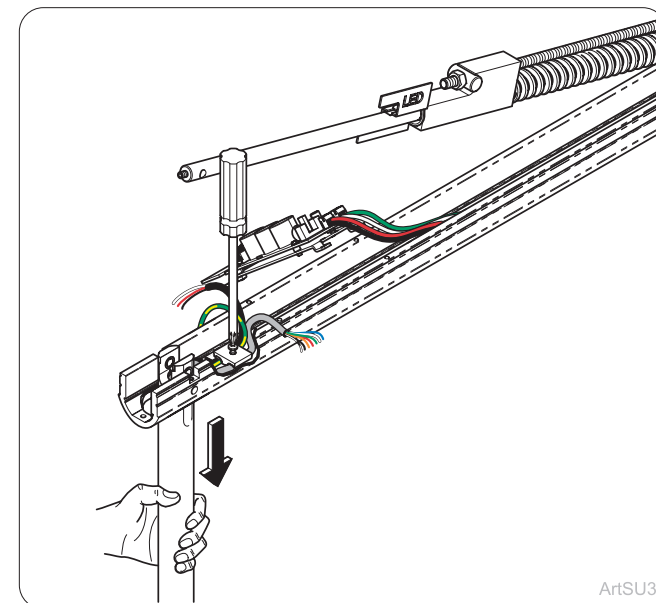

ArtSU3

Step 9:

Remove screw and wire holder in bottom of flex arm and remove light head assembly and post.

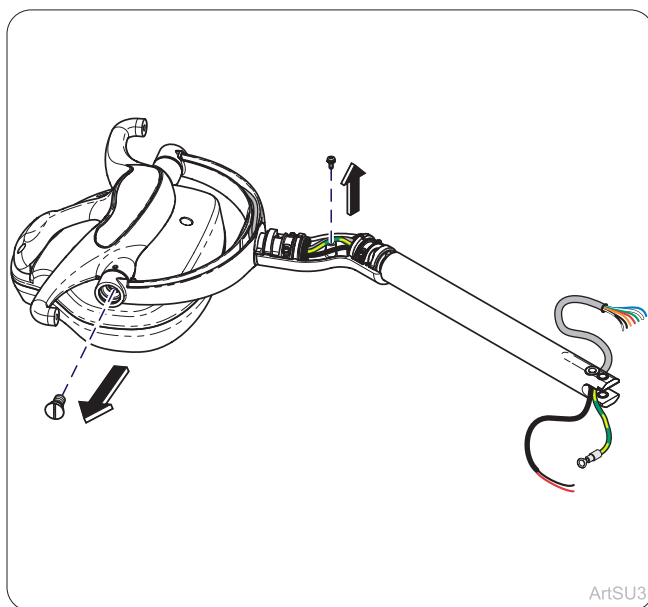

ArtSU3

Step 10:

Remove ground wires and adjustment screw from light yoke.

Note: Earlier versions of light will not have ground wire from light yoke to curved arm..

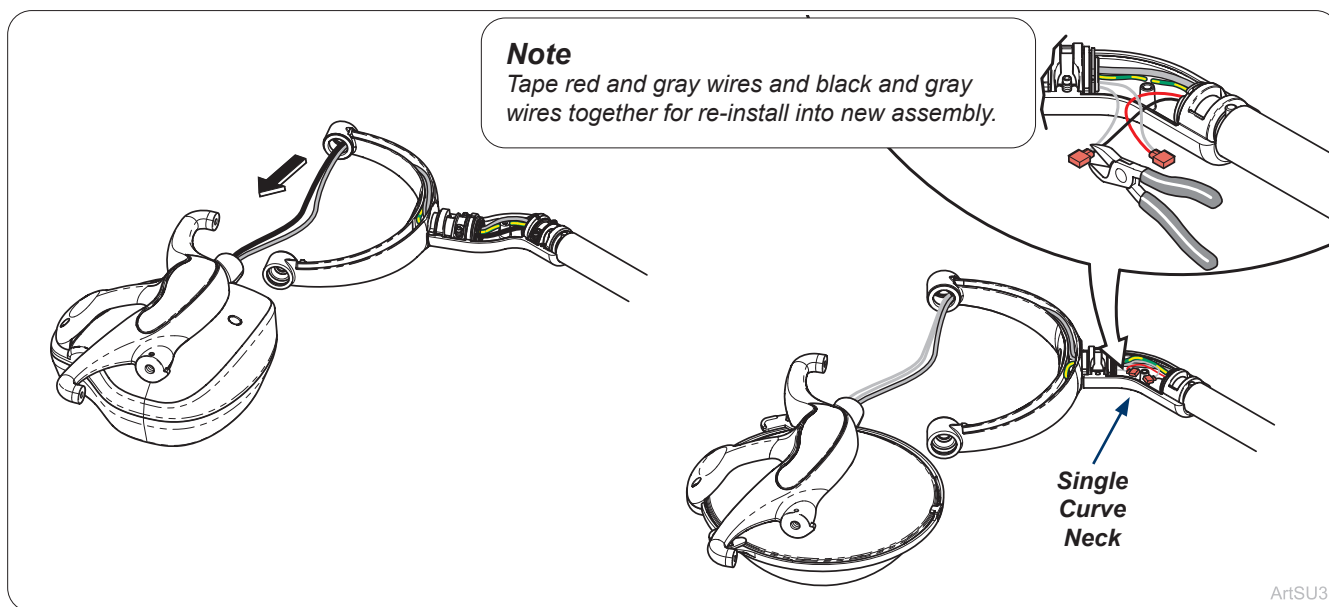

ArtSU3

Step 11: LED

Remove light head and wiring through post, neck and yoke.

Step 11: Halogen

Remove light head and wiring through post, neck and yoke.

Note: Earlier versions of lights will have single curve neck

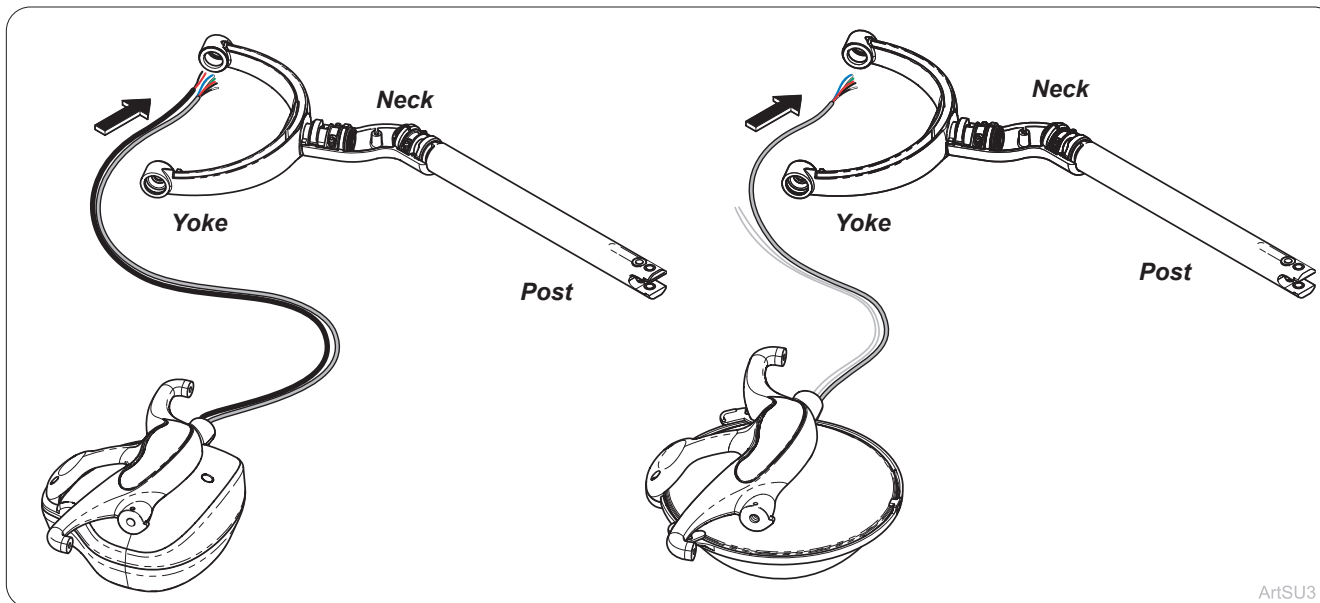

Step 12: LED
Reroute wires through yoke, neck and post.

Step 12: Halogen
Reroute wires through yoke, neck and post. .

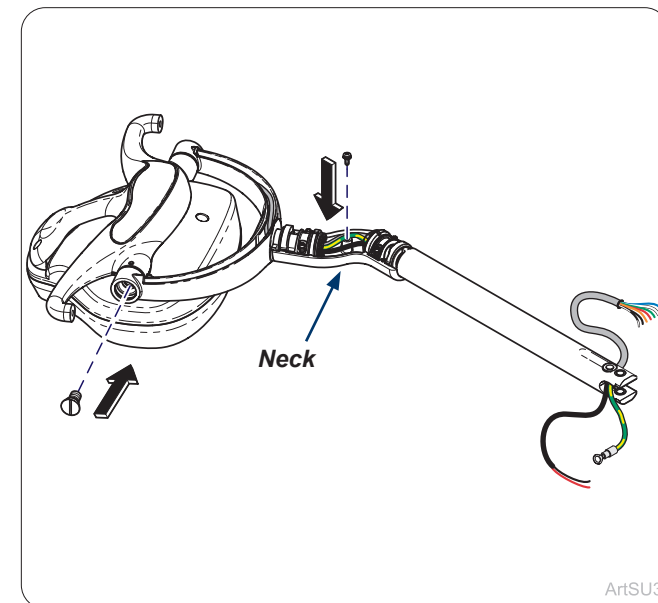

Step 13: LED
Install adjustment screw and ground wires onto neck.

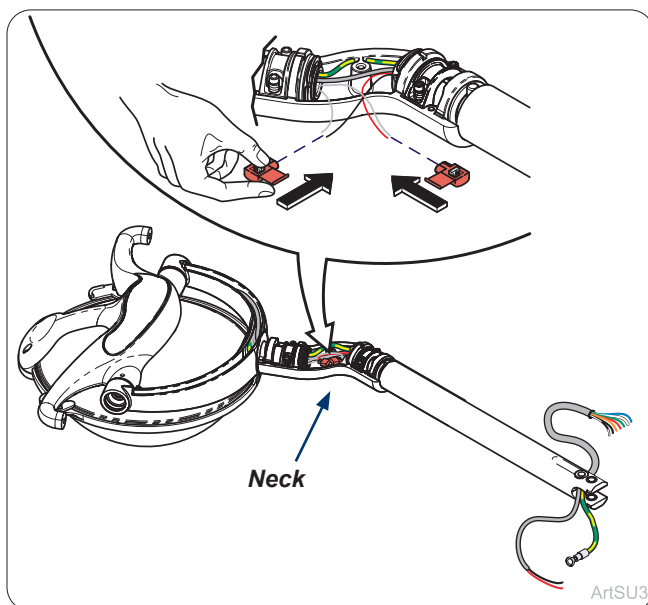

Step 13: Halogen
Make connection of wiring in neck use new connectors provided.

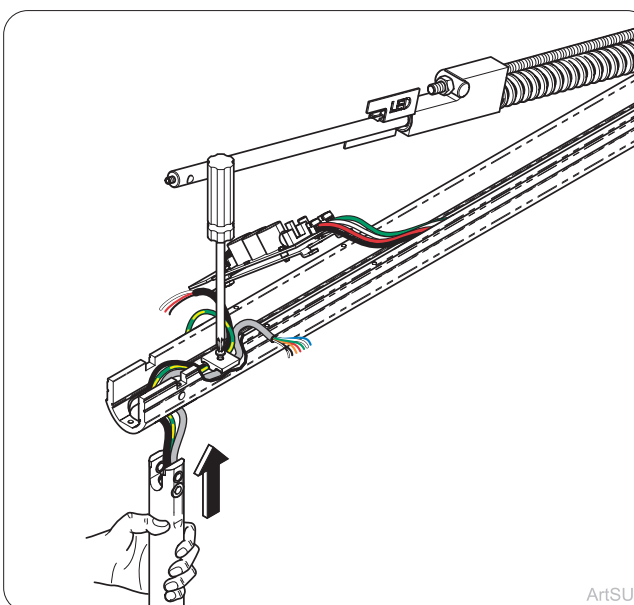

Step 14:
Run wires through bottom of flex arm and install wire holder.

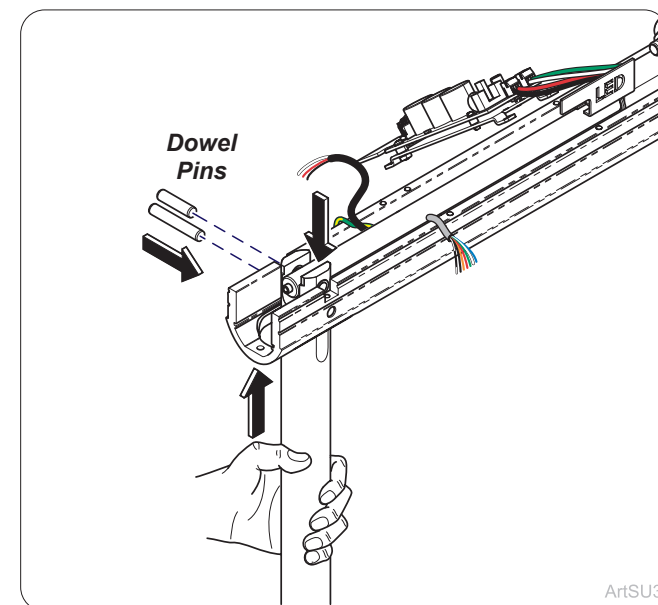

Step 15:
Install light post into bottom of flex arm with flex arm rod in place and insert dowel pins (2).

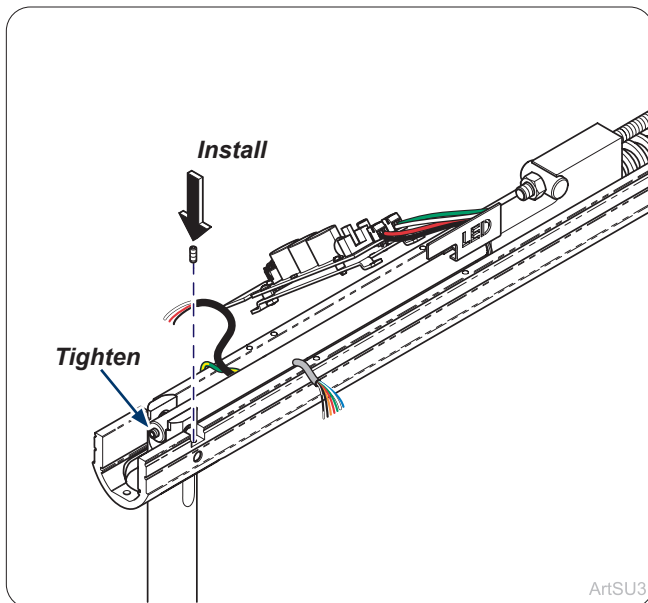

ArtSU3

Step 13:
Install set screw and retighten set screw.

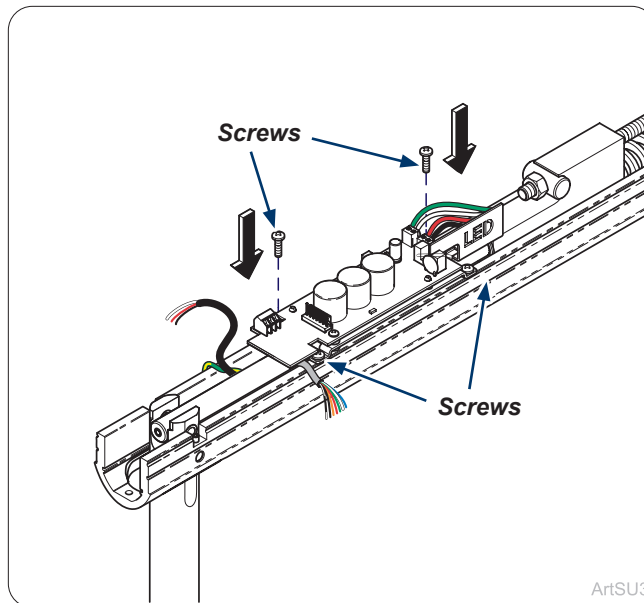

ArtSU3

Step 14:
Install PC Board assembly onto flex arm with screws (4).

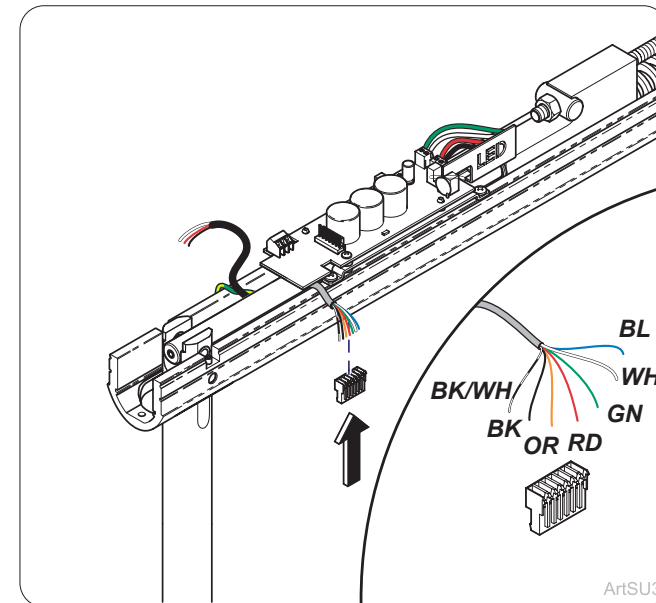

ArtSU3

Step 15:
Install new touch pad wire connector.

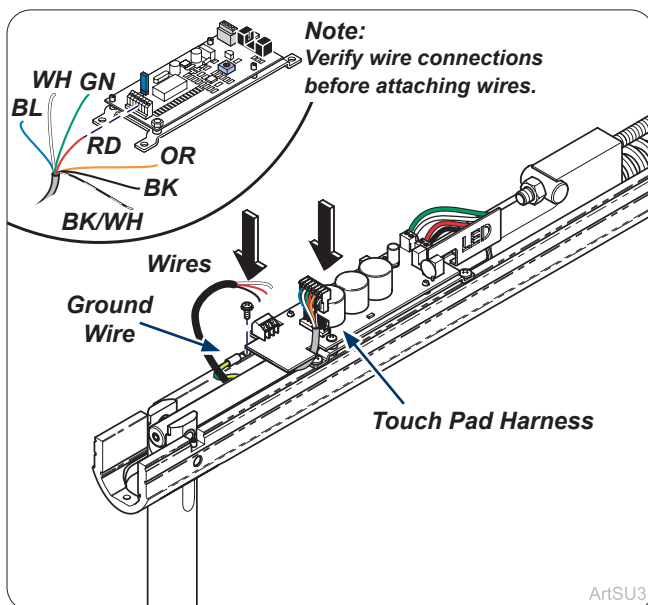

ArtSU3

Step 16:
Install ground wire and wiring to PC Board.

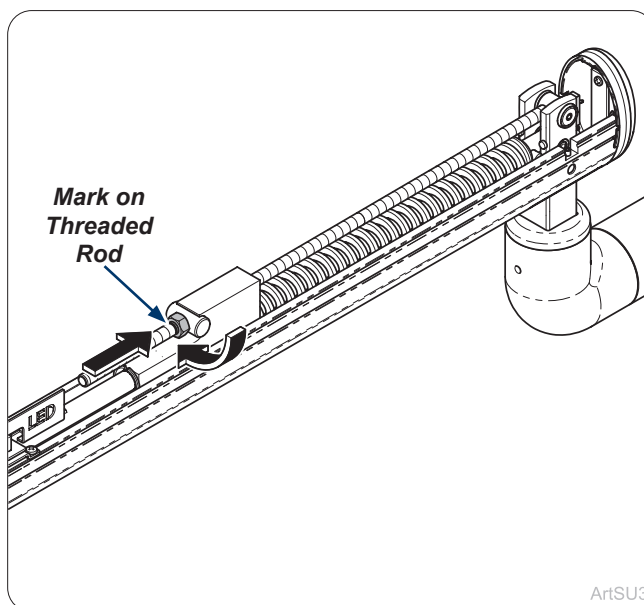

ArtSU3

Step 17:
Tighten spring tension with nut moving to the marked line on threaded rod.
Note: Test flex arm to make sure it does not drift.

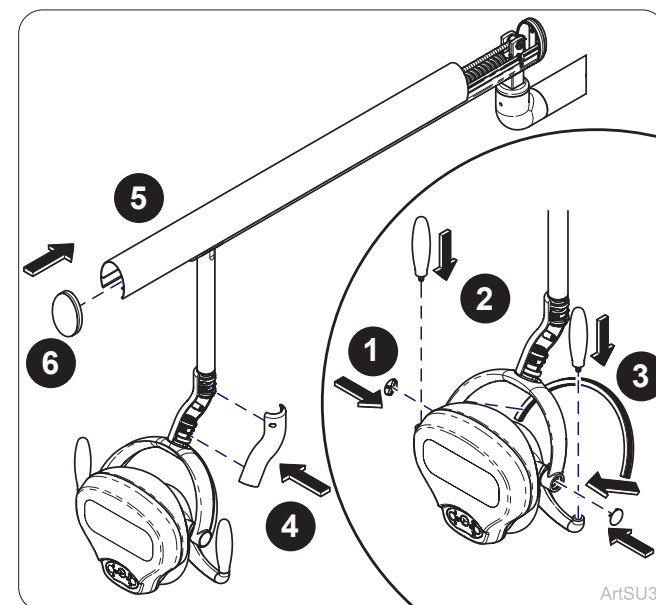

ArtSU3

Step 18:
Install covers, handles, flex arm cover and cap as shown.