



## WARNING

Always disconnect power before removing covers or performing any service procedures.



## Caution

Use eye protection, protective gloves and any other PPE before removing used filter. Dispose of per local codes/regulations.

### Step 1: Remove locking knobs.

Remove six locking knobs.

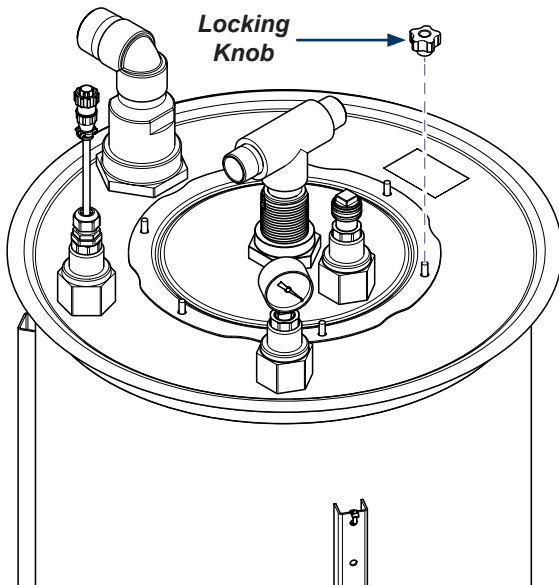

AAF2789

### Step 2: Accessing filter.

Lift filter assembly from separator tank.

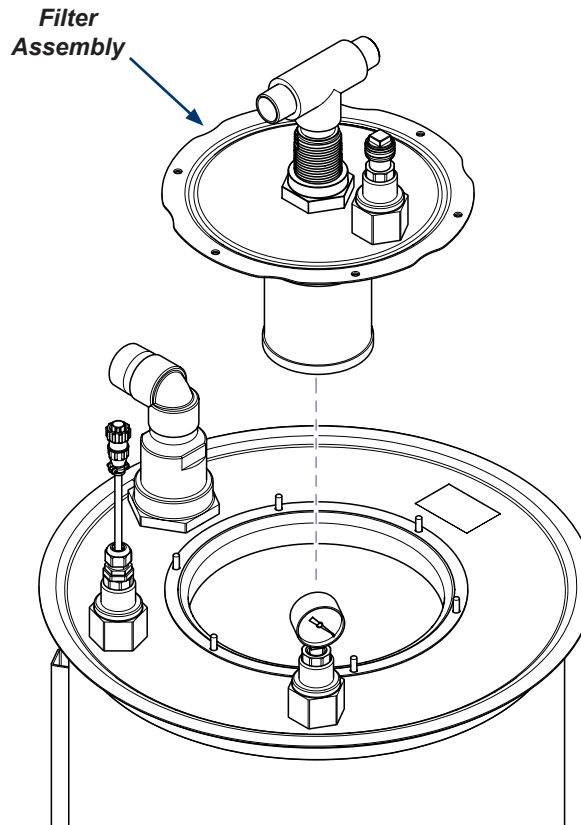

AAF2790

### Step 3: Remove filter.

A) Remove locking knob.  
B) Remove filter.

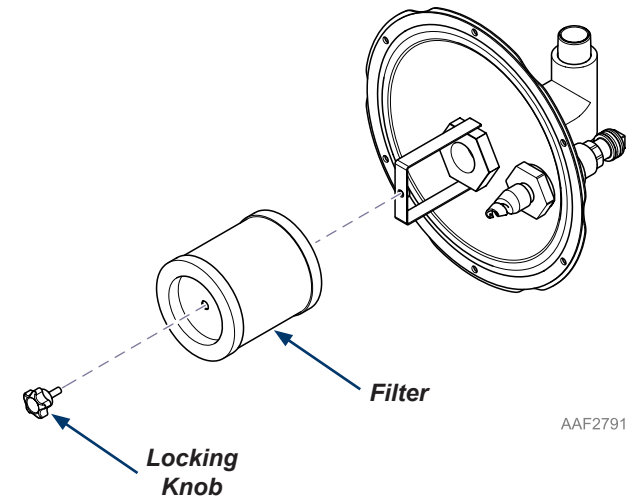

AAF2791

### Step 4: Reassemble.

A) Install new filter and secure with locking knob.  
B) Place filter assembly into separator tank.  
C) Secure filter assembly with six locking knobs.