



WARNING

Always disconnect power before removing covers or performing any service procedures.



Caution

Use eye protection, protective gloves and any other PPE before removing used lid. Dispose of per local codes/regulations.



Equipment Alert

Wrap threads on fittings with Sealing Tape to prevent leakage.

Note

Lid Gasket and Pressure Sensor will be reused on replacement tank lid.

Step 1:

Disconnect hoses from lid assembly.

Note

Hose fittings will be reused.

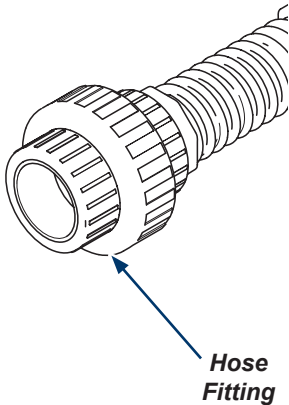

Lid Gasket

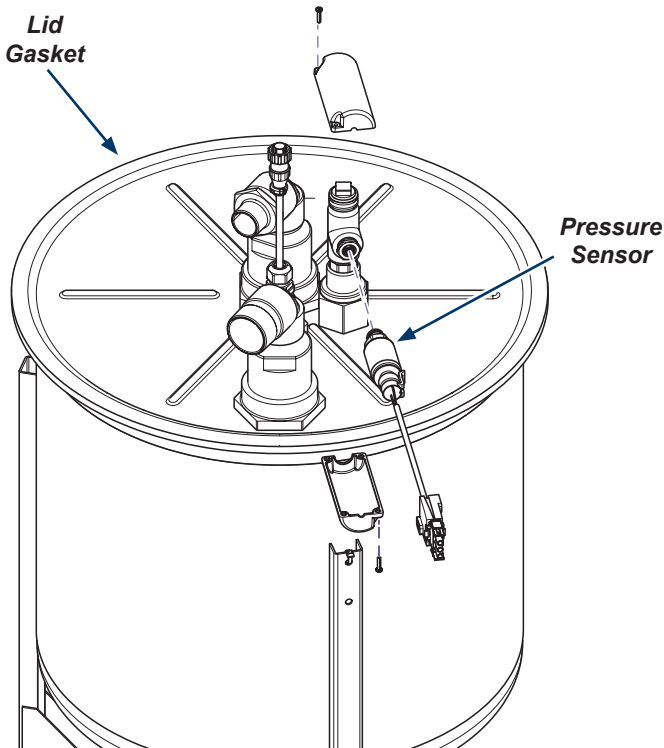

Step 3:

Remove old lid from separator tank.

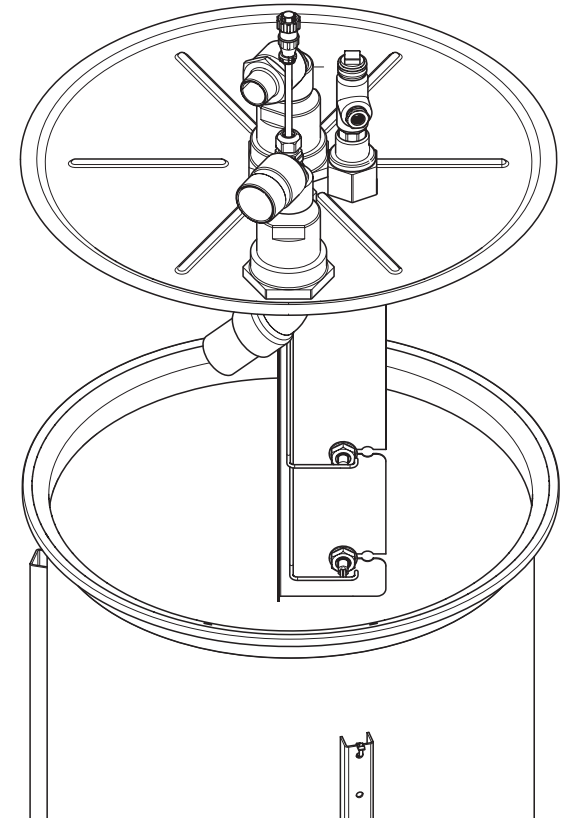

**Equipment Alert**

Ensure Floats are not touching the side of Separator Tank.

Note

Point floats towards inlet as shown.

Note

Bulkhead fittings are Left Hand thread.

Step 4:

Install bulkhead fittings and float assembly.

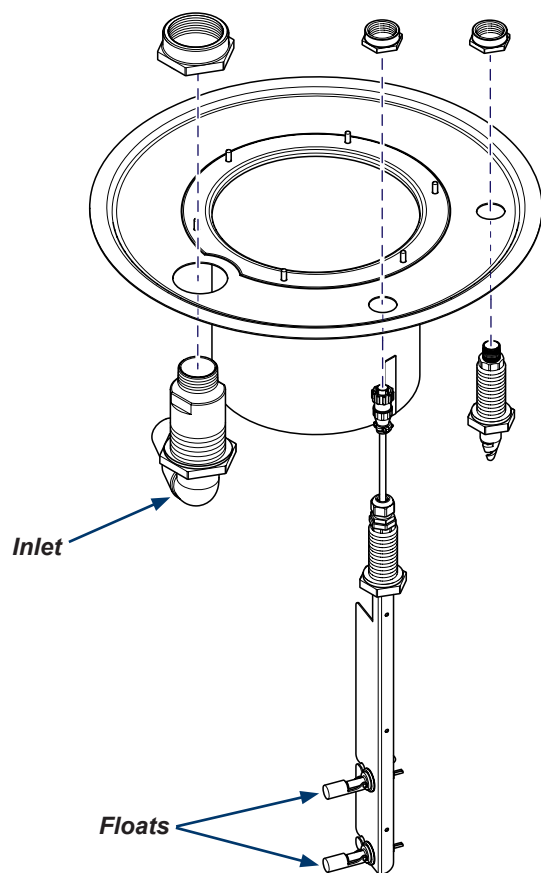
**Step 5:**

Install elbow and pressure sensor tee fitting.

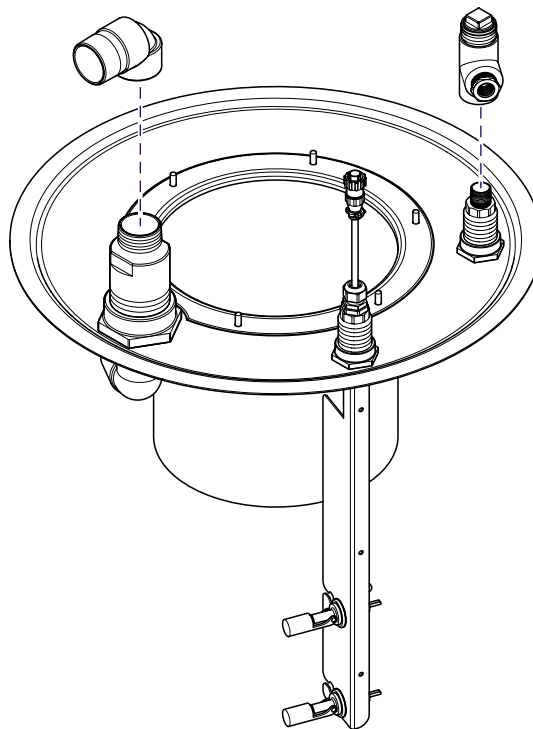
**Step 6:**

Install gasket and place new lid onto separator tank.

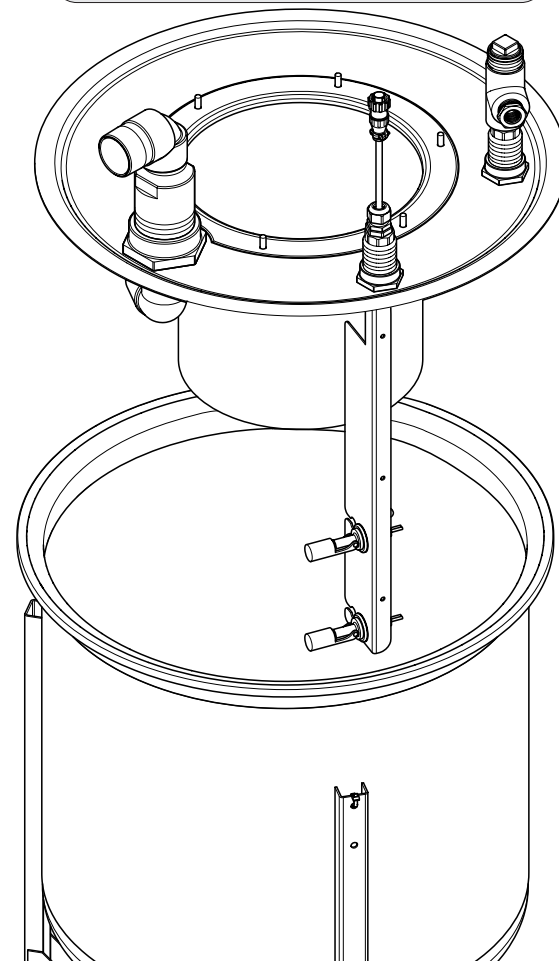

Step 7:

Install and connect pressure sensor.

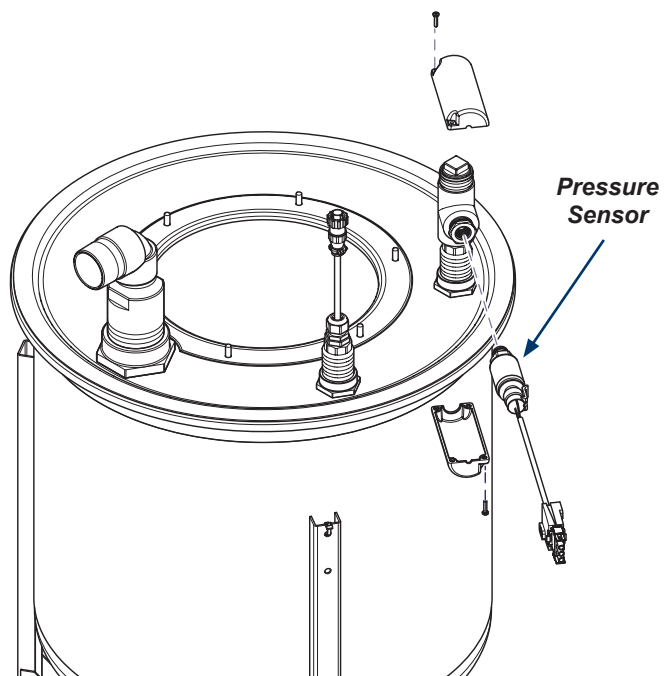

Step 8:

Remove locking knob and filter from filter assembly.

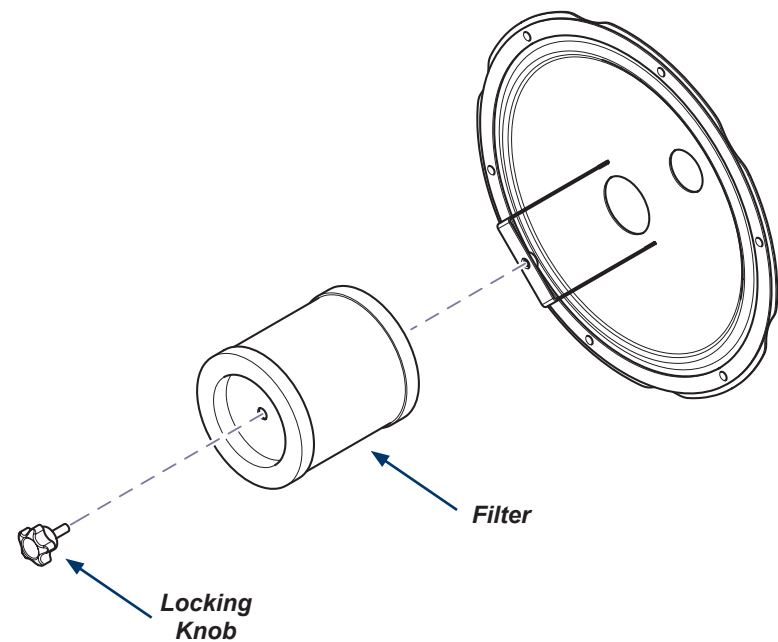

Note

Bulkhead fittings are Left Hand thread.

Step 9:

Install bulkhead fittings to filter assembly.

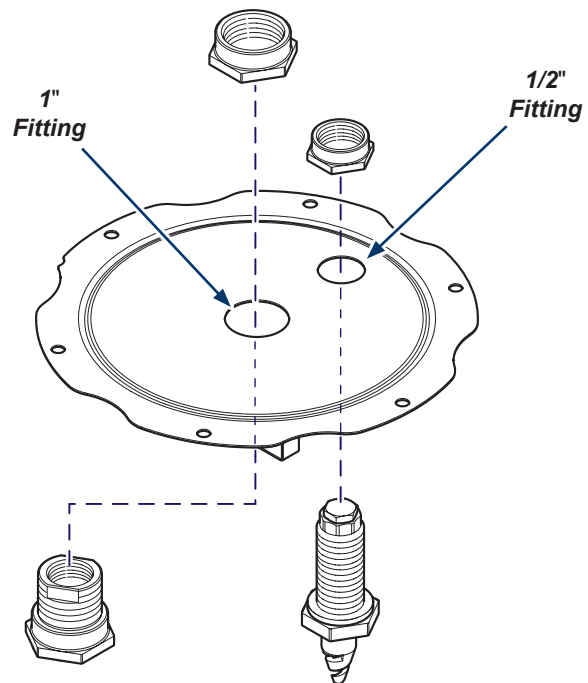

Step 10:

Install vacuum inlet tee.

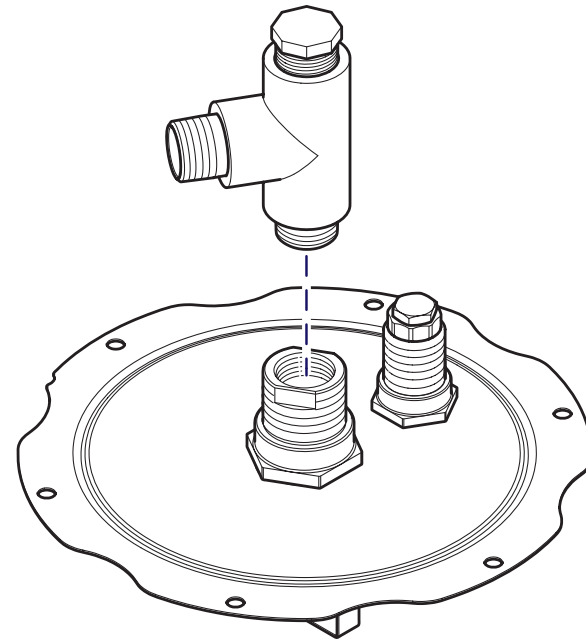

Step 11:

Install filter and secure with locking knob.

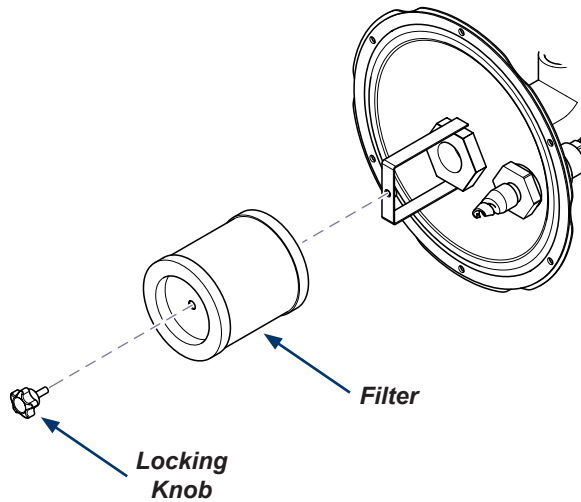
**Step 12:**

Place filter assembly onto separator lid.

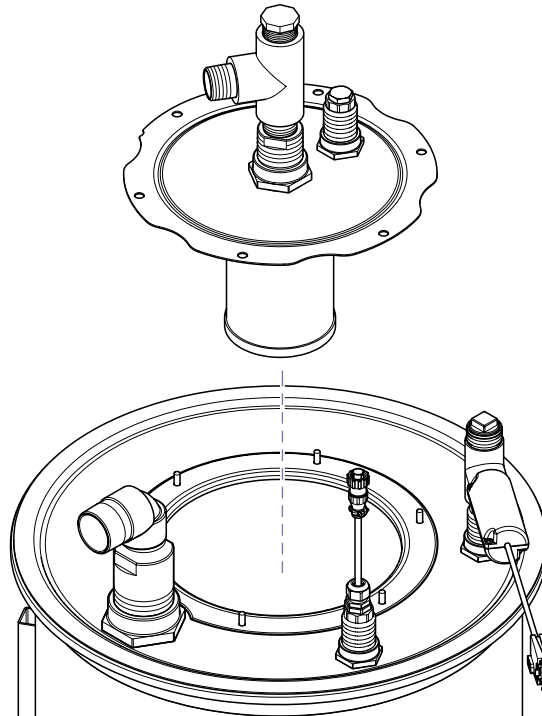
**Step 13:**

Secure filter assembly with six locking knobs.

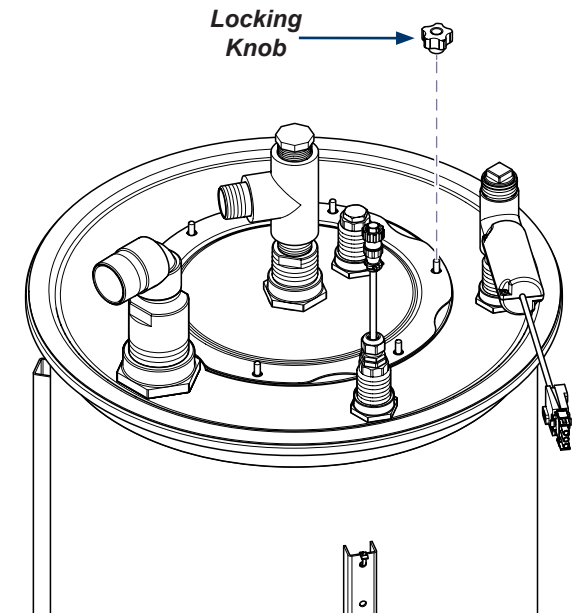
**Step 14:**

Reconnect hoses to lid assembly.

Note

Unless previously adjusted, the pre-set factory vacuum pressure setting is 12inHg.

Step 15:

Turn the unit on and verify vacuum is reaching it's pressure setting via the keypad display on the base. Listen for leaks and tighten any loose fittings.