

# M9® and M11® Gasket Housing Kit

002-10449-00 M9  
002-10449-01 M11

## Applies to Models:

M9 (-050/-053)

M11 (-050/-051/-053)

## Special Tools:

T25 Torx Screw Driver



### WARNING

To prevent risk of shock always disconnect power before removing covers or performing any service procedure.



### WARNING

Allow to cool to ambient / room temperature prior to removing cover. Release pressure by pulling ring of pressure relief valve if necessary.

## Step 1: Disconnect power.

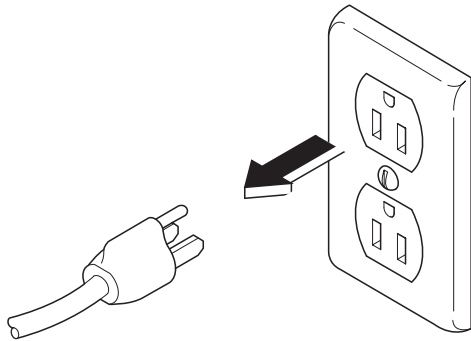

## Step 2: Remove door and dam gaskets.

- Unplug sterilizer, Allow to cool, Open door.
- Remove dam gasket by pulling it off the door studs.
- Remove door gasket by pulling it out of the gasket housing.

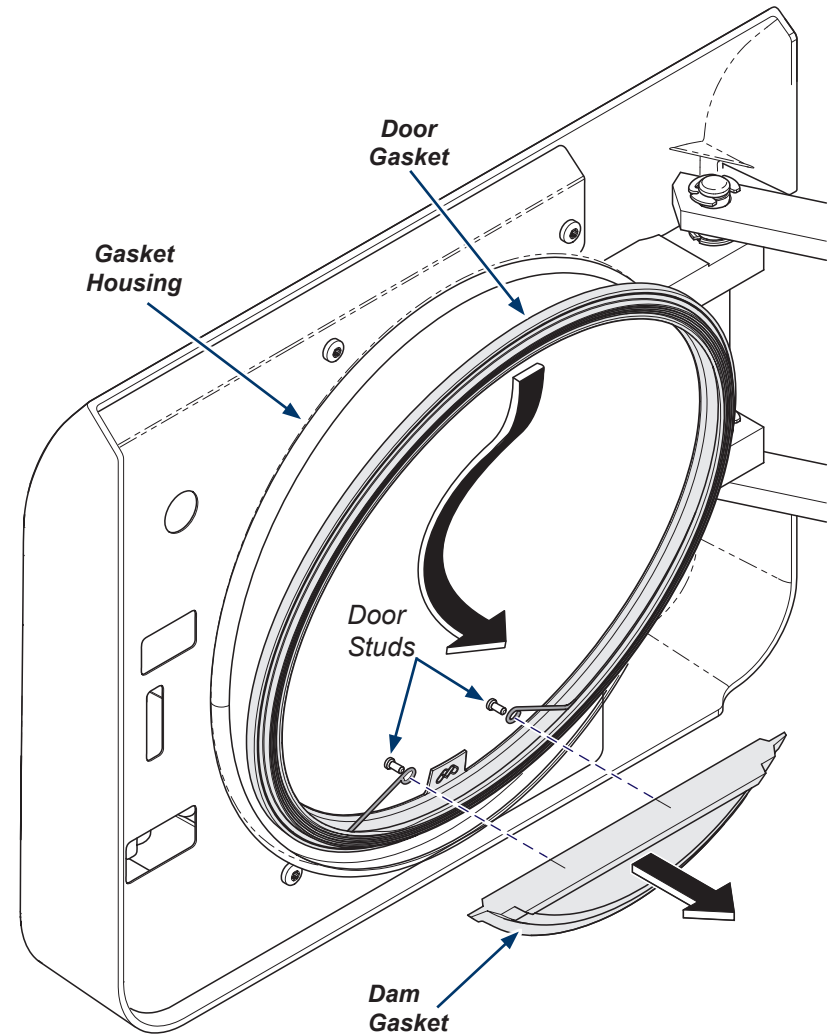

**Step 3: Remove door screws.**

A) Remove four screws to release covers from door.

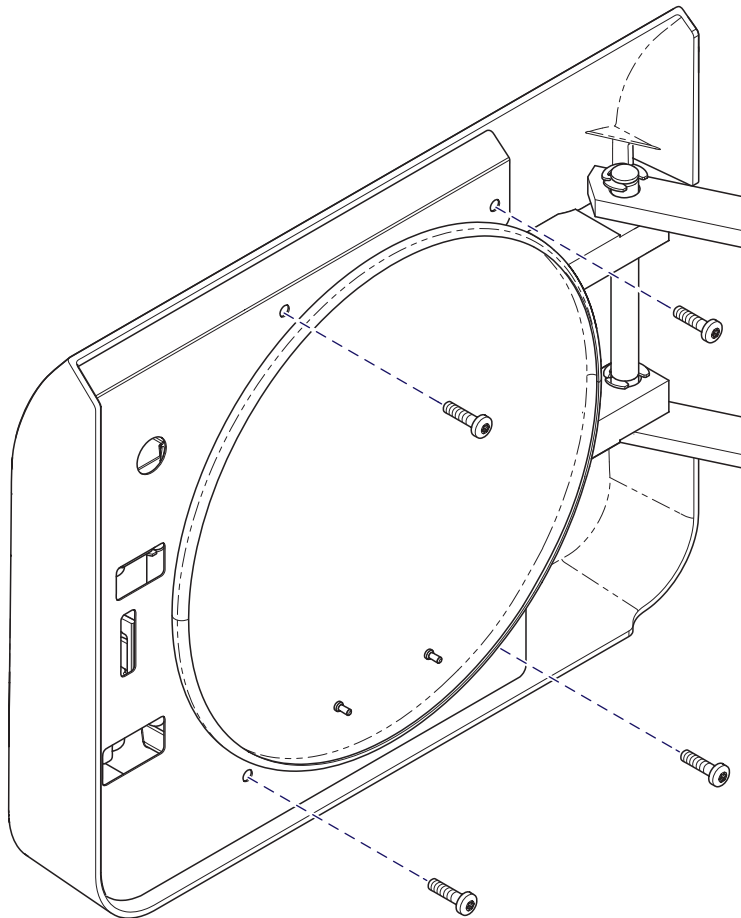

**Step 4: Remove inside door cover.**

A) Pull out on lower left corner of inside cover.

B) Flex cover slightly and remove from door assembly.

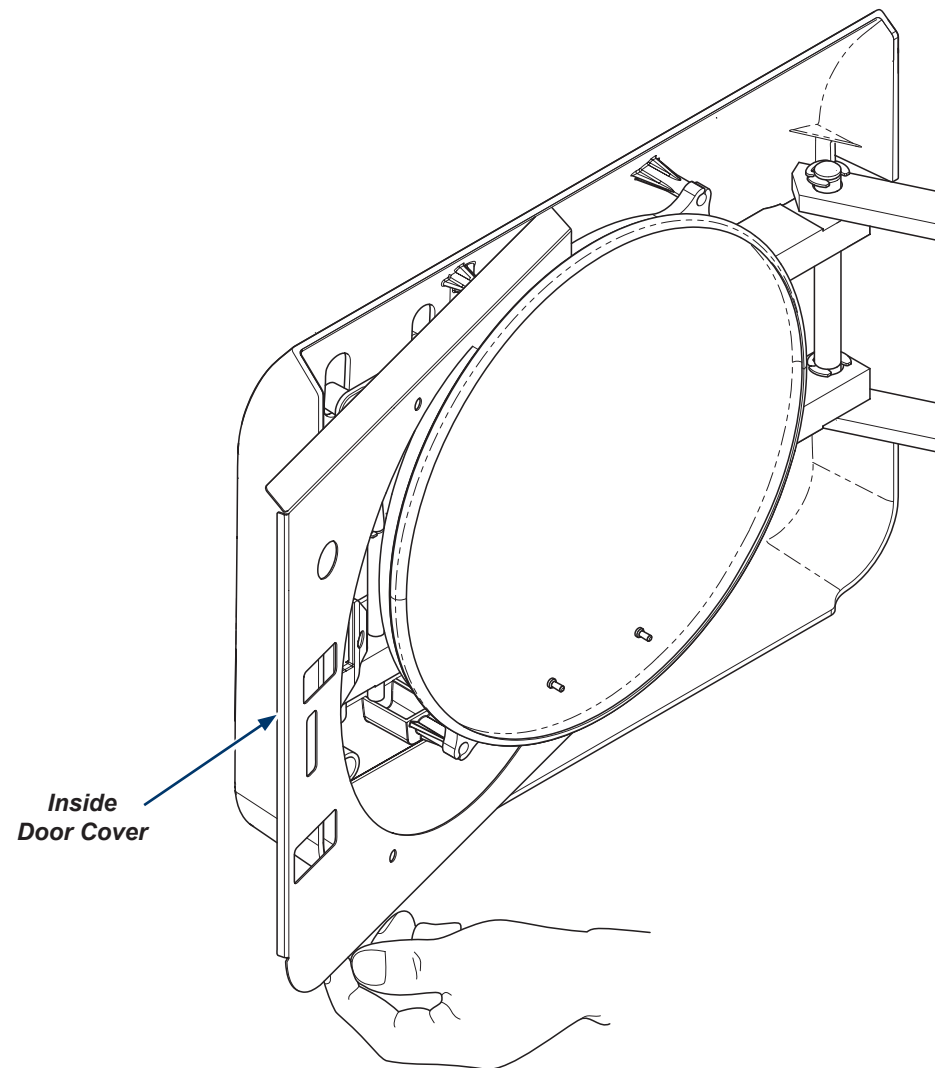

**Step 5: Remove door handle.**

- A) Remove two mounting screws.
- B) Remove door handle.

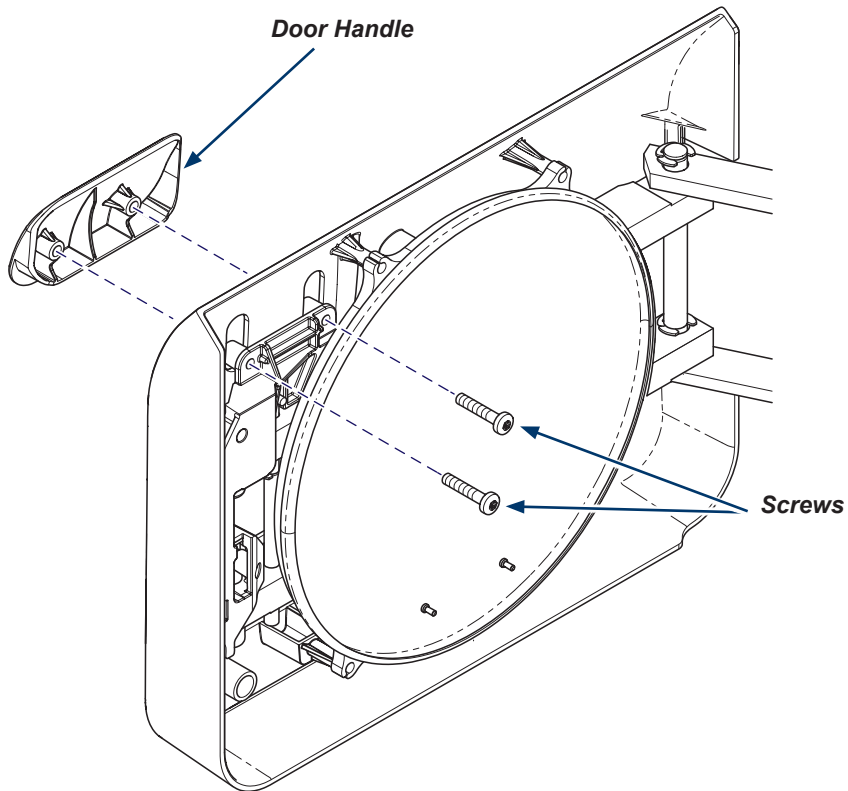

**Step 6: Remove outside door cover.**

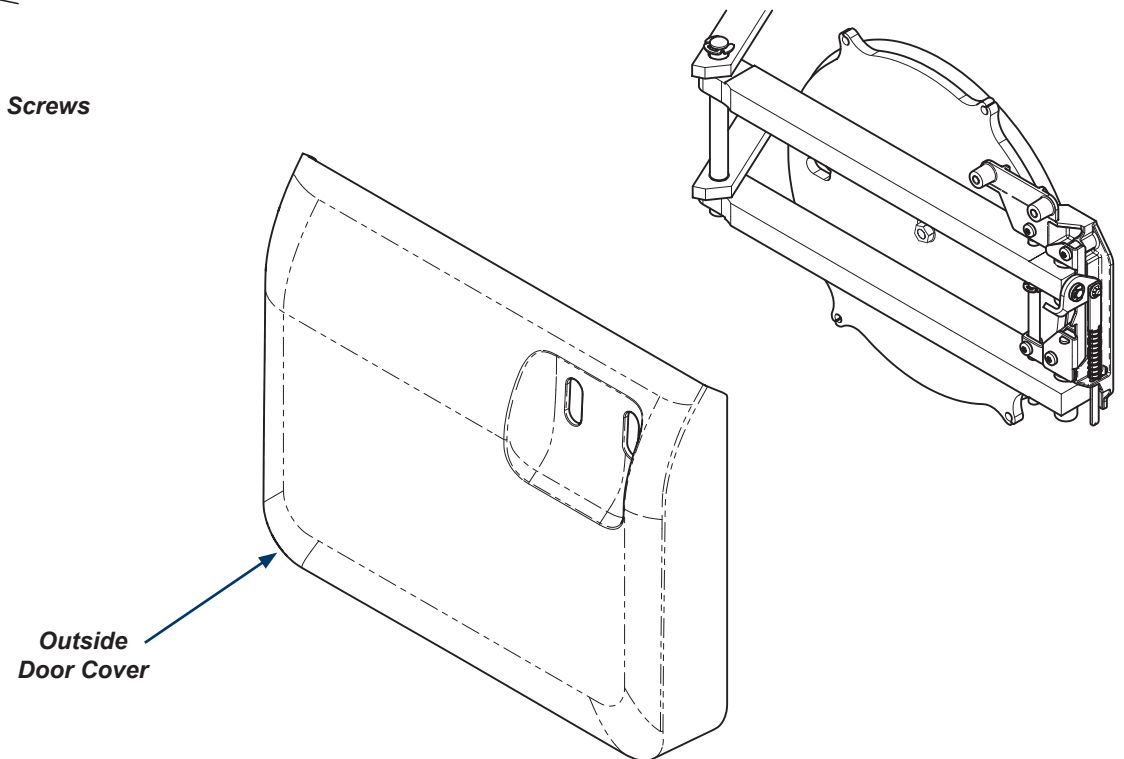

SAF2334i

**Step 7: Mark gasket housing position.**

- A) Use a permanent marker around the gasket housing nut to record it's location for correct reassembly.

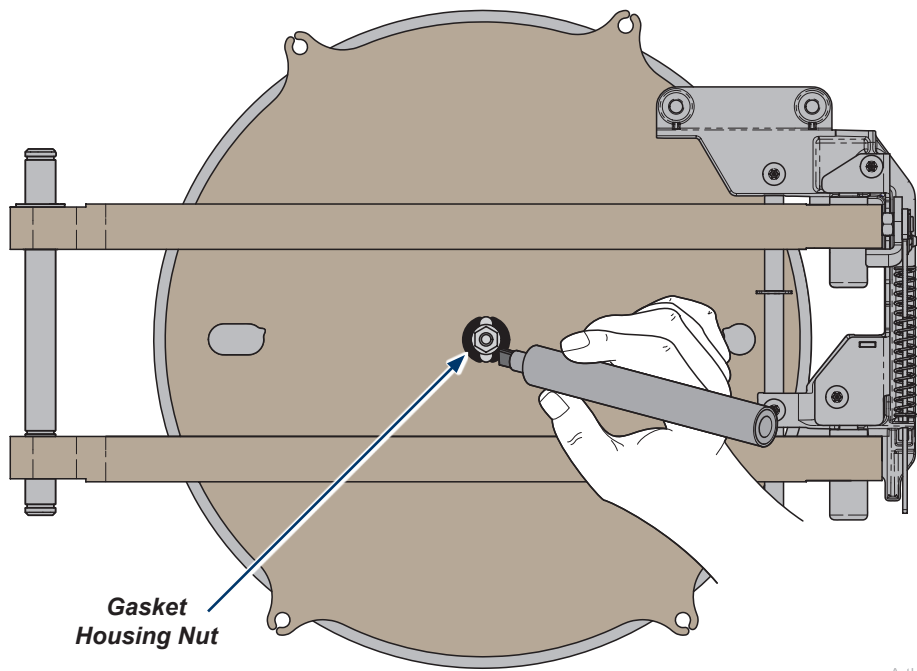

ArtHalf

**Step 8: Remove gasket housing and insulation pad.**

- A) Remove gasket housing nut.  
B) Remove gasket housing.  
C) Remove insulation pad.

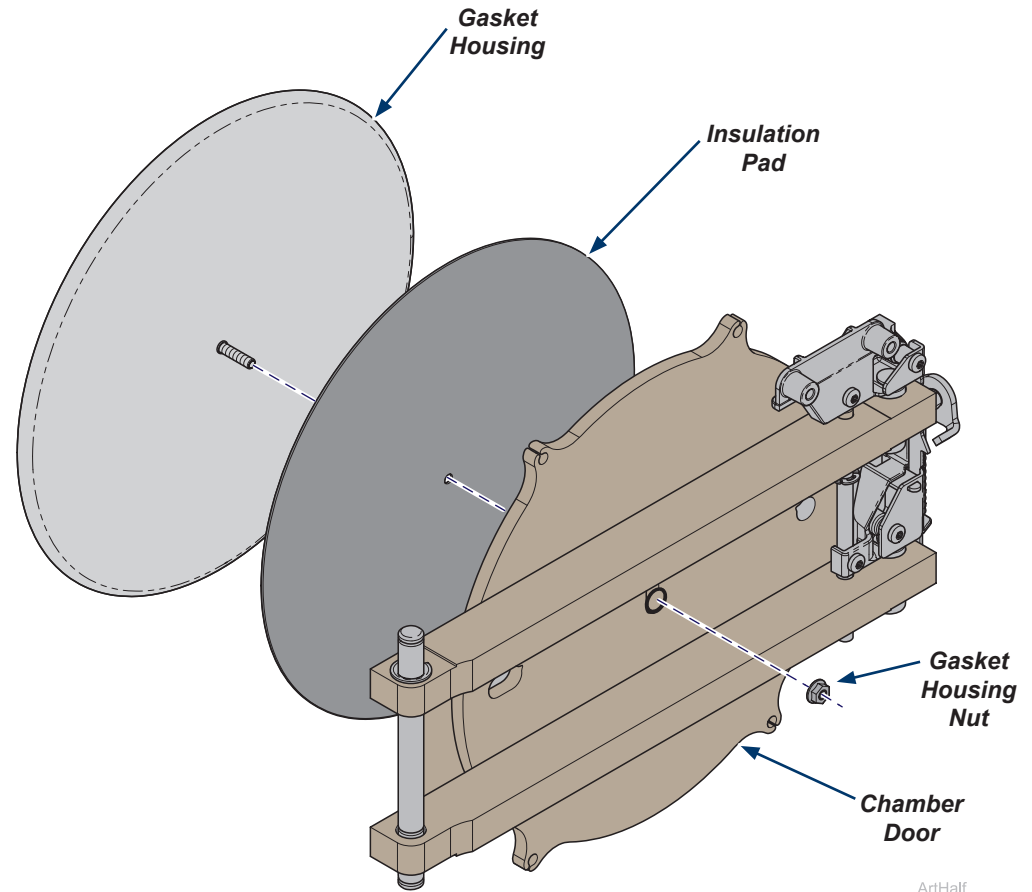

ArtHalf

### Step 9: Install gasket housing.

- A) Position gasket housing threaded rod into new insulation pad then through hole on chamber door.
- B) Aligning the marks around the gasket housing nut.
- C) Hand tighten gasket housing with gasket housing nut.

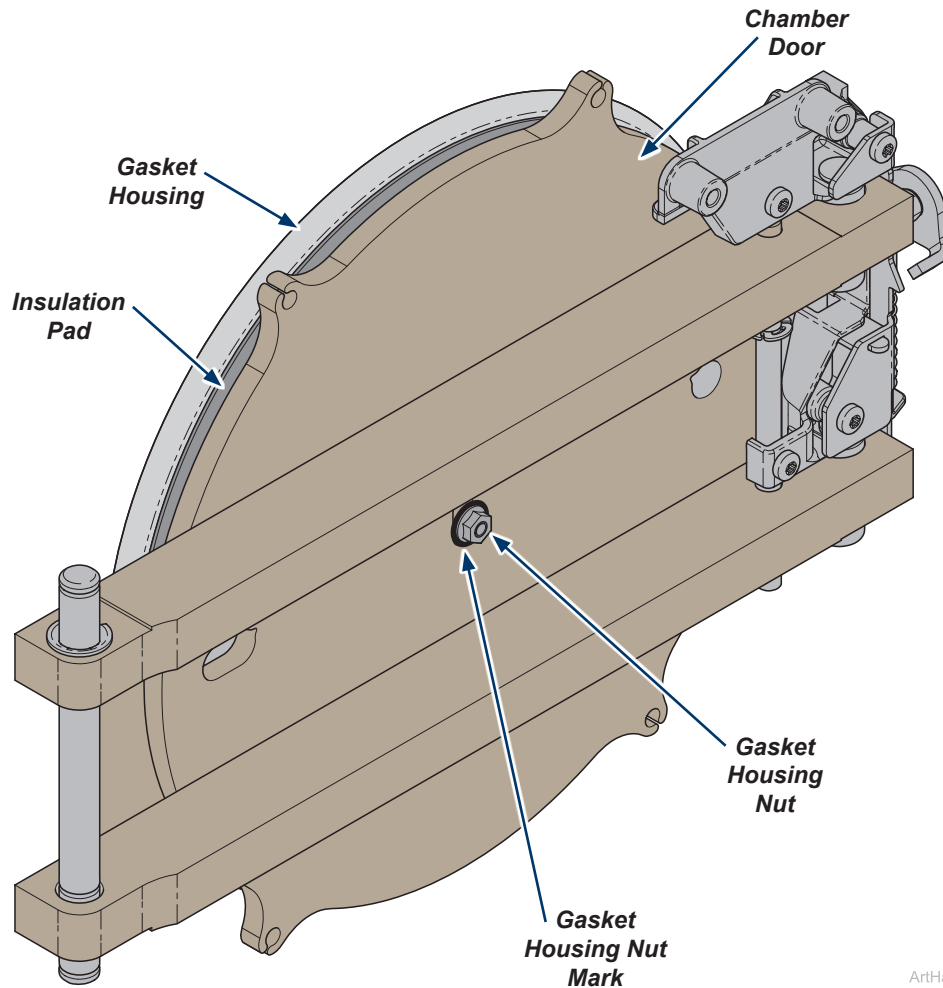

### Step 10: Install Door Gasket.

- A) Install door gasket into bottom of the gasket housing and center tab between door studs.
- B) Install left and right sides and finish at top.
- C) Install gasket ring eyelets onto door studs, work gasket ring into v-groove of door gasket. Start on left and right sides and finish at top.
- D) Make sure door gasket fits evenly and flush all the way around gasket housing.

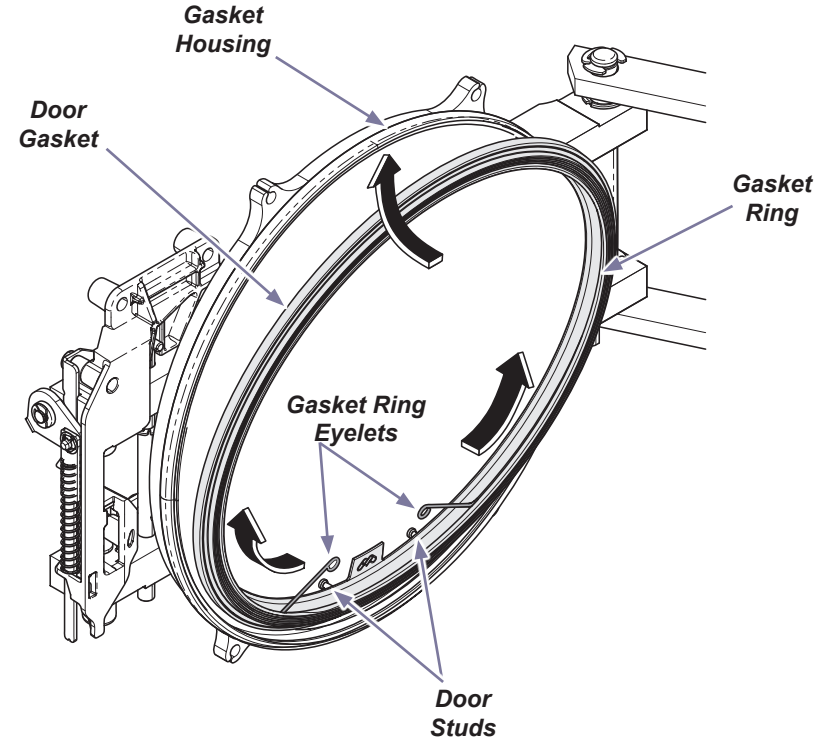

### Step 11 : Install Dam Gasket.

- A) Align dam gasket holes over the door studs.
- B) Tuck bottom edge of dam gasket into the center v-groove of door gasket.
- C) Push dam gasket on to studs until it lies flat against the door.

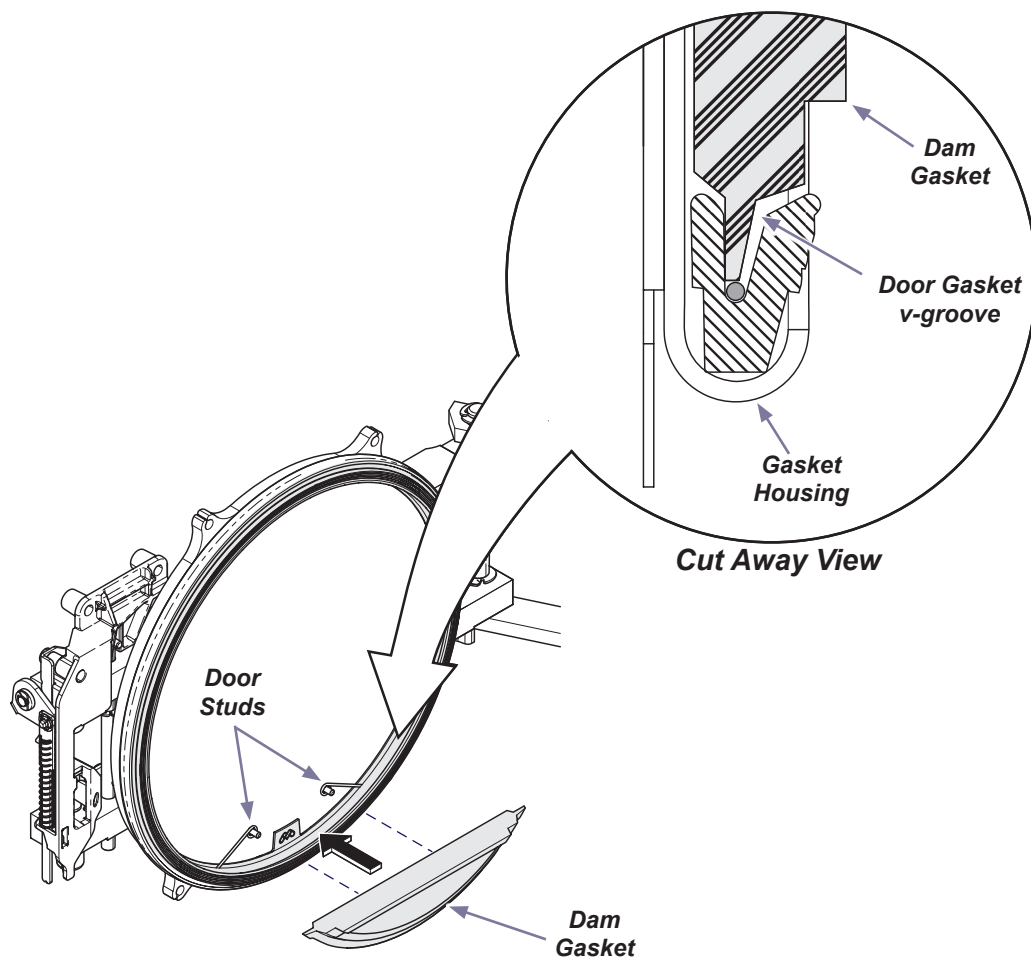

### Step 12 : Align gasket housing and secure.

- A) Align dam gasket with front chamber opening by rotating the gasket housing.
- B) Make sure marks around the gasket housing nut are aligned and finish tightening gasket housing nut from step 9.

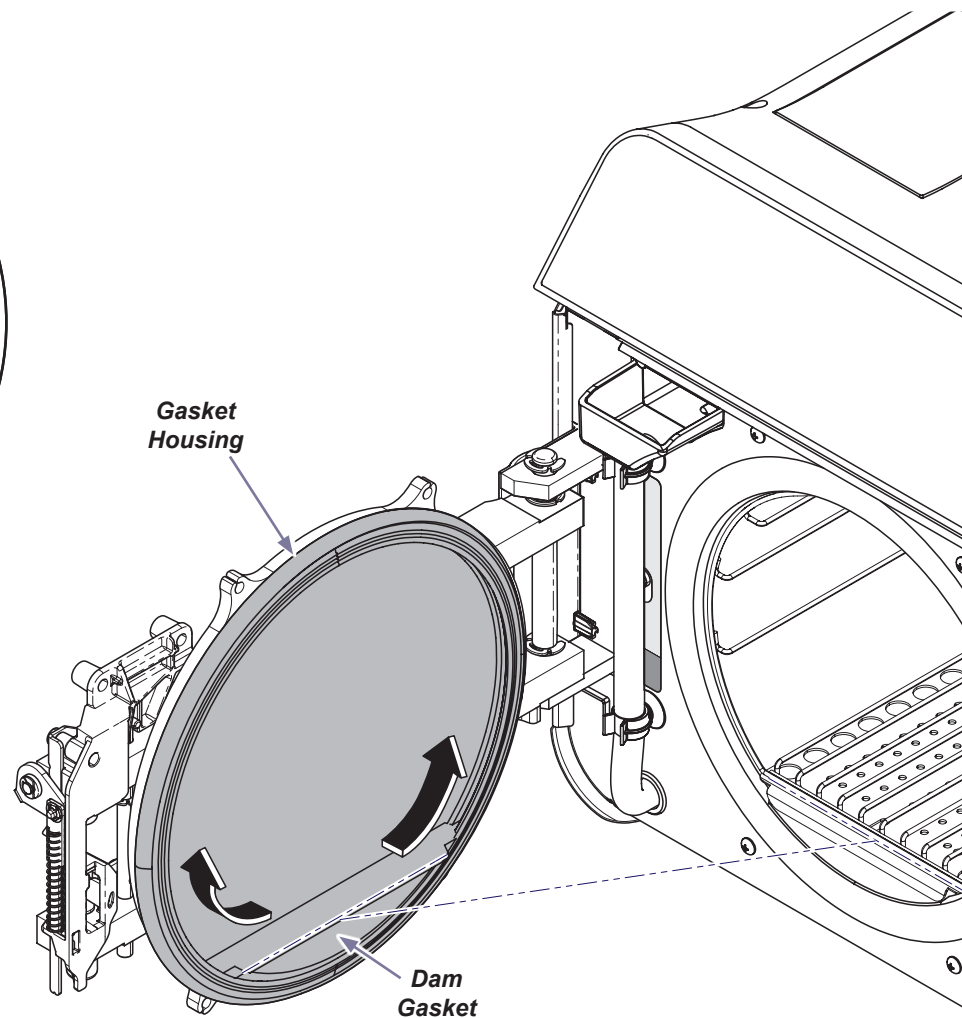

Arthalf

**Step 13: Install covers, door handle.**

- A) Position outside door cover in place.
- B) Install door handle.
- C) Position inside door cover and secure to outside door cover with screws.

**Step 14: Qualification Testing.**

- A) Qualification Testing Cycles should be ran after this repair is completed. (Refer to the user guide for details.)

*If the sterilizer is connected to Smart View, a Request Qualification Testing should be setup on the sterilizer display following the below steps:*

- Press the Menu Button .
- Select Settings.
- Select Service.
- Select Troubleshooting.
- Select Qualification Testing.
- Select Request Qualification Testing.
- Select Yes, Request Qualification Testing.

**Note:** Once qualification testing has been requested, this page will track testing status. The user interface will ask the user if the cycle they are attempting to run is a qualification cycle until the three (3) qualification cycles are completed.