

M9® and M11® Insulation Pad Kit

002-10450-00 M9
002-10450-01 M11

Applies to Models:

M9 (-050/-053)

M11 (-050/-051/-053)

Special Tools:

T25 Torx Screw Driver



WARNING

To prevent risk of shock always disconnect power before removing covers or performing any service procedure.



WARNING

Allow to cool to ambient / room temperature prior to removing cover. Release pressure by pulling ring of pressure relief valve if necessary.

Step 1: Disconnect power.

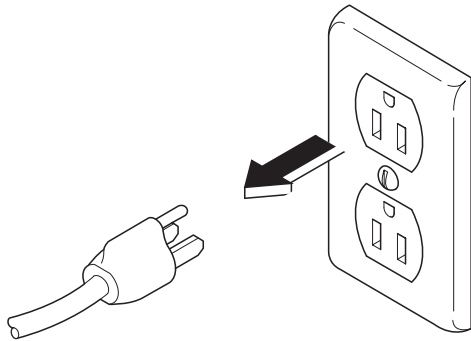

Step 2: Remove door and dam gaskets.

A) Unplug sterilizer, Allow to cool, Open door.

B) Remove dam gasket by pulling it off the door studs.

C) Remove door gasket by pulling it out of the gasket housing.

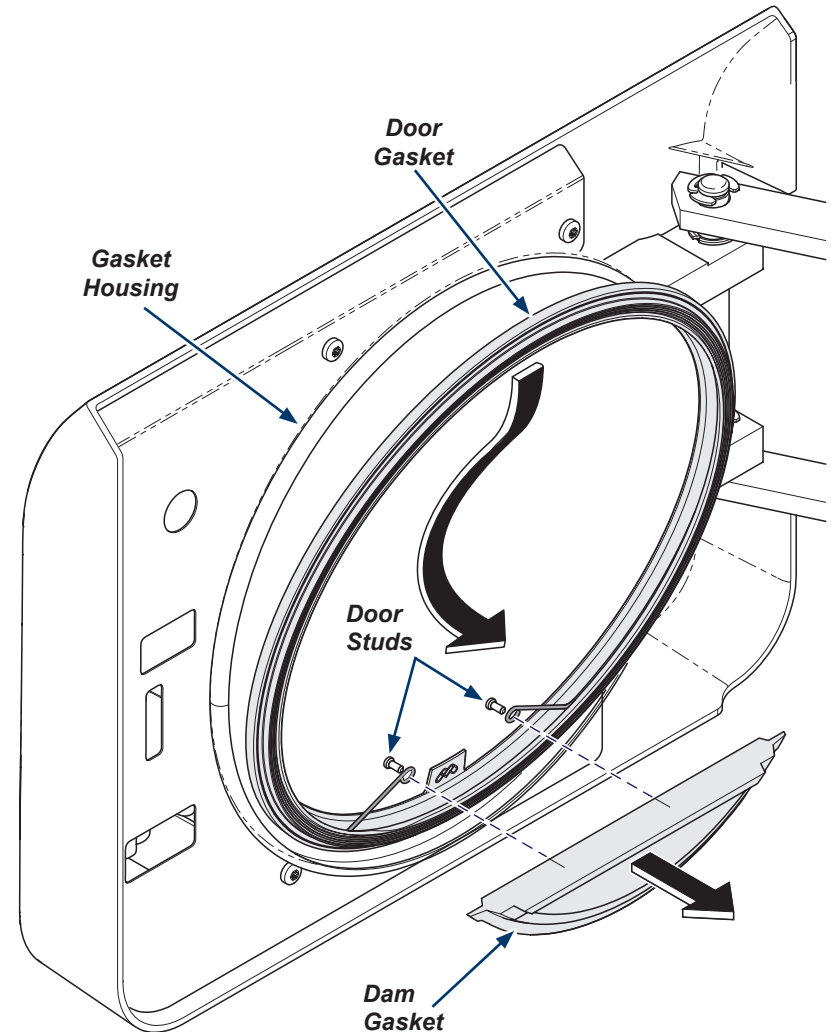

Step 3: Remove door screws.

A) Remove four screws to release covers from door.

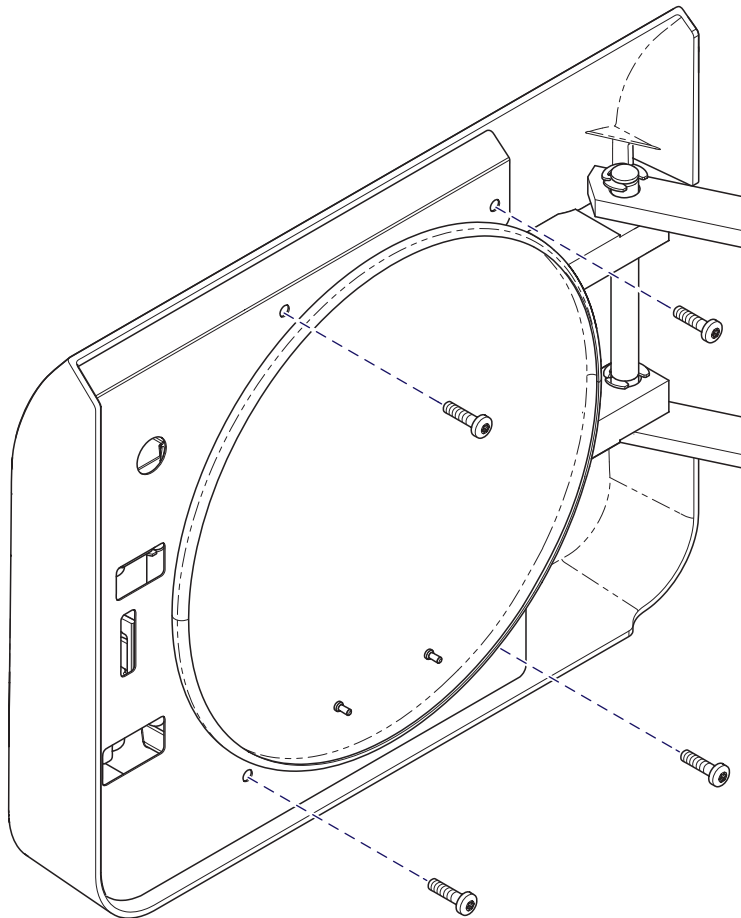

Step 4: Remove inside door cover.

A) Pull out on lower left corner of inside cover.

B) Flex cover slightly and remove from door assembly.

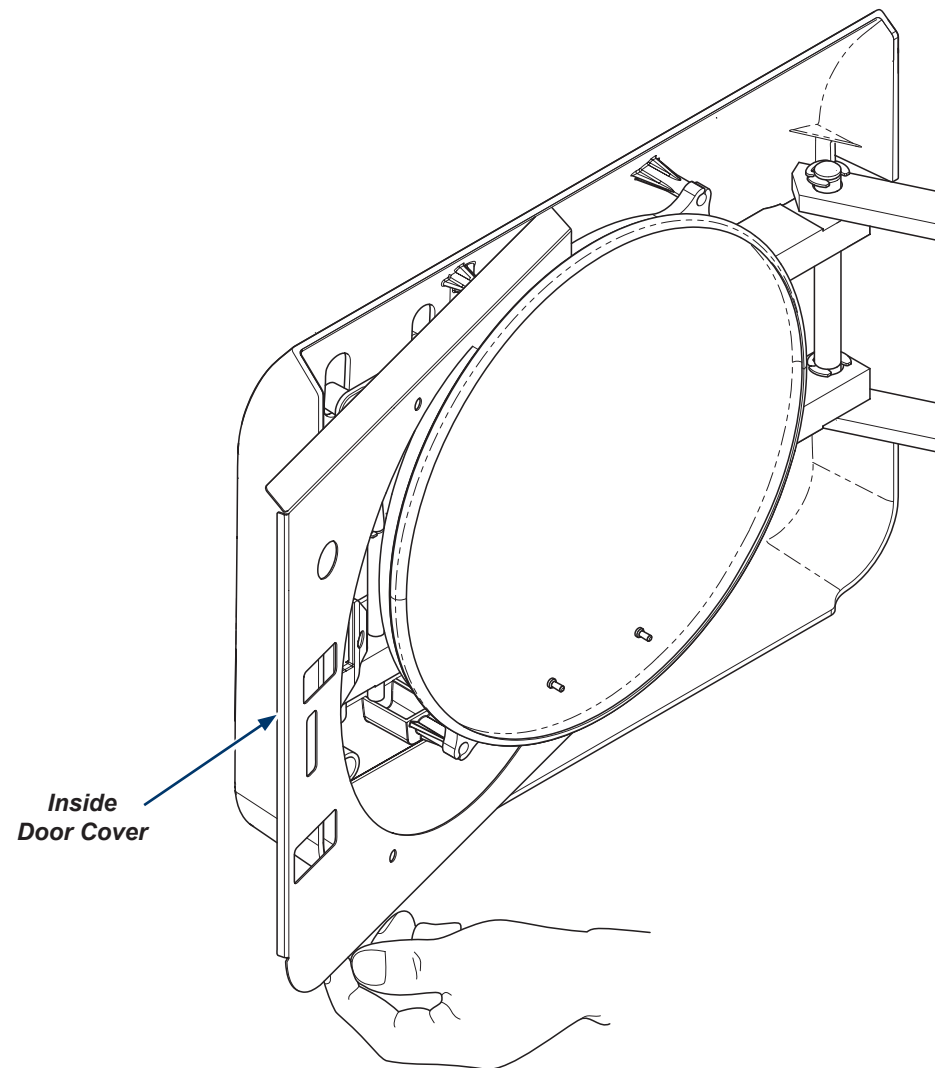

Step 5: Remove door handle.

- A) Remove two mounting screws.
- B) Remove door handle.

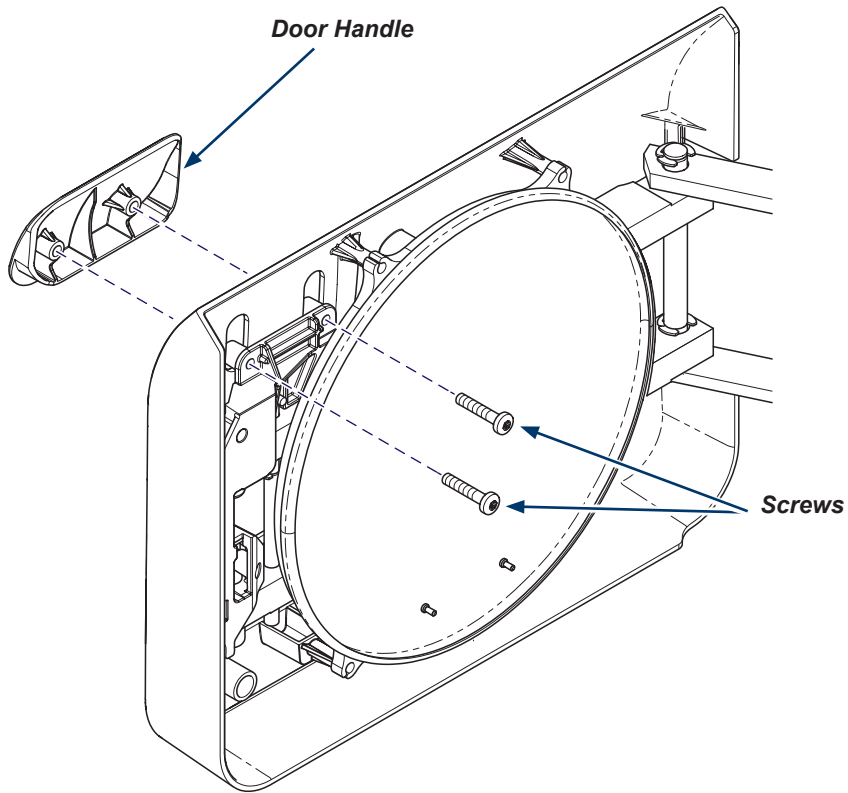

Step 6: Remove outside door cover.

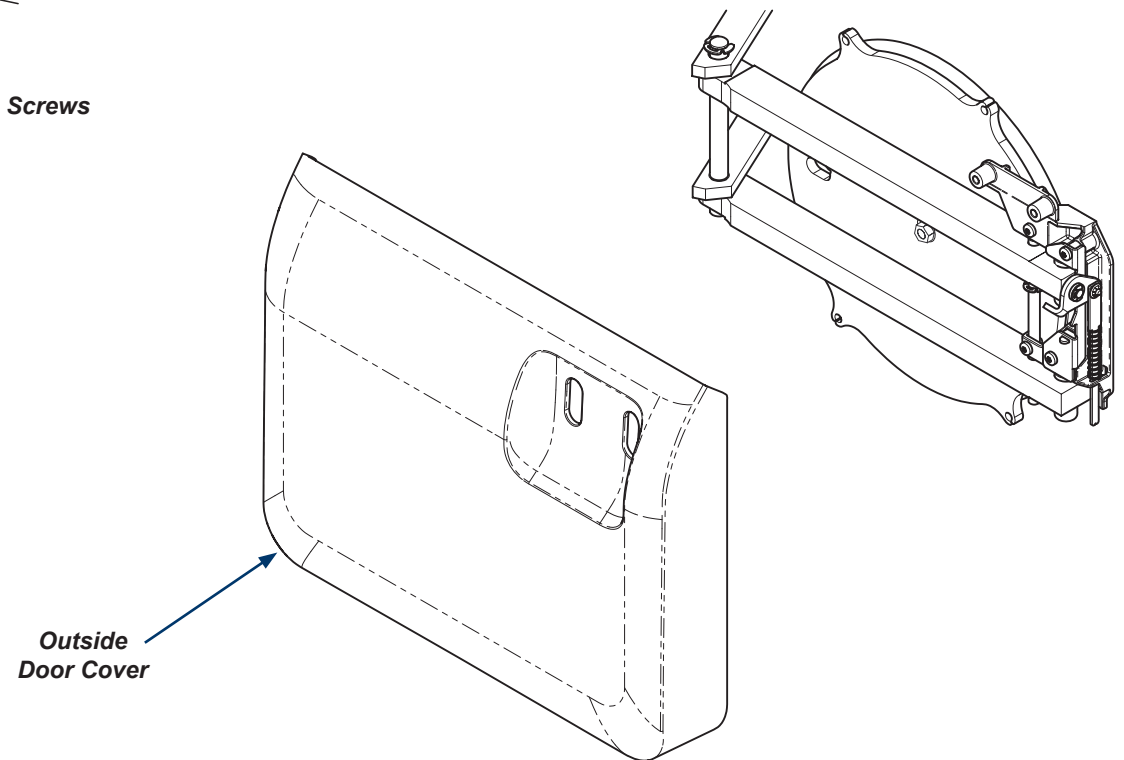

SAF2334i

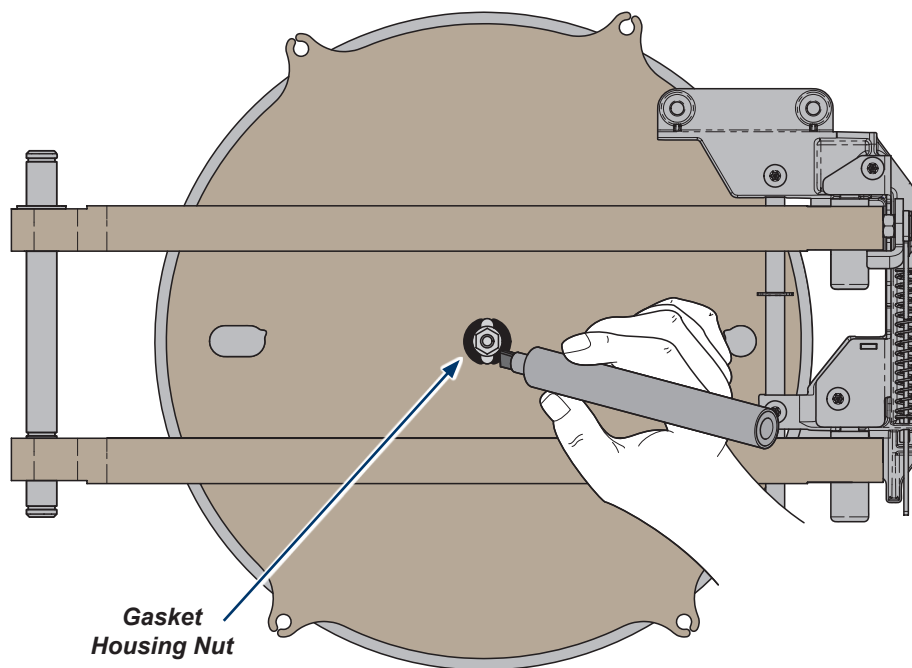

Step 7: Mark gasket housing position.

- A) Use a permanent marker around the gasket housing nut to record it's location for correct reassembly.
- B) Use a permanent marker to draw a line across the top of chamber door and the gasket housing to record correct location of the dam gasket pins.

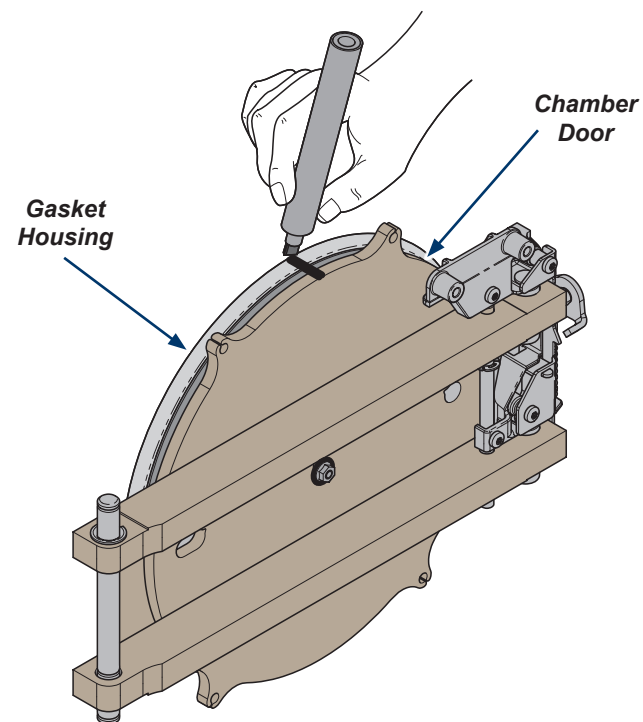

Step 8: Remove gasket housing and insulation pad.

- A) Remove gasket housing nut.
- B) Remove gasket housing.
- C) Remove insulation pad.

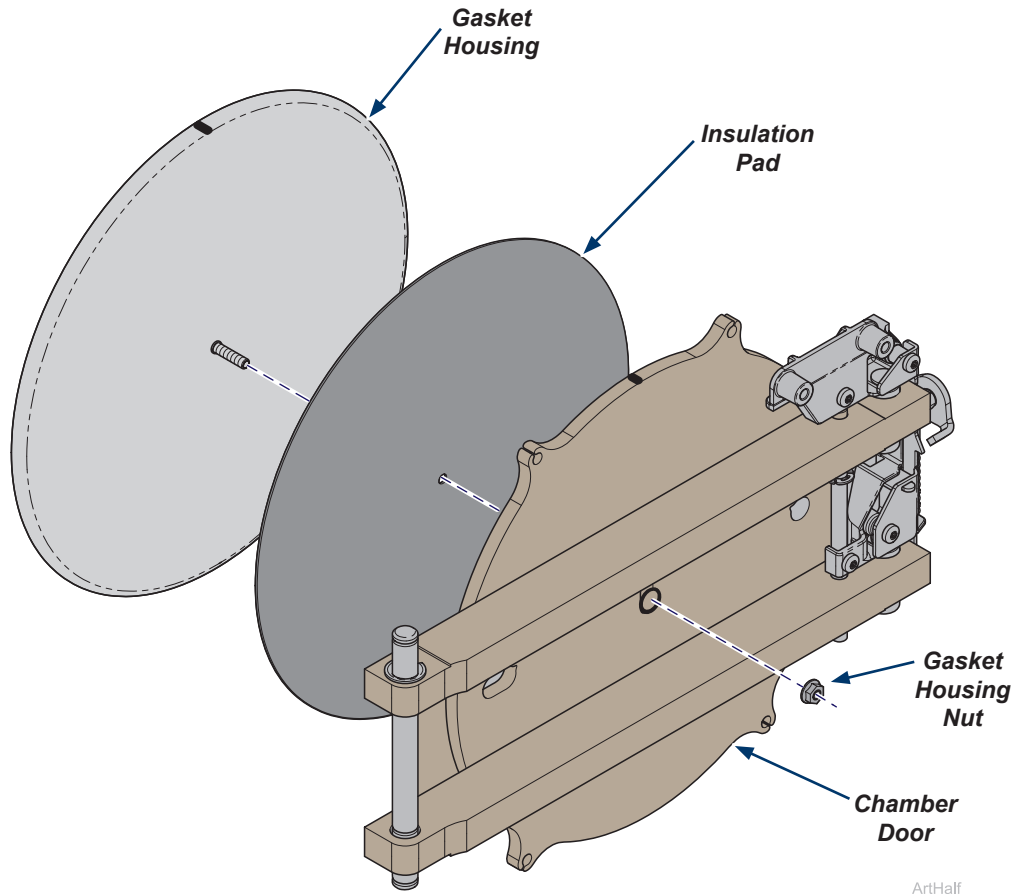

Step 9: Install new insulation pad and reinstall gasket housing.

- A) Position gasket housing threaded rod into new insulation pad then through hole on chamber door.
- B) Aligning the marks around the gasket housing nut and on the top of chamber door and gasket housing.
- C) Secure gasket housing with gasket housing nut.

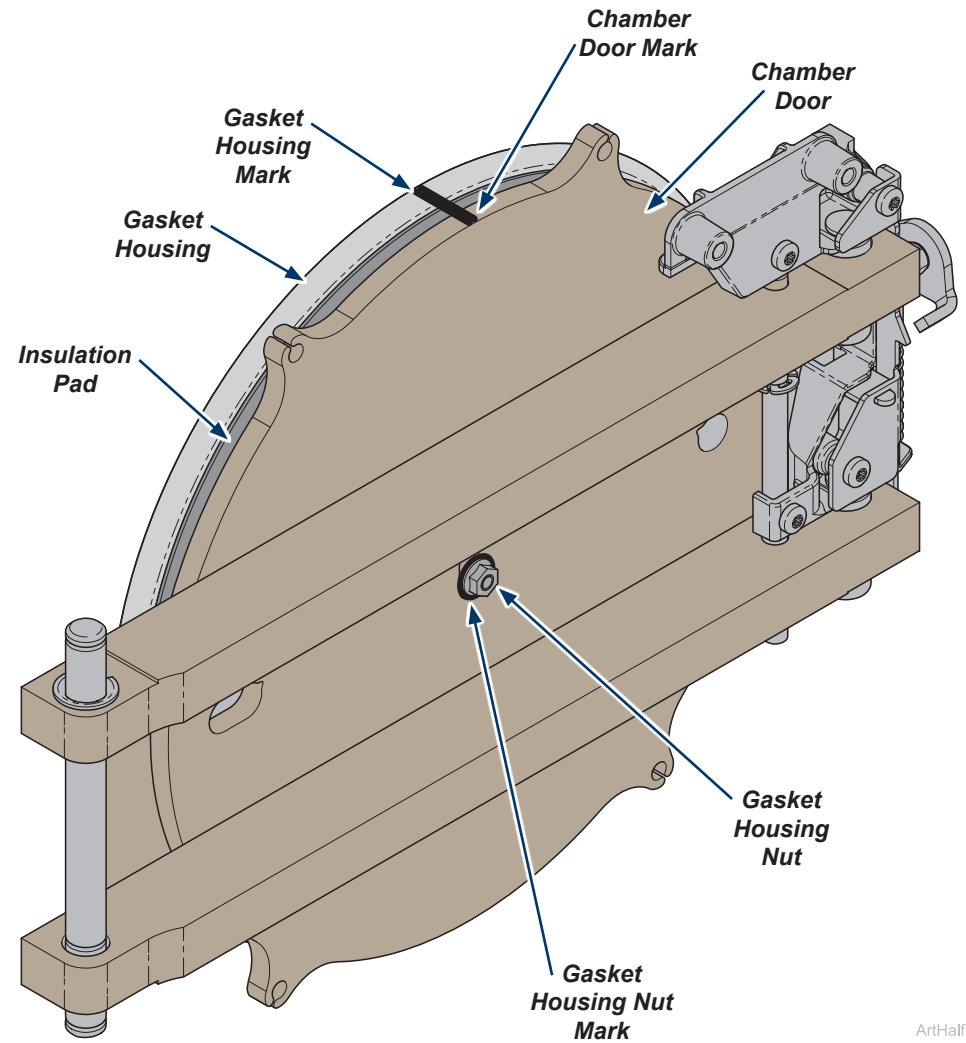

Step 10: Install Door Gasket.

- A) Install door gasket into bottom of the gasket housing and center tab between door studs.
- B) Install left and right sides and finish at top.
- C) Install gasket ring eyelets onto door studs, work gasket ring into v-groove of door gasket. Start on left and right sides and finish at top.
- D) Make sure door gasket fits evenly and flush all the way around gasket housing.

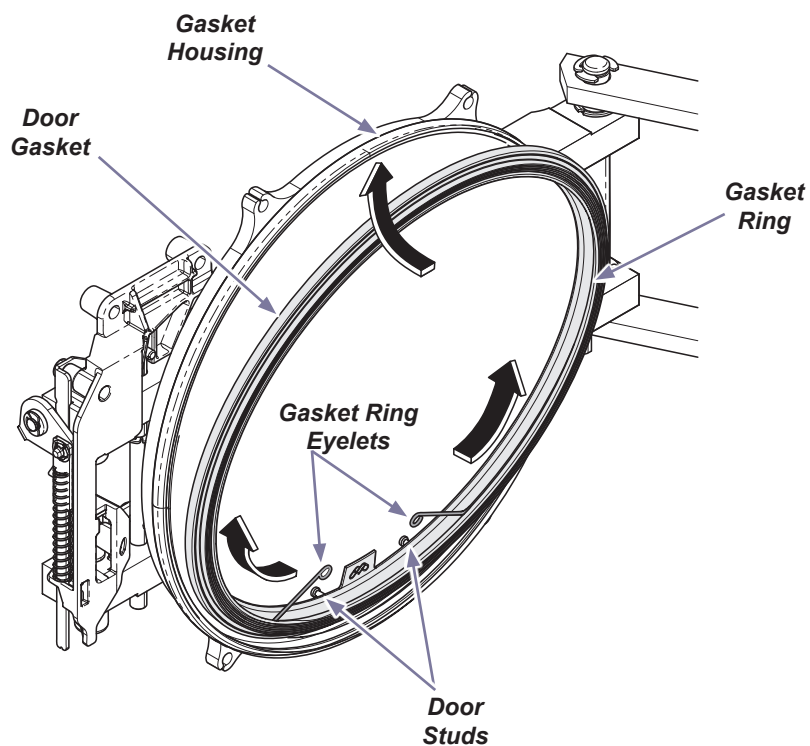

Step 11 : Install Dam Gasket.

- A) Align dam gasket holes over the door studs.
- B) Tuck bottom edge of dam gasket into the center v-groove of door gasket.
- C) Push dam gasket on to studs until it lies flat against the door.

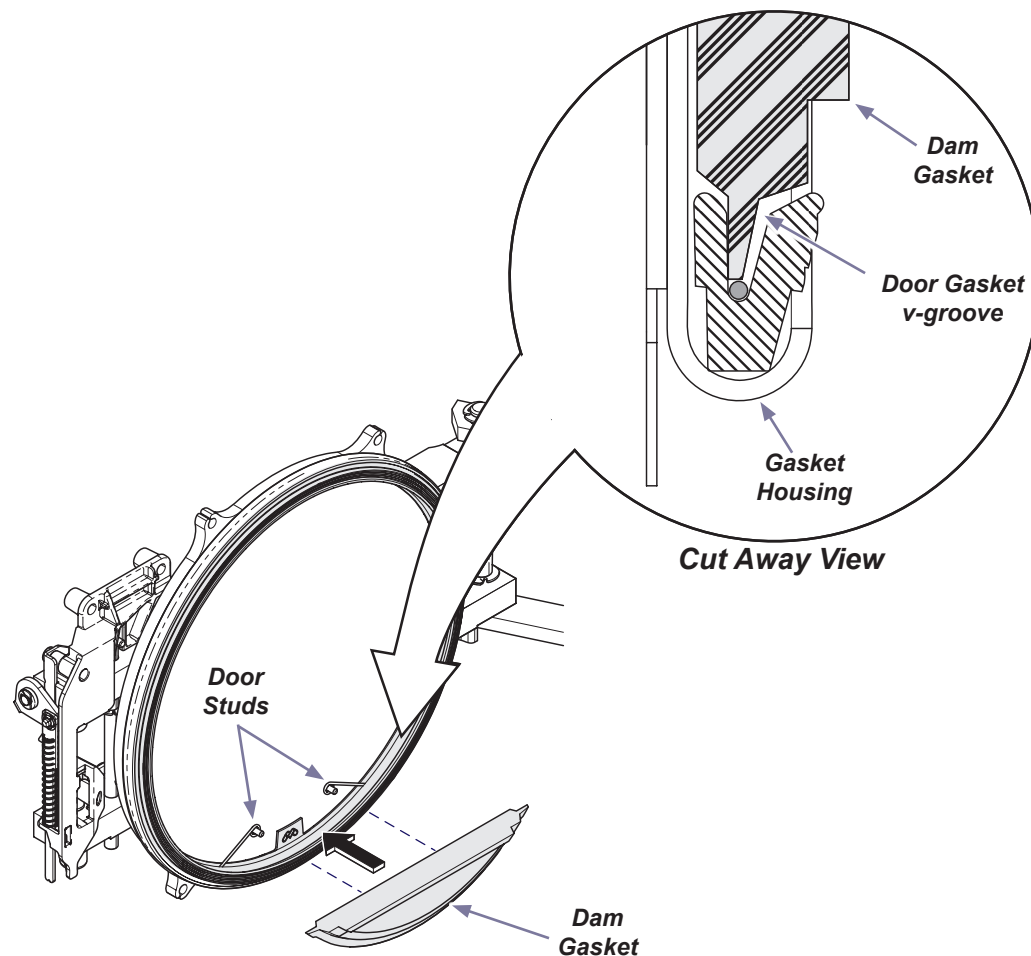

Step 12: Install covers, door handle.

- A) Position outside door cover in place.
- B) Install door handle.
- C) Position inside door cover and secure to outside door cover with screws.

Step 13: Qualification Testing.

- A) Qualification Testing Cycles should be ran after this repair is completed. (Refer to the user guide for details.)

If the sterilizer is connected to Smart View, a Request Qualification Testing should be setup on the sterilizer display following the below steps:

- Press the Menu Button .
- Select Settings.
- Select Service.
- Select Troubleshooting.
- Select Qualification Testing.
- Select Request Qualification Testing.
- Select Yes, Request Qualification Testing.

Note: Once qualification testing has been requested, this page will track testing status. The user interface will ask the user if the cycle they are attempting to run is a qualification cycle until the three (3) qualification cycles are completed.