

M9® and M11® Left Side Cover Kit

002-10875-01 M9
002-10876-01 M11

Applies to Models:

M9 (-050/-053)

M11 (-050/-051/-053)

Special Tools:

T25 Torx Screw Driver



WARNING

To prevent risk of shock always disconnect power before removing covers or performing any service procedure.



WARNING

Allow to cool to ambient / room temperature prior to removing cover. Release pressure by pulling ring of pressure relief valve if necessary.

Step 1: Disconnect power.

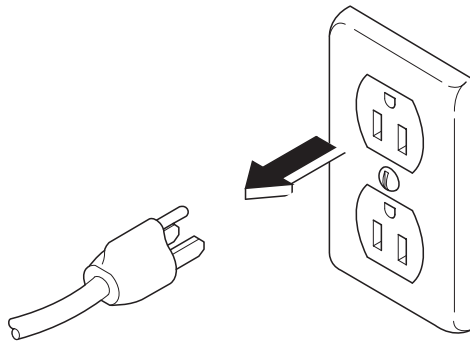

Step 2: Remove left side cover.

- Remove top two left side screws and loosen left rear bottom screw.
- Pull corner tab out of corner slot and rotate top of side cover down to free bottom tabs from base of sterilizer.

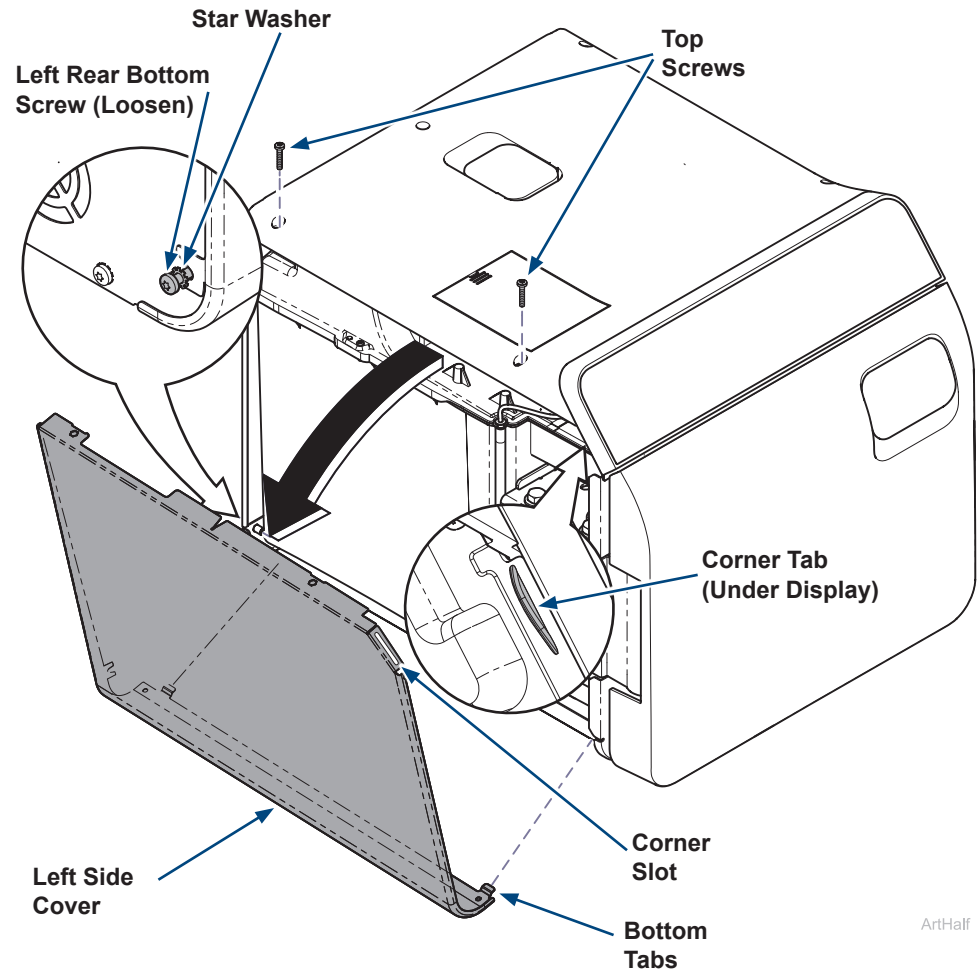

ArtHalf

Step 3: Install left side cover.

- A) Insert bottom tabs of left side cover into base of sterilizer.
- B) Rotate top of side cover up into position and snap corner tab into corner slot.
- C) Install top two left side screws and tighten left rear bottom screw.



WARNING

For effective grounding make sure star washer is located between screw head and tab of side cover when tightening left rear bottom screw.

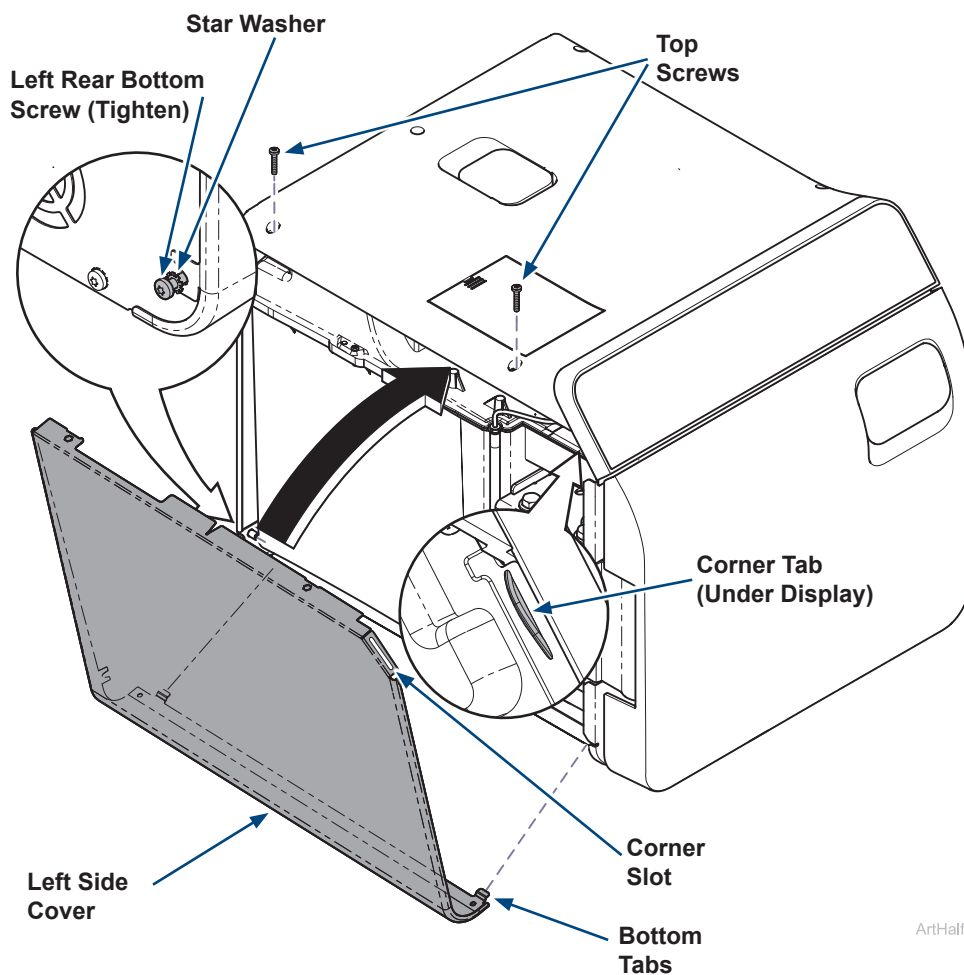

ArtHalf