

M9® and M11® Dam Gasket Kit

M9 002-10879-02

M11 002-10880-02

Applies to Models:

M9 (-050/-053)

M11 (-050/-051/-053)

Special Tools:

none



WARNING

*Allow to cool to ambient / room temperature prior to removing cover.
Release pressure by pulling ring of pressure relief valve if necessary.*

Step 1: Remove Dam Gasket.

- Allow sterilizer to cool and open door.
- Remove dam gasket by pulling it off the door studs.
- Clean the door gasket v-groove and the face of the chamber.

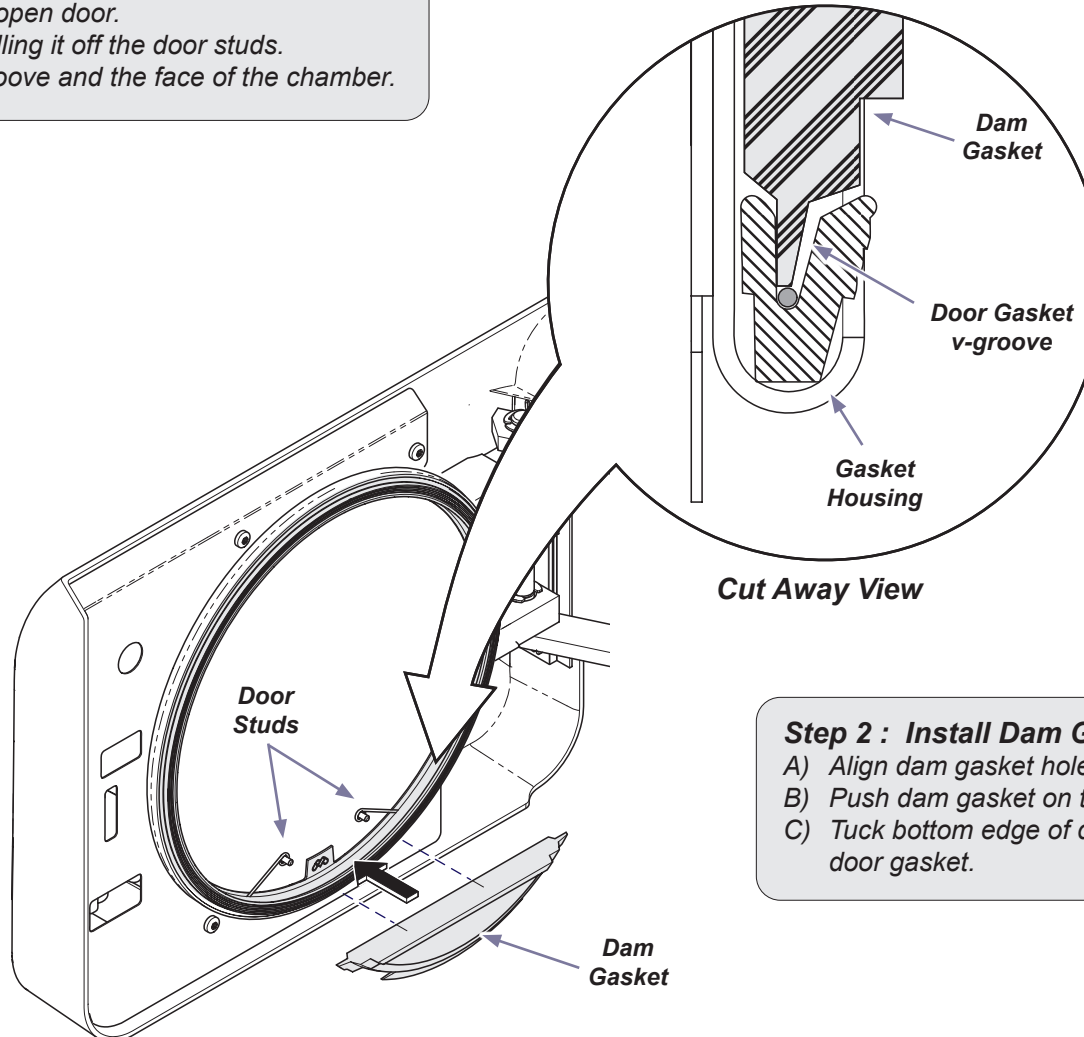

Cut Away View

Step 2 : Install Dam Gasket.

- Align dam gasket holes over the door studs.
- Push dam gasket on to studs until it lies flat against the door.
- Tuck bottom edge of dam gasket into the center v-groove of door gasket.