

M9® and M11® Door Switch Kit

002-10899-00

Applies to Models:

M9 (-050/-053)

M11 (-050/-051/-053)

Special Tools:

T25 Torx Screw Driver



WARNING

To prevent risk of shock always disconnect power before removing covers or performing any service procedure.



WARNING

Allow to cool to ambient / room temperature prior to removing cover. Release pressure by pulling ring of pressure relief valve if necessary.

Step 1: Disconnect power.

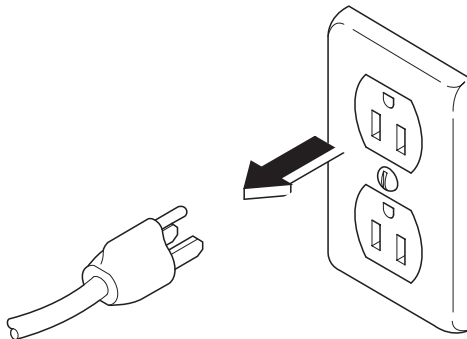

Step 2: Remove right side cover.

- Remove top two right side screws and loosen right rear bottom screw.
- Pull corner tab out of corner slot and rotate top of side cover down to free bottom tabs from base of sterilizer.

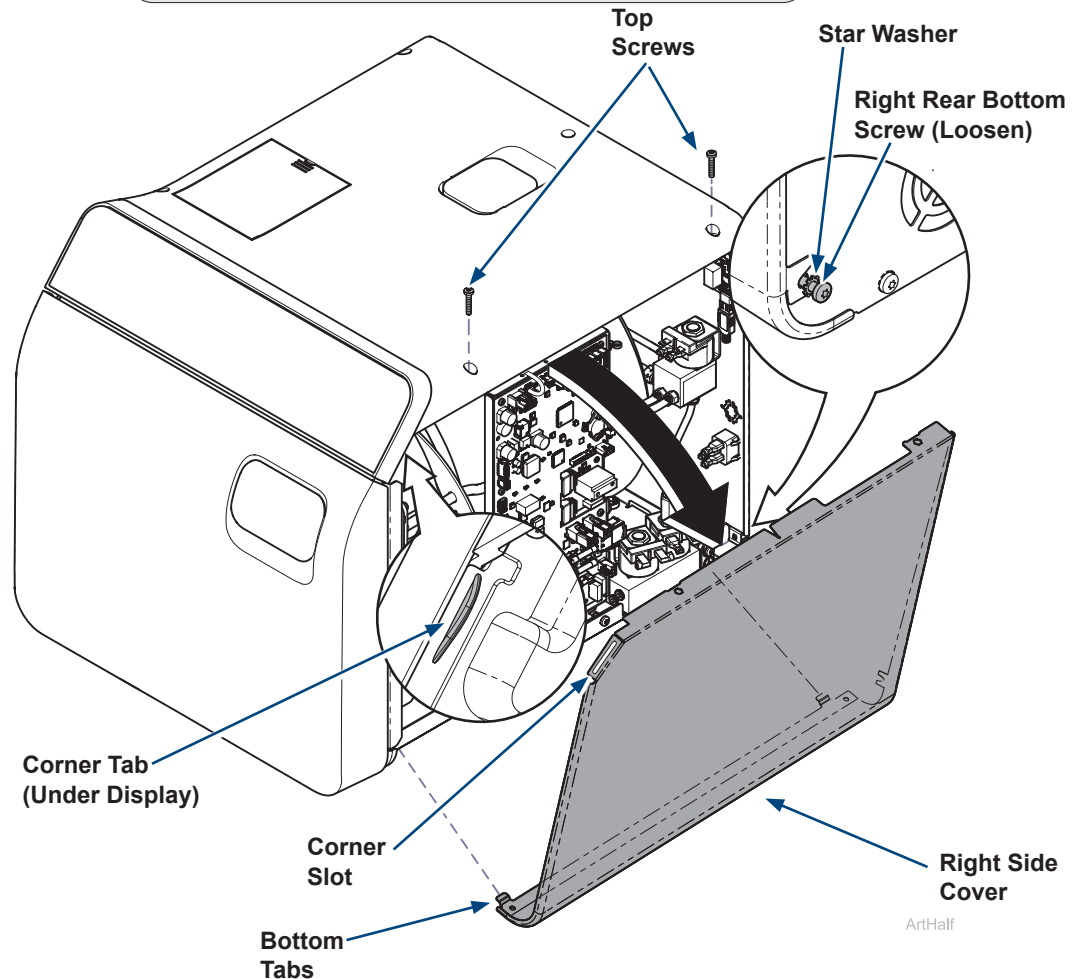

Step 3: Disconnect harness from PC board.

- A) Remove connector with white wires.
- B) Remove connector with blue wires and route connector behind door motor.

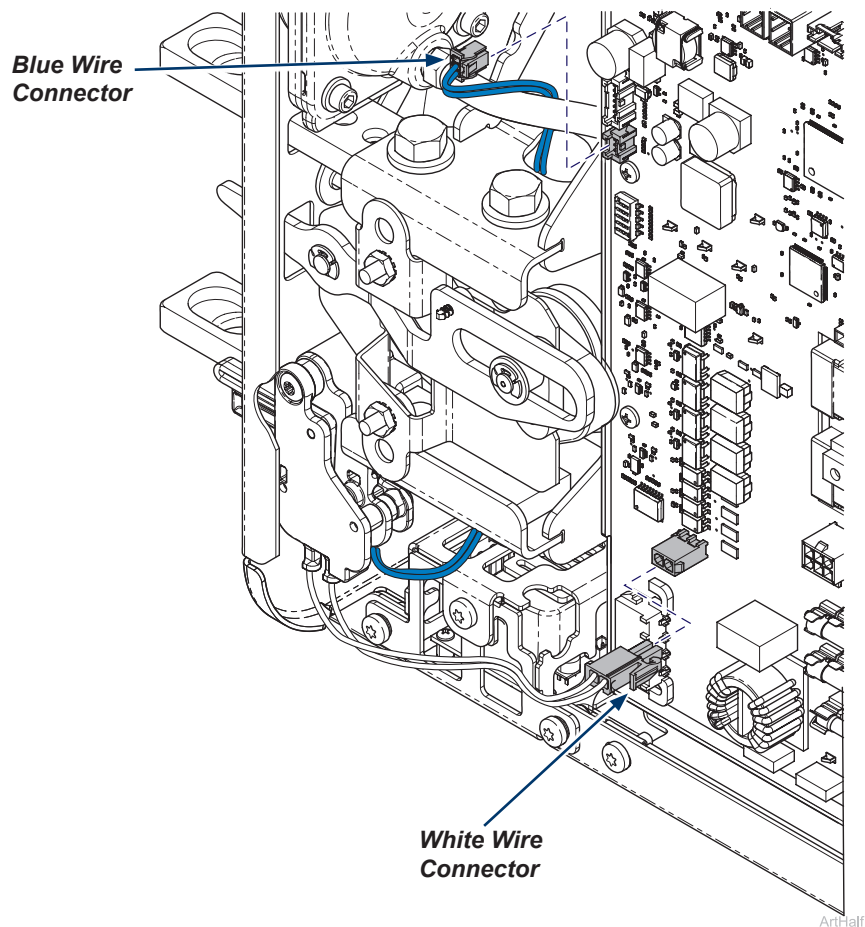

Step 4: Remove door switch assembly.

- A) Remove screw from door switch assembly.
- B) Remove door switch assembly by pulling locator tabs out of locator holes.

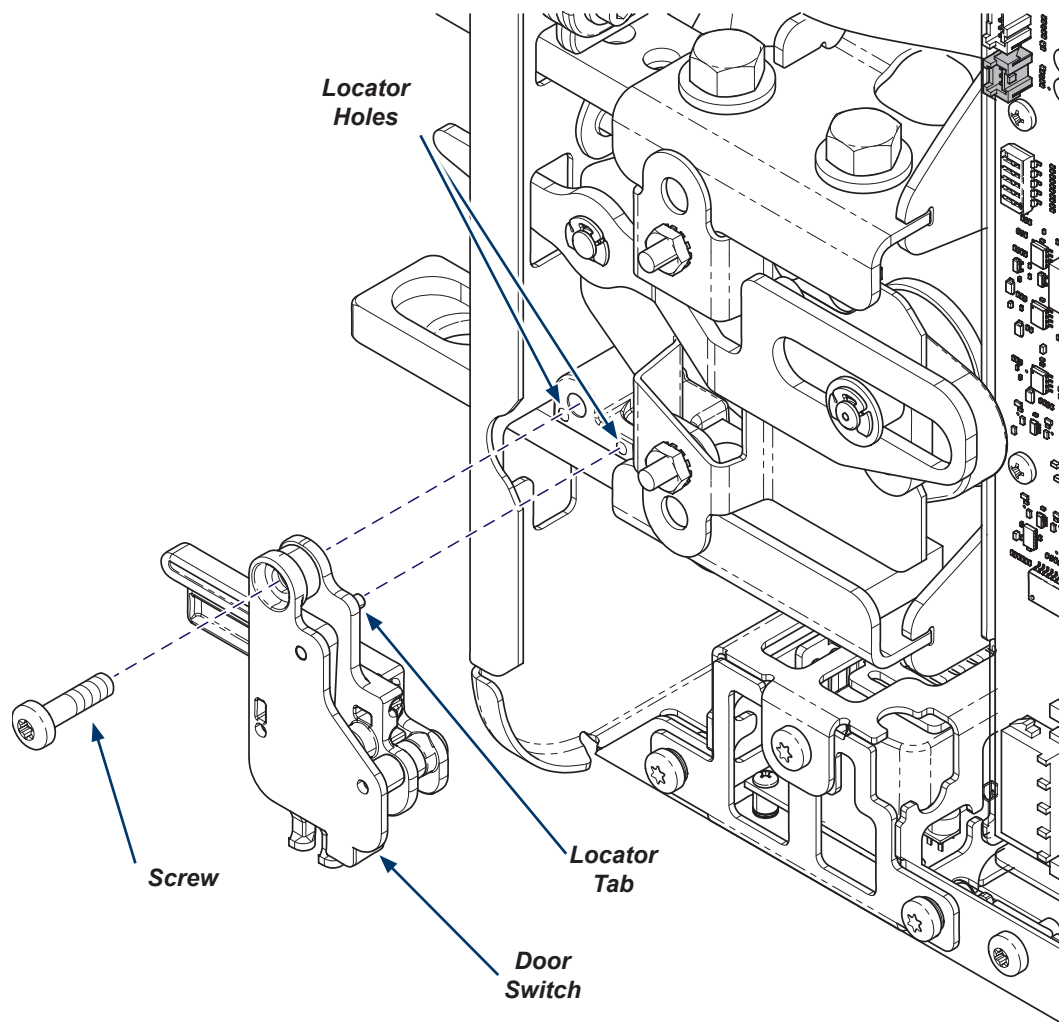

Step 5: Install Door Switch Assembly.

- A) Align door switch assembly by inserting locator tabs into locator holes and secure with mounting screw.
- B) Attach harness to PC Board and secure with cable ties.

Step 6: Install right side cover.

- A) Insert bottom tabs of right side cover into base of sterilizer.
- B) Rotate top of side cover up into position and snap corner tab into corner slot.
- C) Install top two right side screws and tighten right rear bottom screw.
- D) Run a test cycle and check for proper operation.



WARNING

For effective grounding make sure star washer is located between screw head and tab of side cover when tightening right rear bottom screw.

