

# M9® and M11® Connectivity Module Kit

## 002-10909-00

### Applies to Models:

M9 (-050/-053)

M11 (-050/-051/-053)

### Special Tools:

T25 Torx Screw Driver



#### WARNING

To prevent risk of shock always disconnect power before removing covers or performing any service procedure.



#### WARNING

Allow to cool to ambient / room temperature prior to removing cover. Release pressure by pulling ring of pressure relief valve if necessary.

### Step 1: Disconnect power.

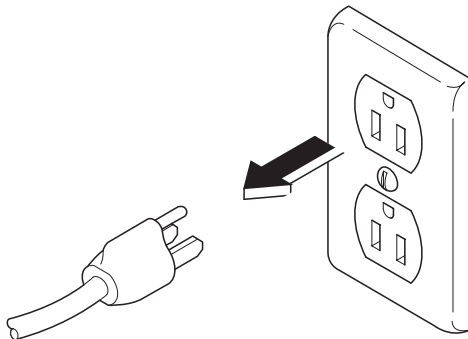

### Step 2: Remove right side cover.

- Remove top two right side screws and loosen right rear bottom screw.
- Pull corner tab out of corner slot and rotate top of side cover down to free bottom tabs from base of sterilizer.

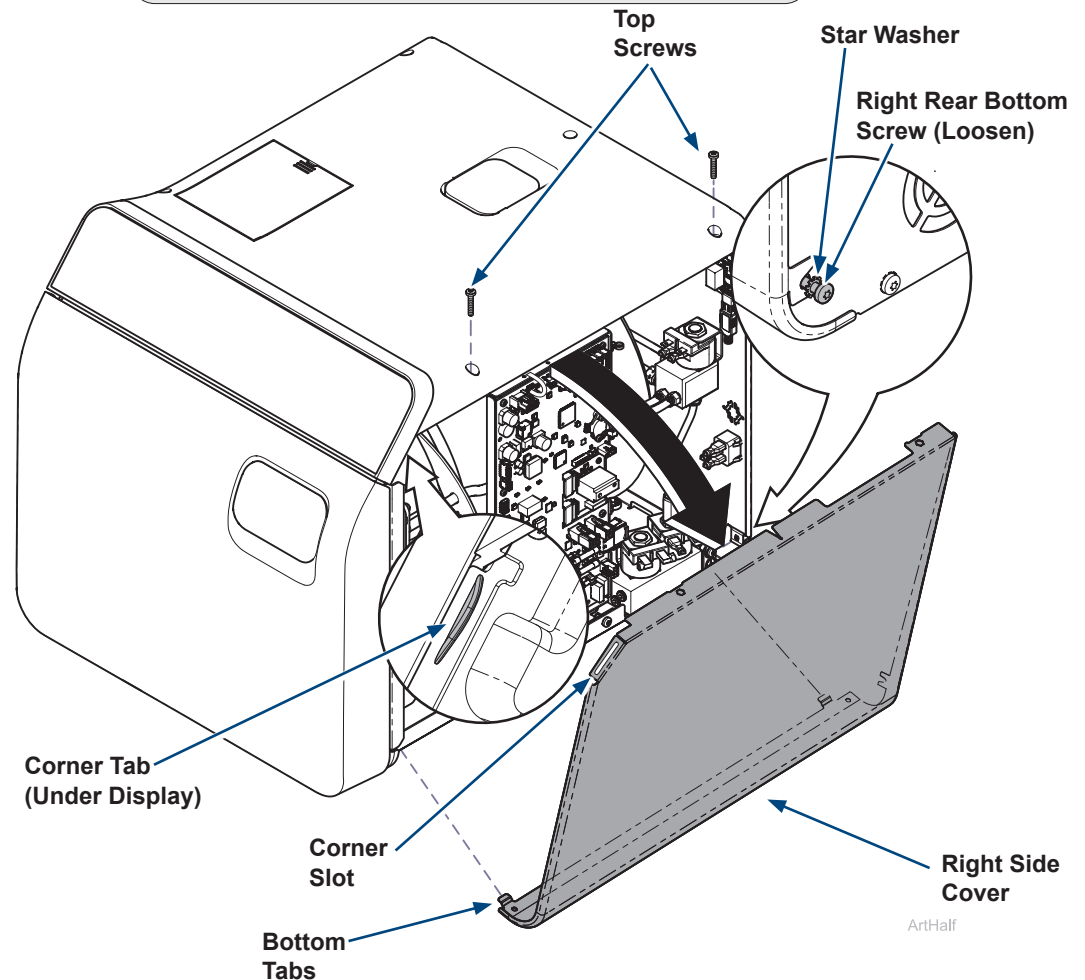

### Step 3: Remove top cover hardware.

- A) Remove remaining three top screws.
- B) Remove screw attaching ring of pressure relief valve to top pull lever.

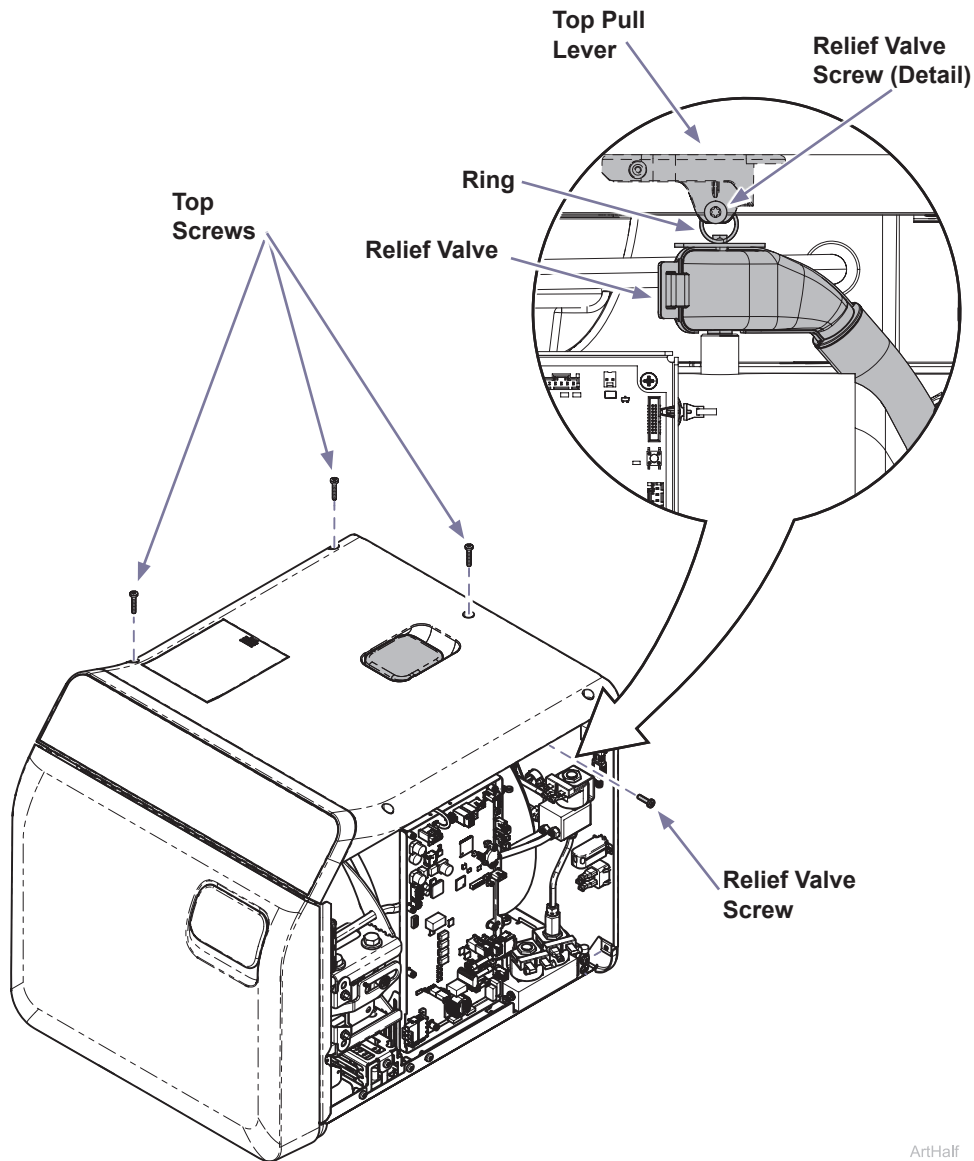

ArtHalf

### Step 4: Disconnect wiring to top cover.

- A) Disconnect CAN line, auto fill overflow sensor harness and auto fill + air valve power harness from the PC board.
- B) Disconnect air valve wires, ethernet cable and any optional accessories needed to remove top cover.

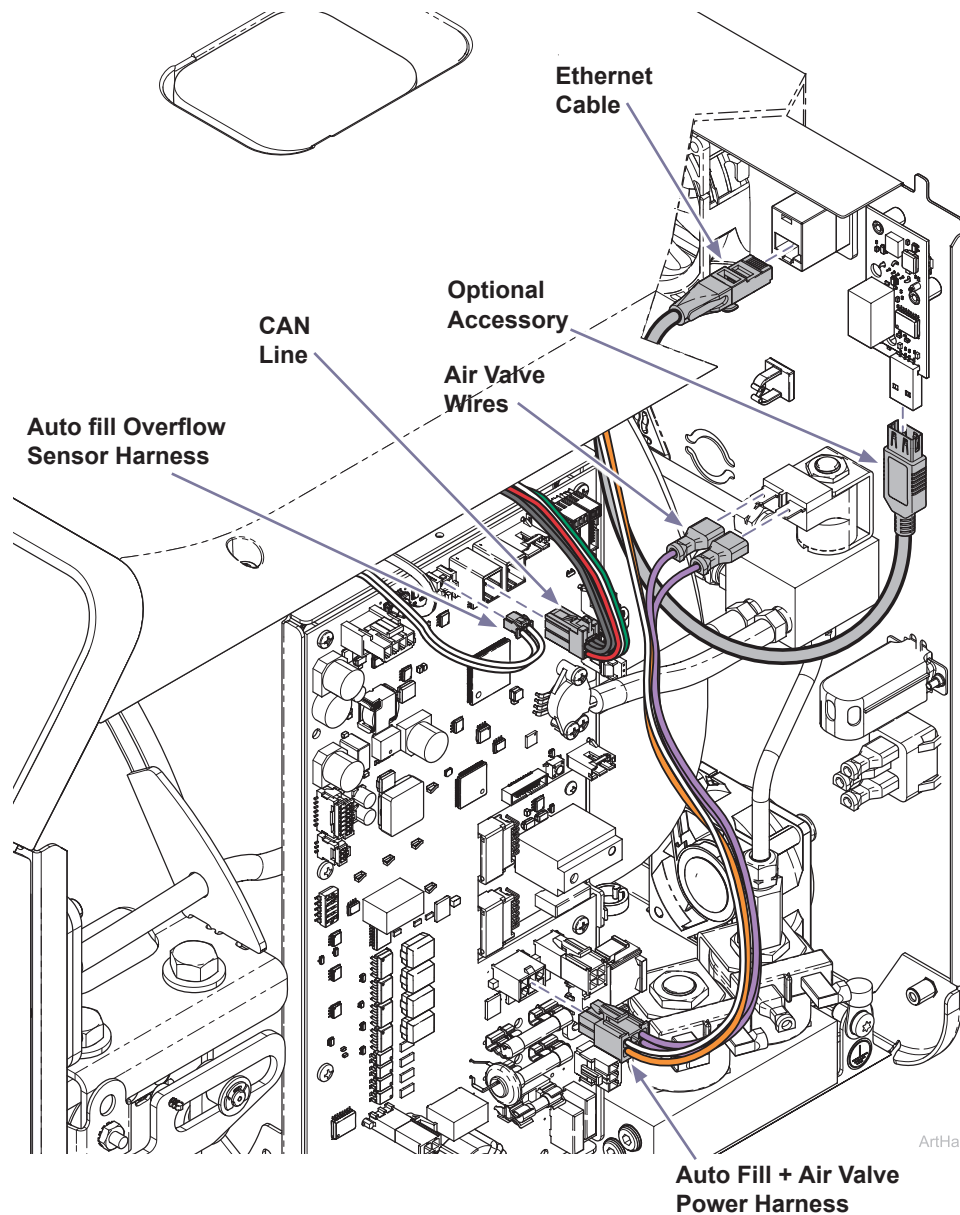

ArtHalf

**Step 5: Remove top cover.**

A) Open door.

B) Lift top cover forward and up to remove.

Note: The front edge of top cover will come out of groove in the steam block.

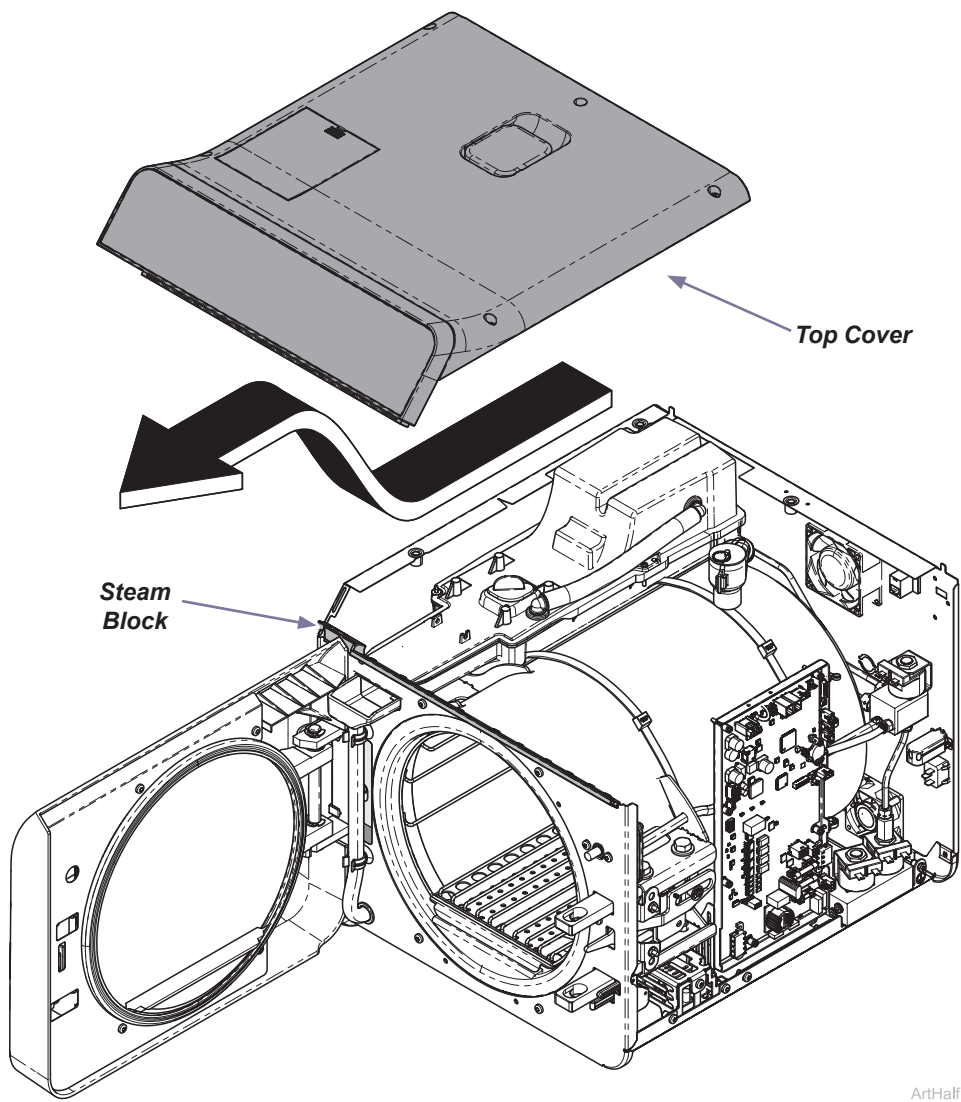

**Step 6: Remove display cover.**

A) Turn top cover over and remove two screws on ends of display cover.

B) Rotate display cover down.

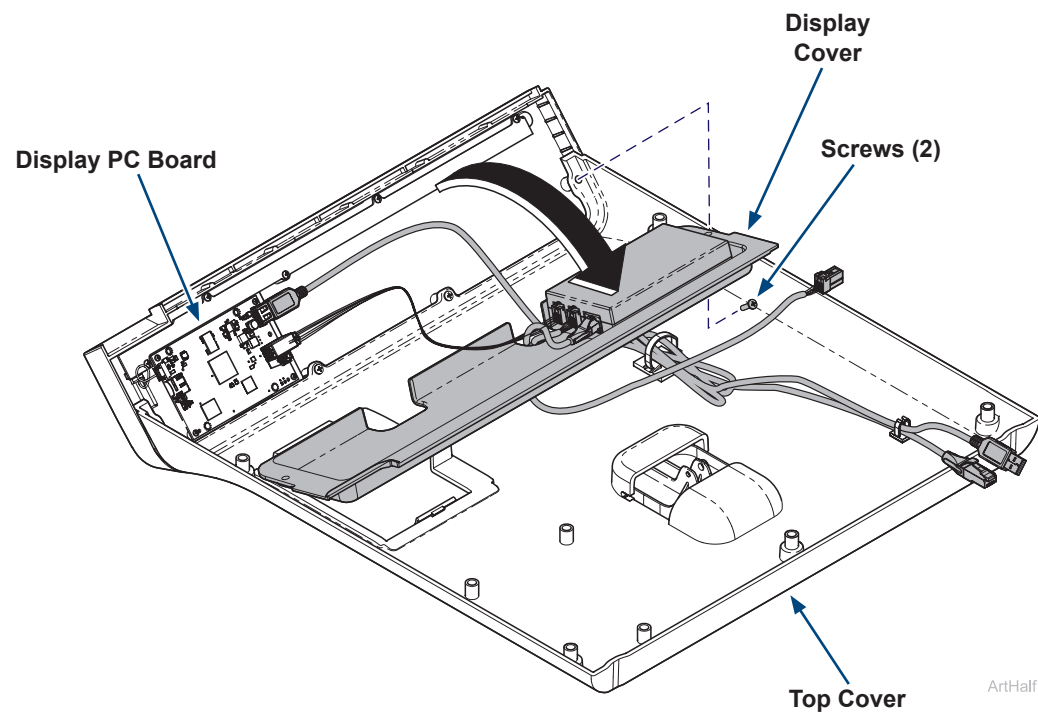

**Step 7: Replace connectivity module.**

- A) Remove three connectors from side of connectivity module.
- B) Remove connectivity module by pulling it off three studs on display cover.
- C) Install connectivity module onto display cover by pushing it firmly onto the three studs.

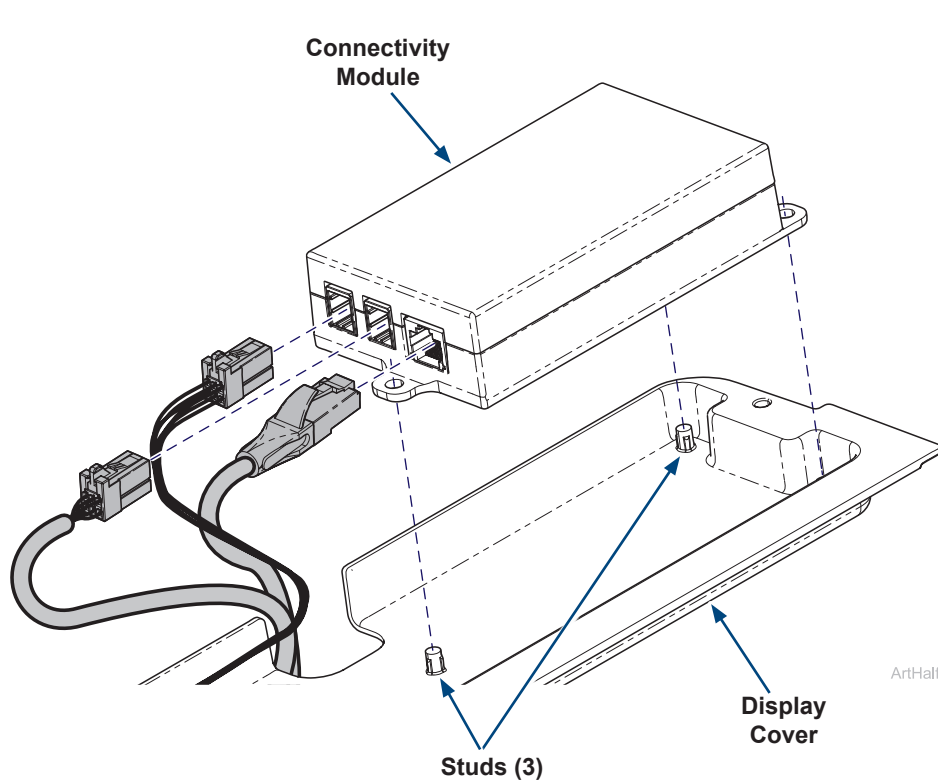

**Step 8: Install display cover.**

- A) Rotate display cover up into place.
- B) Route harnesses so they come out the cutouts in the display cover and secure display cover with two screws.

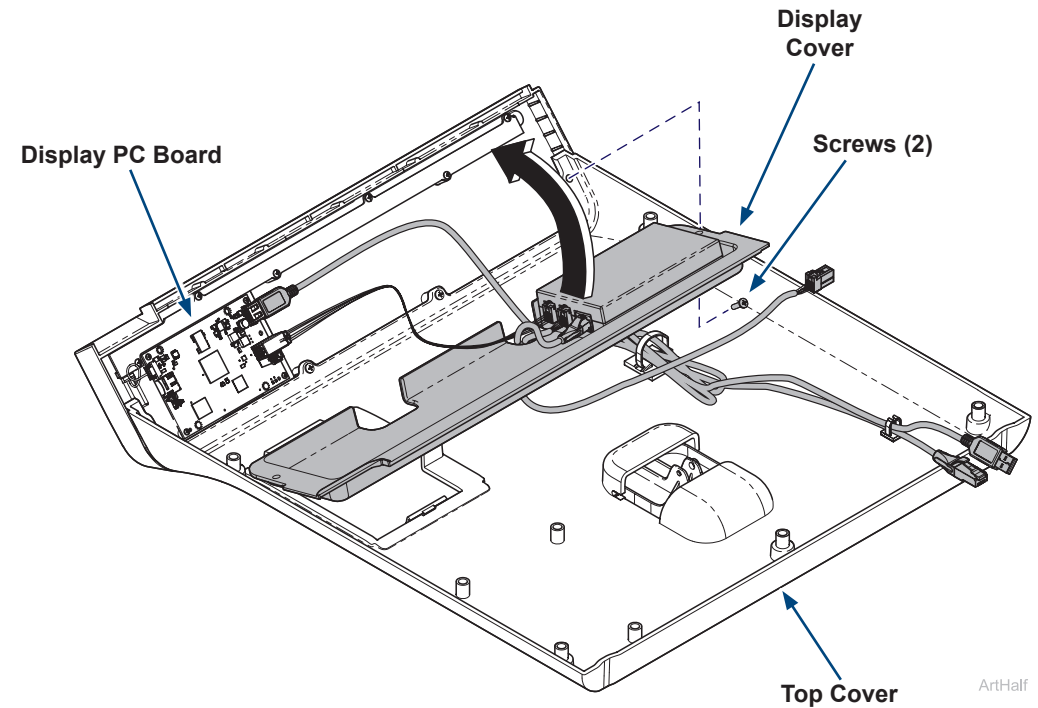



### Step 9: Install top cover.

- A) Open door.
- B) Tuck front bottom edge of top cover into groove of steam block. Then set top cover down in position.

Note: The front edge of top cover fits down in the groove of steam block.

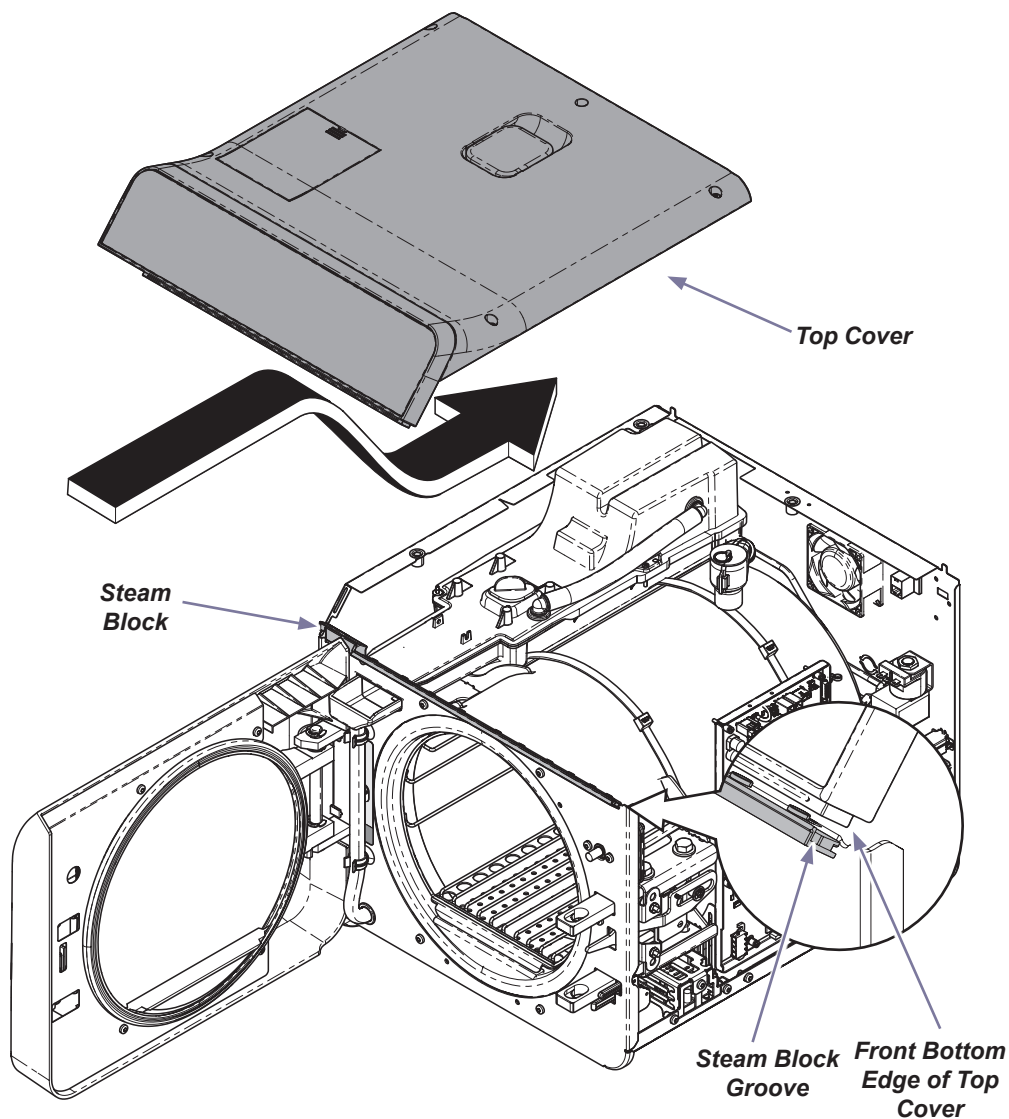

### Step 10: Connect wiring to top cover.

- A) Connect CAN line, auto fill overflow sensor harness and auto fill + air valve power harness from the PC board.
- B) Connect air valve wires, ethernet cable and any optional accessories that were disconnected to remove top cover.

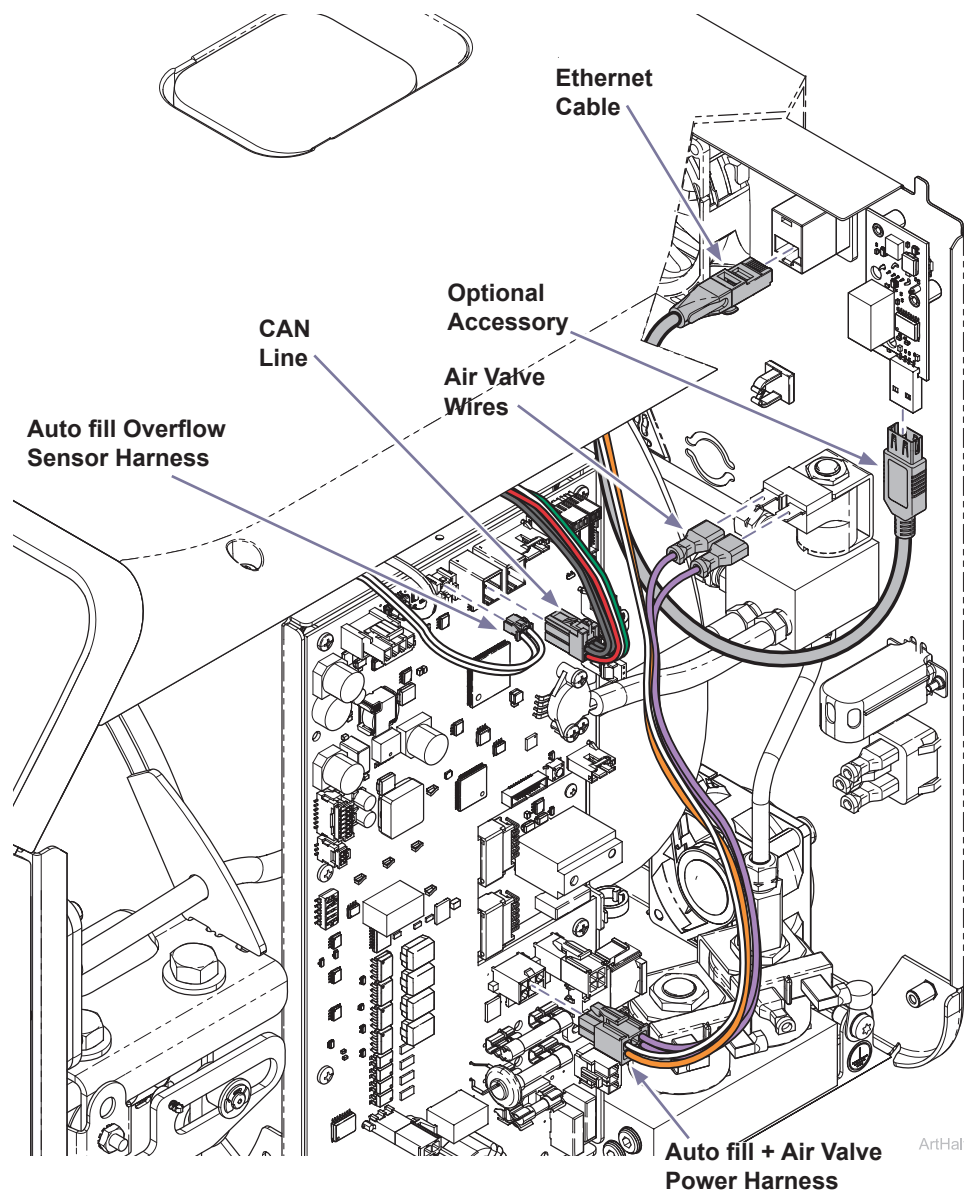

### Step 11: Install top cover hardware.

- A) Hold ring of pressure relief valve in center of top pull lever. Then install screw attaching ring of pressure relief valve to top pull lever.
- B) Install three top screws shown.

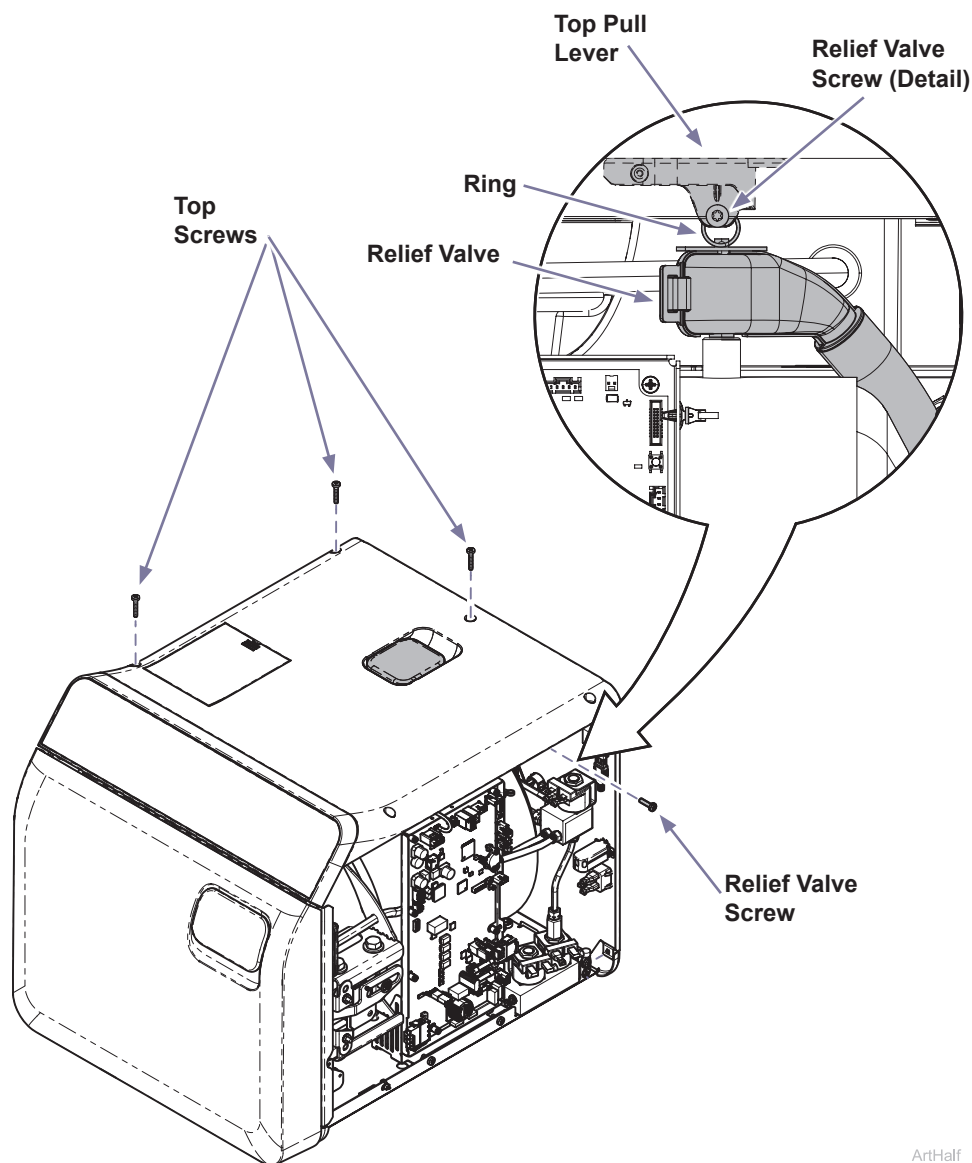

Art:Half

### Step 12: Install right side cover.

- A) Insert bottom tabs of right side cover into base of sterilizer.
- B) Rotate top of side cover up into position and snap corner tab into corner slot.
- C) Install top two right side screws and tighten right rear bottom screw.
- D) Run a test cycle and check for proper operation.



#### WARNING

For effective grounding make sure star washer is located between screw head and tab of side cover when tightening right rear bottom screw.

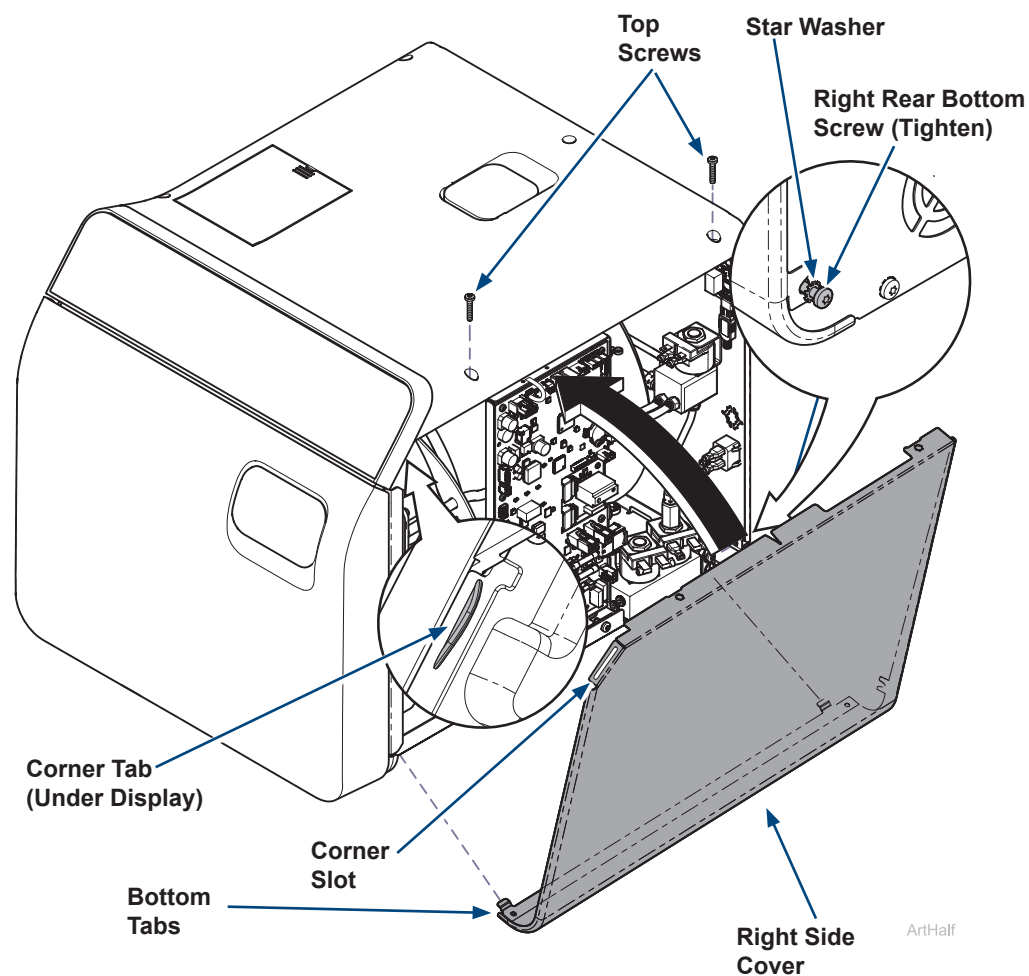

Art:Half