

Smart Compressor Head Replacement

002-11044-00 (115VAC) / 002-11043-00 (230VAC)

Applies to Models:

P21-050

P22-050

P32-050

Special Tools:

none



WARNING

Equipment is not suitable for use in the presence of a flammable anesthetic mixture.

Clarification: Equipment is suitable for use in the presence of oxygen, air, or nitrous oxide.



WARNING

To prevent risk of shock always disconnect power before removing covers or performing any service procedure.

Step 1: Disconnect Harness.

- Disconnect supply power to the compressor.
- Remove cover from electrical control box.
- Disconnect harness from PC Board.
- Disconnect top and bottom wires from corresponding fuse.
- Remove grounding wire from ground stud.
- Remove harness strain relief from electrical control box.

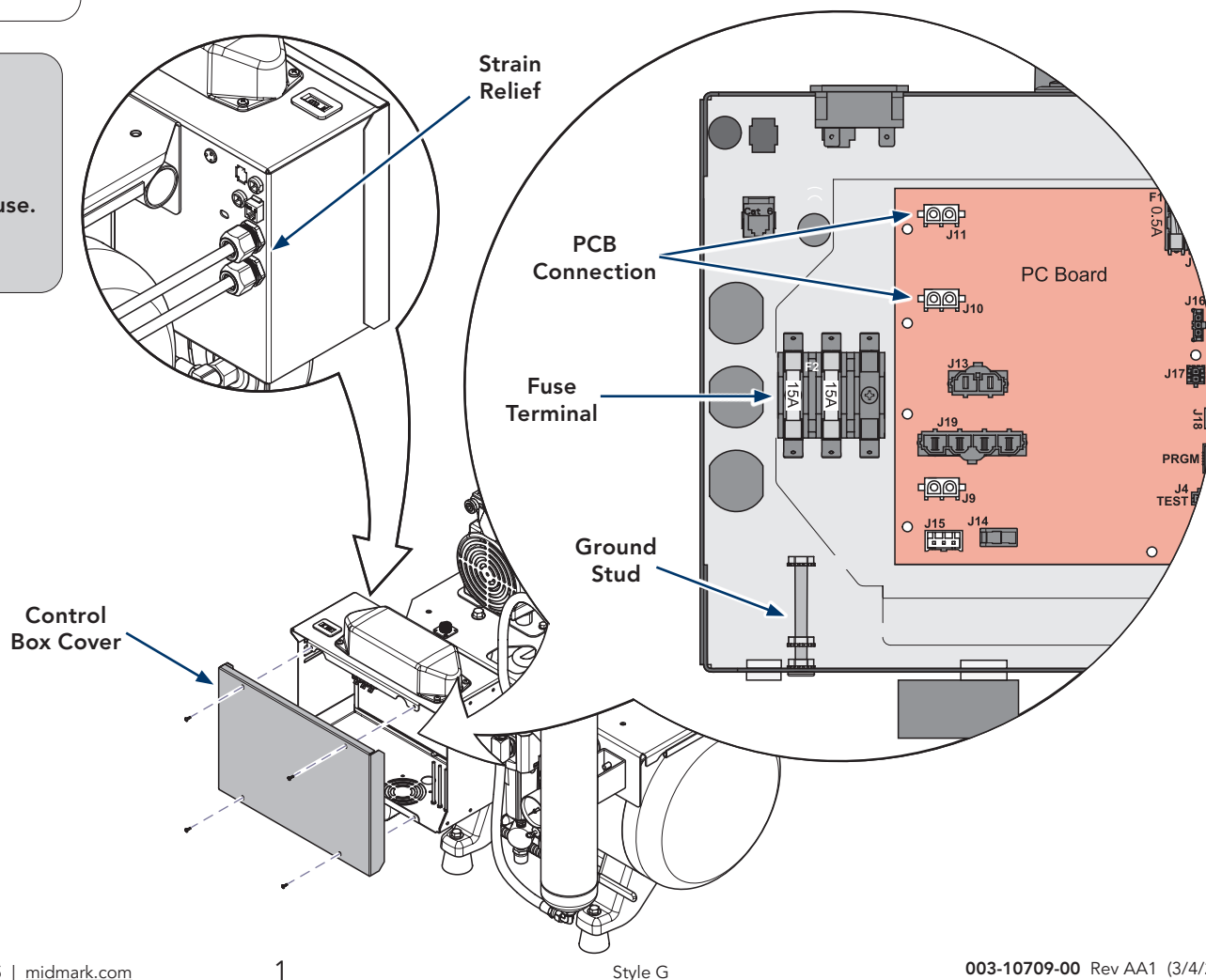

Step 2: Remove Old Head.

- A) Remove braided pressure hose and air intake line.
- B) Unbolt head and mounting plate from saddle.
- D) Repeat for each additional head. (P21, P22 = 2) (P32 = 3)

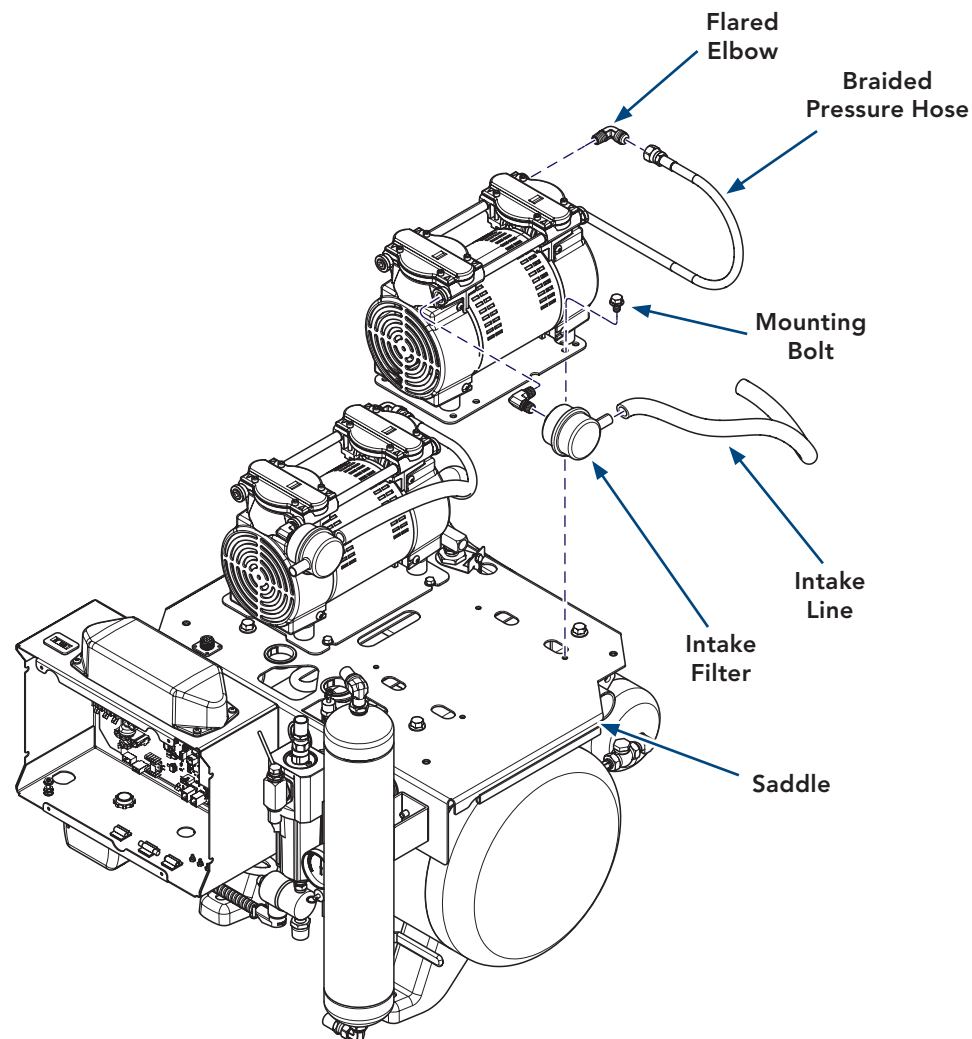
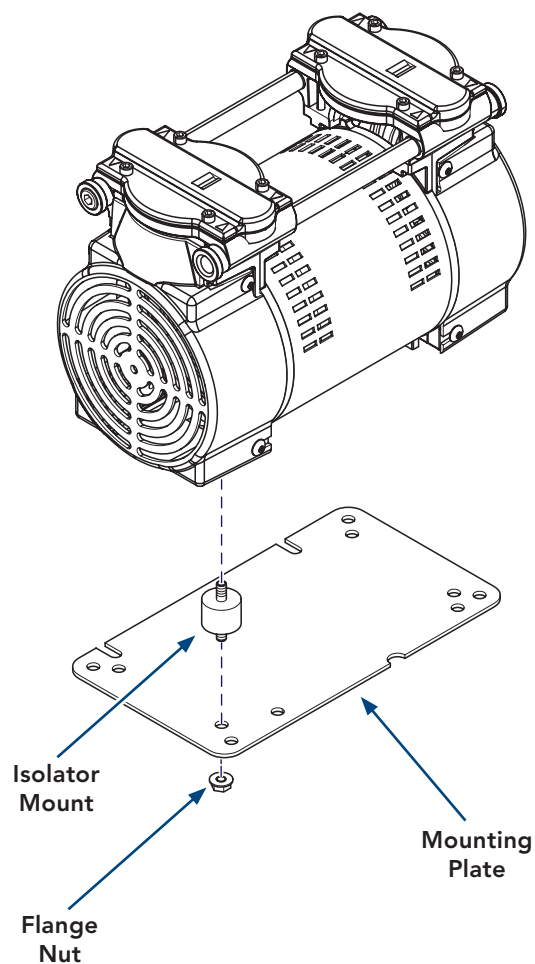

Step 3: Install New Head.

- A) Install isolator mounts to bottom of head.
- B) Install mounting plate to bottom of isolator mounts.
- C) Secure head assembly to saddle.
- D) Apply pipe sealant to fill (pressure) and intake elbow threads.
- E) Install flared elbow and braided hose to pressure connection on back of head.
- F) Install elbow, air intake filter and intake line to intake connection on front of head.
- G) Install wire harness to control box.
- H) Connect wires to PCB, fuse terminals and ground stud.
- I) Install cover onto electrical control box.
- J) Repeat for each additional head. (P21, P22 = 2) (P32 = 3)
- K) Connect supply power to compressor.