



## WARNING

Indicates a potentially hazardous situation which could result in serious injury.

### Step 1: Remove Rear Cover Assembly

A) Remove 4 screws and cover.

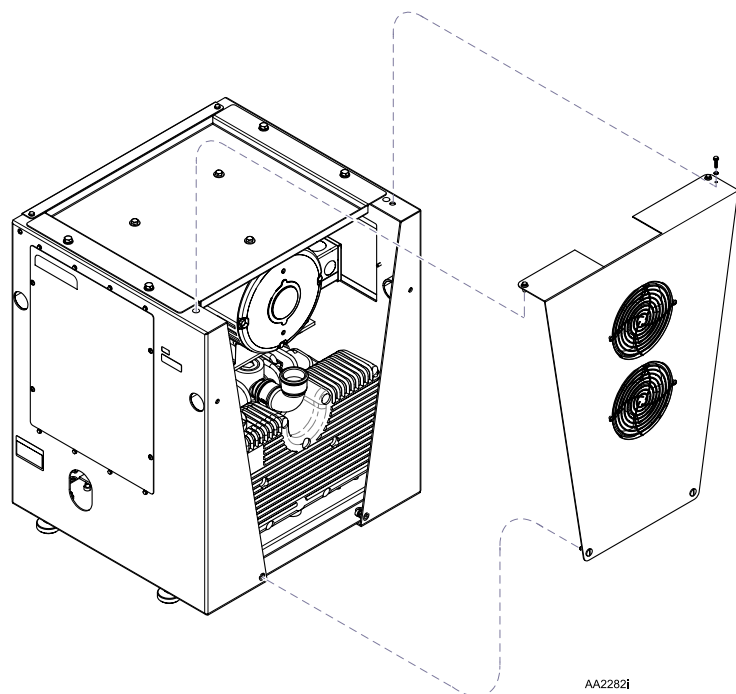

AA2282i

### Step 2: Remove current VRV

A) Remove old VRV and discard.

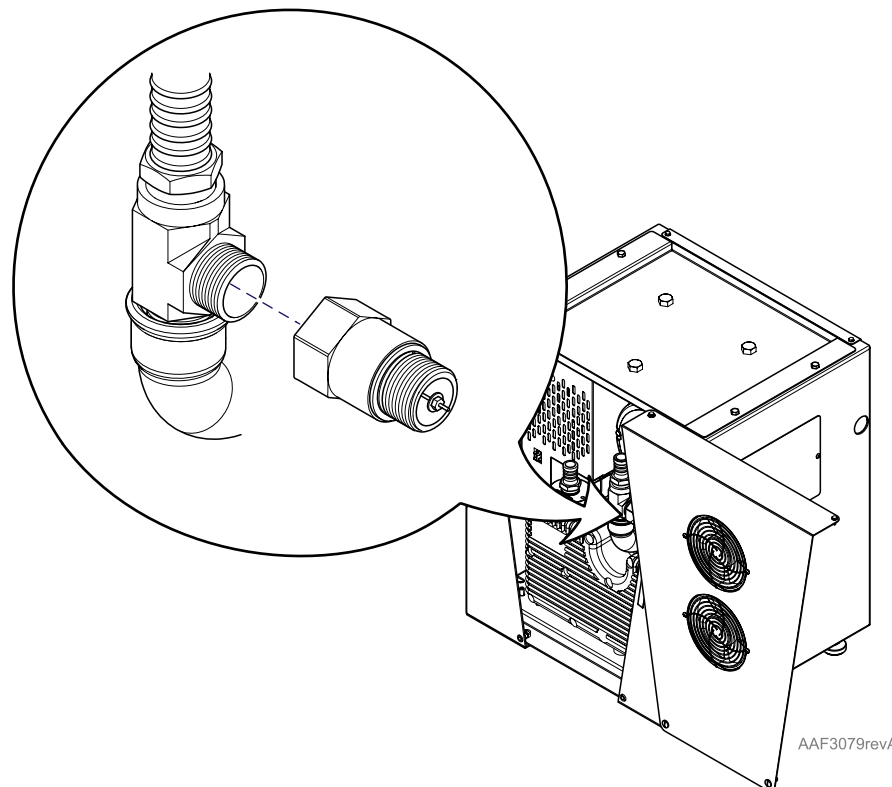

AAF3079revA

### Step 3: Attach new VRV

- A) Install and tighten the new VRV.

### Step 4: Test the pressure

- A) Turn the unit on.
- B) Note the vacuum pressure.

### Step 5: Vacuum Adjustment

*Note: Adjust Vacuum level only if vacuum level is less than 12 inHg. The vacuum level should never exceed 18 inHg.*

- A) Remove the VRV.
- B) Use 1/4" nut driver and a phillips screw driver to adjust the center mounted screw inside valve.  
*Each full clockwise turn increases the vacuum level by approximately 2 inHg. Each full counterclockwise turn decreases the vacuum level by approximately 2 inHg.*
- C) Reinstall VRV
- D) Repeat Step 4

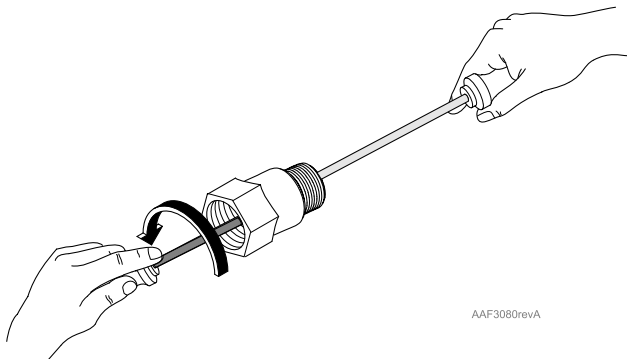

### Step 6: Reinstall Rear Cover Assembly

- A) Attach cover with 4 screws.

### Step 7a: Adjust the VFD (GVac)

*The VFD must be set higher than the VRV by 2 inHg (14 inHg).*

- A) Press the "ESC" button until "V xx" shows on the screen.
- B) Press "Enter" to enter the vacuum setting.
- C) Press the right arrow to highlight the number you would like to change (flashing number is selected).
- D) Use up and down arrows to change the flashing number.
- E) Press Enter to confirm the vacuum setting.
- F) To get back to displaying the pressure value, press the "ESC" button until the "V xx" shows on the screen.
- G) Press the up or down arrows until you see "Mon" on the display. Press enter.
- H) Press up or down to select U8-02, press enter. Pressure value should appear on the display.

"Vxx" xx is a Variable Reading

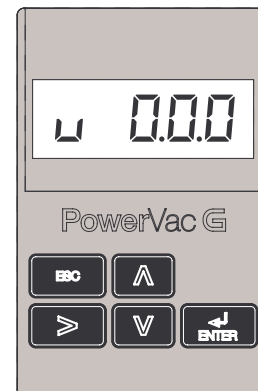

AA2326

"Mon" Reading



AA2327

"U8-02" Reading

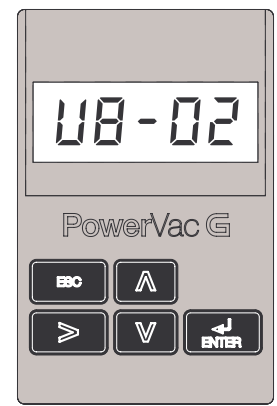

AA2328

#### Note

Vacuum level range is 6" Hg - 18" Hg. Midmark recommends operation at factory preset of 14" Hg. If reading is low check for leaks or open operatory lines prior to adjustment.

### Step 7b: Adjust the VFD (Smart GVac)

The VFD must be set higher than the VRV by 2 inHg (14 inHg).

- A) Press “F2” Menu button.
- B) Press Down arrow to highlight “User Custom Parameters”.
- C) Press “Enter” button.

#### Note

When working on Twin units, unplug parallel harness.

#### Note

Vacuum level range is 6" Hg - 18" Hg. Midmark® recommends operation at factory preset of 14" Hg. If reading is low check for leaks or open operatory lines prior to adjustment.

A



B

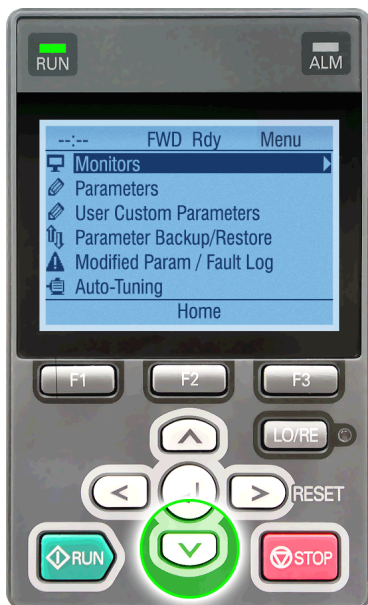

C

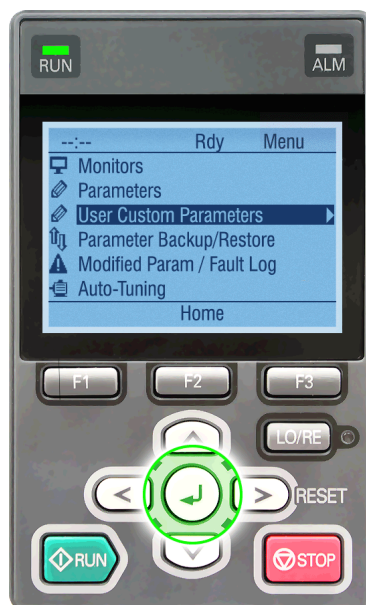

### Step 7b: Adjust the VFD (Smart GVac) (continued)

D) Scroll down to Reference 1: d1-01.

E) Press "Enter" button.

F) Use Right / Left and Up / Down arrows to change vacuum to desired level.

G) Press "Enter" button.

