

## Step 1: Disassembly

- A) With the unit upside down, peel the silicone cover down (away from USB Cable).
- B) Pull the other end of the silicone cover away from the unit to fully expose the patient cable.
- C) Pull the patient cable out of its socket.
- D) Pushing on the small tab (see gray arrow) on the bottom of the USB cable, rotate the cable up and out.

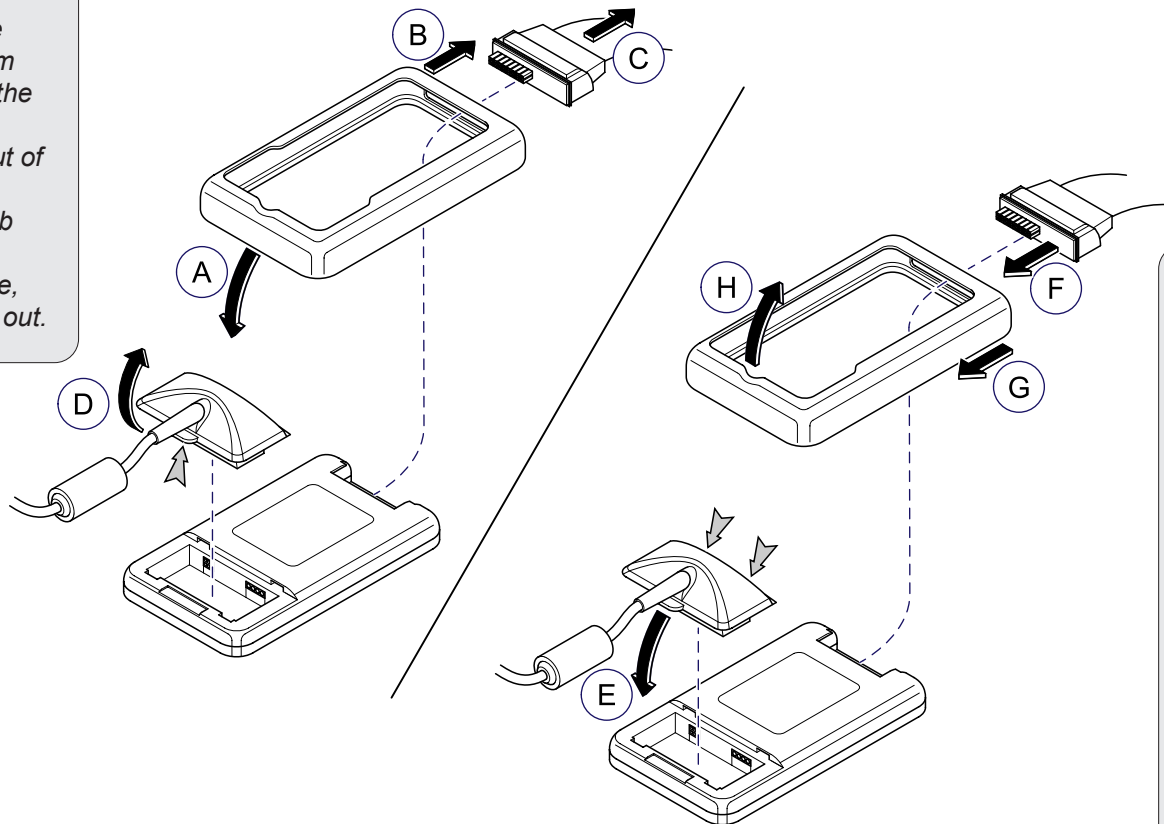

## Note

If you are not replacing both cables there is no need to disconnect the cable you are not replacing.

## Step 1: Assembly

- E) Hook the two small tabs (see two gray arrows) on the front of the new USB Cable into the matching recesses on the unit and rock the connector into its socket.
- F) Push the new patient cable connector through the hole in the silicone cover. Snap the patient cable into its socket, letting the other end of the silicone cover hang underneath the unit.
- G) Push the silicone cover forward onto the unit.
- H) Pull the silicone cover up over the lip of the USB cable connector.

ArtFull