



631-001 Base Actuator [002-11244-0x]

Applies to Models:
631 (-001)

Special Tools:
Bungee Cord
Scissors Lockout Bracket (provided)



WARNING

Always disconnect chair from power source before removing any covers. Failure to do so may result in personal injury.

Note

It may be necessary to run the Tilt Up function to route bungee cord under seat section.

Step 1:

- A) Remove bottom shroud screws.
- B) Stretch a bungee cord (under seat) across top of base column.
- C) Lift shrouds, then attach bungee cord hooks under shrouds on both sides.



WARNING

Ensure scissors lockout bracket is securely in place. Failure to do so may result in personal injury.

Step 2:

- A) Raise base high enough to insert scissors lockout bracket between center rungs of scissors assembly.
- B) Lower base enough to secure lockout bracket in place.
- C) Disconnect chair from power source.

Note

The scissors lockout bracket may be placed in the front or the back of scissors assembly.

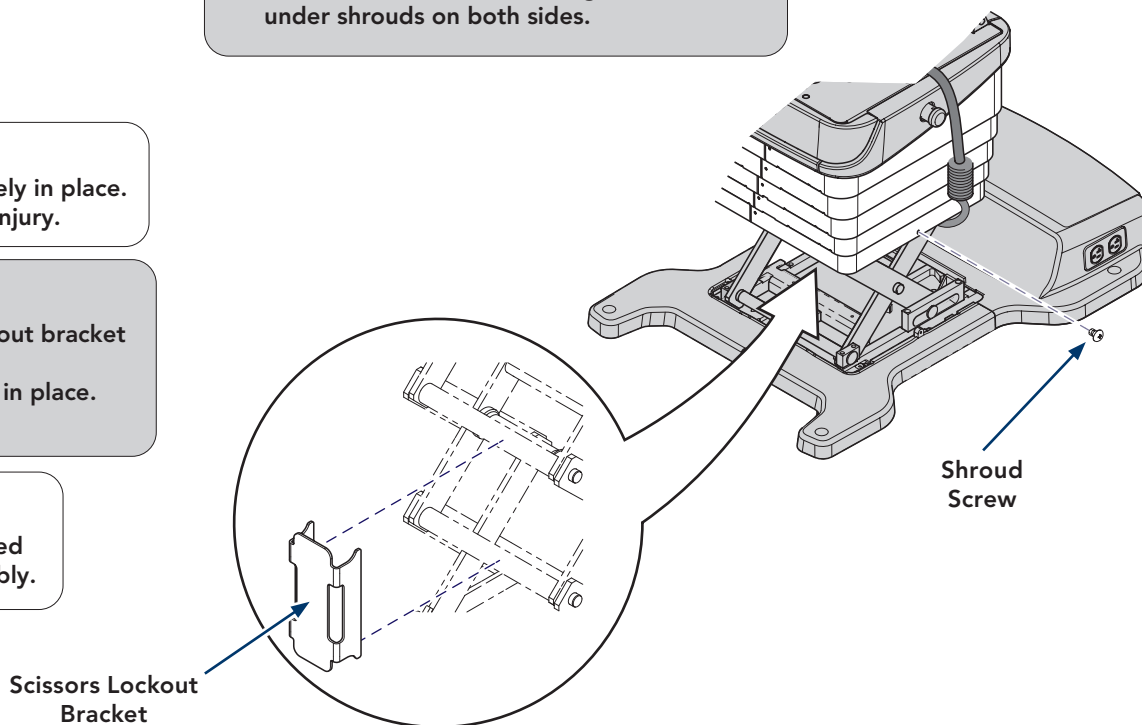

Note

If replacing only the actuator / coupler, refer to the illustration below.
If replacing complete actuator assembly, go directly to Step 3.

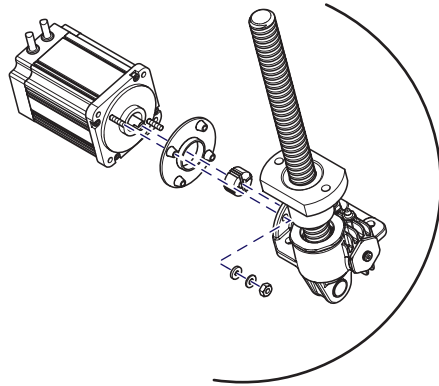

Equipment Alert

The wire connections and wire routing must be put back in original locations before installing covers.

Step 3:

- A) Remove base cover.
- B) Disconnect wire connections J6 and J7 from the Power Supply PC Board.
- C) Pull wires from rear of chair through the wire chase into the center of the chair.
Cut all wire ties securing wires to the chair frame.

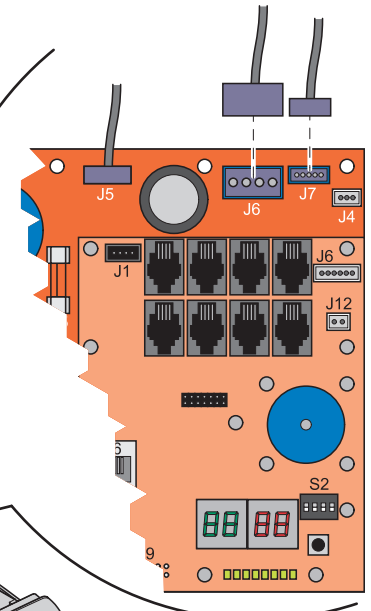

Step 4:

- A) Remove two mounting screws securing the ball nut assembly to cross bar

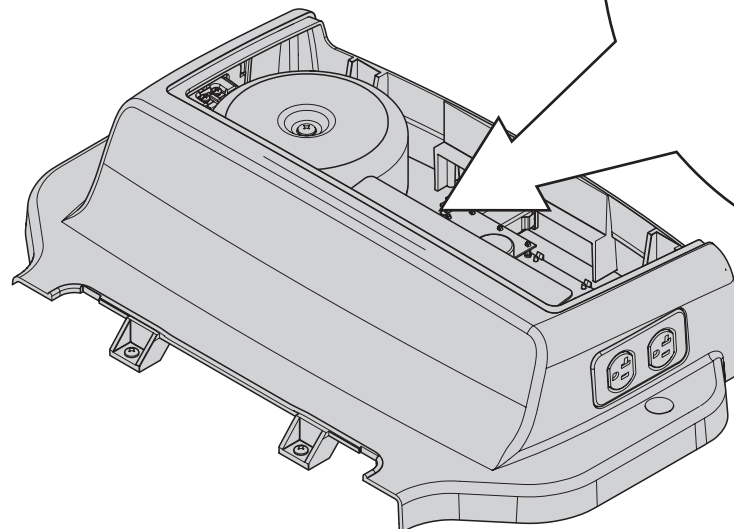
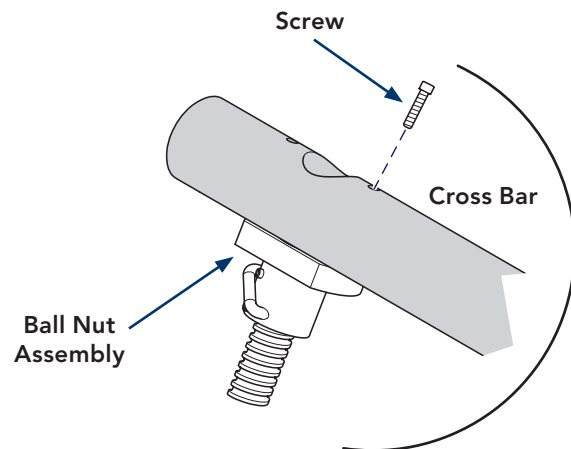

Step 5:

- A) Manually rotate the ball nut assembly to the bottom of the actuator shaft.
- B) Remove one screw, pin retainer and clevis pin.
- C) Lift up on base actuator to remove.

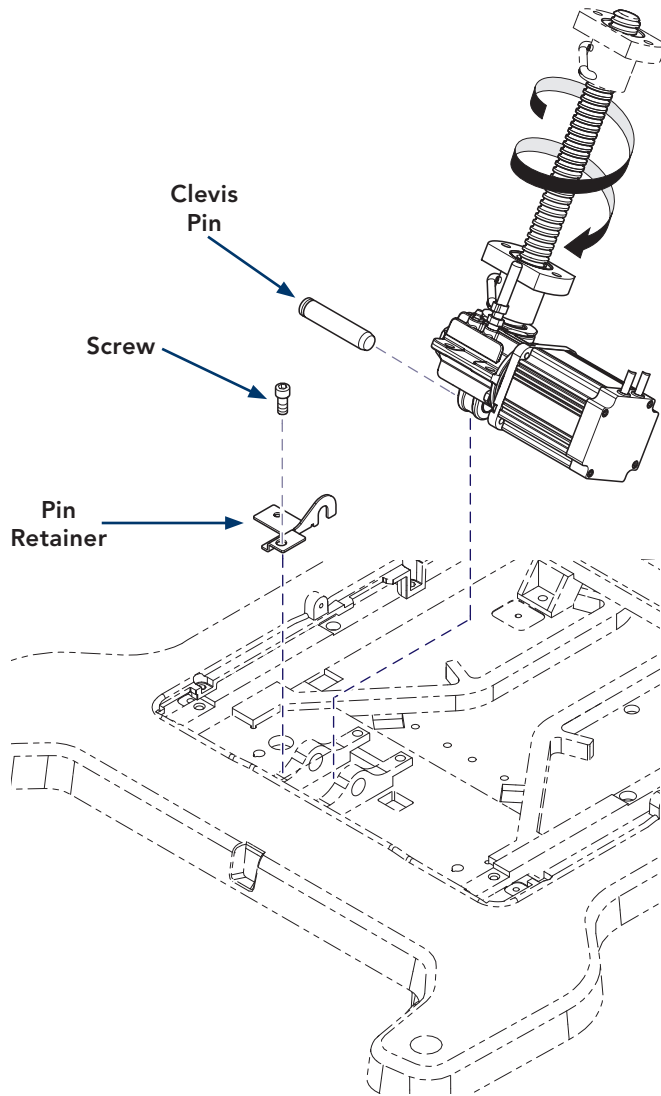

Step 6:

- A) Insert actuator shaft thru hole in cross bar.
- B) Position bottom of actuator and insert clevis pin.
- C) Secure clevis pin with pin retainer and screw.
- D) Manually rotate the ball nut assembly to the top of the actuator shaft and secure with two screws.

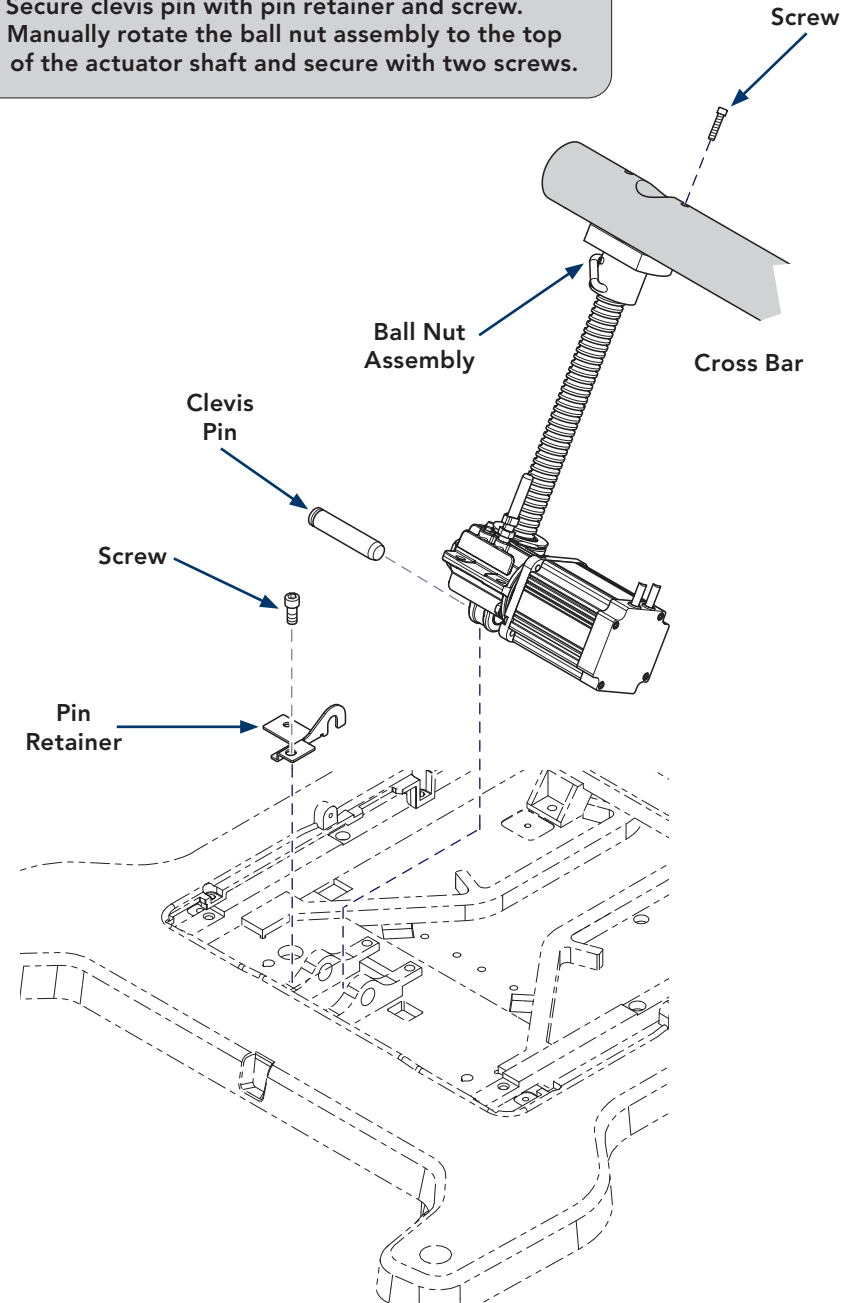



Equipment Alert

The wire connections and wire routing must be put back in original locations before installing covers.



Equipment Alert

Anytime the limit switch wires or the actuator wires are disconnected, the chair must be calibrated.

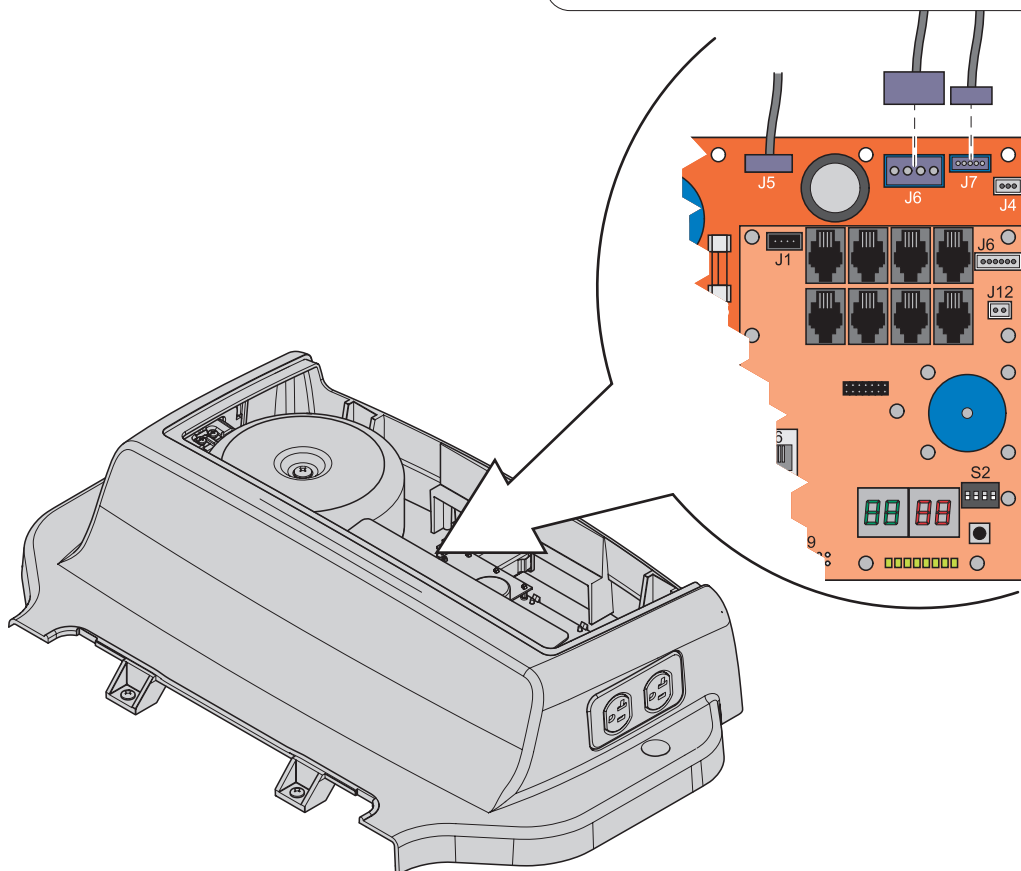

Step 7:

- A) Route the actuator wire through the wire chase in the center of the chair to the back. Ensure wires are away from all moving parts and secure with wire ties from previously cut locations.
- B) Connect wire connections to J6 and J7 on Power Supply PC Board, then secure wires with cable ties.
- C) Raise base and remove scissors lockout bracket.
- D) Lower base and reassemble shrouds.
- E) Calibrate chair.
- F) Install base cover.

Scissors Lockout
Bracket

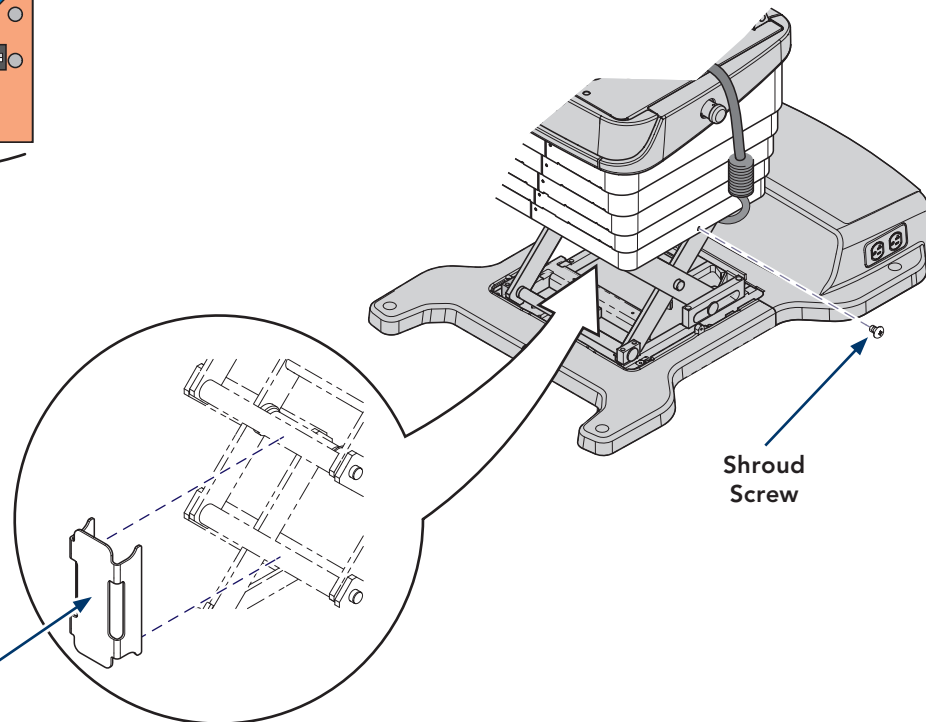

Shroud
Screw

Base Cover

Base Cover Removal / Installation



WARNING

Always disconnect chair from power source before removing any covers. Failure to do so may result in personal injury.

Removal...

- A) Remove one screw and lock washer.
- B) Slide cover back and lift off of base.

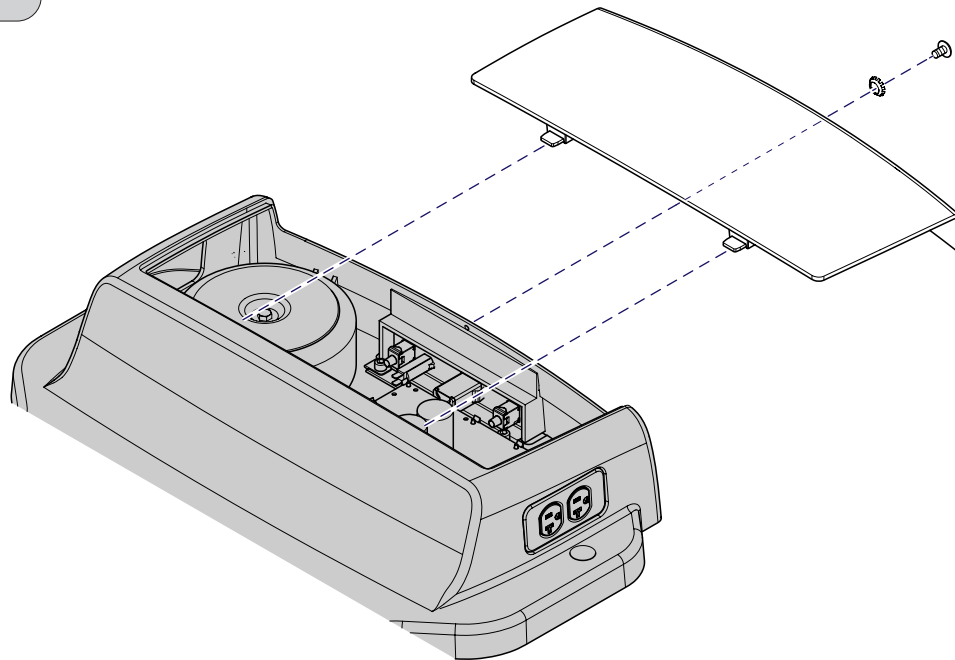

Installation...

- A) Align tabs and position cover on base.
- B) Secure with one screw and lock washer.

Calibration Procedure

During the calibration procedure you will hear a steady pattern of “beeps” .
The chair will run all functions (base, back, tilt, foot) to their minimum and maximum positions,
then return to a lowered flat position.
When calibration is complete, the chair will stop moving and you will hear three short “beeps”.

You must calibrate the chair in the following situations:

- After replacing Power Supply PC Board.
- After replacing Motor Control Hub PC Board.
- After replacing Machine Control Board.
- After replacing Base, Back, Tilt or Foot actuators.
- After a limit switch bracket is adjusted.
- When an error code indicates calibration is needed.



Equipment Alert

Anytime the PC Board is removed or the actuator wires are disconnected, the chair must be calibrated.

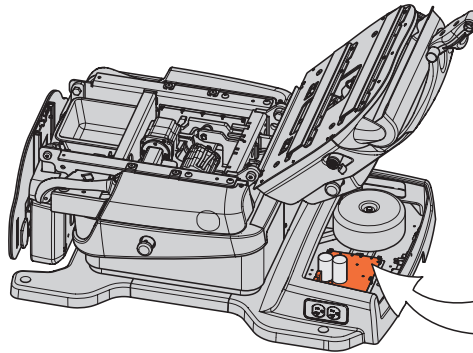

Machine
Control
Board

Note

When S3 switch is pressed, then released you will hear a steady pattern of “beeps”. When calibration is completed you will hear three short beeps.

To Calibrate...

- Slide foot section to highest stowed position.
- Unplug chair power cord.
- When the digital display darkens, move S2 switch number four to ON (up).
- Plug in chair power cord.
- When the digital display darkens, press and release S3 switch.
- When calibration is complete, unplug chair power cord.
- Move S2 switch number four to OFF (down).
- When the digital display darkens, plug in chair power cord.

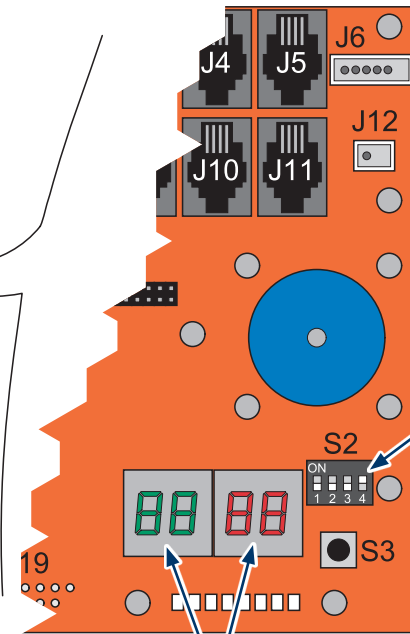

Switch
Number
Four

Digital
Display