



WARNING

Always disconnect chair from power source before removing any covers. Failure to do so may result in personal injury.

Note

This illustration shows top components removed for clarity only.

Step 1:

- A) Pull outward on the top of front upper cladding and unsnap.
- B) Unsnap side cladding from front lower cladding and rear cladding to remove.
- C) Remove two screws from front lower cladding.
- D) Remove one screw and washer from rear cladding.

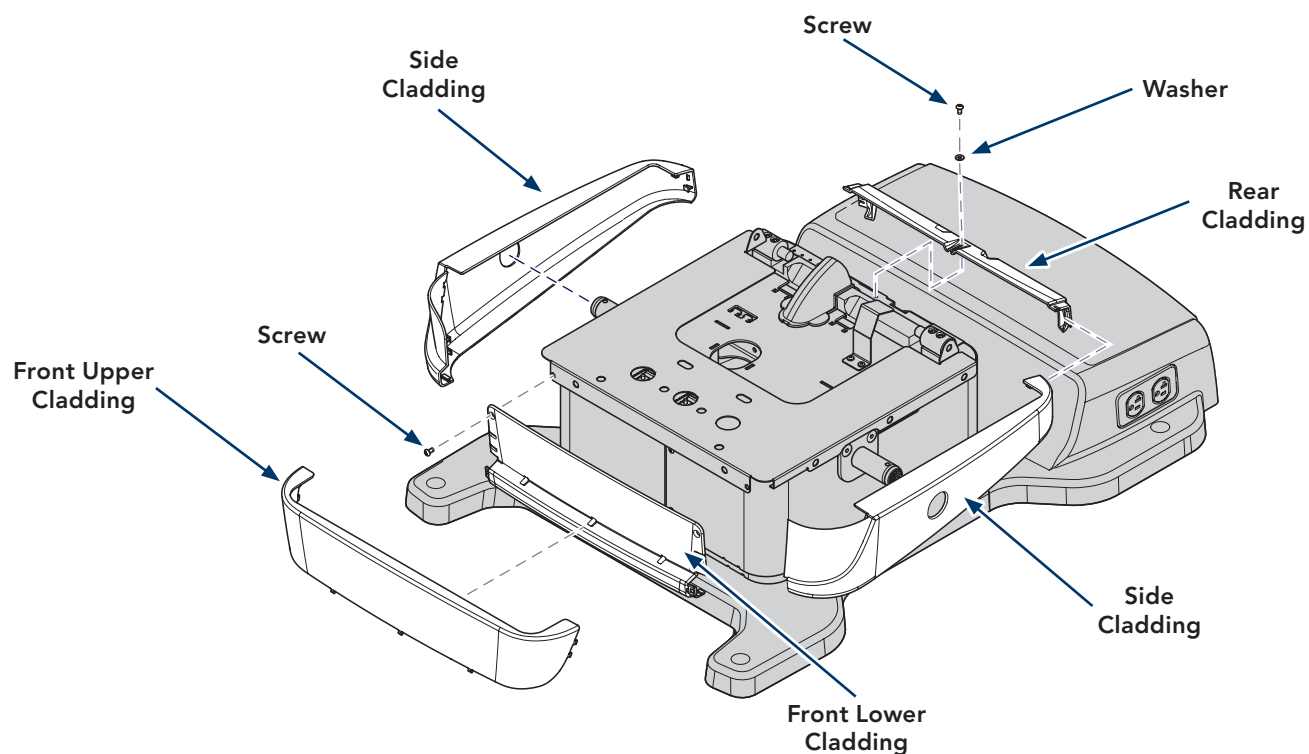

Note

For ease of shroud removal, it is recommended to remove the bail.
This illustration shows top components removed for clarity only.

Step 2:

- A) Remove two screws and two bushings.
- B) Slide bail forward and remove.

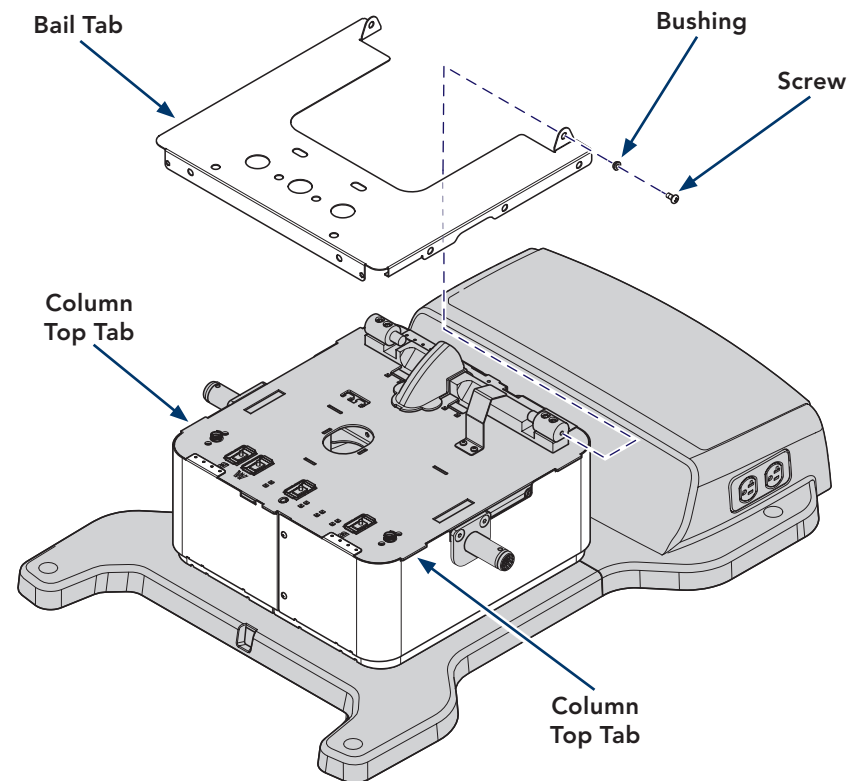



Equipment Alert

Be sure front bail tabs capture the column top tabs.

Step 5:

- A) Position bail on top of column.
- B) Secure with two bushings and two screws.

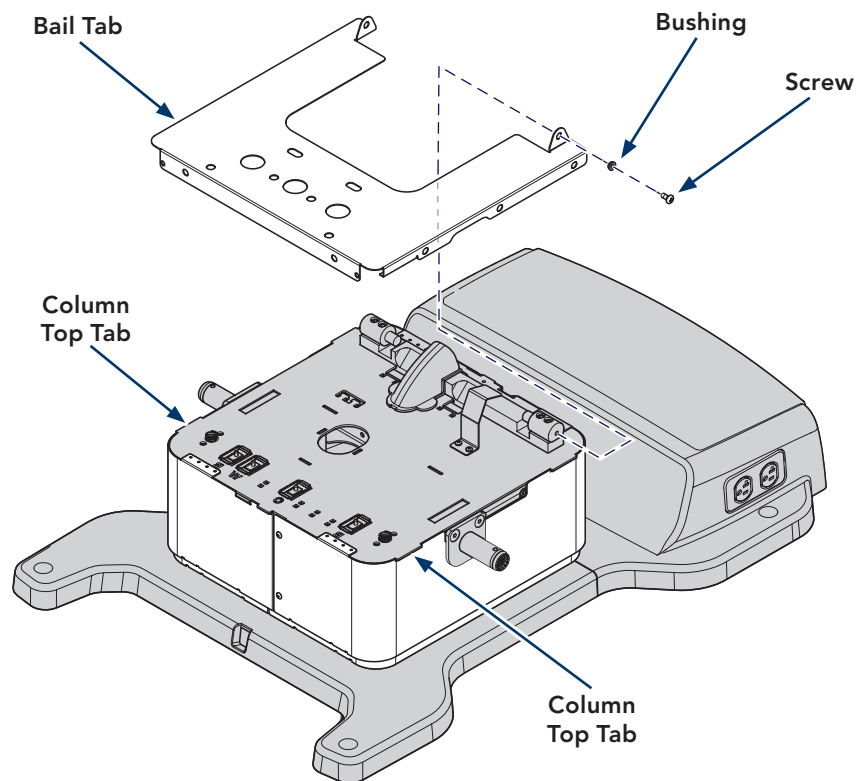

Step 6:

- A) Position rear cladding and secure with washer and screw.
- B) Position front lower cladding and secure with two screws.
- C) Position side cladding and snap into place.
- D) Engage bottom tabs of front upper cladding and snap onto front lower cladding.

