



# Midmark® Cabinet / Wall Light Installation

## Applies to Models:

153908 (-002)  
153909 (-002)  
153640 (-001)  
153641 (-001)

Language of origin: English

[Full size template is available: 003-1289-00]



### WARNING

Equipment is not suitable for use in the presence of a flammable anesthetic mixture.



### Equipment Alert

Before installing the Midmark Cabinet / Wall Light, ensure the physical room requirements outlined are met.

## Physical Requirements

**NOTE:** This install guide applies to Halogen and LED-style lights.

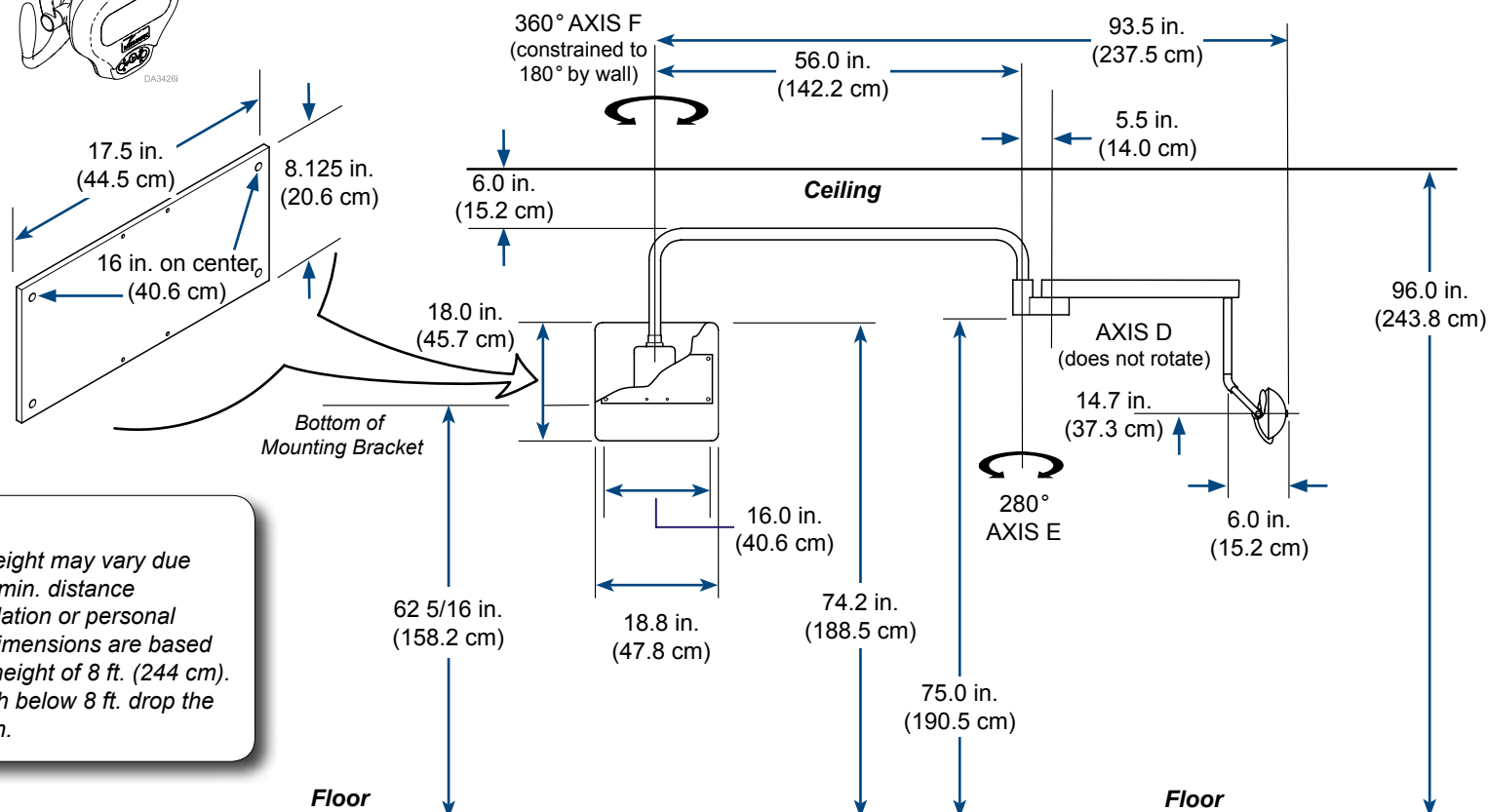
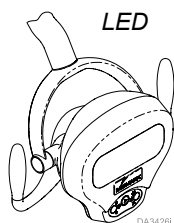

### Note

Unit is shipped with a power cord and plug assembly. Where installation requires a power outlet, the outlet must be within 12 feet of wall or cabinet mounting.

### Note

Recommended height may vary due to 6 in. (15.2 cm) min. distance required for installation or personal preferences. All dimensions are based on a min. ceiling height of 8 ft. (244 cm). For every one inch below 8 ft. drop the mounting one inch.

DA3400i

## Physical Requirements...continued



### Equipment Alert

Before installing the Midmark Cabinet / Wall Light, ensure the physical room requirements outlined are met.

### Center Column Installation

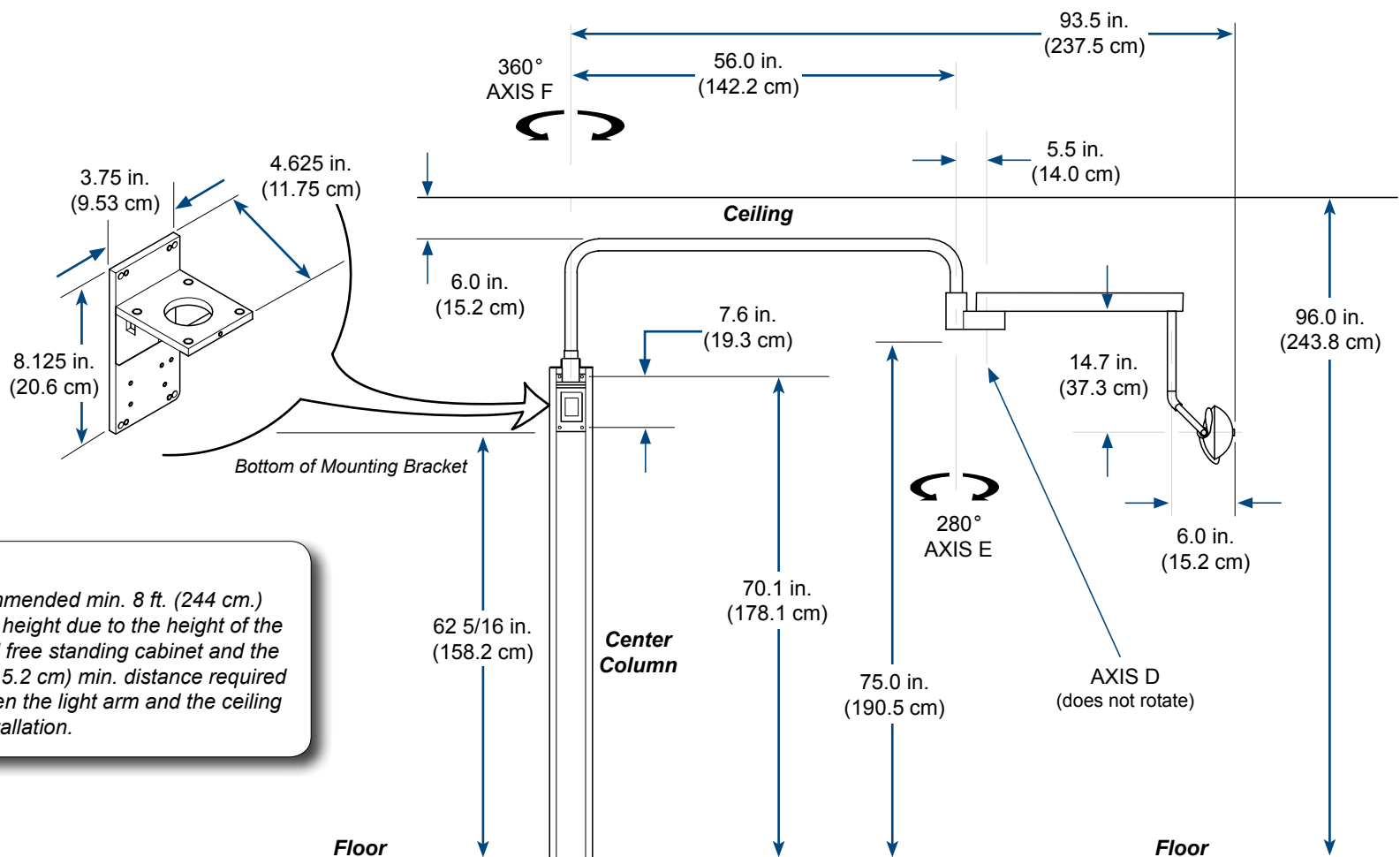

### Note

Recommended min. 8 ft. (244 cm.) ceiling height due to the height of the central free standing cabinet and the 6 in. (15.2 cm) min. distance required between the light arm and the ceiling for installation.

DA3401i

General Movement Characteristics

General Information

The support structure must be capable of supporting:

System (only)	
Weight (Max.):	66 lbs (29.9 kgs)
Torque (Max.):	170 ft-lbs. (230.5 N·m)

In addition to supporting the above listed weights, the support structure must also be able to support the light without deflection. To prevent the suspension arm from drifting, the assembly must deflect no more than 1/16 in. (1.6 mm) over a 12 in. (30.5 cm) distance.

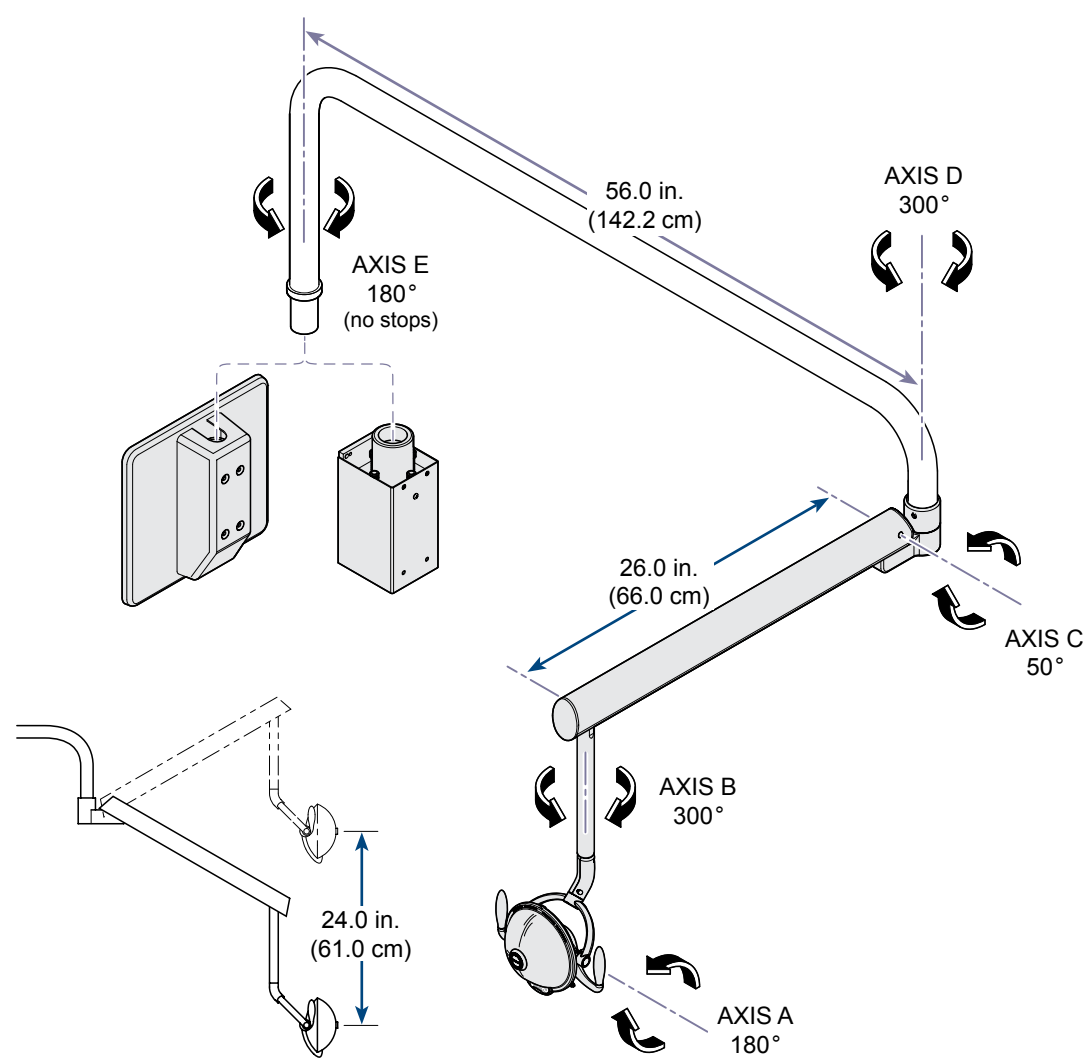

DA3402i

## Wall Mount Installation

### Location

The wall mount assembly must be located so the operation of the light and arm assembly does not interfere with procedures or patient access. Power source must be within 12 feet of mounting location.

### Structure

The wall mount backer plate must be leveled and secured with appropriate hardware to vertical wall studs or other substantial support structure capable of supporting the total weight of the light and arm assembly (refer to General Information).

### Power Source

Light may be plugged into an appropriate wall outlet or wired to a suitable power source. The power source must be grounded, and protected by a 15 amp circuit breaker for 115 VAC operation or a 7.5 amp breaker for 230 VAC operation. All wiring must be applicable to state and local codes.

\* Recommended height may vary due to 6 in. (15.2 cm) min. distance required for installation or personal preferences. All dimensions are based on a min. ceiling height of 8 ft. (244 cm). **For every 1" (2.54 cm) below 8 ft. drop the mounting 1" .**

**Step 1:** Using template located on shipping box, place in position, level, and mark wall (outside) mount backer holes.

**Step 4:** Remove light mount assembly from wall mount backer, four screws.

**Step 3:** Slide wall mount cover from light mount assembly.

**Step 2:** Remove transformer cover, four screws.

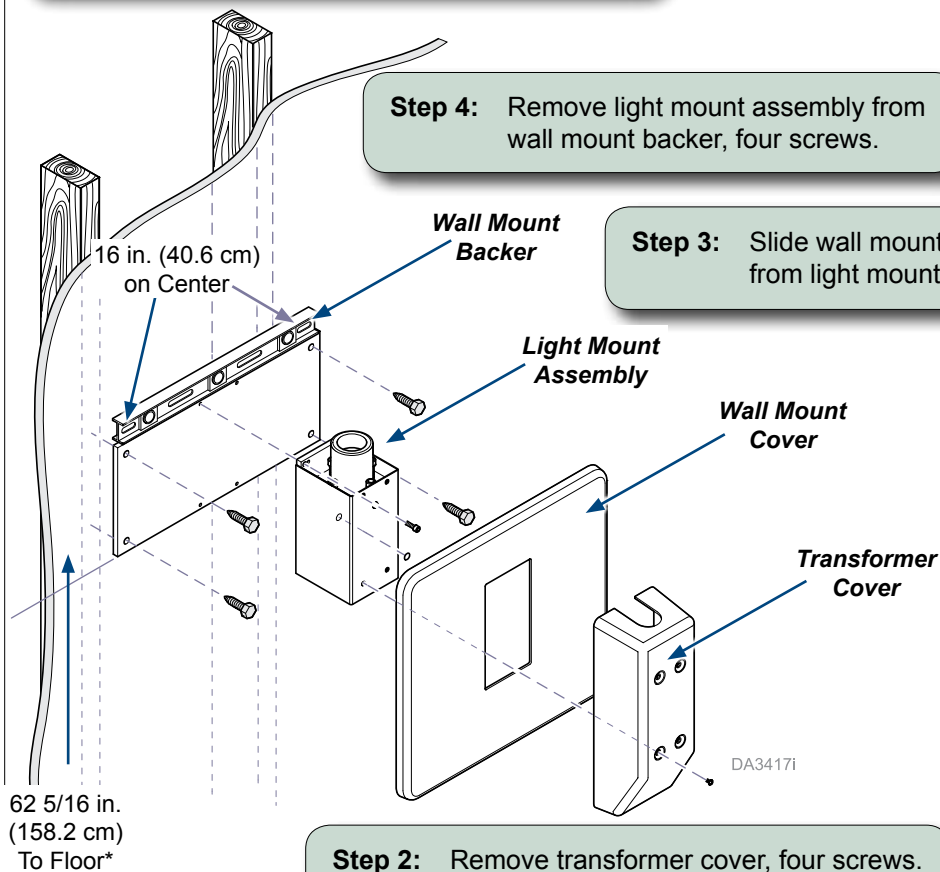

### Note

Refer to chase installation manual for mounting hole locations. To install light, use hardware included with chase cabinet. (3/8" bolts, washers and nuts)

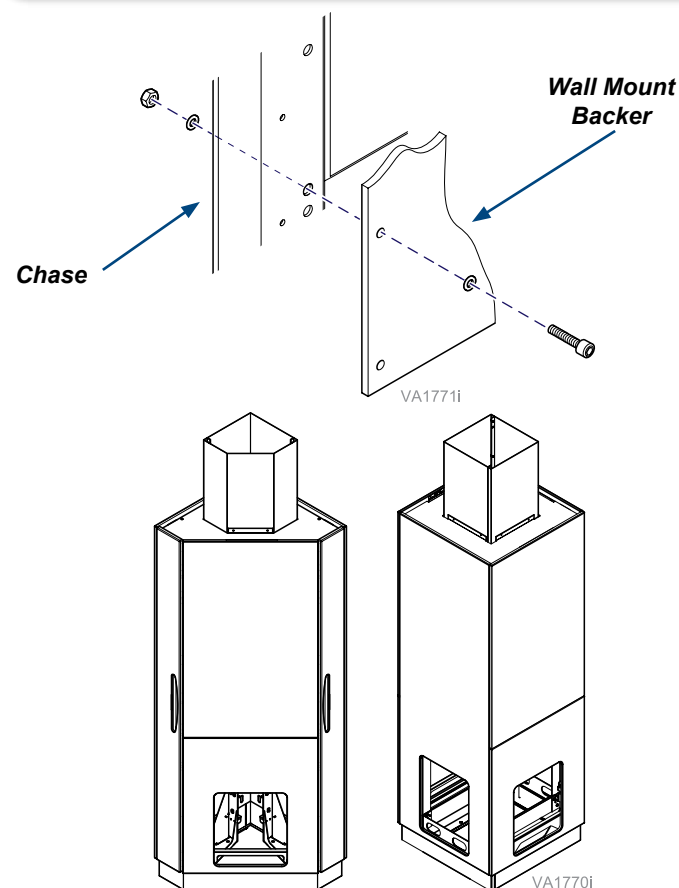

## Wall Mount Installation...continued



### Equipment Alert

Failure to secure to a substantial structure with appropriate hardware capable of supporting the light assembly could result in equipment malfunctioning and damage.

**Step 5:** Align mounting holes of wall mount backer with location holes on wall and secure with appropriate hardware. Check to assure wall mount backer is level.

**Step 6:** Position light mount assembly on wall mount backer and secure with four screws.

### Note

If supply voltage is 230 VAC refer to ADJUSTING TRANSFORMER FOR 230 VAC.

**Step 7:** Place wall mount cover in position on light mount assembly.

\* Recommended height may vary due to 6 in. (15.2 cm) min. distance required for installation or personal preferences. All dimensions are based on a min. ceiling height of 8 ft. (244 cm). **For every one inch below 8 ft. drop the mounting one inch.**

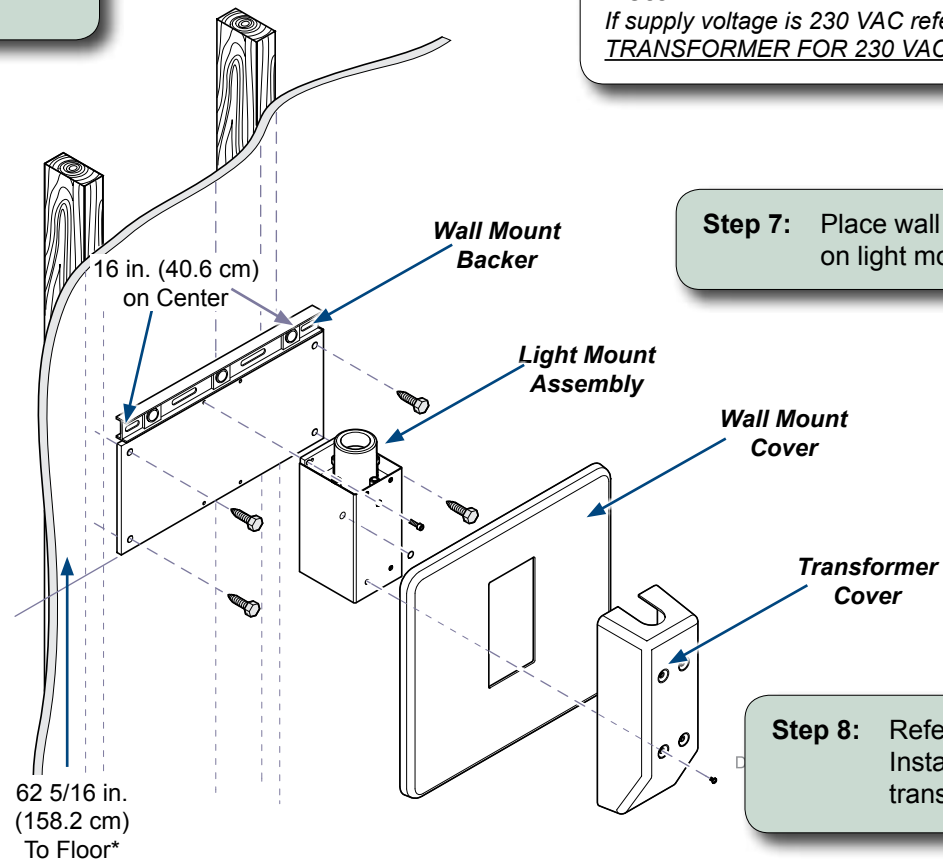

**Step 8:** Refer to Light Head and Arm Installation before installing transformer cover.

## Cabinet Mount Installation

### Location

The cabinet mount assembly must be located so the operation of the light and arm assembly does not interfere with procedures or patient access. Power source must be within 12 feet of mounting location.

### Structure

The cabinet mount must be leveled and secured to cabinet structure with appropriate hardware (1/4"-20, grade 8, socket head cap screws) capable of supporting the total weight of the light and arm assembly (refer to General Information).

### Power Source

Light may be plugged into an appropriate wall outlet or wired to a suitable power source. The power source must be grounded, and protected by a 15 amp circuit breaker for 115 VAC operation or a 7.5 amp breaker for 230 VAC operation. All wiring must be applicable to state and local codes.

### Note

There are two sets of holes on the template for cabinet mounting. Inside holes are for drilling clearance holes when installing screws from the front into threaded holes or when using washers and nuts. The outer holes are when installing 1/4"-20 screws through cabinet into mounting plate.

**Step 1:** Use existing holes from previous light or use template located on shipping box. Place template in position, level, and mark cabinet mounting holes.

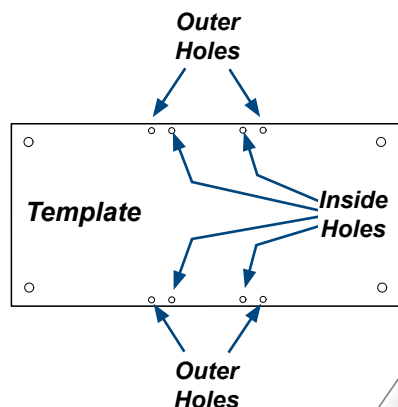

### Equipment Alert

Failure to secure to a substantial structure capable of supporting the light assembly could result in equipment malfunctioning and damage. Mounting hardware must be 1/4 in.-20, grade 8, socket head cap screws and lockwashers.

**Step 2:** Align mounting holes of mounting bracket with location holes on cabinet and secure with appropriate hardware. Check to assure mounting bracket is level.

1/4" Nylock nuts can be used when installation is on products other than Midmark.

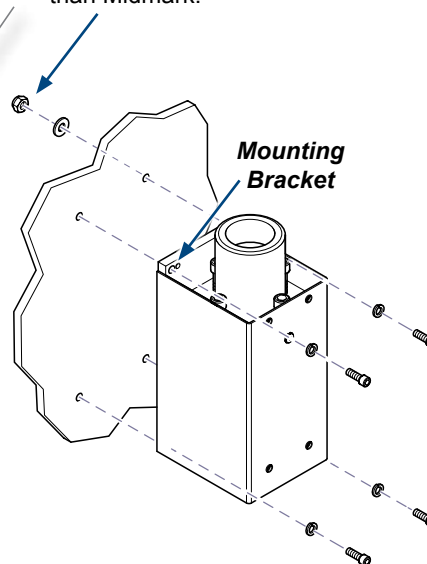

### Note

If supply voltage is 230 VAC refer to Adjusting Transformer for 230 VAC.

**Step 3:** Refer to Light Head and Arm Installation before installing post mount cover.

DA3420I

## Adjusting Transformer for 230 VAC (Halogen ONLY)

### Note

If supply voltage is 230 VAC, the following procedure must be performed before connecting power to light.

**Step 2:** Disconnect brown lead from **115 V** tap on transformer and connect to **230 V**.

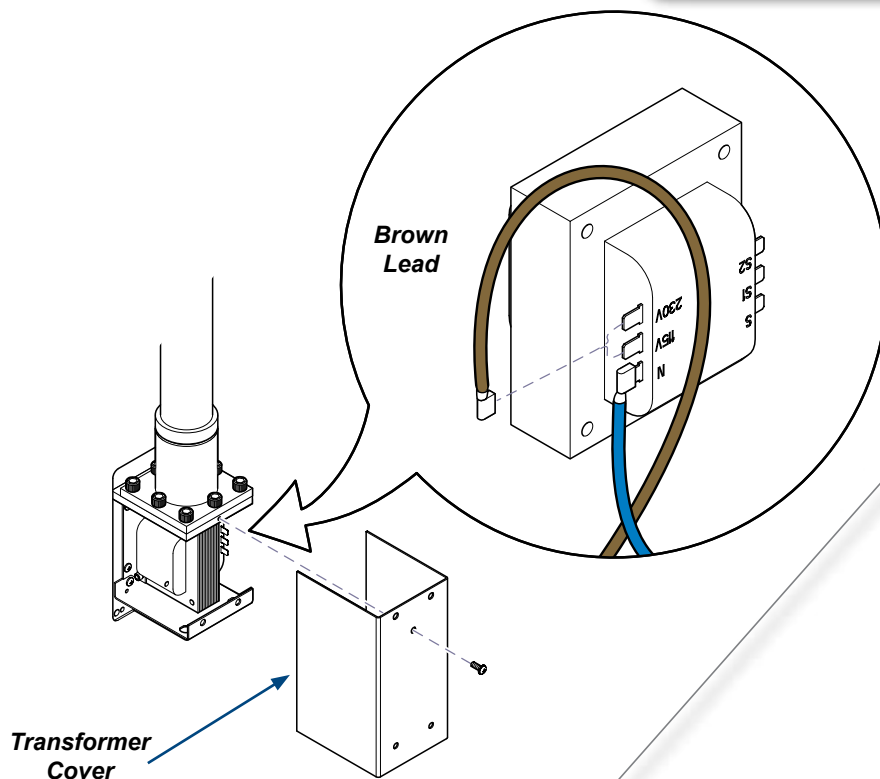

**Step 1:** Remove transformer cover, one screw.

### Note

Cabinet units may not have the post mount cover.

**Step 3:** Install transformer cover and, where applicable, post mount cover.

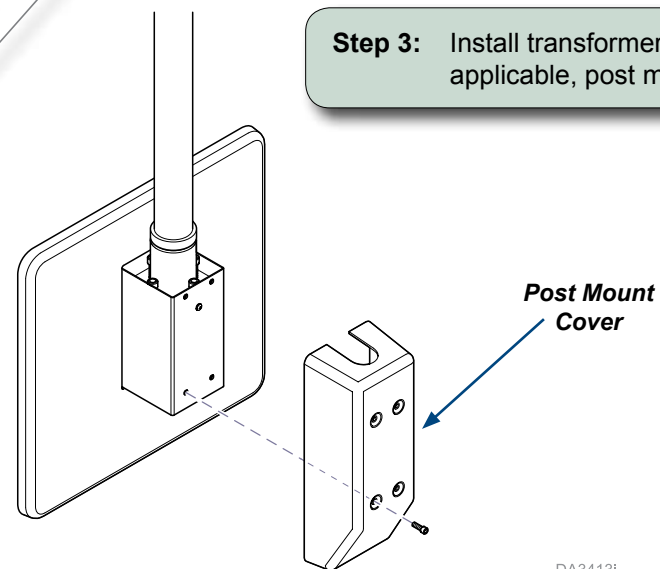

DA3413i

## Installing Plug to Power Cord

### Note

If facility voltage is 230 VAC, install a properly rated plug according to local codes and regulations. Adjust transformer for 230 VAC operation.

### Step 1:

- A) Remove screw as shown & three pronged portion of plug.
- B) Loosen two screws as shown & insert power cord into housing.

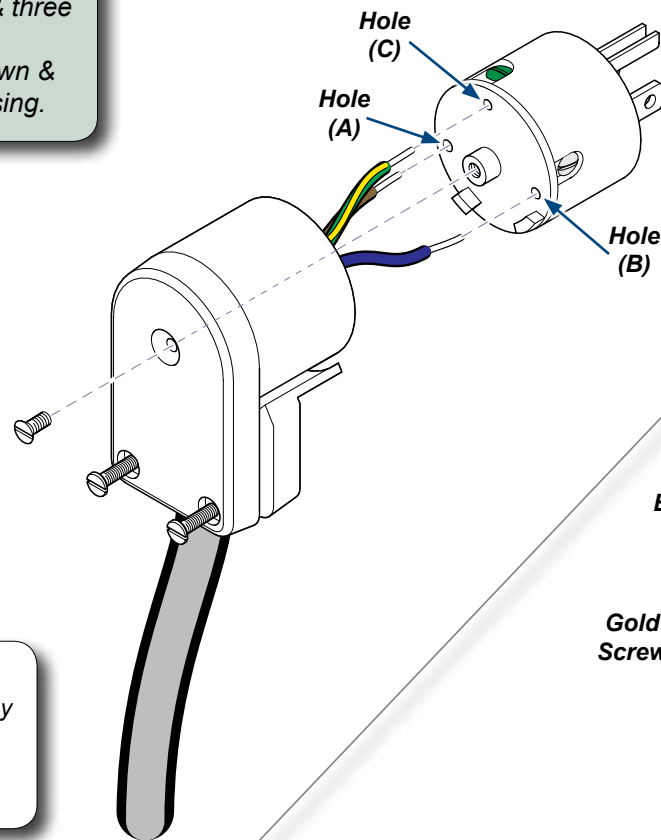

### Note

The three pronged portion of plug may be installed in four different positions. Be sure two tabs on pronged portion align with notches in housing.

### Step 3:

- A) Rotate three pronged portion of plug to desired position in housing & secure with screw.
- B) Tighten two screws so that power cord is secured. Do not overtighten screws.

### Step 2:

- A) Insert BROWN wire from power cord into hole (A) & tighten GOLD screw.
- B) Insert BLUE wire from power cord into hole (B) & tighten SILVER screw.
- C) Insert GREEN wire from power cord into hole (C) & tighten GREEN screw.

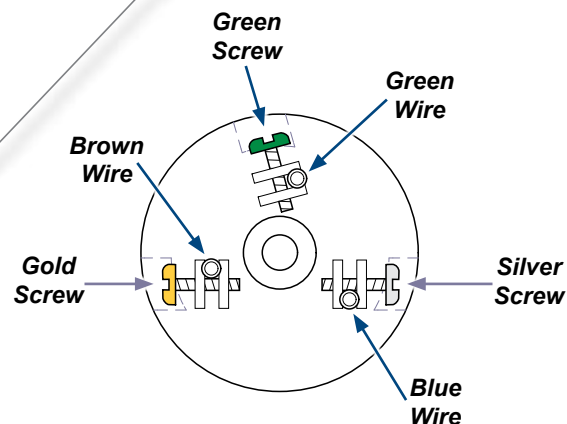

DA3416i

- Step 4:** Plug power cord into properly rated receptacle & check for proper operation.



## Arm and Light Head Installation

**Step 1:** Place fixed arm assembly in position & connecting harness plug (A) from fixed arm to plug (B) on cabinet / wall mount assembly.

Bearing Housing

A

B

**Step 2:** Insert fixed arm into bearing housing.

Fixed Arm Assembly

**Step 3:** Insert collar onto fixed arm, snugging up set screw to hold it in place.

### Note

Assure the collar is installed with the set screw toward the bottom. Do Not locate the set screw over the key.

Collar

Key

C

D

Flex Arm

**Step 4:** Connect harness plug (C) from fixed arm to connector (D) in flex arm assembly.

DA3422i

## Arm and Light Head Installation...continued



### Equipment Alert

To ensure quiet operation, apply a thin coat of lubricant (included w/light) to inside of fixed arm and bearing shaft of flex arm assembly.

**Step 8:** On wall mount units, install transformer cover.

**Step 6:** Check level of fixed arm and, if necessary loosen or tighten four leveling screws.

**Step 7:** Tighten mount screws to secure position.

Leveling  
Screws

Mount  
Screws

Fixed Arm  
Assembly

Transformer  
Cover

Collar

Key

Flex  
Arm

**Step 5:** Insert end of flex arm into end of fixed arm. Install the key, then move collar down over the key & tighten set screw.

*Note:* The set screw cannot be located over key.

### Note

Units are equipped with a separate 115 VAC plug for installation on the cord. The unit can also be direct wired to an appropriate circuit. Should a 230 VAC plug be desired it must be purchased locally.

**Step 9:** Connect unit to the appropriate electrical supply.

DA3425i

## Tension Adjustments

### To adjust tension at Light pivot joint...

- Remove screw cover as shown.
- Loosen set screw.
- Loosen or tighten light pivot adjustment screw.
- Tighten set screw.

### To adjust tension at Arm / Yoke pivot joints...

- Remove neck cover as shown (see Note).
- Loosen or tighten appropriate screws to adjust tension.

Note: Some halogen models have a short neck on the lighthouse. It is not necessary to remove the neck cover on these models.

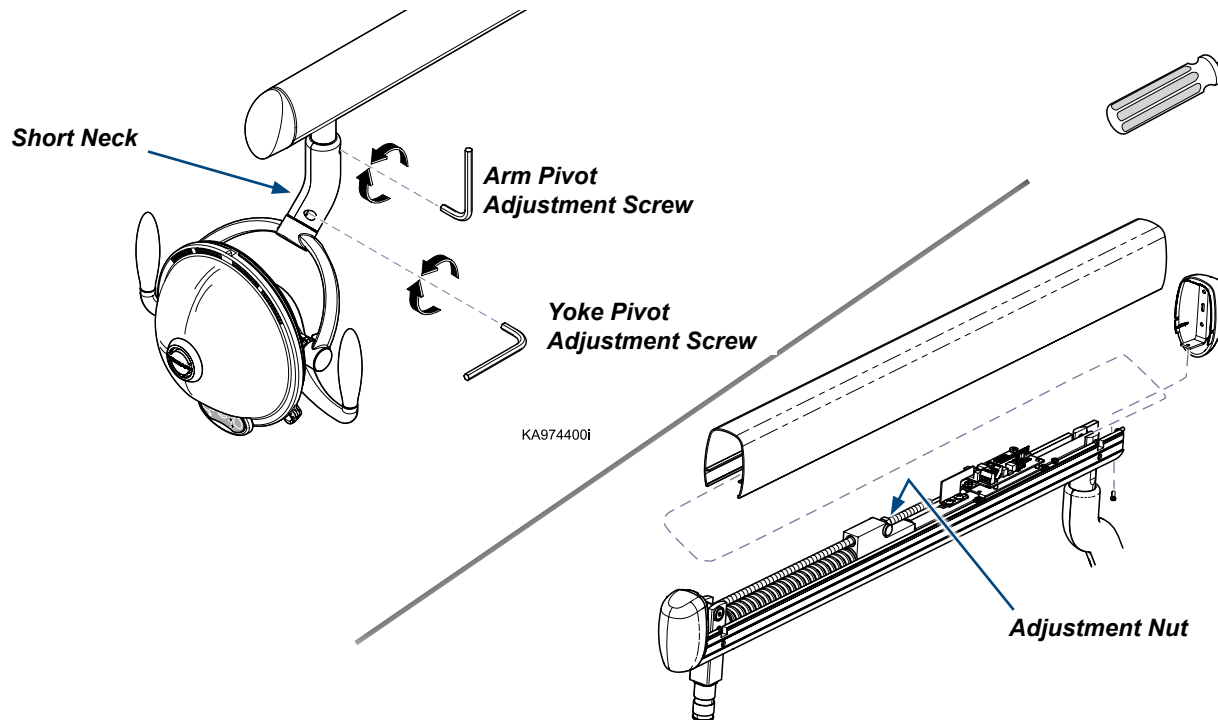
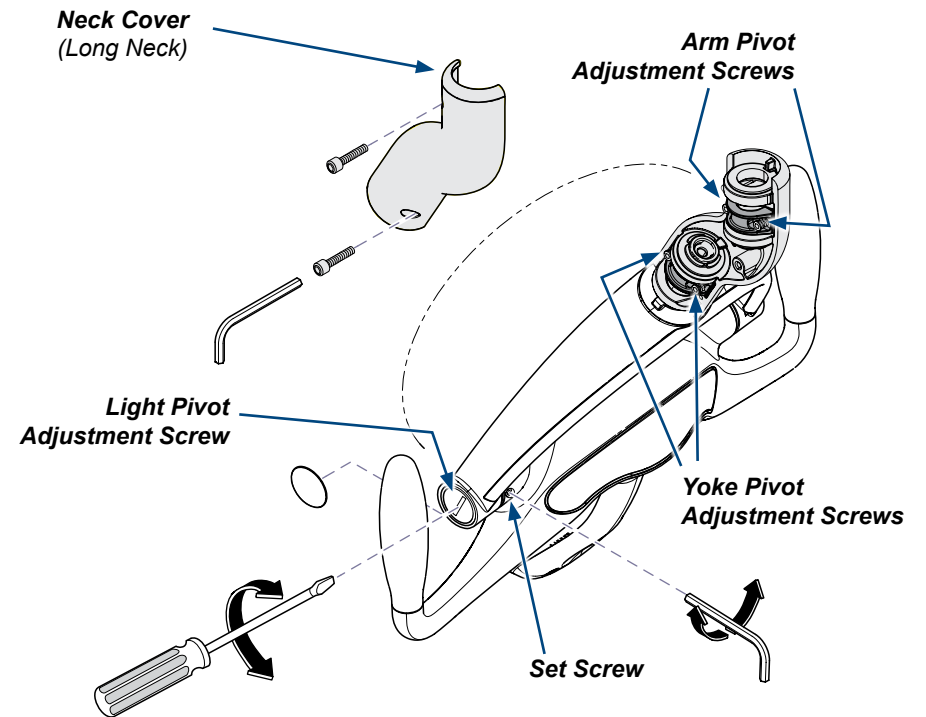

### To adjust Flex Arm tension...

- Remove end cap and top cover as shown.
- Loosen or tighten adjustment nut as desired.