

## Arm Socket Accessory [9A350002]

### Applies to Models:

230  
630 (-001 thru -009)

### Special Tools:

none

### **Restrictions:**

*Cannot use arm on same side as a base rail mounted 253 light.*

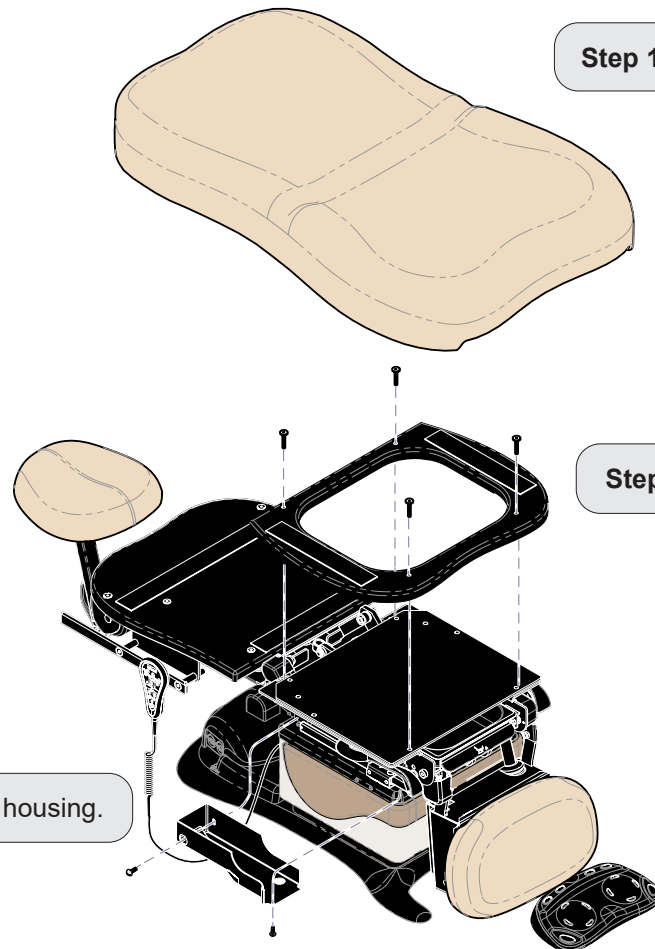

**Step 1:** Remove seat / back upholstery.

**Step 2:** Remove seat mounting board.

**Step 3:** Remove stirrup housing.

MA6420001

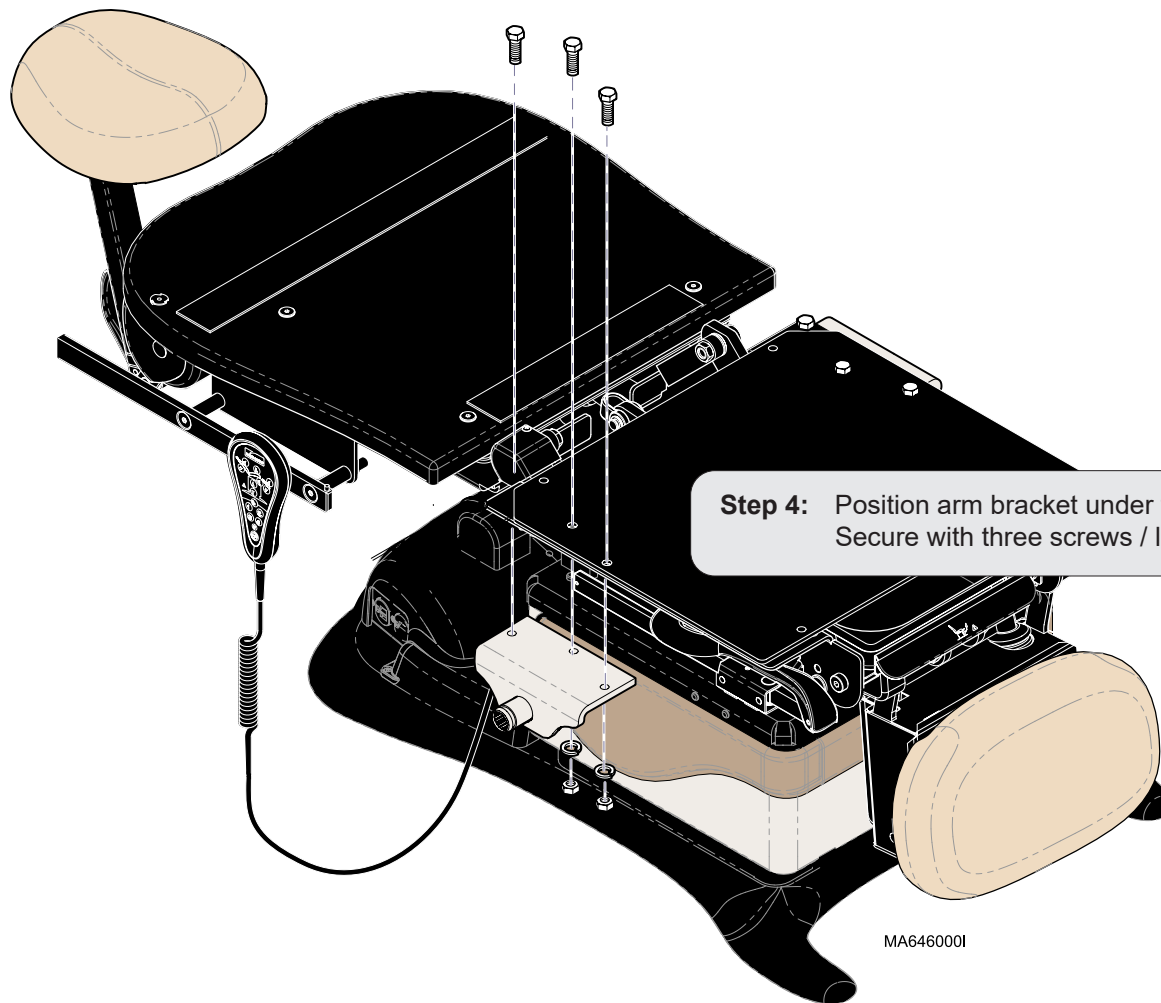

**Step 4:** Position arm bracket under flange of seat weldment. Secure with three screws / lockwashers / nuts.

**Step 5:** Replace stirrup housing, seat mounting board and upholstery. (Refer to page 1)