

Components:  
Upper Glide ..... 2

Special Tools:  
none

**Note:** If possible, lower the base before removing shrouds. This will prevent the shrouds from falling when the outer shrouds are removed.

Midmark models only

**Removal**

**Step 1:** Remove three magnetic covers.

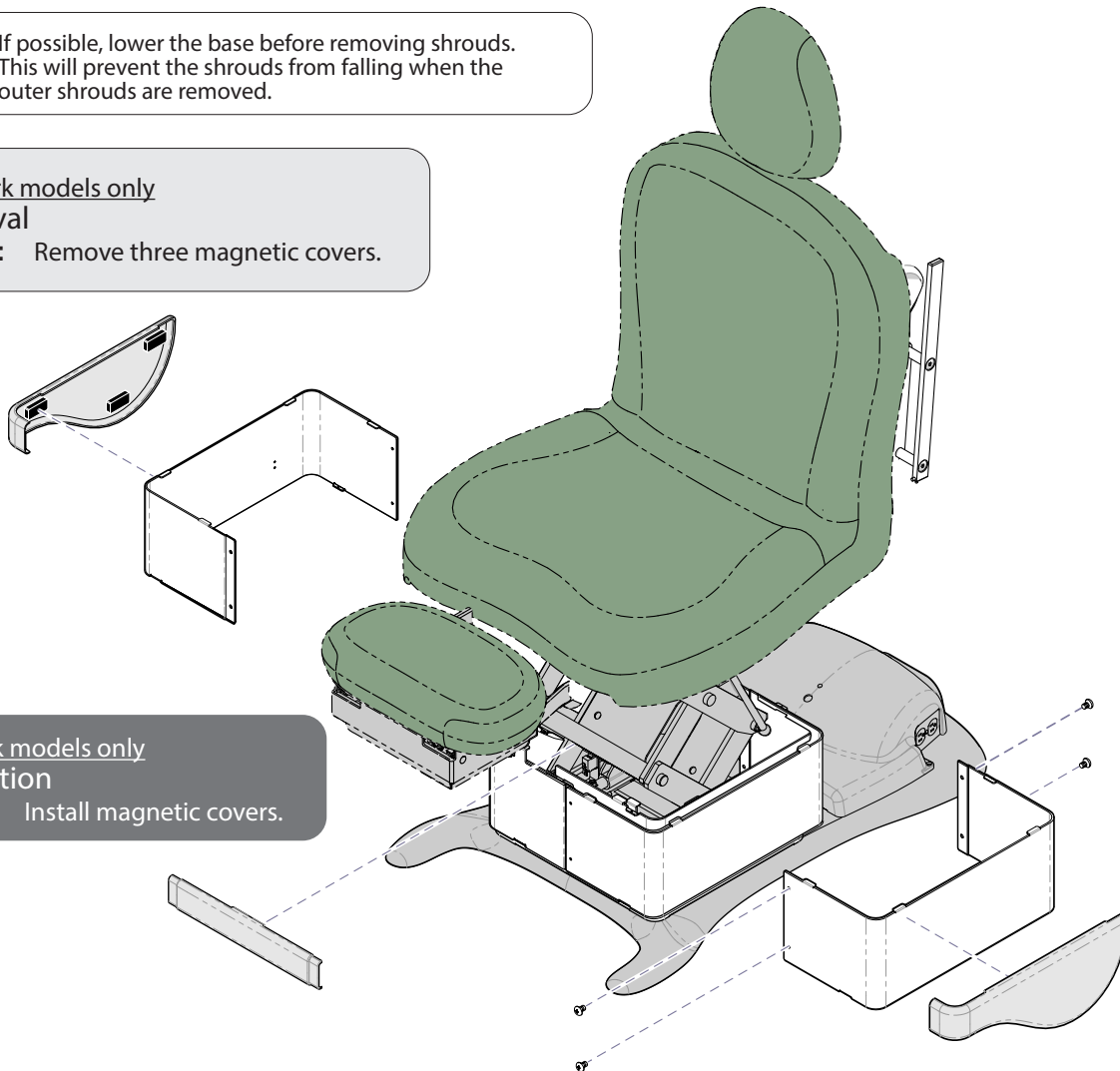

Midmark models only

**Installation**

**Step 4:** Install magnetic covers.

**Removal**

**Step 2:** Remove screws from outer shrouds only. Pull shrouds outward to disengage tabs.

**Installation**

**Step 3:** Position outer shrouds. Secure with screws at both ends.

**Note:** Insert shroud tabs into seat weldment slots.

## Installation

**Step 2:** Secure two guide bars with four screws.

## Removal

**Step 3:** Remove two screws from guide bar.  
Repeat on opposite side.

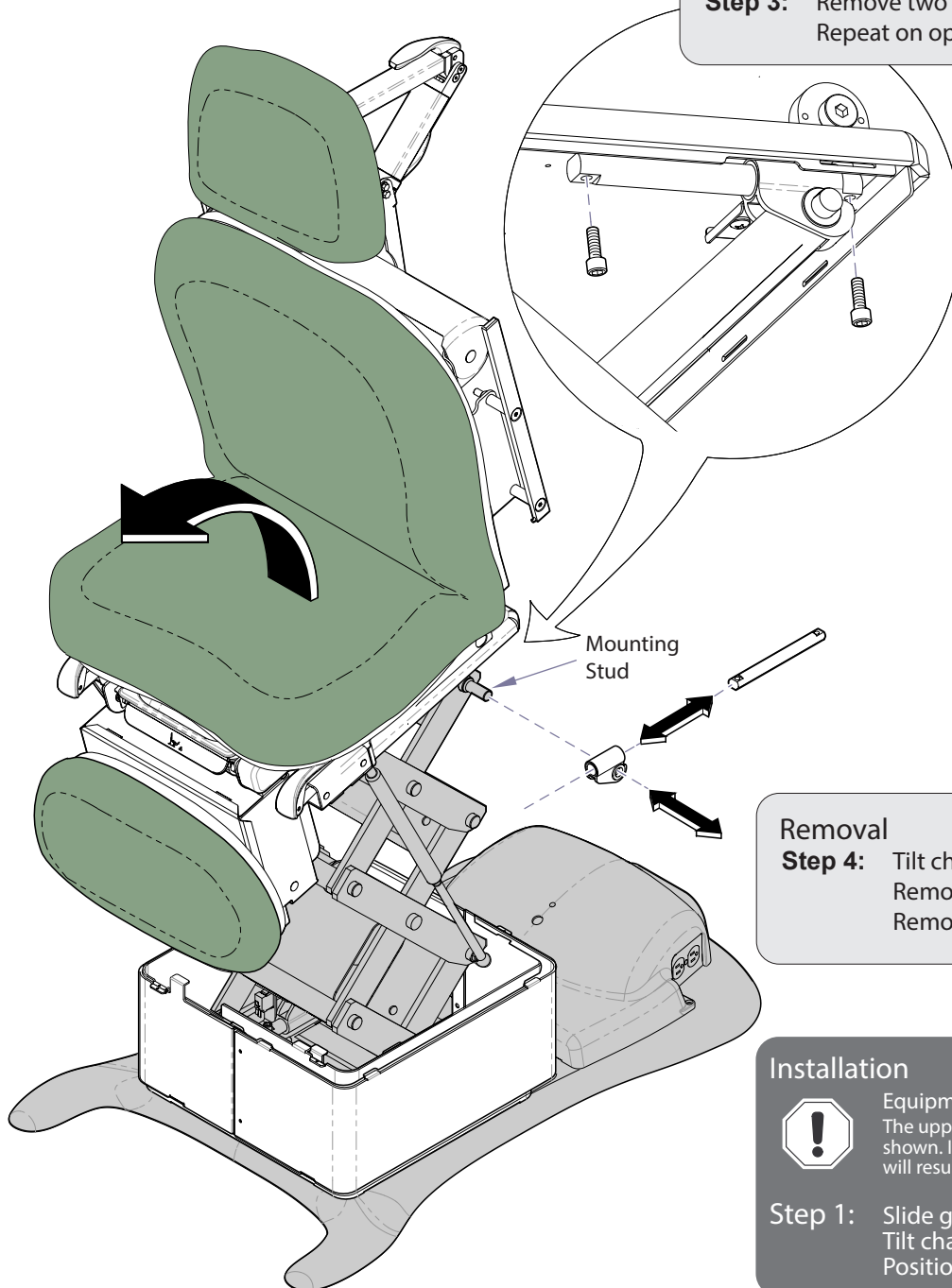

## Removal

**Step 4:** Tilt chair top slightly (toward foot end).  
Remove two guide bars.  
Remove two upper glides.

## Installation



### Equipment Alert

The upper glide must be positioned as shown. Installing the glide backwards will result in damage to the chair.

**Step 1:** Slide guide bar thru upper glide.  
Tilt chair top slightly (toward foot end).  
Position upper glide on mounting stud.