

Rotational Base Repair Kit [002-0998-0x]

Components:

Rotational Base Assy (Lower) 1
Cable Ties 6

Special Tools:

bungee cord
saw horses (2)
5/16" allen wrench

Removal

Step 1: Route bungee cord across top of base column (under seat).

Note: It may be necessary to run the Tilt UP function to route bungee cord under seat section.

Removal

Step 2: Run Base UP function to its max height. Position chair so that foot and back sections are level as shown.

(630 shown)

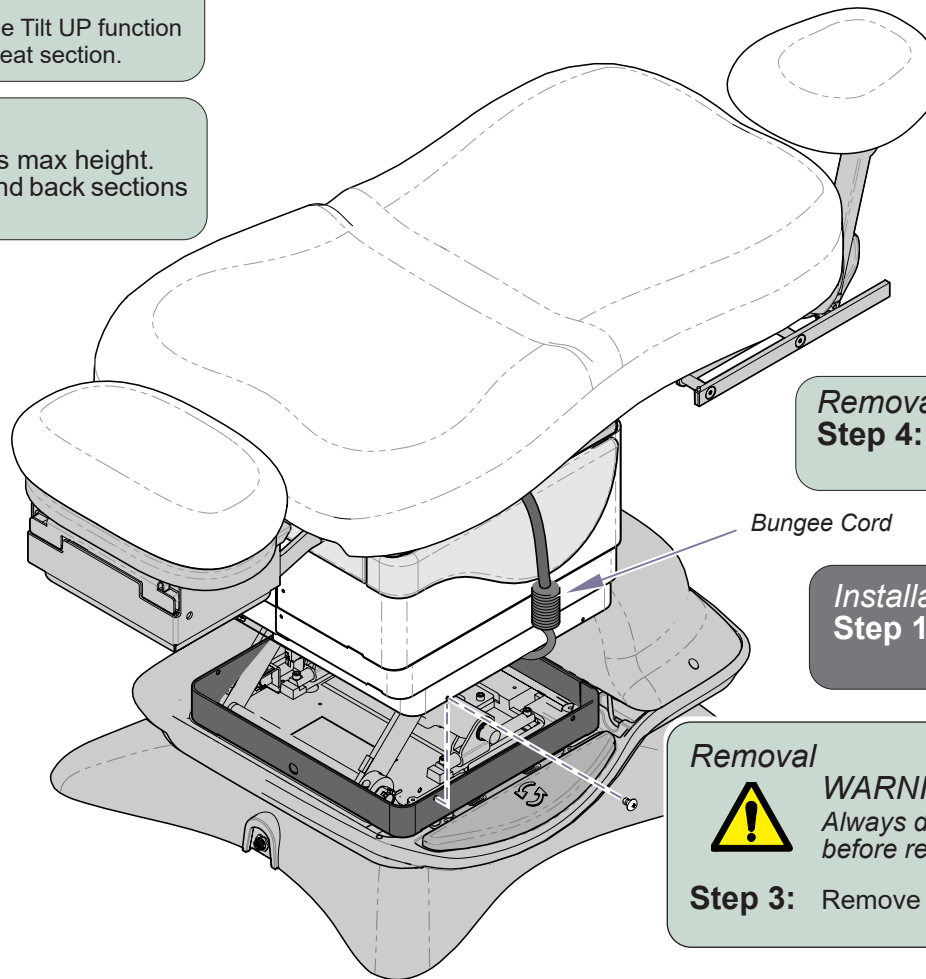

Removal

Step 4: Raise shrouds, then attach bungee cord hooks under shrouds on both sides.

Installation

Step 10: Remove bungee cord. Secure inner shrouds w/screws.

Removal



WARNING

Always disconnect chair power cord before removing any covers or shrouds.

Step 3: Remove bottom screws from inner shrouds.

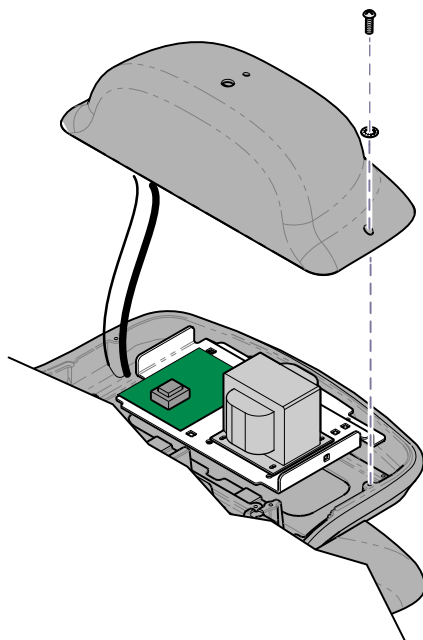

Removal

Step 5: Partially separate PC board cover.

Note: Do not disconnect wire harnesses.

Installation

Step 9: Replace PC board cover.

Installation

Step 7: Install wire harness cover.

Removal

Step 7: Remove wire harness cover.

Removal

Step 6: Remove shroud spacer.

Installation

Step 8: Install shroud spacer.

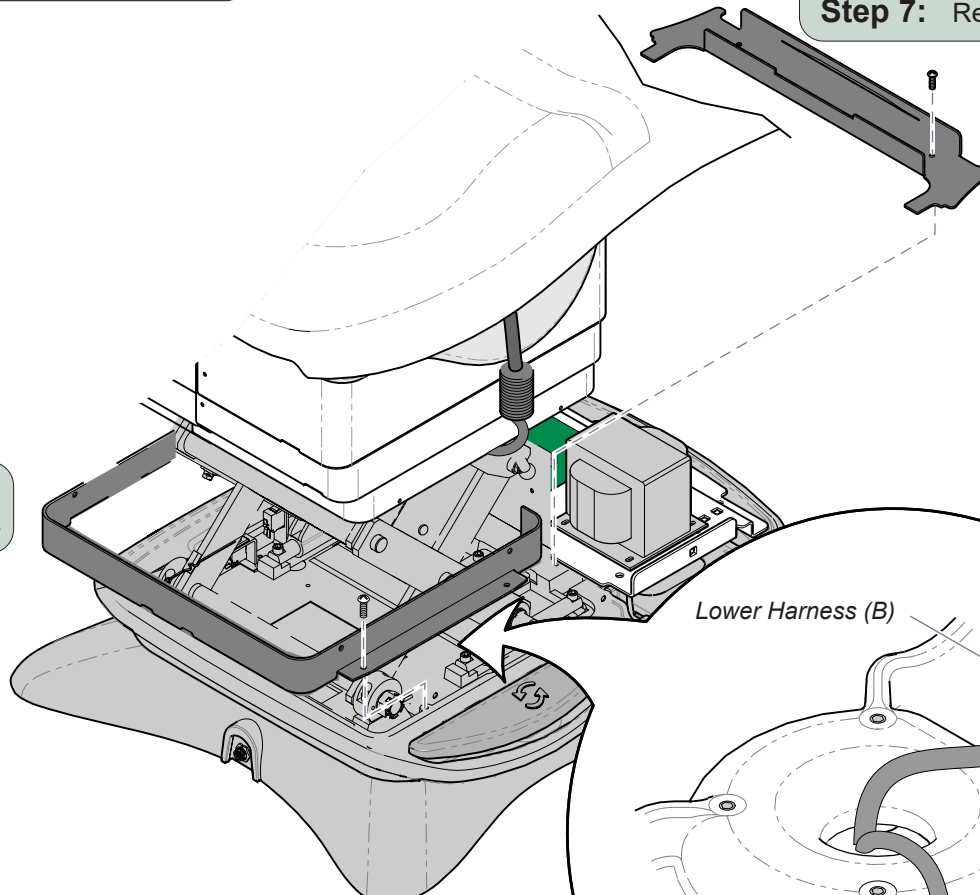

Installation

Step 6: Replace all cable ties.
Connect ground wires for lower harness (A).

Removal

Step 8: Disconnect ground wire for lower harness (A).
Remove cable ties securing lower harnesses (A and B) to base.

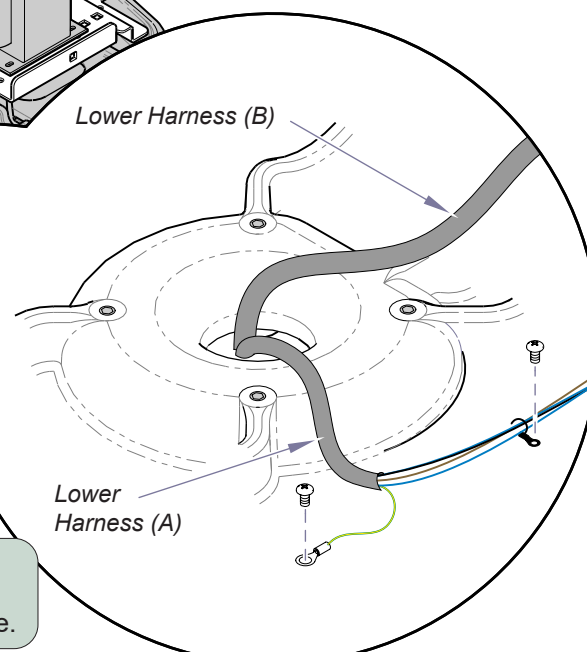

Removal



CAUTION

The chair weighs approx. 540 lb (244 kg).
Use supports designed for this amount of weight.

Step 9: Position sawhorses (or other suitable supports) under back section weldment and foot section weldment.

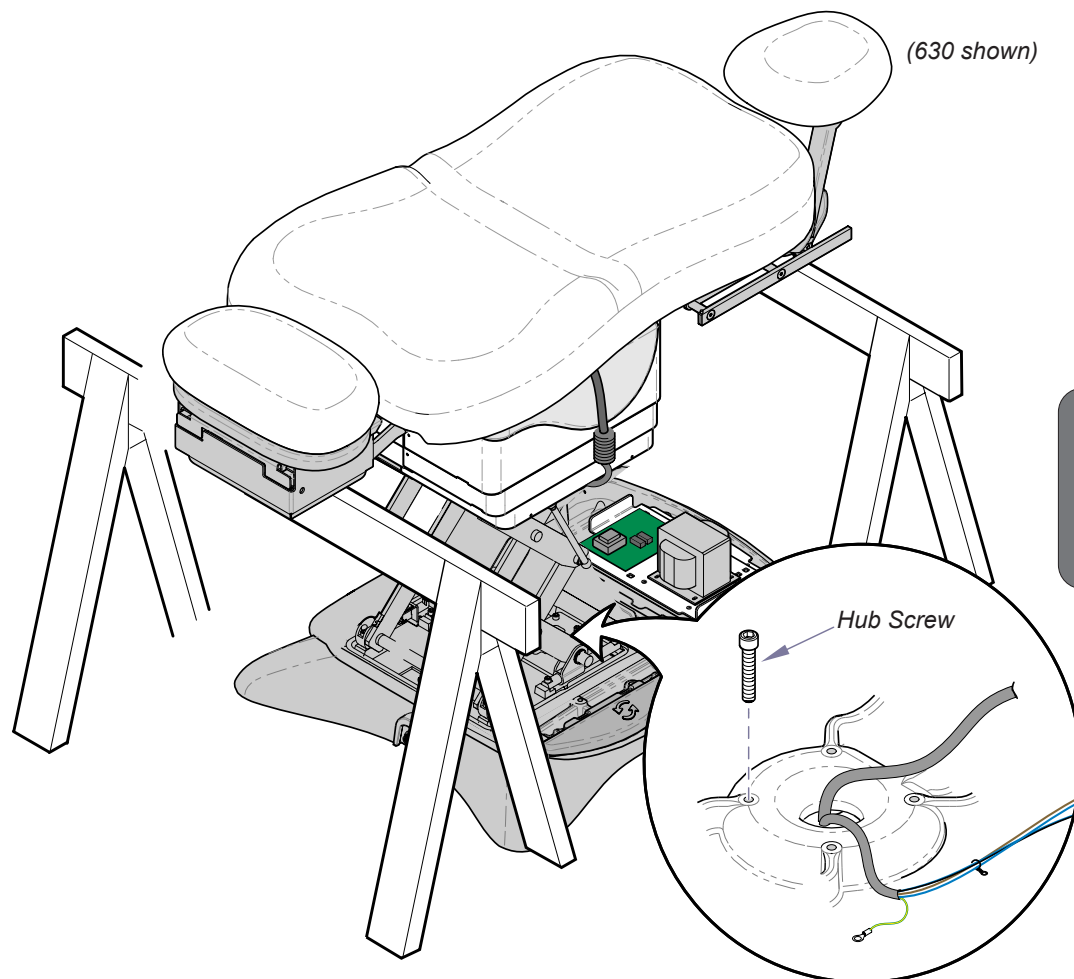

Installation



WARNING

Disconnect the chair power cord before
performing the remaining Installation steps.

Step 5: Install four hub screws.

Removal



CAUTION

The chair top / upper base is not secured
once the hub screws are removed. Hold onto
the chair when performing the following steps.

Step 10: Remove four hub screws.

Removal and Installation WARNING



The Removal and Installation steps on this page require power to be connected to the chair. Avoid all contact with wiring and electrical components.

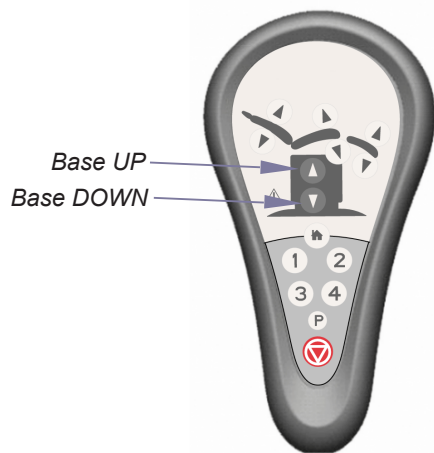

Installation

Step 4: Carefully adjust chair top until alignment studs on bottom of upper casting lock into the notches on the rotation wheel.

Note: You will feel chair top drop into place when alignment studs engage notches.

Removal



Equipment Alert

The two lower wire harnesses are still connected to upper casting. Running the Base Down function too long may result in damage to the chair.

Step 11: Press **Base DOWN** button on hand or foot control until upper and lower base castings separate slightly.

Installation



CAUTION

The chair top / upper base is not secured until the hub screws are installed. Hold onto the chair when performing the following steps.

Step 3: Press **Base UP** button on hand / foot control until chair raises (slightly) off of sawhorses.

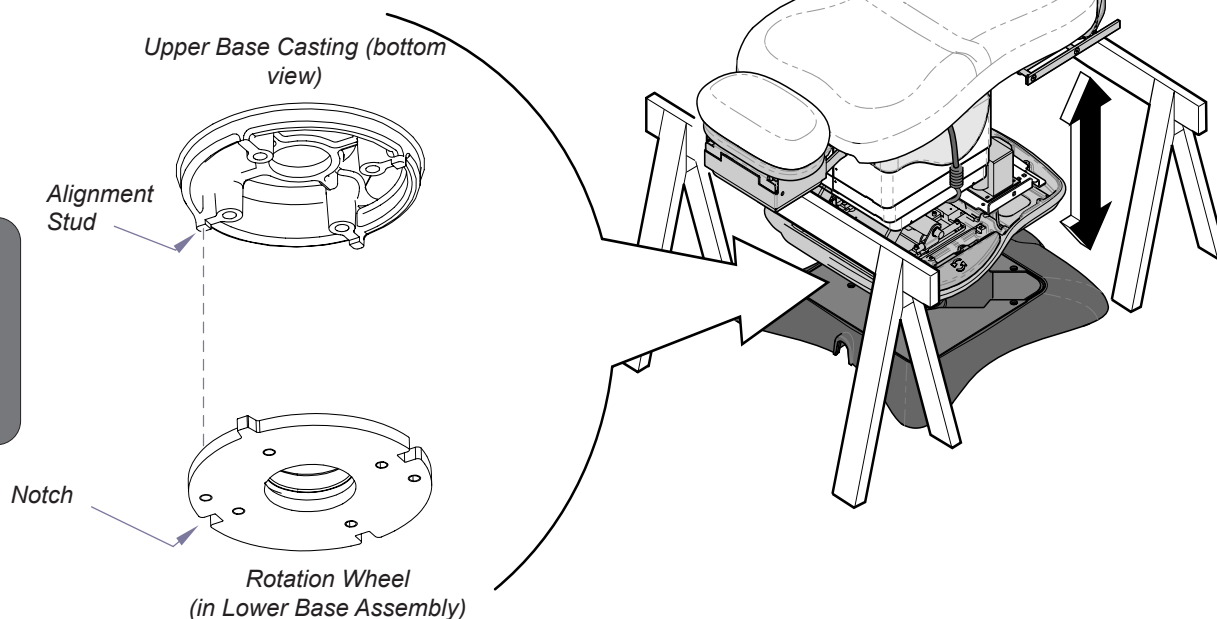

Removal and Installation



WARNING

Disconnect chair power cord before performing any of the Removal / Installation steps on this page.

230 / 630 only

Removal

Step 13: Disconnect wire harness from J9 on main PC board.

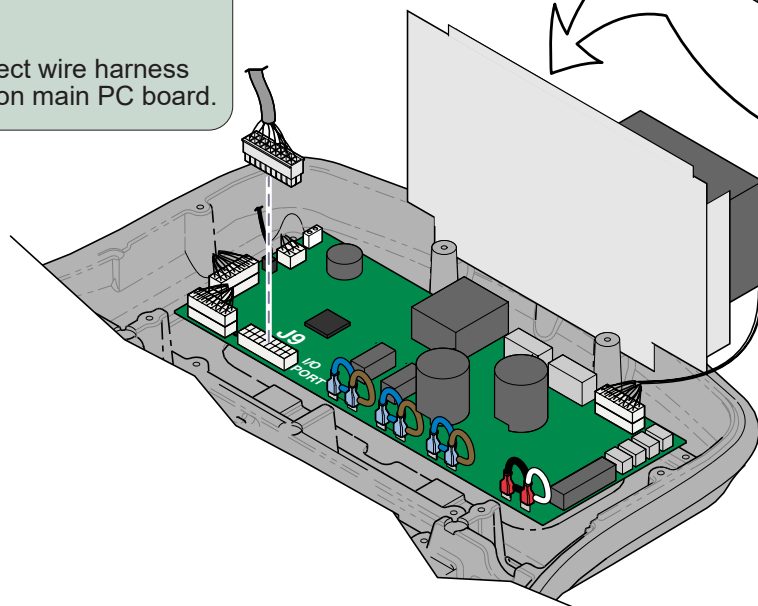

Removal

Step 12: Disconnect wire harness from J2 and J3 on rotational base PC board.

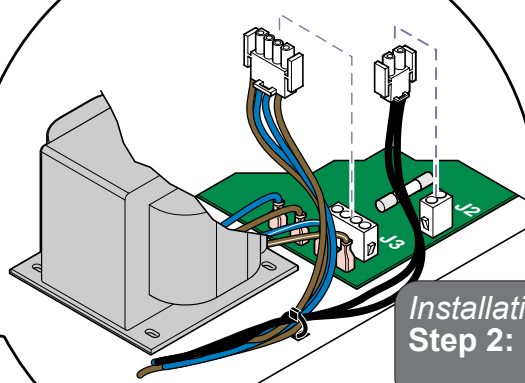

Installation

Step 2: Route wire harnesses thru upper casting. Reconnect all wire harnesses as shown.

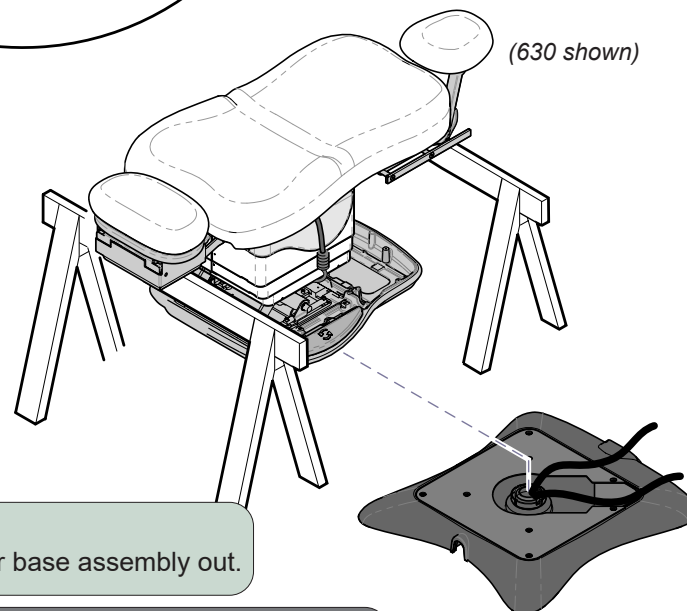

Removal

Step 14: Slide lower base assembly out.

Installation

Step 1: Slide lower base assembly under chair.

Note: To ease installation, align the new lower base assembly in the same position as the old base.