

Wireless Hand / Foot Controls [9A408]

Compatible with models:

641 (all)



Caution

Always disconnect power to chair before removing covers or performing any service procedure.

Components:

Antenna	1	Foot Control	1
PC Board	1	Hand Control	1
Nut	1	Batteries (AA)	4
Wire Harness	1		

Special Tools:

Bungee cord

Step 1: Remove bottom screws from inner shrouds.

Step 2: Stretch bungee cord across top of base column (under seat).

Note: It may be necessary to run Tilt UP function to route bungee cord under seat section.

Step 3: Lift shrouds, then attach bungee cord hooks under shrouds on both sides.

Step 4: Remove two screw(s) and partially separate cover.

Note: You must perform Step 5 before cover can be completely removed.

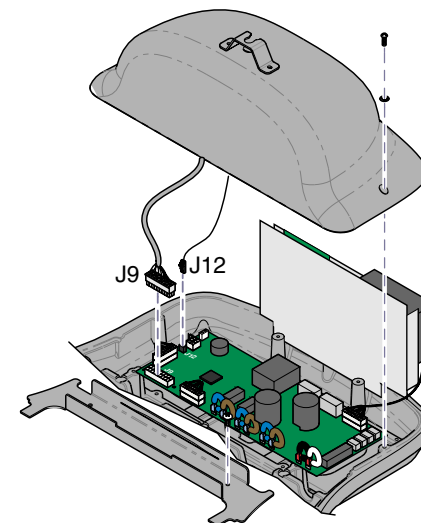
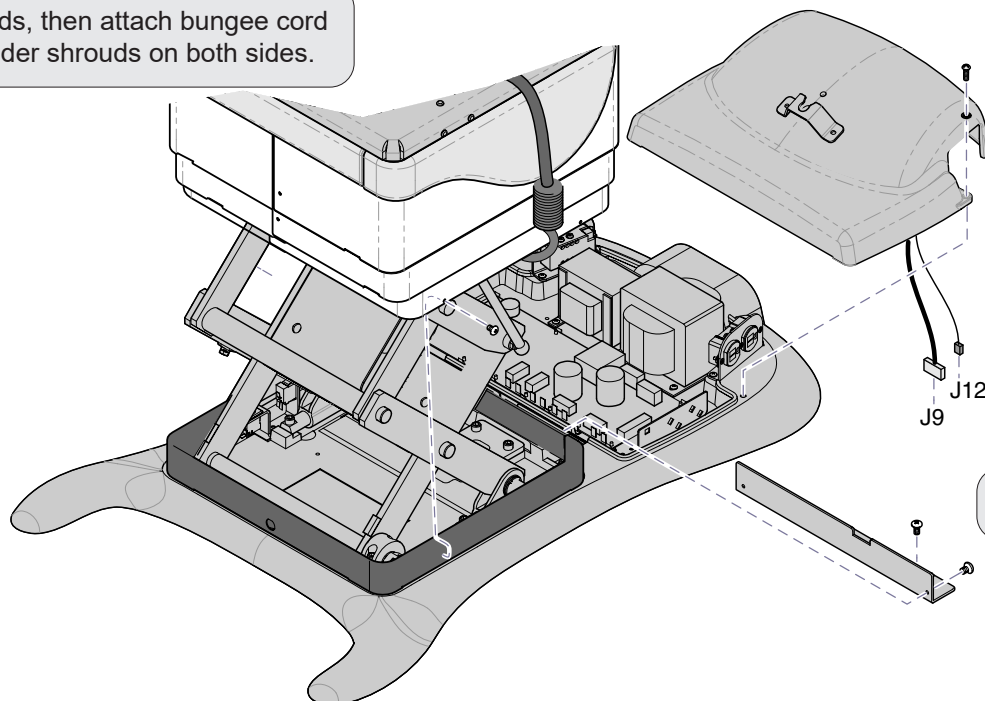

Step 5: Disconnect wire harnesses from J9 and J12 on main PC Board.

Step 6: Remove wire harness cover.

MA768600i

Step 8: Install base station PC board onto standoffs as shown.
Connect antenna to base station PC board.

Note
When power is connected, three LEDs
on the base station PC board will illuminate.



Equipment Alert

Antenna connection is very delicate.
Do not kink wire or apply stress to connection.

Flat Side

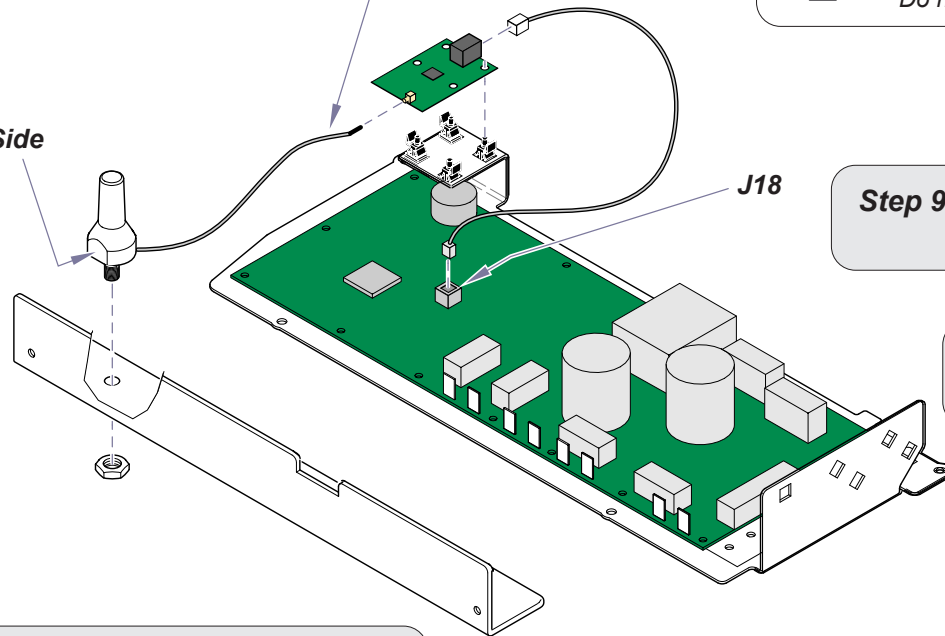

Step 9: Connect harness to base station PC board.
Connect other end of harness to J18 on main PC board.

Step 10: Apply compliance label to
chair shrouds as shown.

Step 7: Secure antenna to wire harness
cover with nut.

Note: Position flat side of antenna as shown.

To complete installation:

- Install batteries in hand / foot controls
- Check for proper operation
- Install wire harness cover
- Install PC board cover
- Lower / secure shrouds

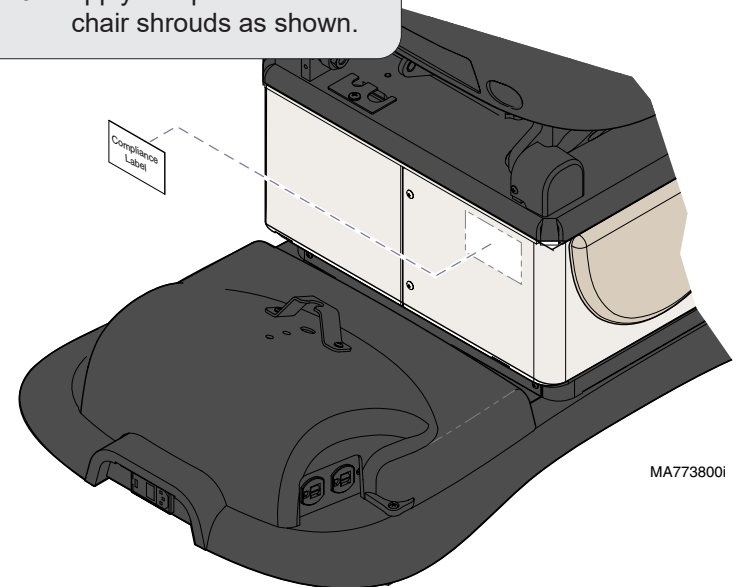

MA773800i