

Front Cover Installation Sheet [002-1082-0x]

Components:
 Front Cover..... 1
 Membrane Switch... 1

Special Tools:
 Magnetic tip Phillips
 screwdriver



WARNING

Power unit off and unplug from outlet to prevent electrical shock.

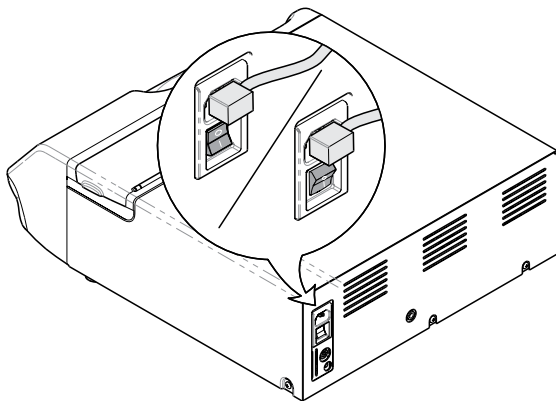

Step 1:

- A) Power unit off by using switch.
- B) Unplug unit from wall outlet.

Step 2:

Remove four screws (two from back and one from each side) and slide cover back and up.

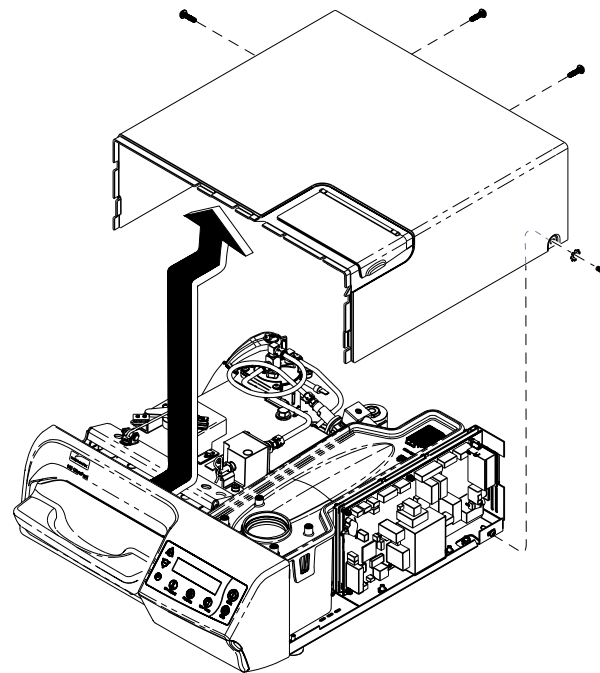

SA1766i



Equipment Alert

Be careful not to loosen or tighten
Limit Switch adjustment screw.

Step 6:
Remove display panel.

Step 4:
Remove two screws
from front cover.

Step 7:
Disconnect harness and pry
bracket to release display
PC Board.

Step 5:
Remove front panel, pry outward on
each side to release snap fittings
and tilt forward.

Step 8:
Remove no access plate.

Step 3:
Remove door / tray
from unit.

Step 9:
Remove access door by depressing
in the middle of door.

Step 10:
Reverse steps for installation.

SA1012011