

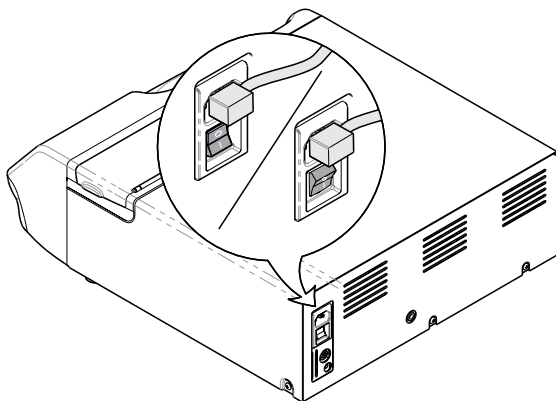

WARNING

Power unit off and unplug from outlet to prevent electrical shock.



Step 1:

- A) Power unit off by using switch.
- B) Unplug unit from wall outlet.

Step 2:

Remove four screws (two from back and one from each side) and slide cover back and up.

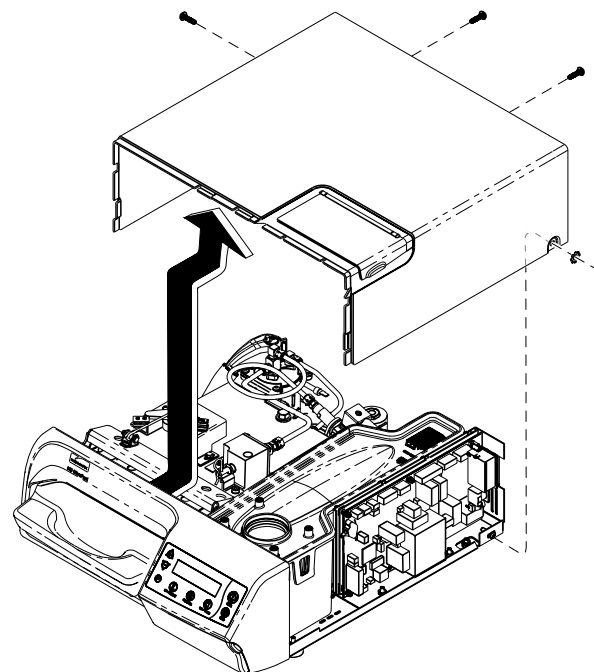

SA1766i

**Equipment Alert**

Be careful not to loosen or tighten
Limit Switch adjustment screw.

Step 8:

Remove display panel membrane
and clean surface.

Step 9:

Remove adhesive backing
and place membrane to
front cover. Follow steps 7
thru 1 in reverse order.

Step 4:

Remove two screws
from front cover.

Step 7:

Disconnect harness
from display PB Board.

Step 5:

Disconnect display harness
from J15 on main PC Board.

Step 6:

Remove front panel, pry outward on
each side to release snap fittings
and tilt forward.

Step 3:

Remove door / tray
from unit.

SA100901i



Because we care.