

Vision Block Screen [9A422]

Contents:
Installation 1

Special Tools:
none

Intended Use:

To provide a visual barrier for the patient during podiatry procedures.

Step 1: Install spline weldments.

- Position LH spline weldment as shown.
- Secure with three hex screws.
- Repeat for RH spline weldment.

Step 2: Install screen assembly.

- Insert screen assembly into spline as shown.
- Press inward until retaining lever snaps into place.

Note: The screen assembly can be installed on either side of the chair.

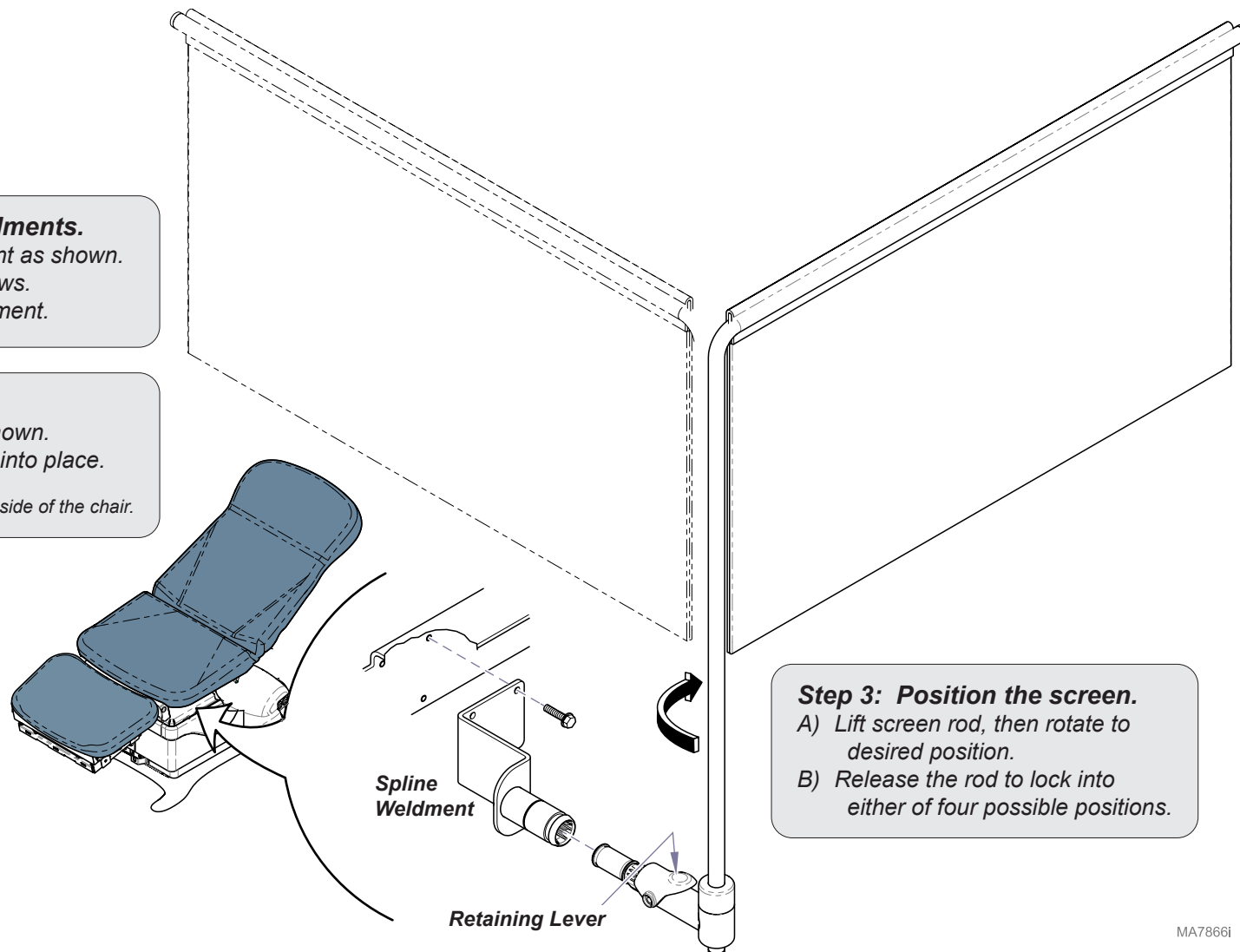

Step 3: Position the screen.

- Lift screen rod, then rotate to desired position.
- Release the rod to lock into either of four possible positions.

MA7866i