

**Components:**

Washer .....	1
Friction Pad .....	2 pcs.
Friction Washer Sleeve .....	1

**WARNING**  
 Disconnect the Power before removing any Flex Arm covers.

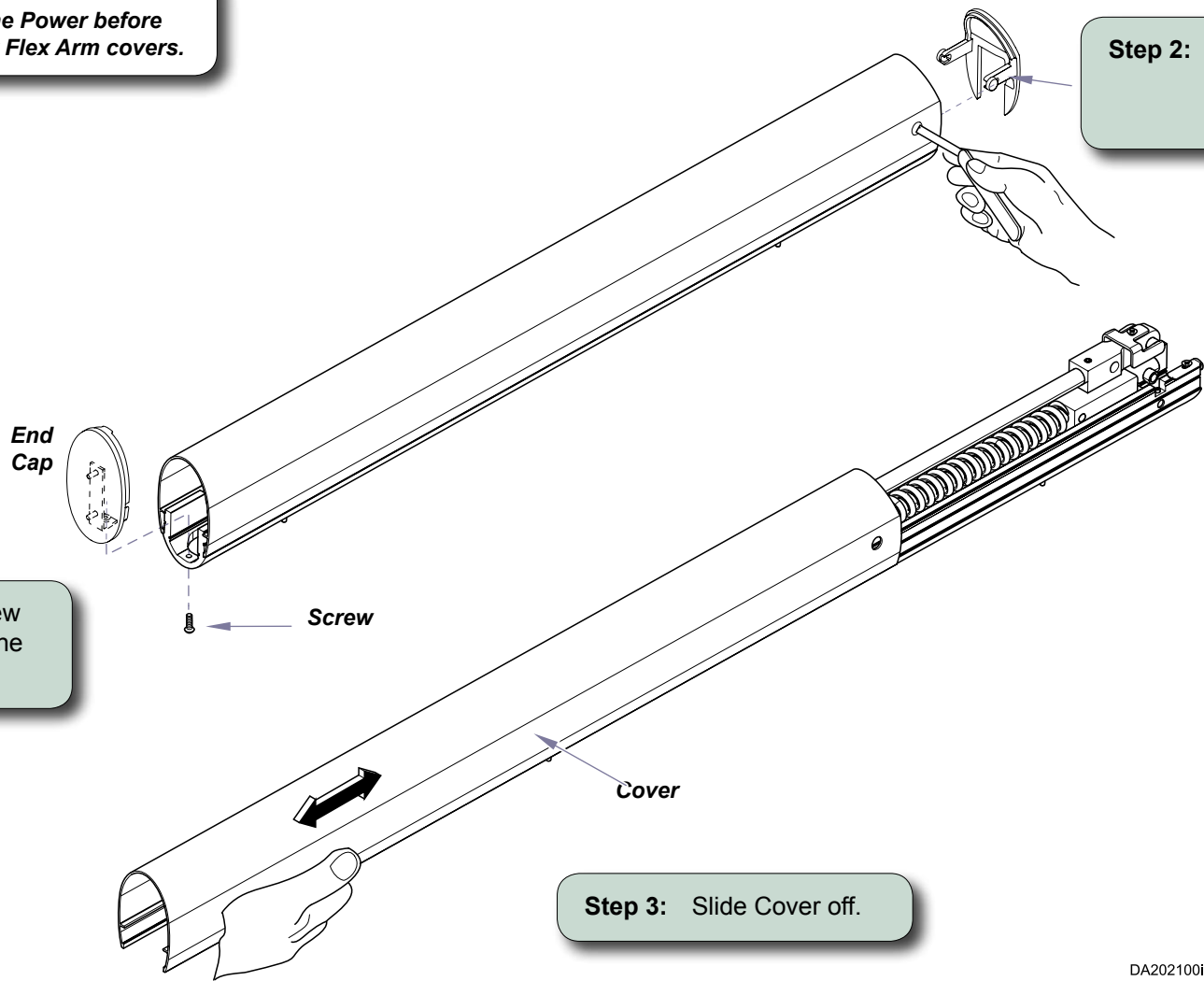

**Step 1:** Remove Screw and take off the End Cap.

**Step 2:** Push in to release clip and slide Cover away from End Cap.

**Step 3:** Slide Cover off.

DA202100i

**Step 8:** Remove and discard the Dowel Pin, Spacers, and Push Nut.

*Note: These parts were present only to provide stability to the assembly during shipping.*

**Step 7:** Remove nut, Washer, Spring Support Washer, Stop and Block from shafts.

**Step 9:** Insert 2 piece Friction Pad into the Friction Washer Sleeve and place them on the shaft against the Spring. Put on Washer.

*Note: Be sure the tapered ends of the Friction Pad fit into the Friction Washer Sleeve facing away from the Washer, towards the Spring.*

**Step 4:** Loosen nut until tension is relieved on the Spring.



**WARNING**  
Do Not Loosen Set Screw if the Spring is under any tension!

**Step 5:** Loosen set screw on end of shaft.

**Step 6:** Remove pin and rotate both shafts upwards to access components.

**Step 10:** Continue to reassemble the components on both shafts following steps 1 thru 7 in reverse.

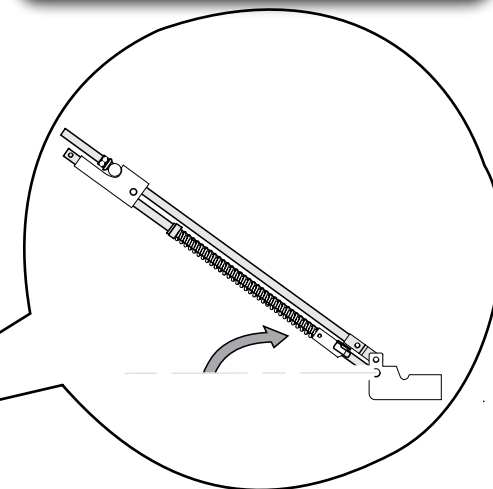
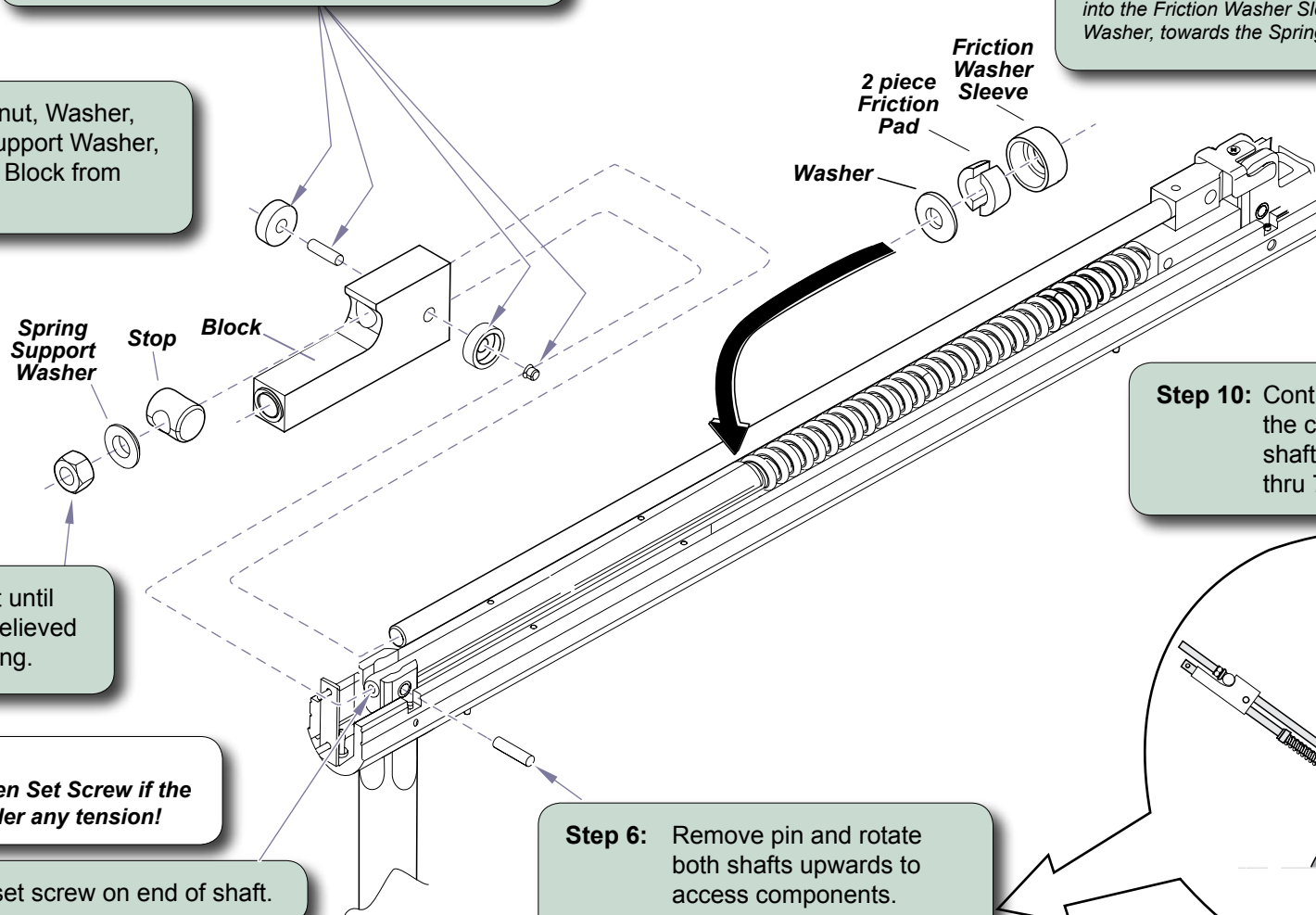

DA2022001