



Freestanding Treatment Console Installation

Applies to Models:

FTC4472

FTC4452

Special Tools:

Level

3/8" masonry drill bit

9/32" wood drill bit

Hammer drill

Note

This Midmark casework unit must be connected to a dedicated circuit rated 20 A, 120 VAC. Failure to comply could result in an overload of the electrical circuit and/or components. All electrical and plumbing connections must be made by a licensed electrician and plumbing contractor following applicable local, city, and national codes.

Midmark casework unit contains four electrical duplex outlets, which are rated at a combined 15 amps. This rating must be taken into account when plugging device(s) into the available outlets.

Note

Inspect all components for shipping damages. A concealed damage report must be filed with the carrier (by the person receiving the goods) within 15 days of delivery.

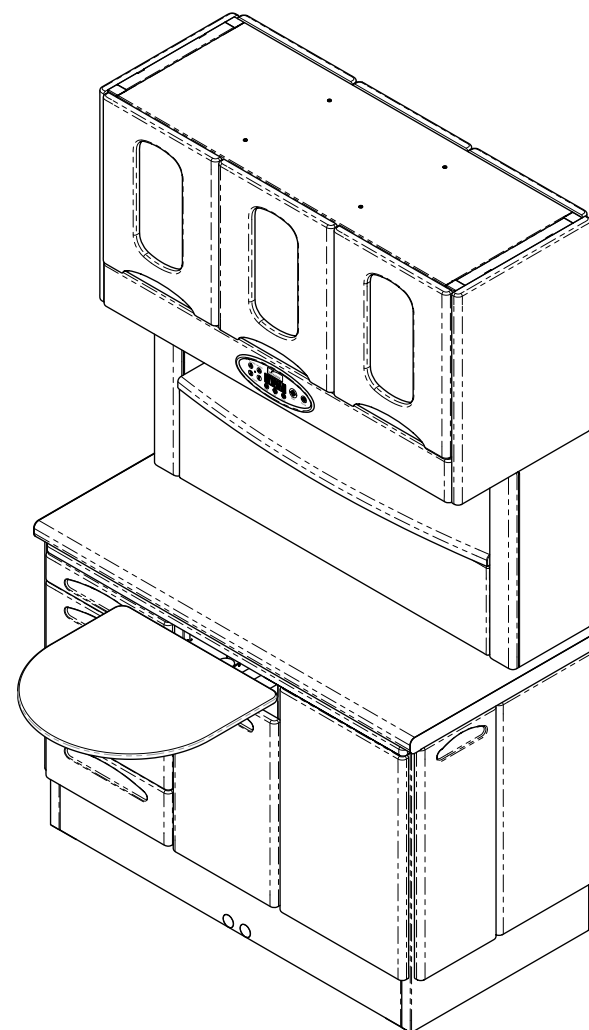

DA2113i

Floor Layout (as applicable)

A. The floor layout.

Note: Full size Floor Template and Wall Template are available upon request, or refer to rough-in dimensions on next page.

B. Have licensed electrical and plumbing contractors position and install electrical outlet receptacles and related plumbing using the pre-installation template or layout.

Note: Be sure floor construction is sufficient to adequately support / anchor the casework unit. If necessary, contact a licensed contractor to reinforce the floor.

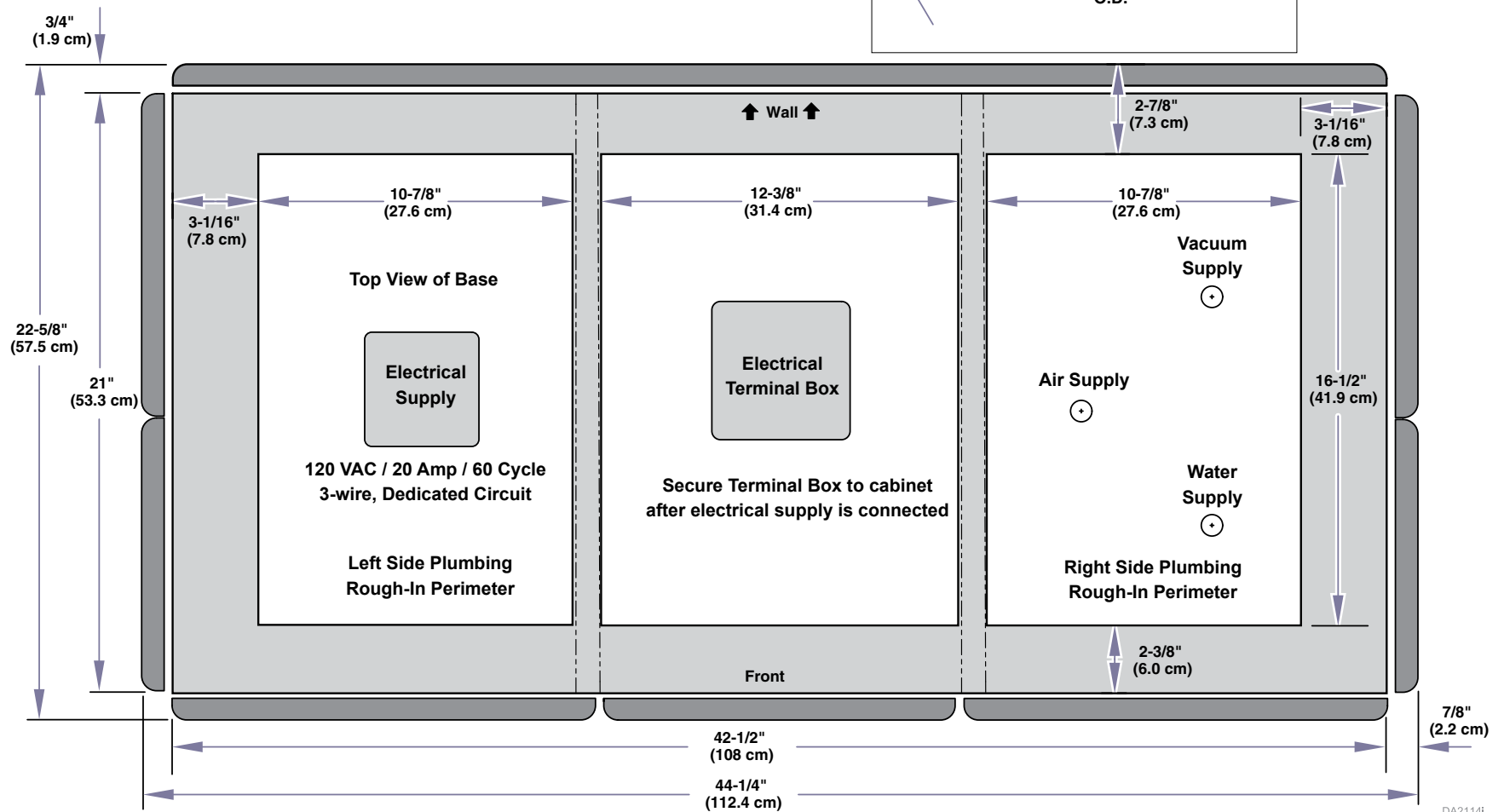

Wall Layout (as applicable)

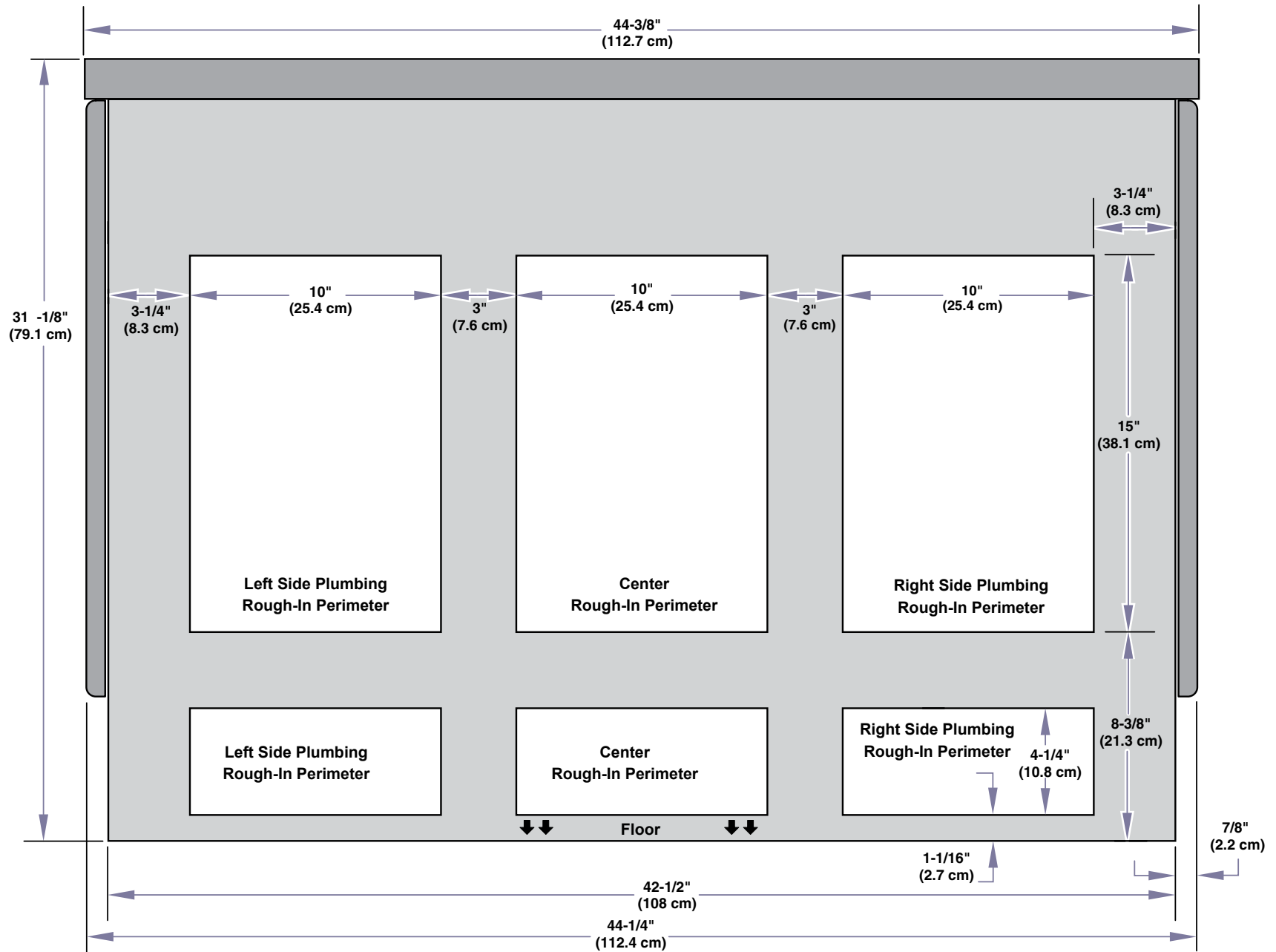

DA22061

Setting Up

Note

If applicable, refer to 2" Drawer Removal on next page as removal is different.

- A. If necessary, remove the drawers by pulling the drawer outward until it meets resistance.
- B. On both sides of drawer, pull outward until locking slots (1) on drawer are free of tabs (2) on drawer glides (3).
- C. Lift drawer upward (4) while pulling outward to free rear of drawer from hooks (5) on glide.
- D. On base sections that have doors, open door and remove bottom shelf.

Note

When reinstalling drawers assure back of drawer is positioned beneath hooks (4) on glides and tabs (2) on glide snap into locking slots (1) on drawer.

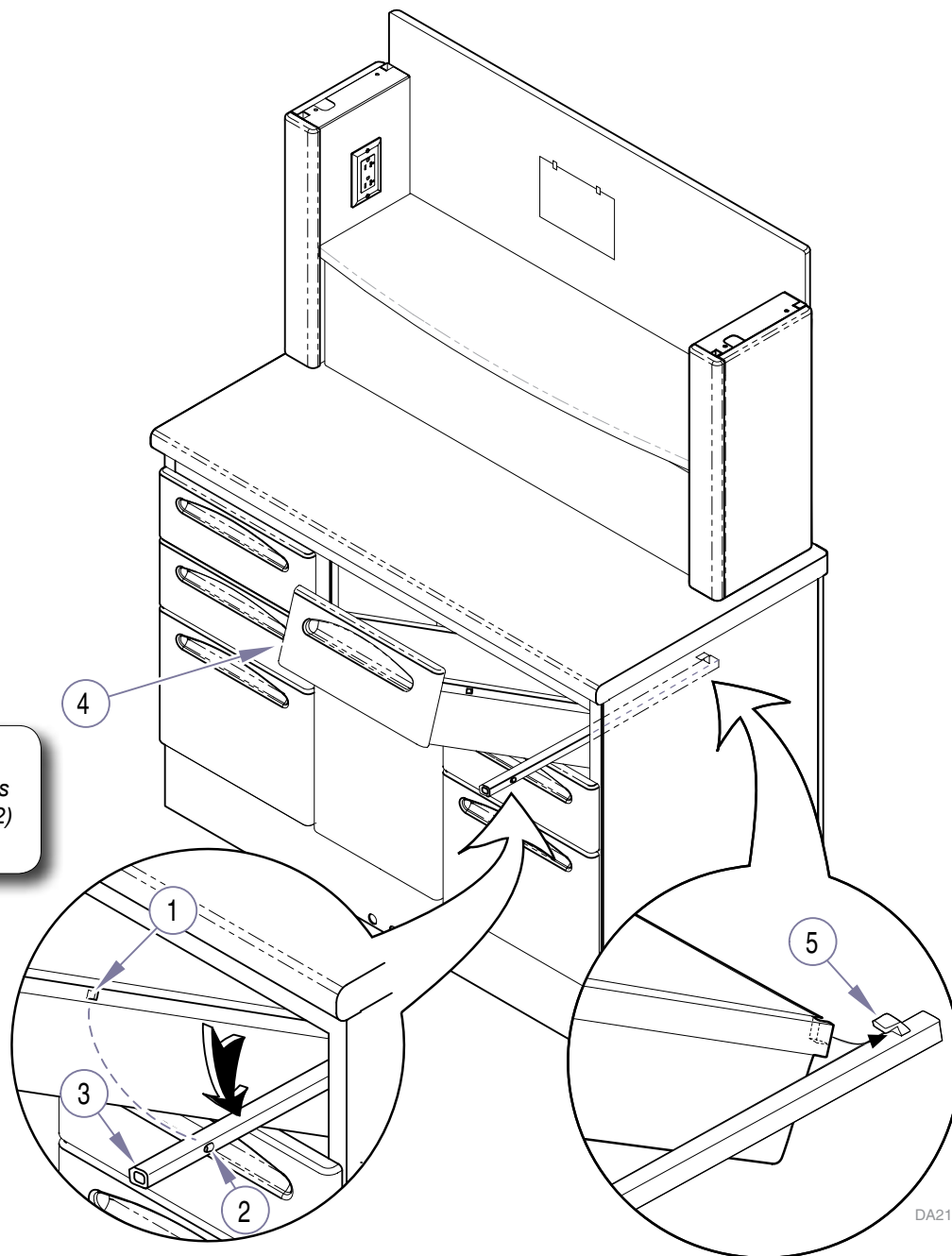

DA2116i

Removing the 2" (5 cm) Drawer:

To remove drawer and front slide...

- A. While lifting or pushing down release levers (on each side), slide rail and drawer from slide.

To remove drawer tray and front...

- B. Remove four screws, then slide drawer tray and front from channel.

To remove slides...

- C. Remove four screws, then remove slides.

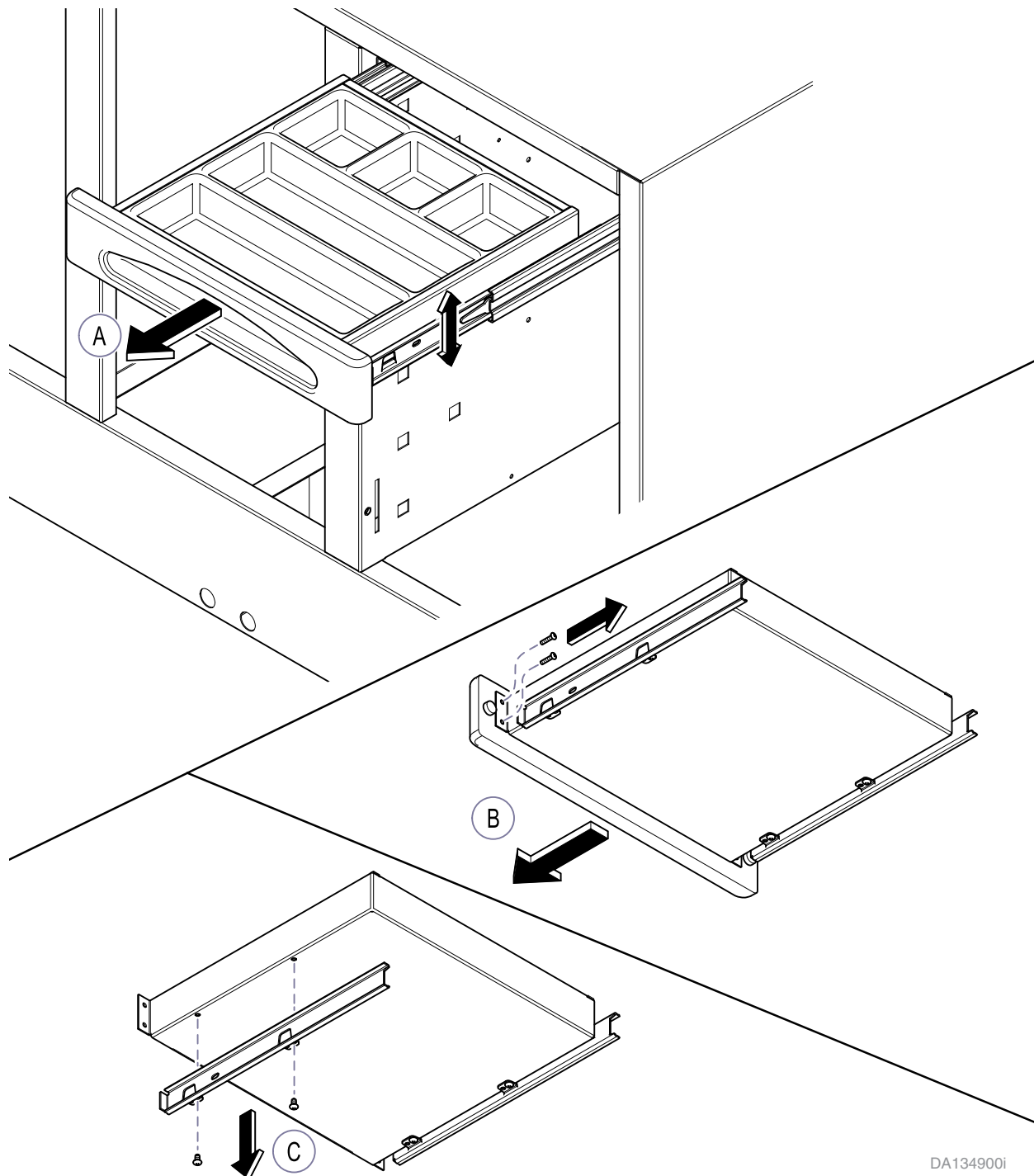

DA134900i

Side Storage Unit

Note

You must remove the bottom panel, to install the anchor mounting clips.

A. Open the doors and lift out the bottom panel.

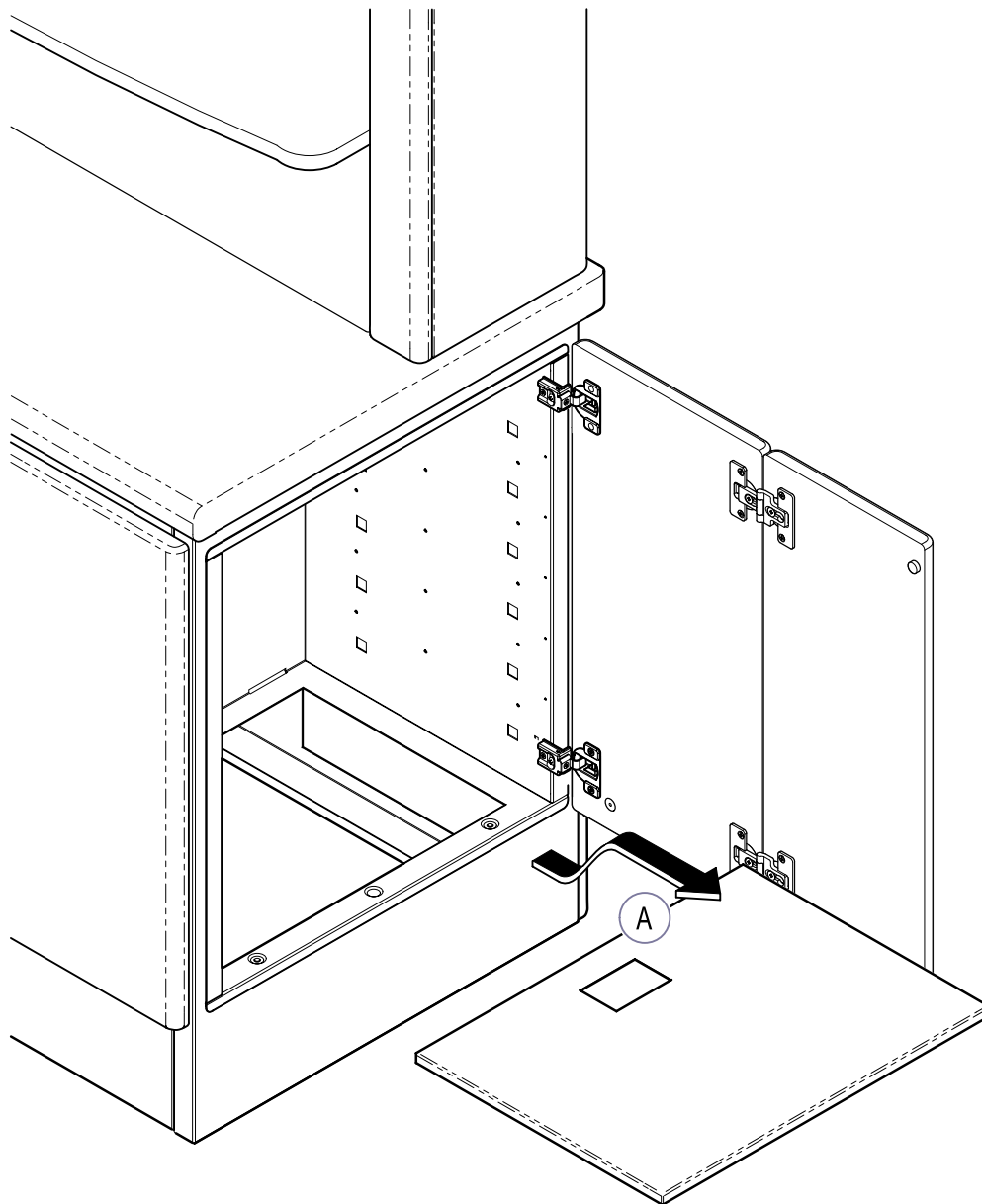

DA2128i

Locating Anchor Mounting Clips

- A. Place the anchor mounting clips within 4" (10 cm) of each corner. Be sure clips do not interfere with the leveling bolts. [suggested locations of the four mounting clips].

Note

The hold-down bolts for the anchors should be placed as close as possible to the sub-base lip.

- B. Using the anchor mounting clips as templates, place location marks for the hold-down bolts on the floor.

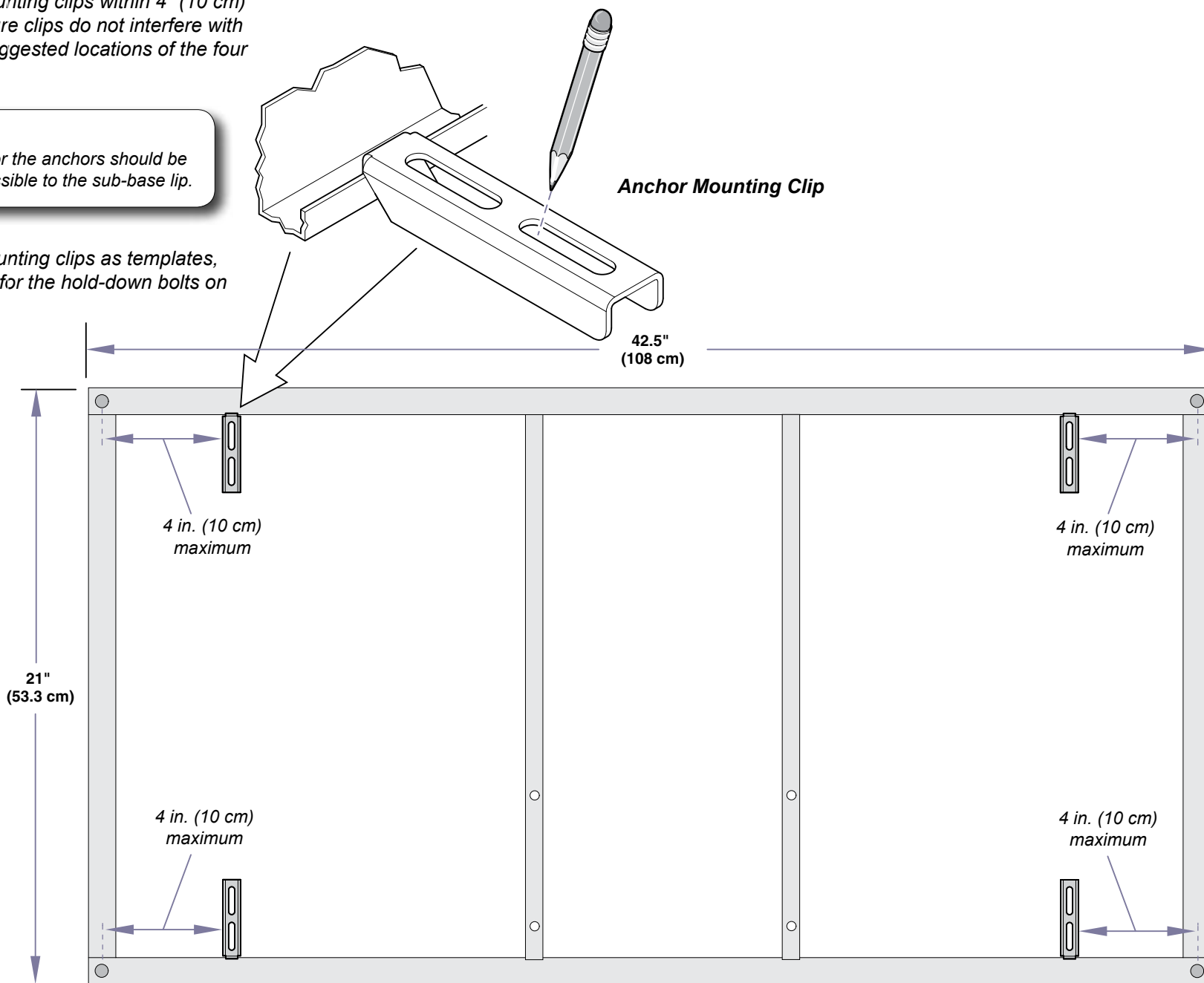

Installing Anchor Mounting Clips & Leveling

- Using the appropriate drill bit (masonry: 3/8") (wood: 9/32"), drill holes at each location per specification.
- Loosely install the anchor mounting clips.
- Using a 1/4" socket, adjust leveling screws in each corner until cabinet is level.

Note

To prevent instability, do not adjust leveling screws more than 1/2" (1.3 cm).

- Insert shims beneath area of anchor and tighten each bolt.
- Trim any excess shim material that may protrude beyond base.

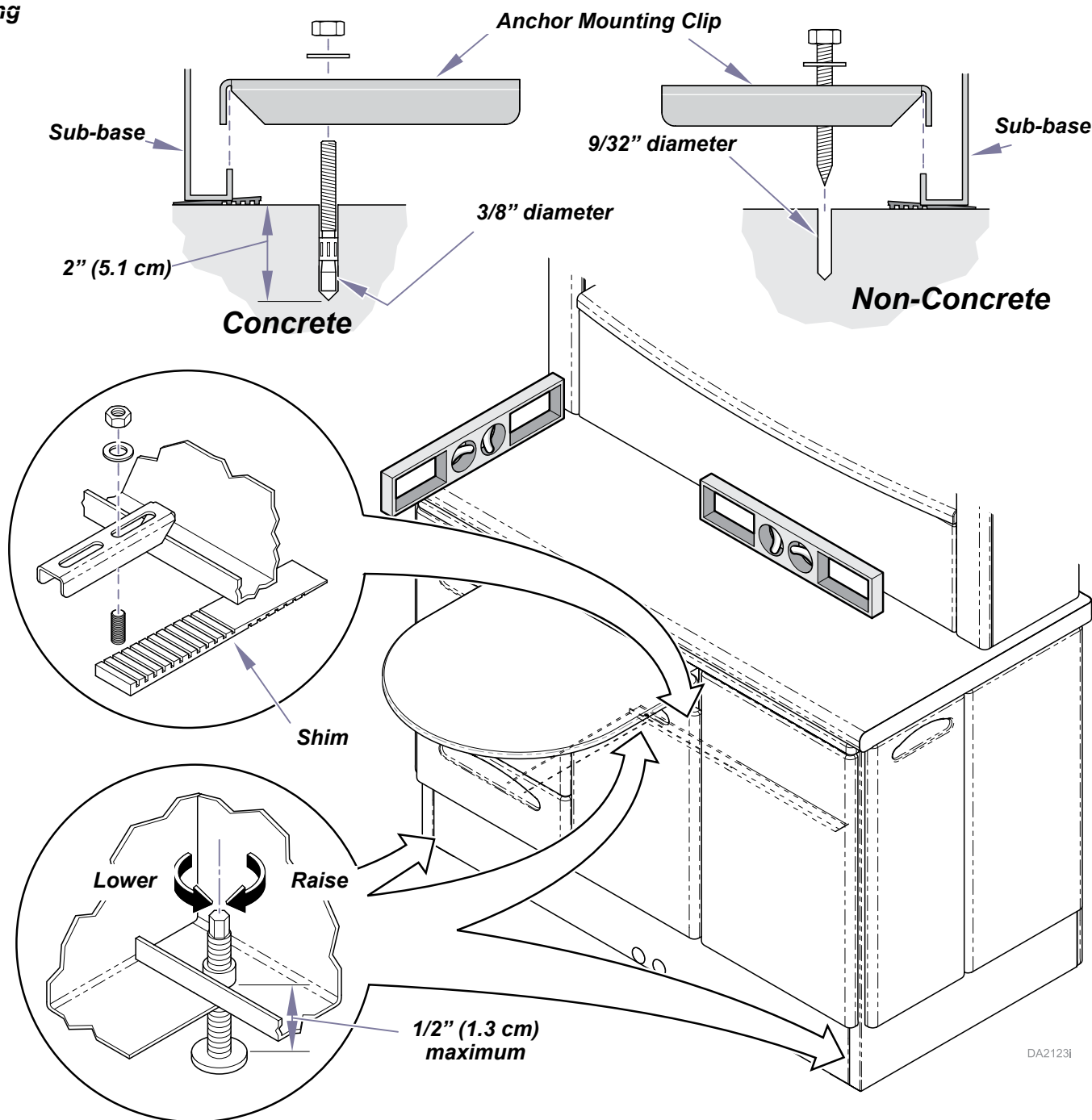

DA2123i

Securing Electrical Box

- A. Secure the electrical box to the inside of the cabinet base with (#10 x 3/8") screws.

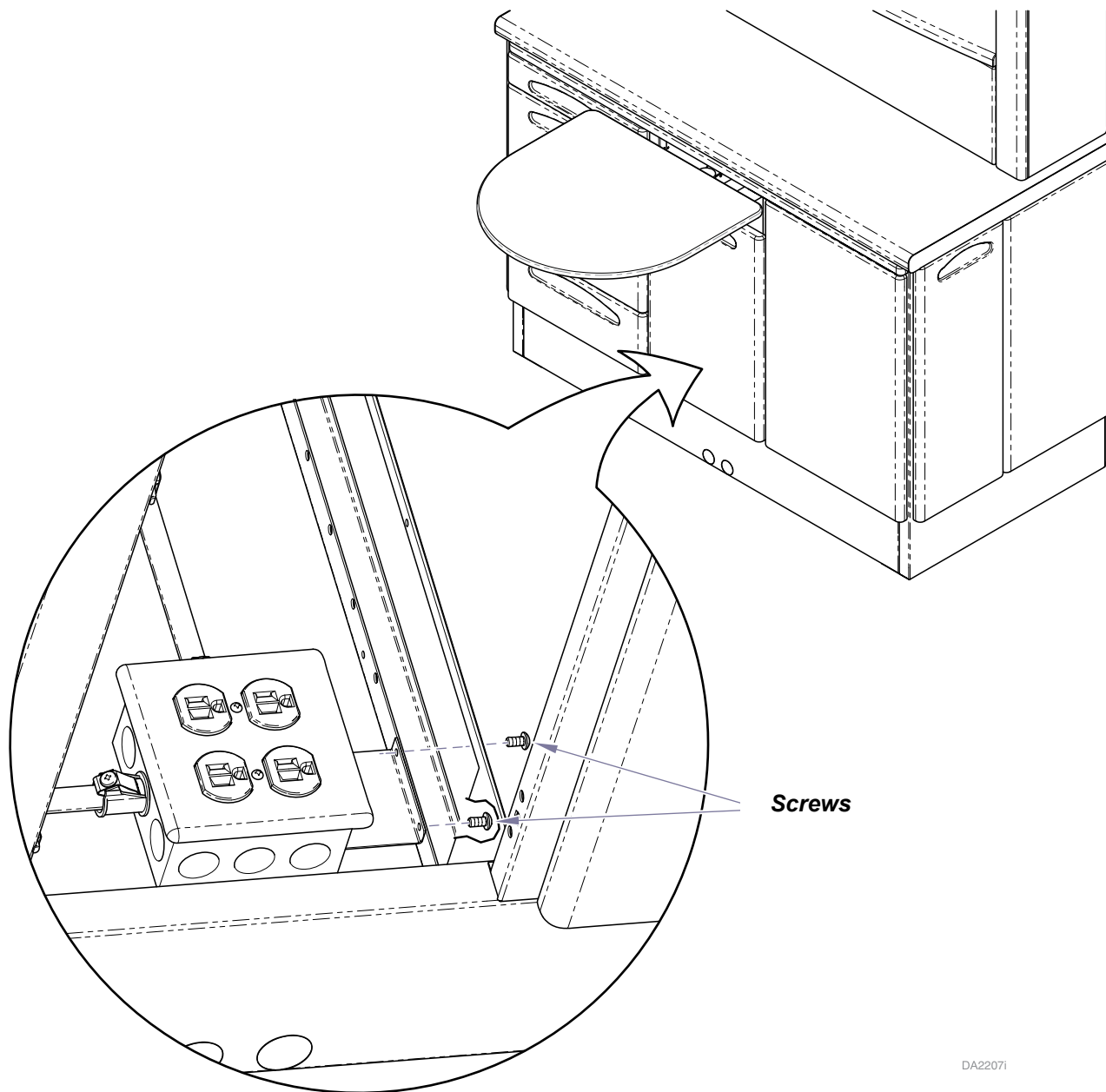

DA2207i

Installing Overhead Section (if required)

A. Remove side panels and receptacle enclosure covers.

B. Position overhead section on top of midsection.
Be sure to align mounting holes.

C. Connect the plugs from the overhead section
and midsection.

D. Secure overhead section to midsection with
six 10-24 x 5/8" screws.

E. Install the receptacle enclosure and side panels.



Equipment Alert

The particle board screws
must be installed for stability.

F. Remove task light cover to access holes in upper
unit by taking out thumb screws.

G. Install particle board screws.

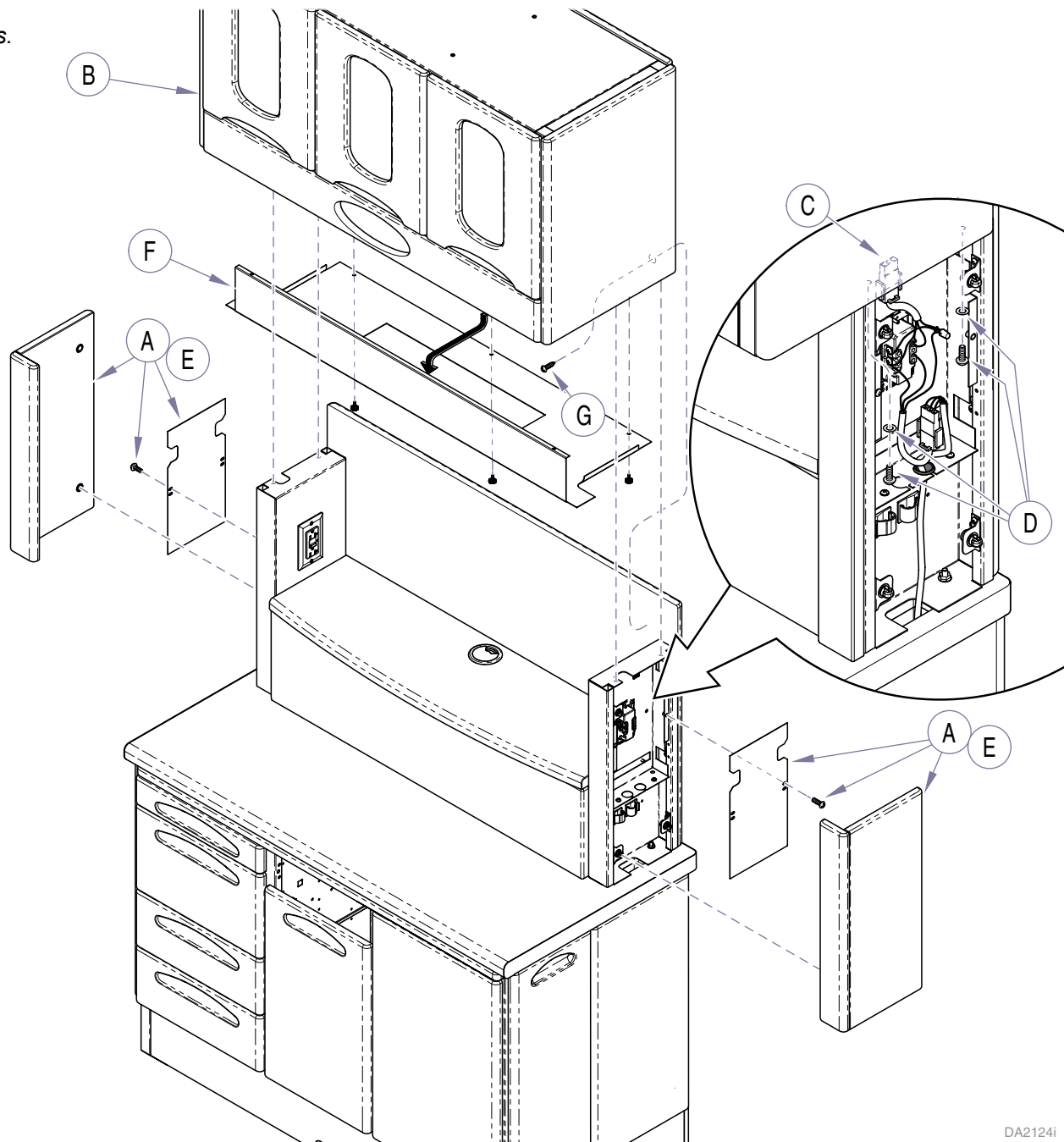

Installing Clock / Timer

- A. Remove clock / timer from box located in cabinet and push clock / timer into opening.

Installation of Power Supply for Clock / Timer (if required)

- B. Plug power supply to electrical outlet.
- C. Install grommet into upper cabinet.
- D. Route power supply wire through cabinet.
- E. If necessary, install grommet into task light cover.
- F. Plug power supply cord into the back of the clock / timer.

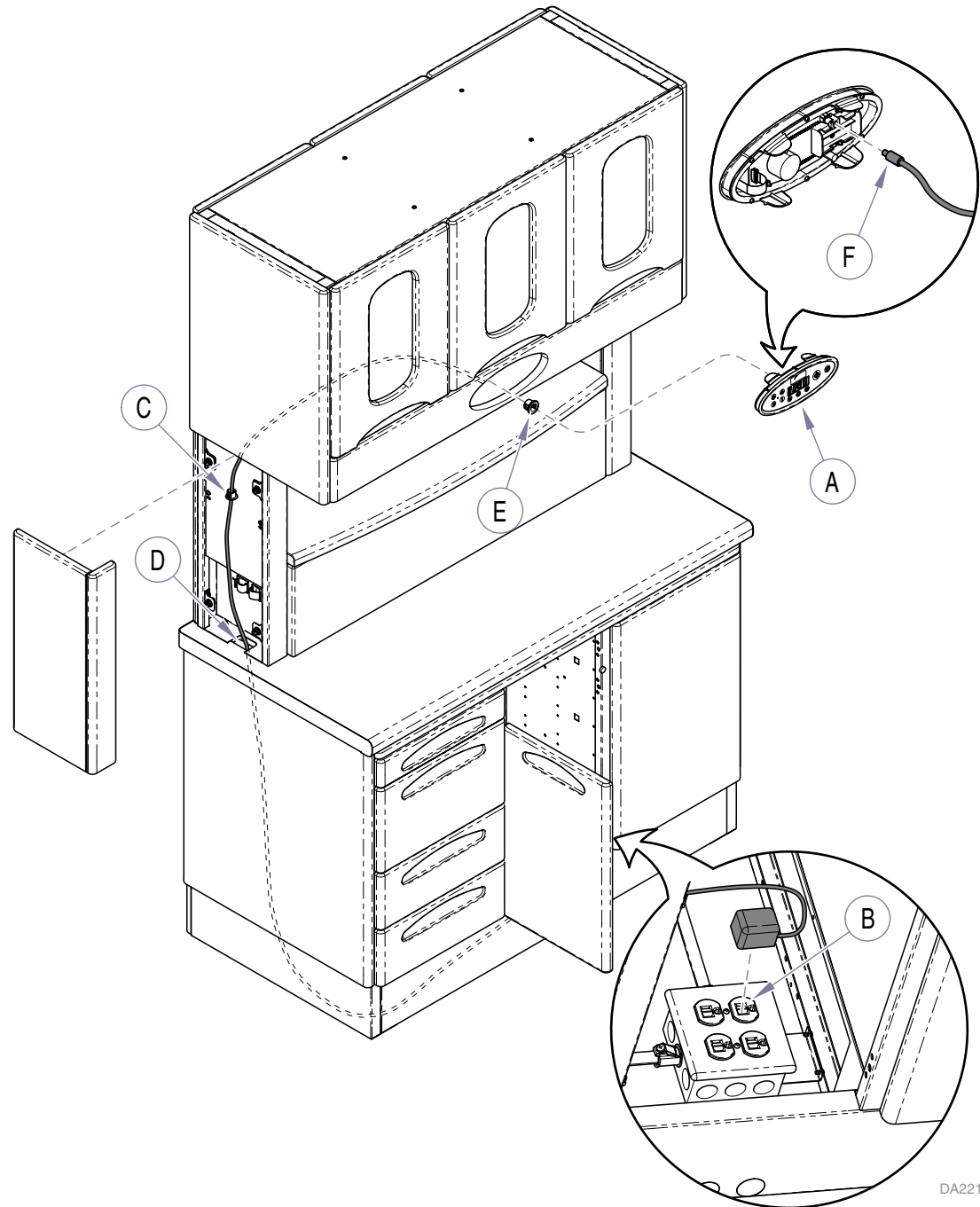

DA2215i

Removal of Accessory Panel

- A. Remove side panels and then pull out on accessory panel.

Relocating Pull-out Shelf and Swing-out Shelf or Tub

- B. Remove six screws from shelf slides and relocate pull-out shelf in desired position.
- C. Loosen screws so the shelf or tub is loose.
- D. Move shelf forward to remove. Remove screw, then re-install at desired location (do not tighten). Position shelf, then tighten screw.

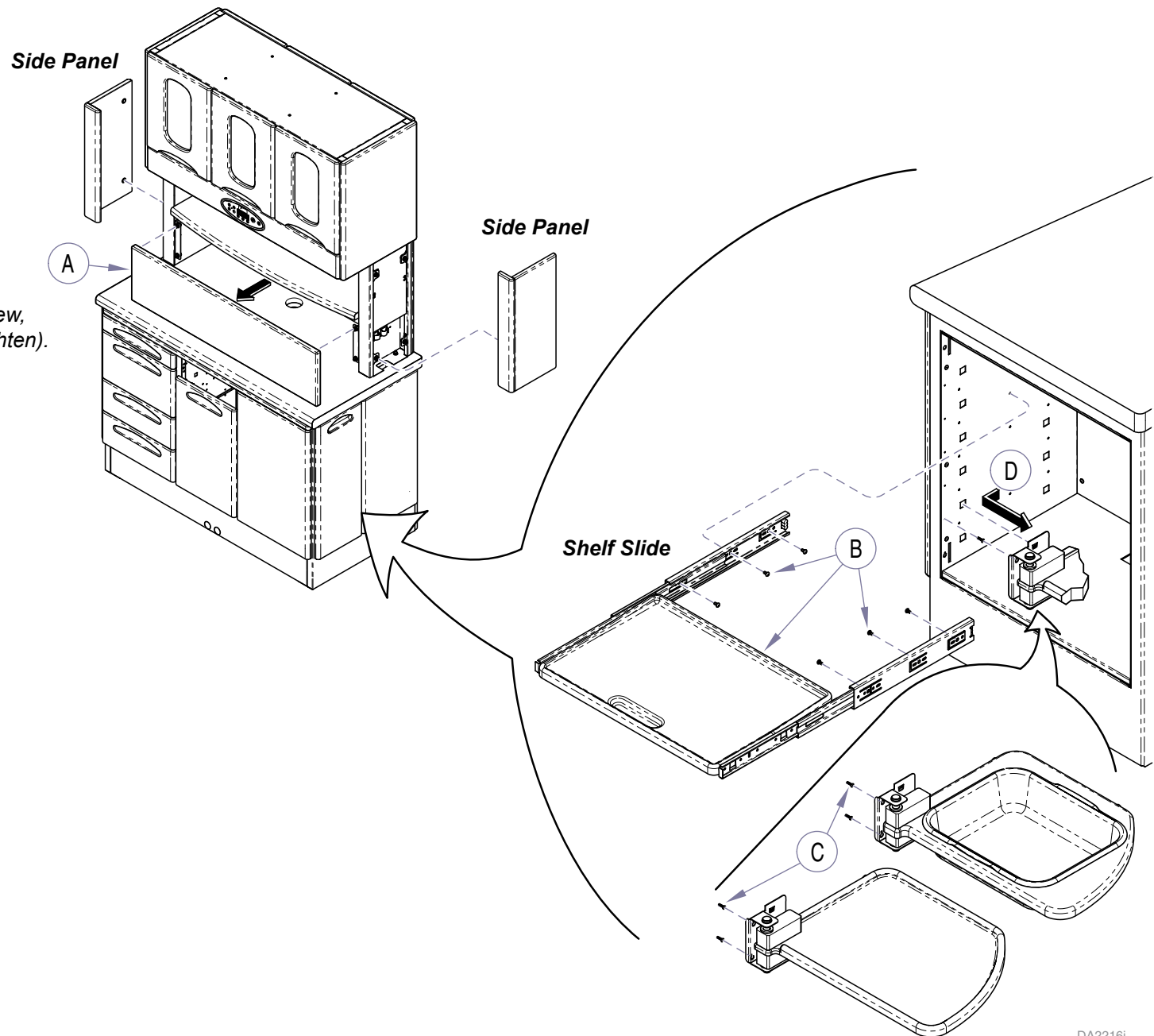

DA2216i

Installing and Adjusting Doors / Panels / Shelves

- A. Check doors for proper adjustment. [Gap between doors should be approximately 1/16" (0.16 cm)].

Note

Refer to **Hinge Adjustments** for proper adjustment procedures.

- B. Install shelf brackets at desired height of shelf.

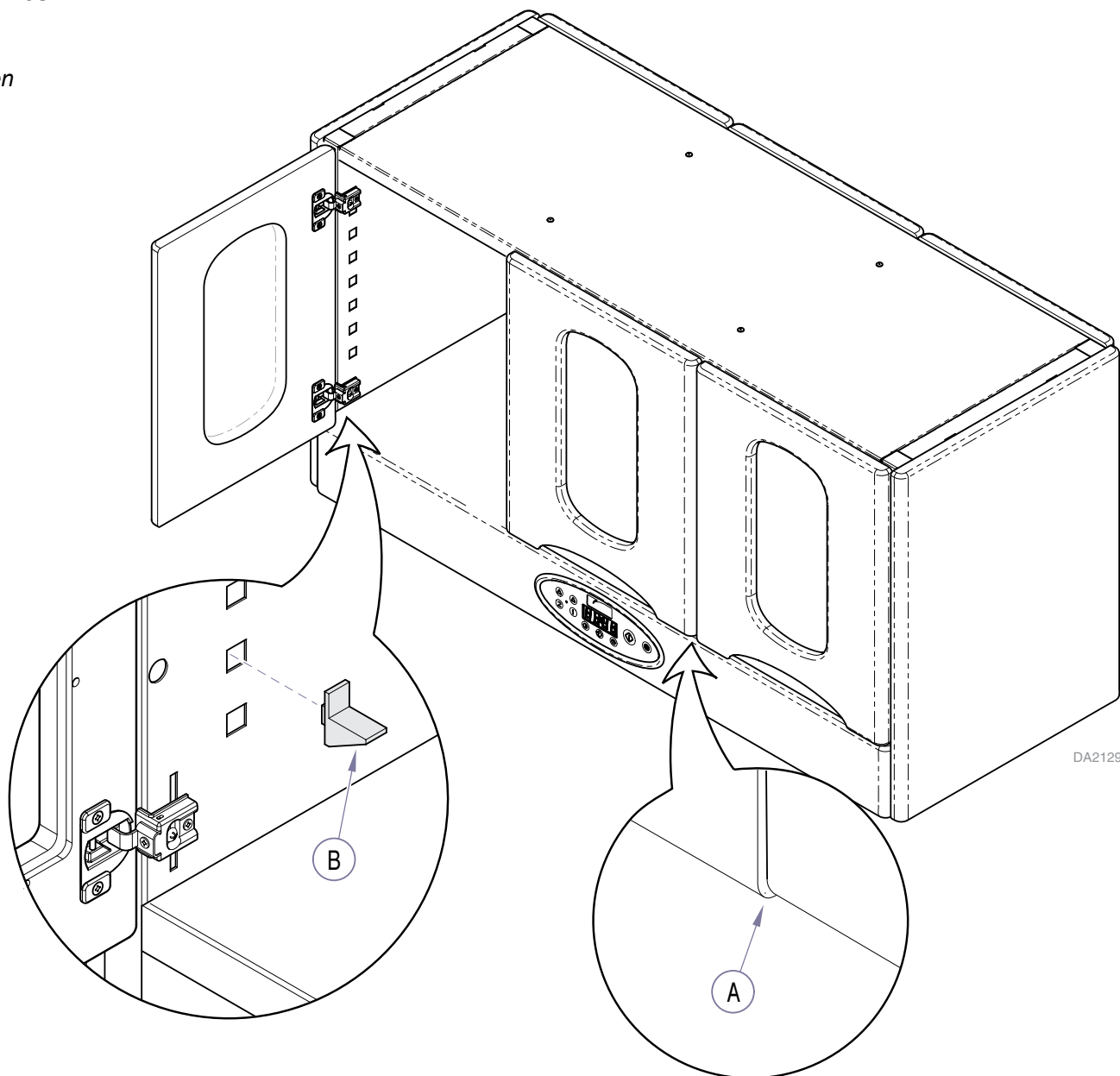

Hinge Adjustments

A. Side Adjustment

Turn screw (A) until door is in desired position.

B. Height Adjustment

Loosen screw (B) approximately 1/4 turn, reposition door, then tighten screw.

C. Depth Adjustment

Loosen screw (C), reposition door, then tighten screw.

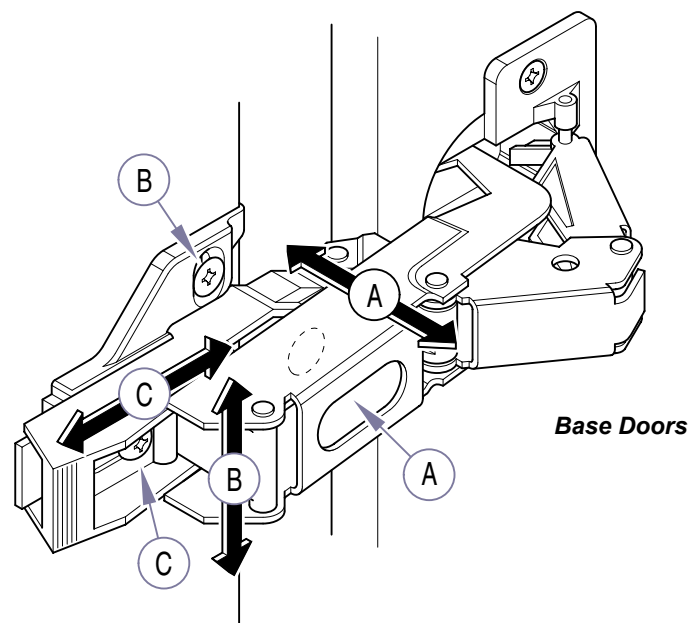
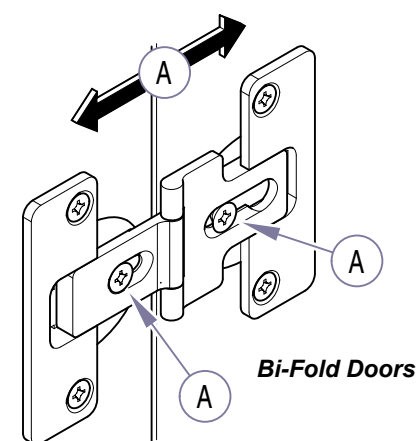
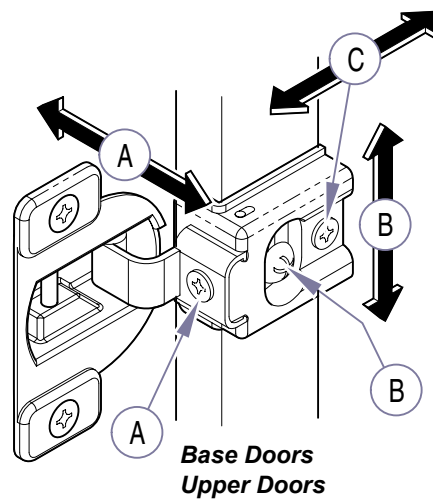

Figure 12

DA2125i

Freestanding Treatment Console (FTC-4472)



Equipment Alert

Dedicated branch circuit rated at 120VAC, 50/60 Hz, 20 amp.

Note

Only Licensed Electricians following local and applicable electrical codes should install and connect the electrical supply power. Midmark cannot be held responsible for installations that do not conform to local codes.

Optional Task Light

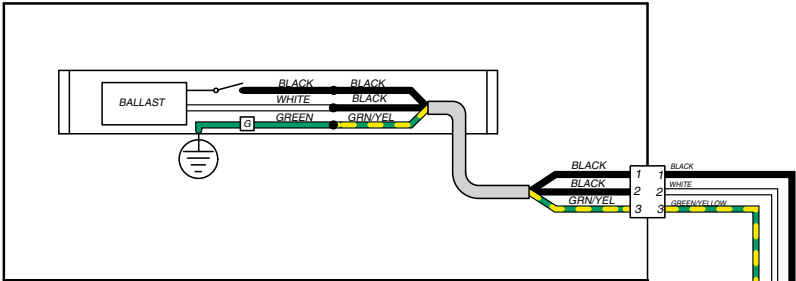

Mid Section of 12:00 Unit

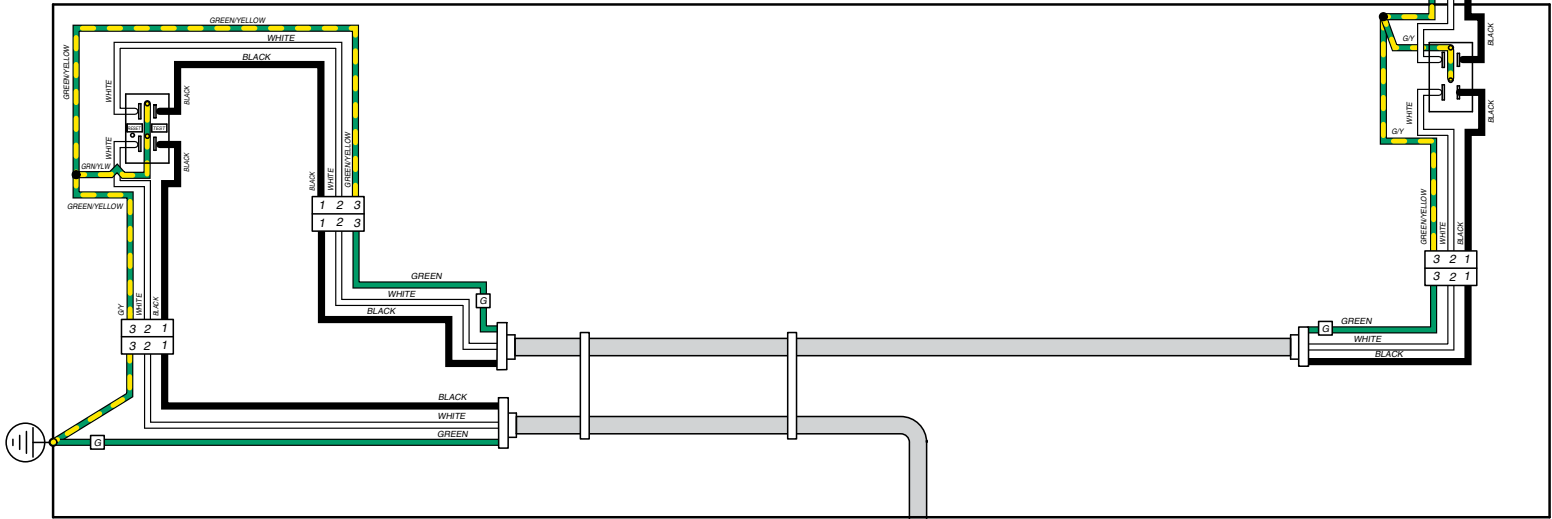

User Electrical Connections

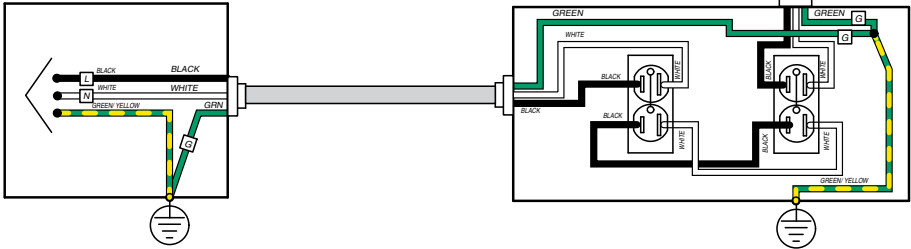

Freestanding Treatment Console (FTC-4452)



Equipment Alert

Dedicated branch circuit rated at 120VAC, 50/60 Hz, 20 amp.

Note

Only Licensed Electricians following local and applicable electrical codes should install and connect the electrical supply power. Midmark cannot be held responsible for installations that do not conform to local codes.

