

Wireless Foot Control Installation [9A418]

Compatible with models:
647 (all)

Components:

Antenna	1
PC Board	2
Nut	1
Wire Harness	1
Foot Control	1
Batteries (AA)	2



Caution

Always disconnect power to chair before removing covers or performing any service procedures.

Step 1: Raise base shrouds.

- Remove bottom screws from inner shrouds.
- Stretch bungee cord across base column.
- Lift shrouds, then attach bungee cord hooks under shrouds on both sides.

Step 2: Remove PC board cover.

- Remove two screws, then **partially** separate cover.
- Disconnect wire harness from J12 on PC board.
- Remove PC board cover.

(Rotational Base)

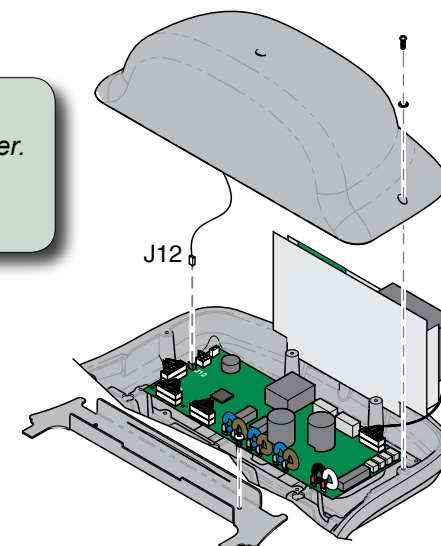

(Standard Base)

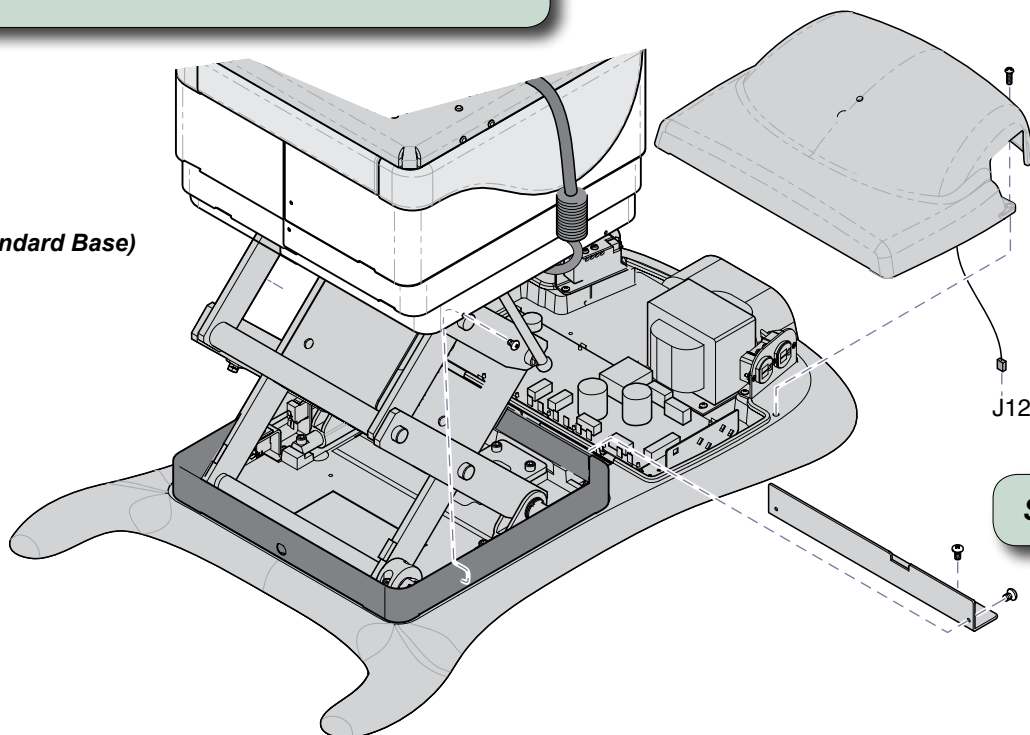

Step 3: Remove wire harness cover.

MA7941i

Step 4: Install antenna.

- A) Insert antenna thru hole in wire harness cover with flat side positioned as shown.
- B) Secure antenna with nut.

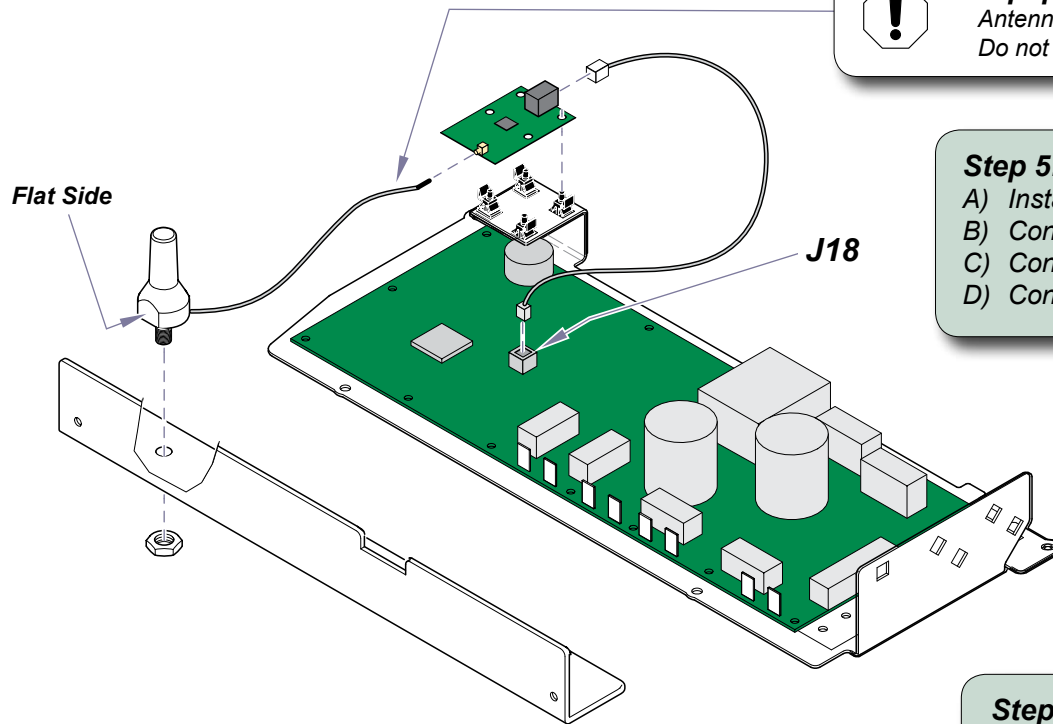

Equipment Alert

Antenna connection is very delicate.
Do not kink wire or apply stress to connection.

Step 5: Install / connect base station PC board.

- A) Install PC board onto standoffs as shown.
- B) Connect antenna to base station PC board.
- C) Connect wire harness to base station PC board.
- D) Connect other end of harness to J18 on main PC board.

To complete installation:

- Install batteries in foot control
- Check for proper operation
- Install wire harness cover
- Install PC board cover
- Lower / secure shrouds

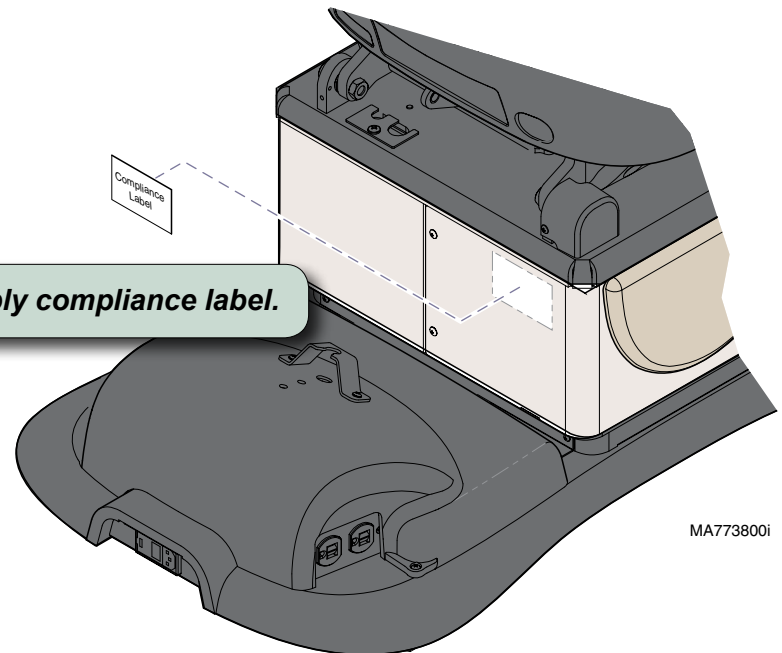

Step 6: Apply compliance label.

MA773800i