

# Base Actuator [002-1273-00]

**Components:**  
Base Actuator ..... 1

**Special Tools:**  
none

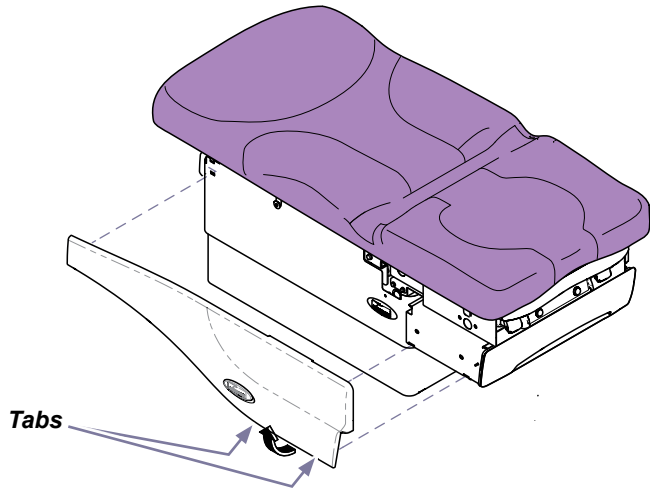

**Step 1:** Remove cladding.

**Step 2:** Push LH side lever UP and RH side lever DOWN. Remove drawer.

*Note: Side levers are clear plastic.*

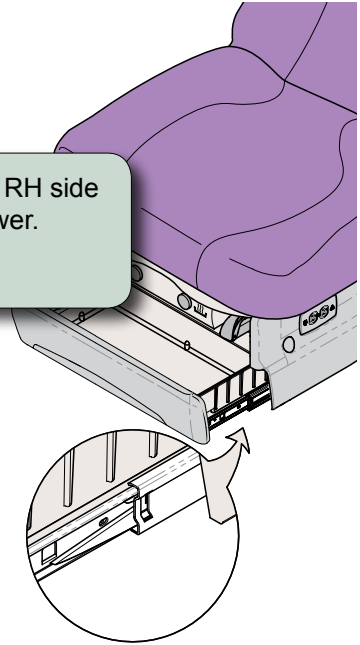

**Note**  
Lower table all the way down to remove shrouds.

**Step 3:** Remove eight screws.  
Remove outer shrouds.

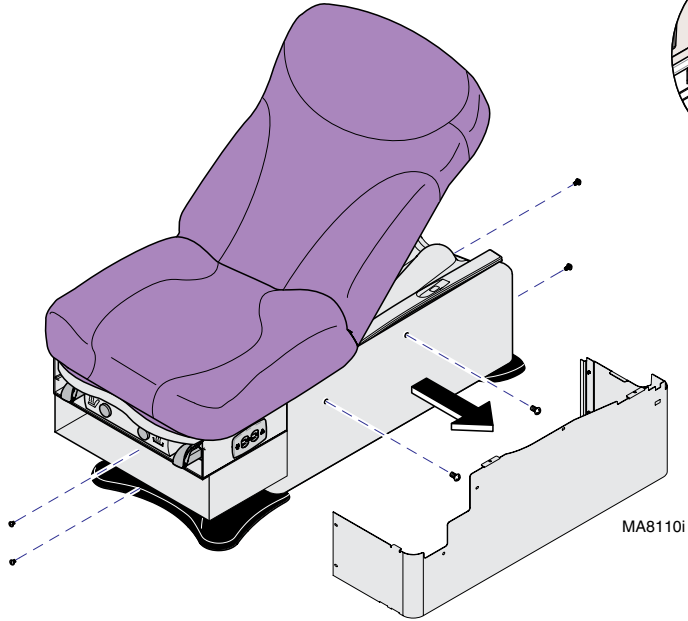

**Step 4:** Remove middle & inner shrouds.

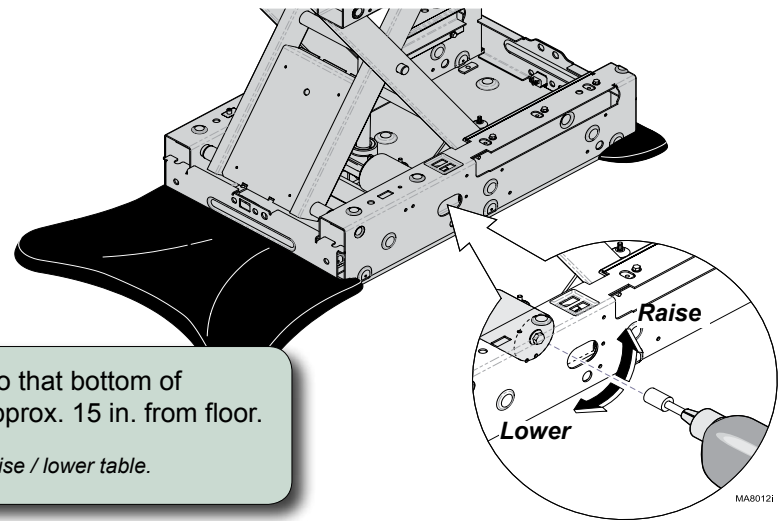
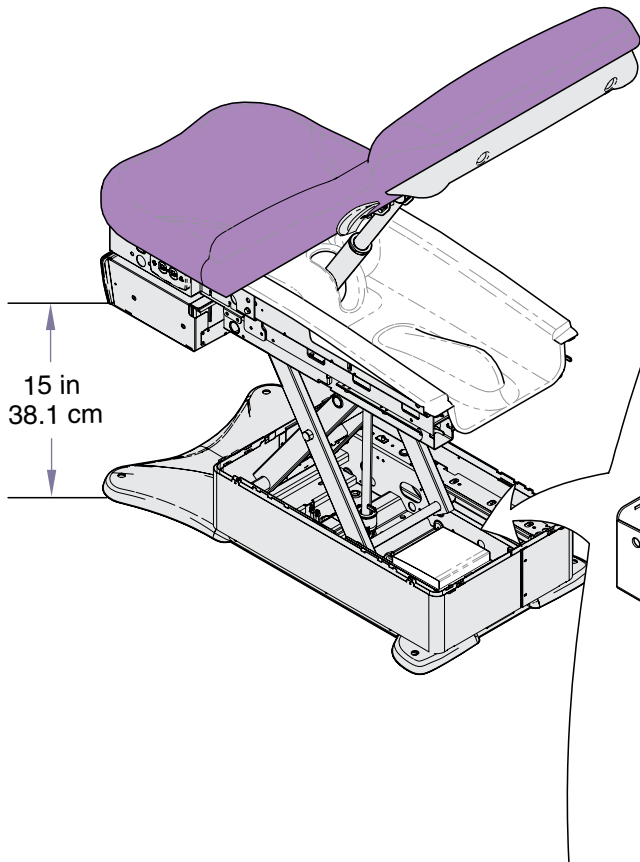

**Step 5:** Position table so that bottom of upperwrap is approx. 15 in. from floor.  
*Note: If necessary, manually raise / lower table.*

**Caution**  
Unplug power cord before removing PC Board cover.

**Step 6:** Remove PC Board cover.

**Step 7:** Disconnect base actuator wire connection at J5. Disconnect base sensor wire connection at J6.

**Step 8:** Remove cable ties as necessary.



**Caution**

Use an assistant when laying / lifting table.  
Remove all accessories (chair arms, storage pod , ect.)

**Step 9:** Lay table down on LH side.

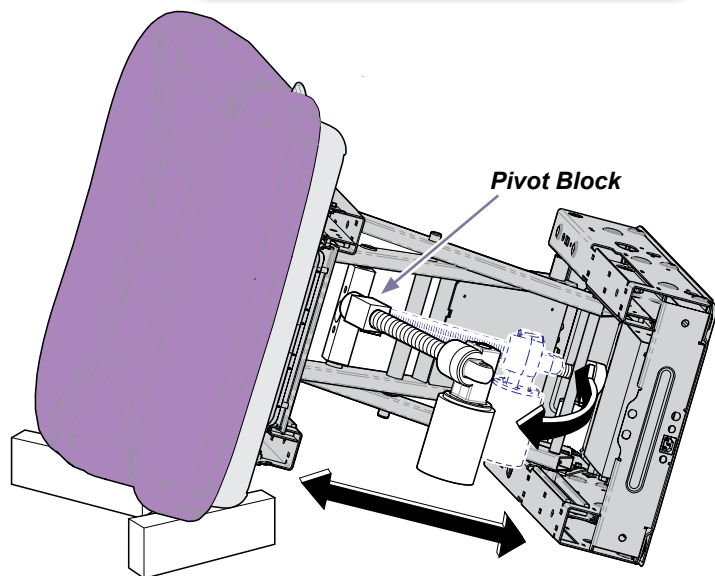

**Step 10:** Remove retaining screw.  
Remove base actuator pin.  
Pull base out to it's full extension.  
Pivot actuator toward head end.

**Step 11:** Remove two nuts, washers,  
& hex bolts.  
Remove actuator.  
Unscrew cradle weldment  
from actuator block.

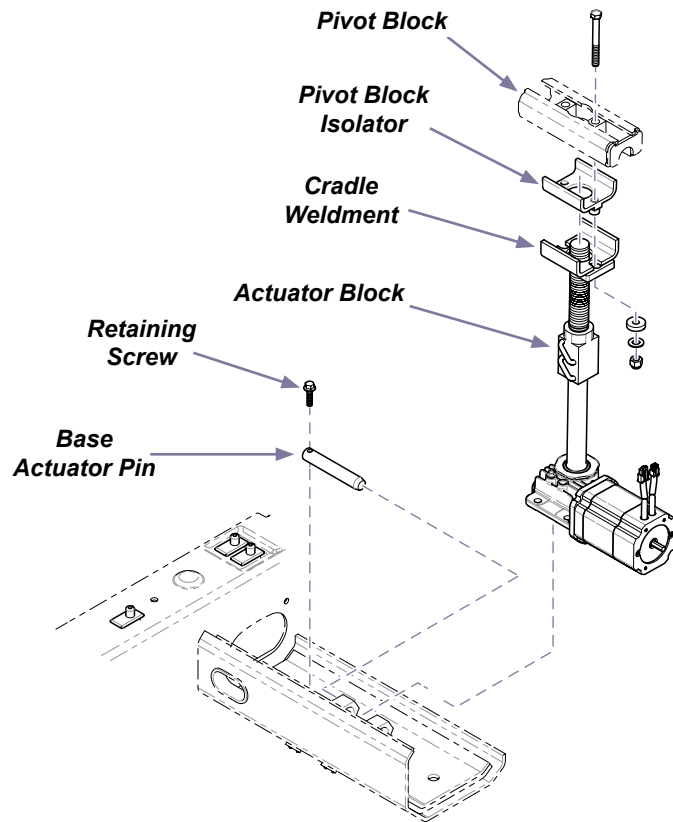

*Early Models*

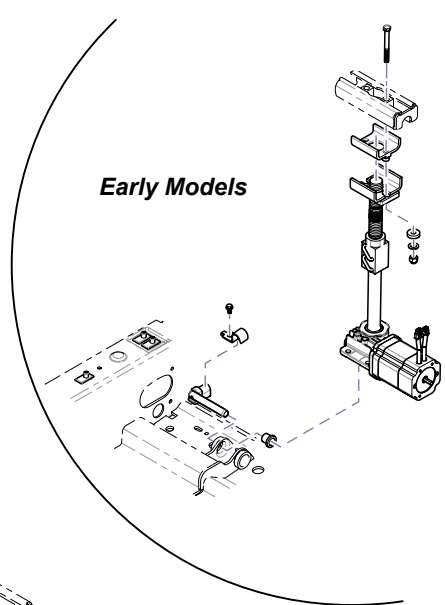

MA8197I

## Step 12:

- A) Install pivot block insulator.  
Thread cradle weldment onto actuator block.  
Insert actuator thru pivot block.  
Secure cradle weldment to pivot block.
- B) Pivot actuator toward foot end.
- C) Push base together, install base actuator pin and retaining screw.
- D) Carefully lift table upright..
- E) Connect wire harnesses to J5 & J6 on PC Board.
- F) Replace cable ties as necessary.
- G) Calibrate PC Board.
- H) Install PC Board cover.
- I) Install shrouds & cladding.

Note: Refer to removal procedure.



### Equipment Alert

Anytime the PC Board is removed or the actuator wires are disconnected, the PC Board must be calibrated.

### Note

When S2 switch is pressed you will hear a steady pattern of "beeps". When calibration is completed you will hear three short beeps.

### To calibrate...

- A) Unplug and re-plug power cord.
- B) Wait for the power up beep sequence from table, then within two seconds, press S2 switch.
- C) Run Base all the way down.
- D) Run Base all the way up.
- E) Run Back all the way down.
- F) Run Back all the way up.

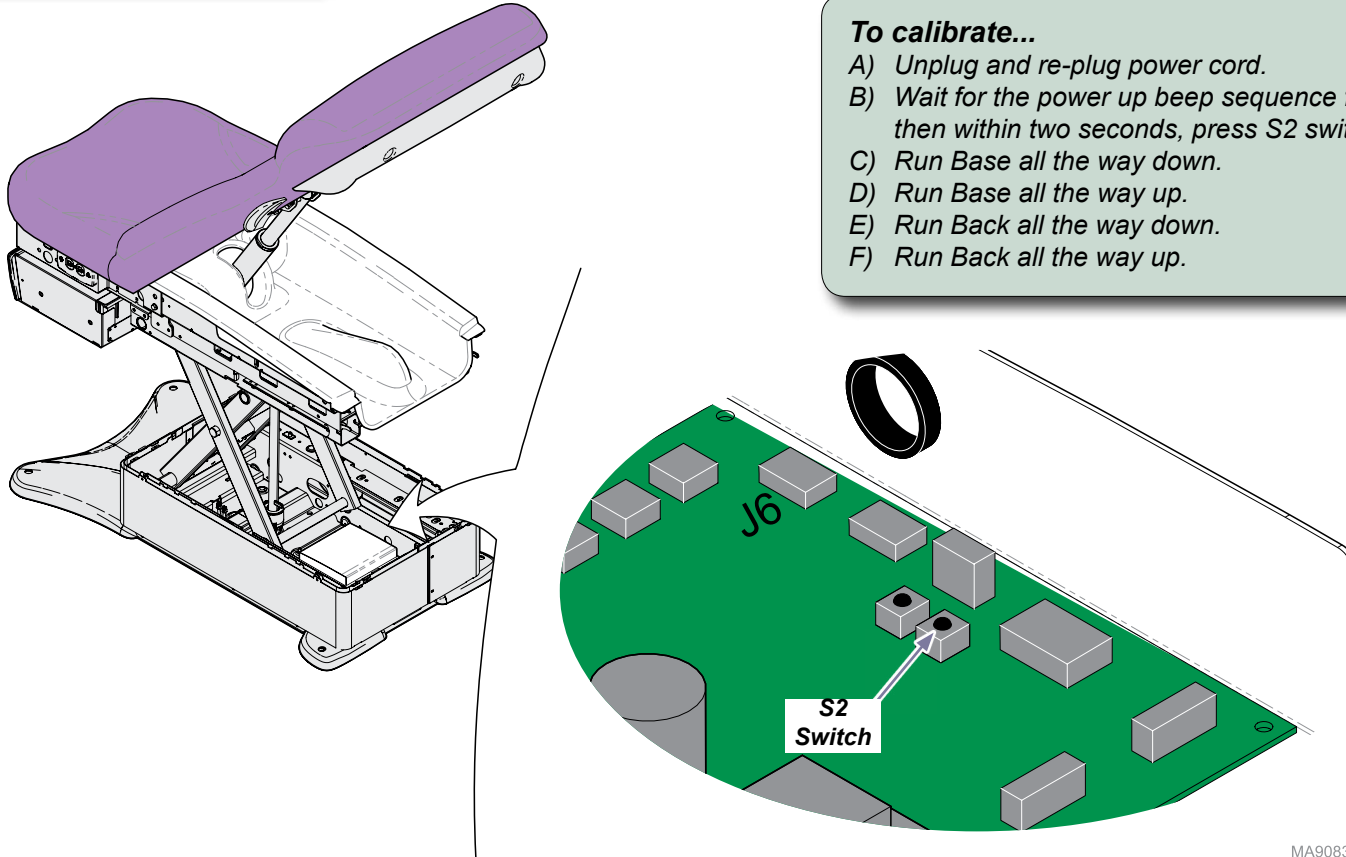

MA9083i

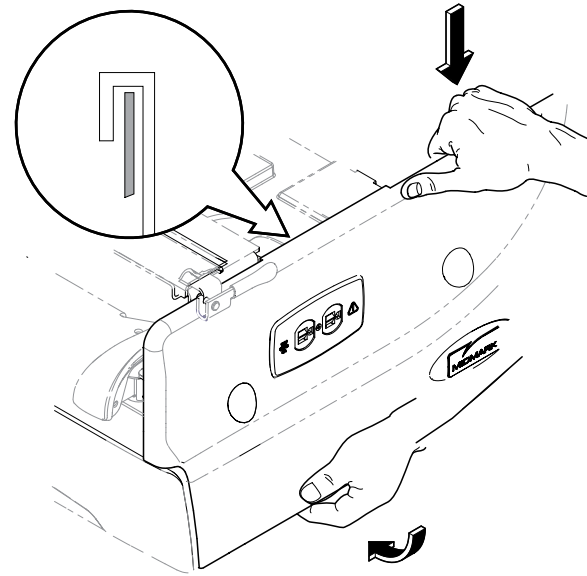
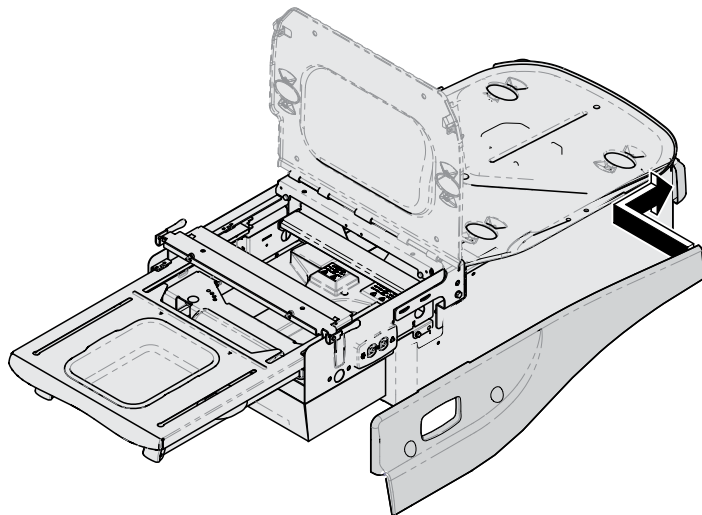

MA8111i

**To install cladding...**

- A) Insert tab at head-end of cladding into top shroud.
- B) Slide cladding over upperwrap.
- C) Pull bottom of cladding out, then push down on the top to engage the long tab onto top edge of upperwrap.
- D) Push bottom of cladding in, until two bottom tabs snap into place.