

Wireless Basestation Replacement Kit [002-1280-0x]

Components:
Basestation PC Board 1

Special Tools:
none



Caution

Always disconnect power to chair before removing covers or performing any service procedure.

Step 1: Remove PC board cover.

- A) Remove two screws, then **partially** separate cover.
- B) Disconnect indicated wire harness(es)* from PC board.
* Models 630 and 641: J9 and J12
Models 647: J12 only
- C) Remove PC board cover.

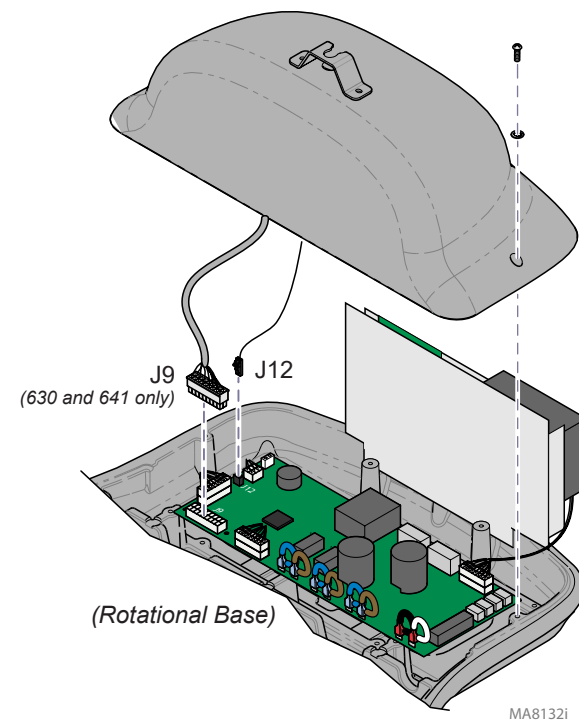
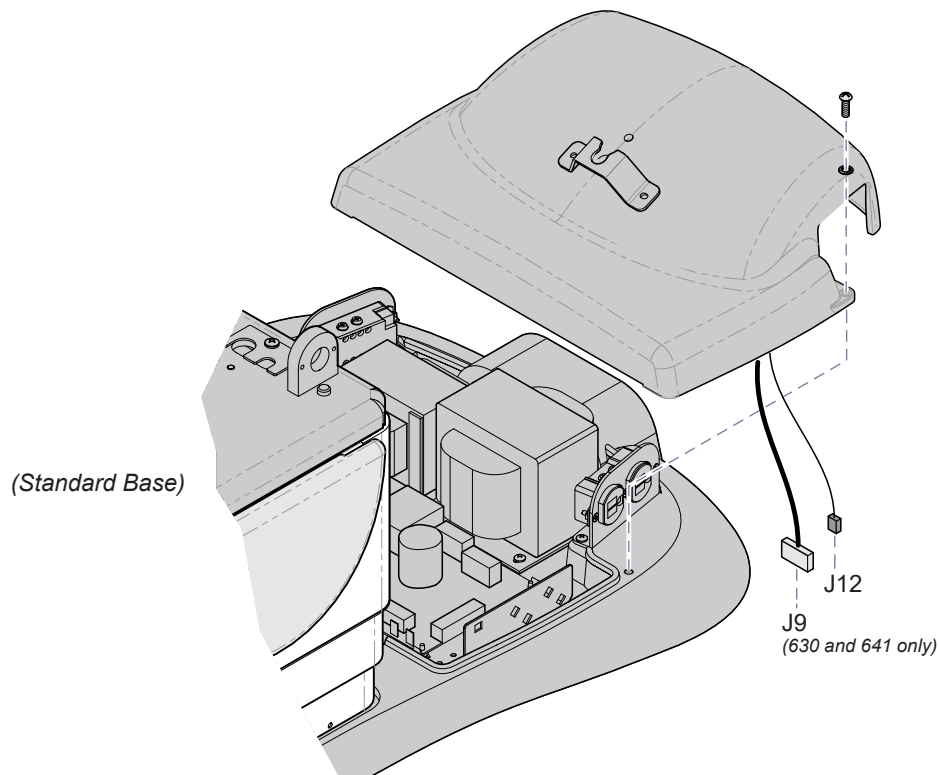

**Equipment Alert**

Antenna connection is very delicate.
Do not kink wire or apply stress to connection.

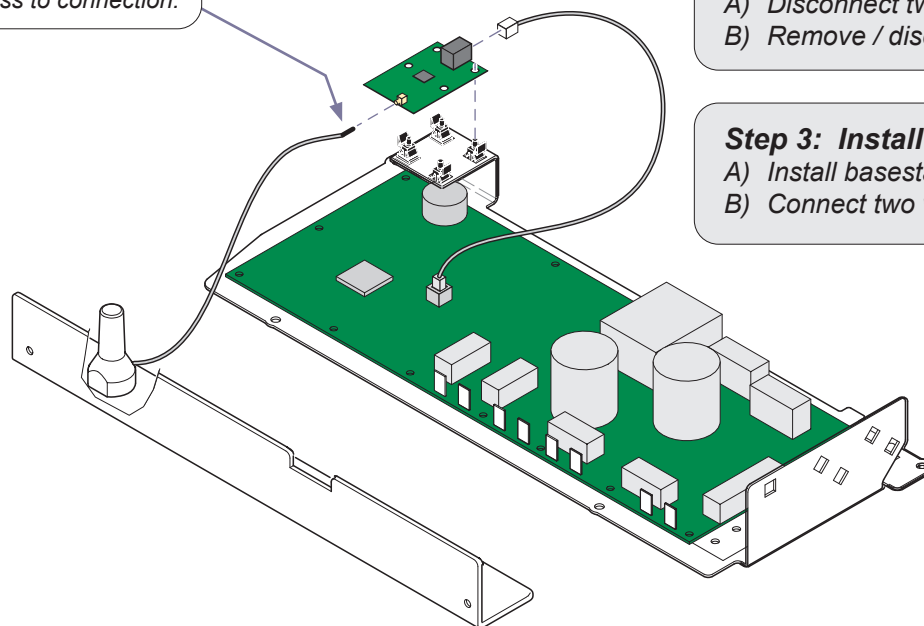
**Step 2: Remove old basestation.**

- A) Disconnect two wire harnesses from basestation.
- B) Remove / discard old basestation.

Step 3: Install new basestation.

- A) Install basestation onto standoffs as shown.
- B) Connect two wire harnesses to basestation.

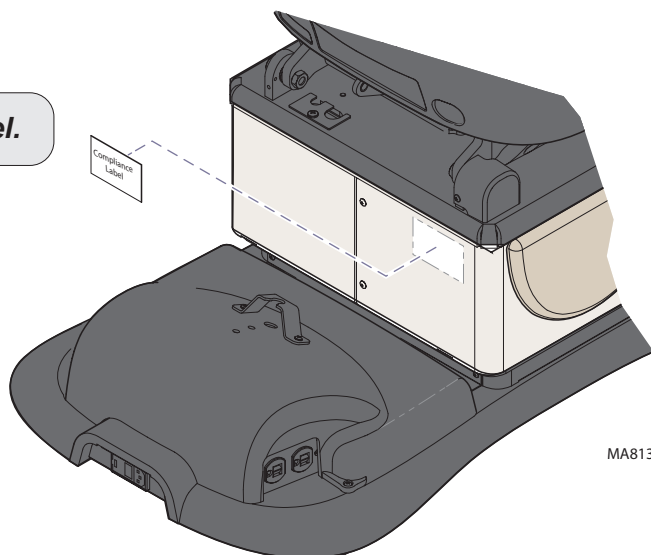
Step 4: Apply compliance label.**Step 5: Install PC board cover.**

- A) Secure wire connection(s),
then install PC board cover.

Step 6: Perform 'Association Procedure'.
[refer to following page for details]

Note: The chair's PC board only stores the last two associated controllers.

Models: 630 and 641

Association Procedure:

A) Using the **wired** hand or foot control, press and hold the **Stop** and **Home** buttons simultaneously.
(After two seconds, you will hear a single “beep”)

B*) Using the **wireless** foot control, press and hold the **Stop** and **Home** buttons until you hear three “beeps”.

* Note: Step B must be performed within 3 seconds of Step A.

C) Check for proper operation of wireless foot control.

D) Repeat procedure for wireless hand control.

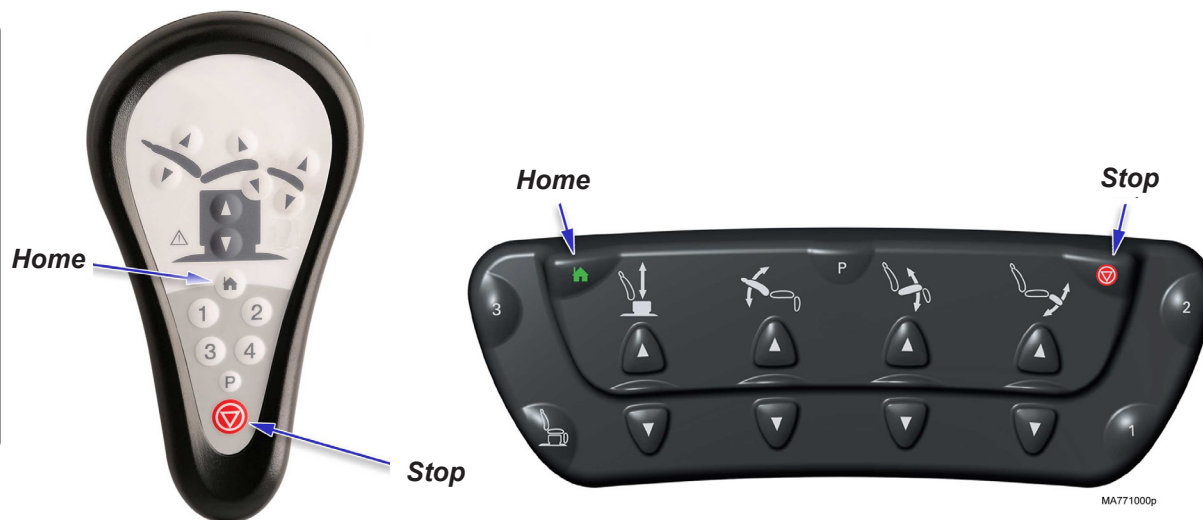

Model: 647

Association Procedure:

A) Using the **wired** foot control, press and hold the **Stop** and **QuickChair** buttons simultaneously.
(After two seconds, you will hear a single “beep”)

B*) Using the **wireless** foot control, press and hold the **Stop** and **QuickChair** buttons until you hear three “beeps”.

* Note: Step B must be performed within 3 seconds of Step A.

C) Check for proper operation of wireless foot control.

