

Base Cylinder Replacement Kit [002-1426-00]

Components:

Yellow Support Bar	1
Base Cylinder Assembly	1
Cylinder Mount Pins	2
Oil	1

Special Tools:

Crow bar



WARNING

Always disconnect chair from the power source before removing any covers. Failure to do so may result in personal injury.

Step 1: Position chair.

- Raise chair seat 26-28" above floor.
- Disconnect chair from power source.

Note: Upper lift arm cover cannot be removed if chair is raised higher than 28" above floor.



Equipment Alert

On LR and console models, position and secure flex arm mounted components to provide access to the base cylinder.



Step 2: Remove covers.

- Release clips using a slotted screwdriver and remove upper lift arm cover.
- Working one side at a time, move lower lift arm cover to the side and back to free from mounting pins.
- Release clip with a slotted screw driver and remove base cover.
- Pull out then lift from bottom, to remove front base cover.
- Loosen two screws to remove top pivot cover.
- Maneuver bottom pivot cover off mounting studs and remove.

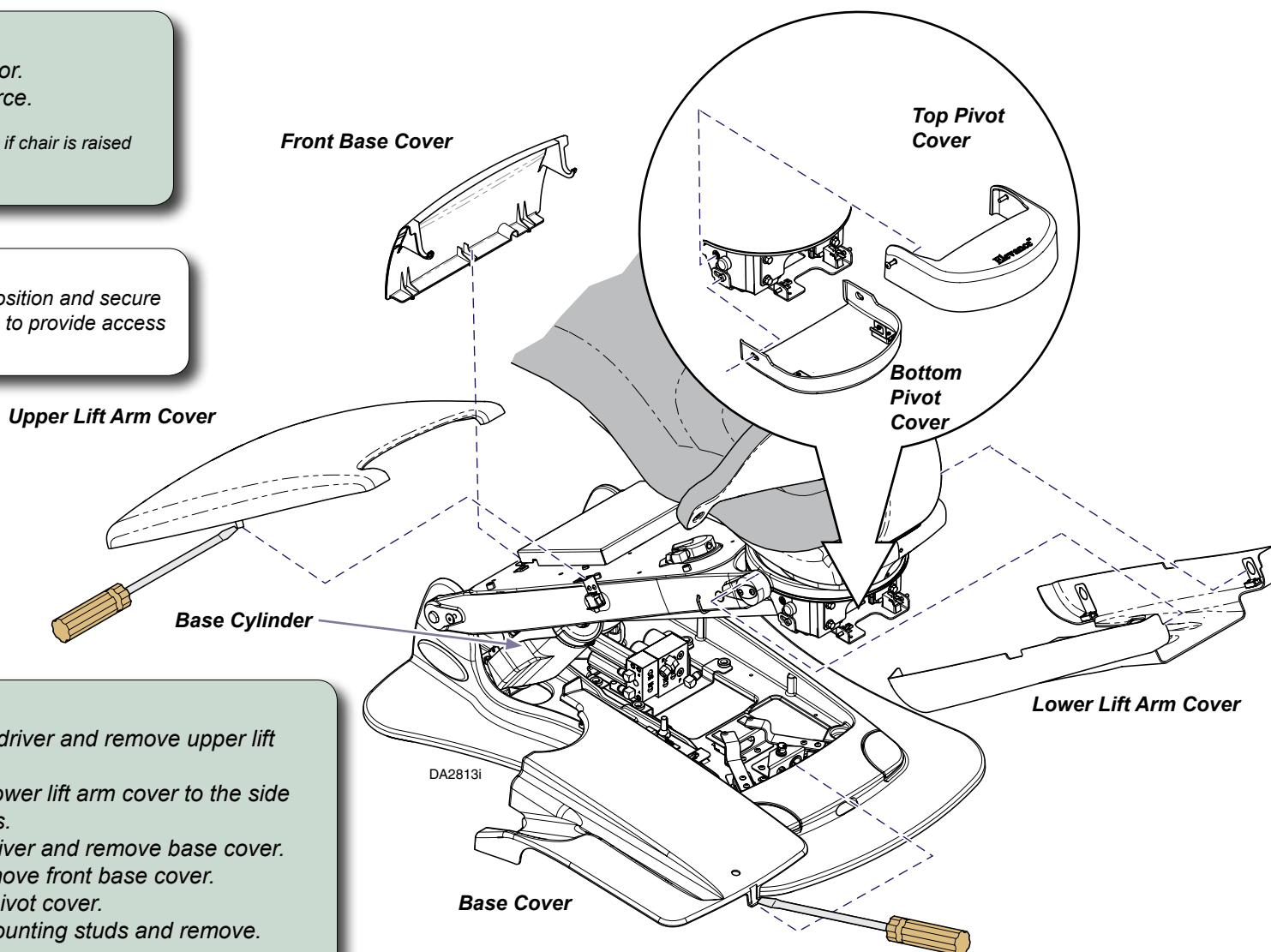

Step 3: Support Chair.

- A) Connect chair to power source.
- B) Place yellow support bar into base hole and align with chair frame pocket, then lower chair onto bar.
- C) Disconnect chair from power source.
- D) Place a bottle jack (or 4X4 wood block) under the pivot for extra support.



DANGER

Verify that the chair is securely supported before removing the base cylinder. Failure to do so could result in serious personal injury or death!

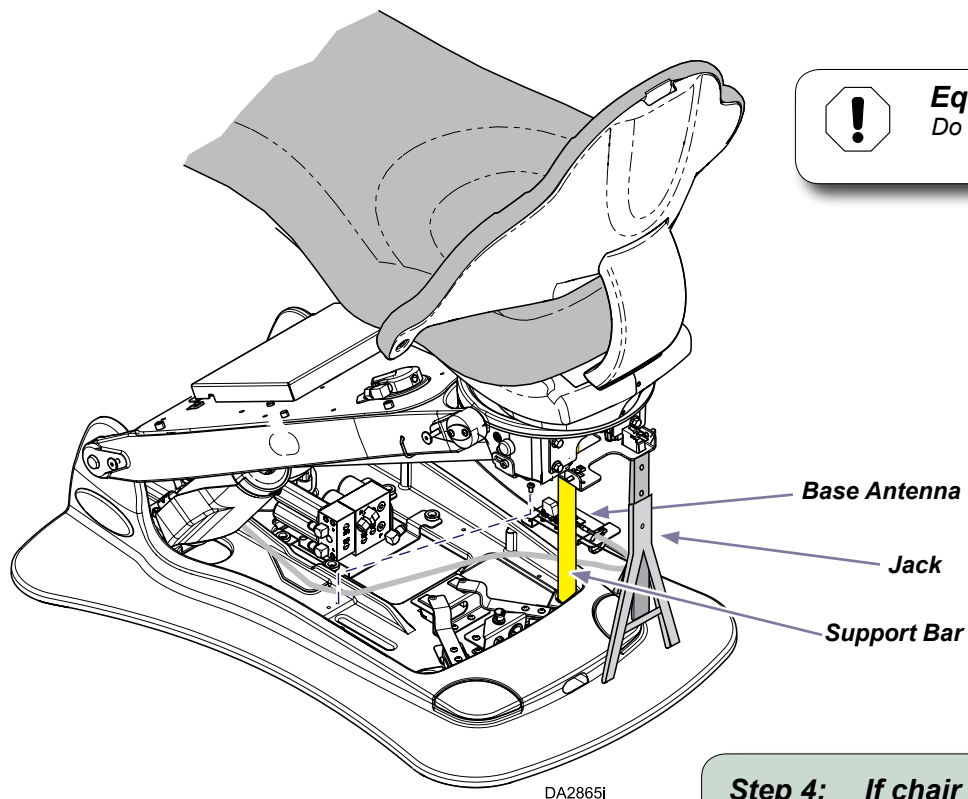

Equipment Alert

Do not pinch wiring when lowering chair onto support bar.

Step 4: If chair has a remote control, remove base antenna.

- A) Remove two screws and lift base antenna assembly.
- B) Move base antenna to right side of the chair.
- C) Disconnect power supply from chair.

Note: Leave wiring connected to base antenna so you can use remote control.

Step 5: Remove base cylinder assembly.

- A) Remove two socket head screws and the upper bracket.
- B) Wedge a crowbar between lift arm and cylinder shaft and pull up to free upper mount pin from mounting slot.
- C) Remove two socket head screws and the lower bracket.
- D) Rock the cylinder to free lower mount pin from the mounting slot.



DANGER

Verify that the chair is securely supported before removing the base cylinder. Failure to do so could result in serious personal injury or death!

Note:

Save mounting screws, brackets and covers for re-use.

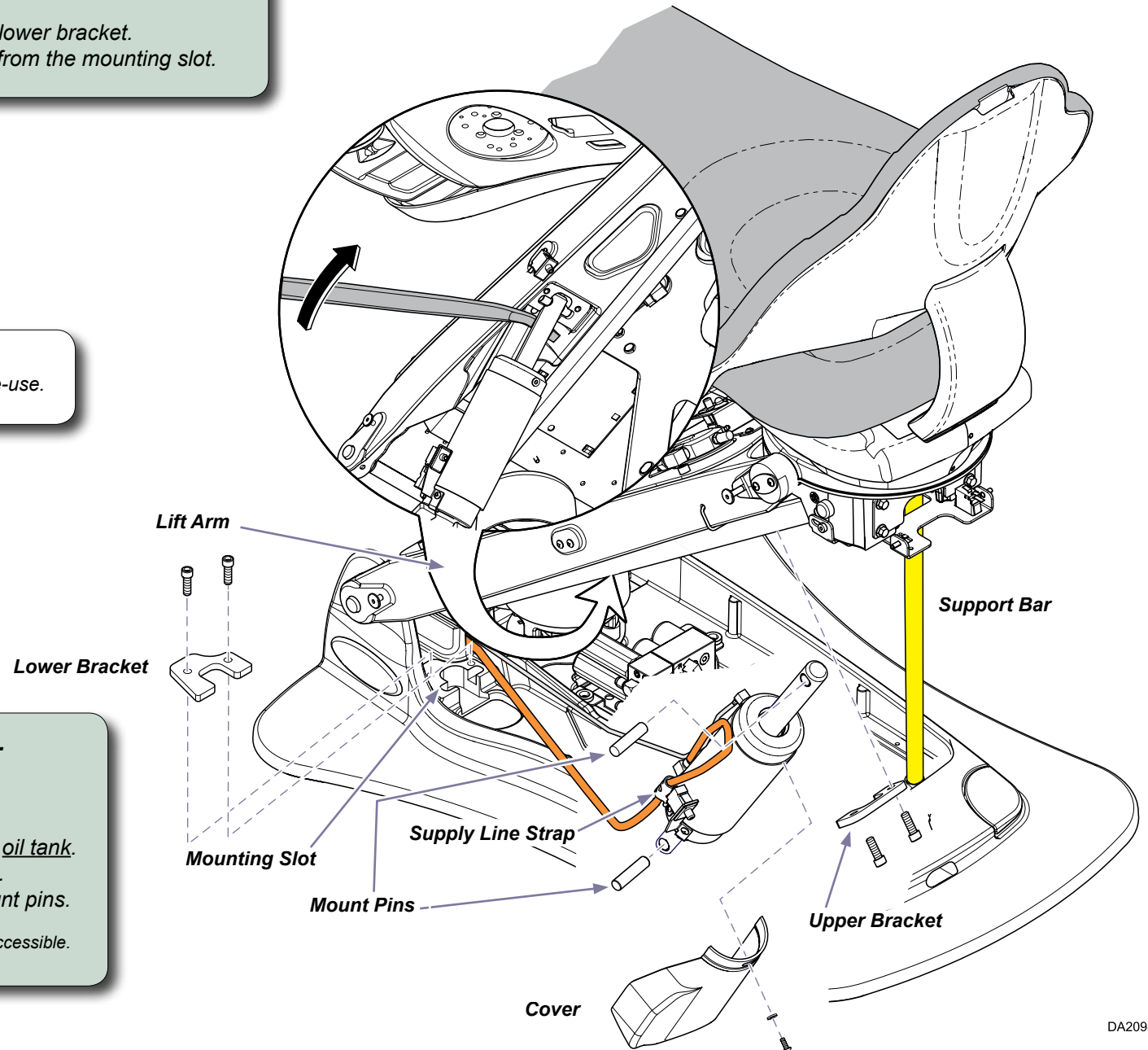

Step 6: Remove cylinder components.

- Disconnect wires from safety switch.
- Remove two screws and supply line strap.
- Remove screw, washer and cover.
- Disconnect breather line from fitting at the oil tank.
- Disconnect supply line from cylinder fitting.
- Remove and discard the cylinder and mount pins.

Note: Components may be removed any time they are accessible.

Step 7: Assemble and install new base cylinder.

- A) Center mount pins in shaft holes and insert into bottom mounting slot. May have to tap pin into slot. Tighten lower bracket to secure.
- B) Finger tighten supply line to cylinder fitting (DO NOT ROTATE FITTING) then tighten 2-3 flats with wrench (DO NOT OVERTIGHTEN).
- C) Secure supply line strap to cylinder with two screws.
- D) Route breather line over top of shaft and connect to oil tank fitting.
- E) Connect wires to safety switch.
- F) Connect chair to power supply.
- G) Raise chair slowly as you hold cylinder up. You want chair just high enough to put mount pin into mounting slot. DO NOT RAISE TOO HIGH.
- H) Once pin is aligned with mounting slot, tighten down with upper bracket and screws.
- I) Install cylinder cover.
- J) Install base antenna (if applicable) - Step 4.



CAUTION

Always use caution when operating a chair with covers removed!

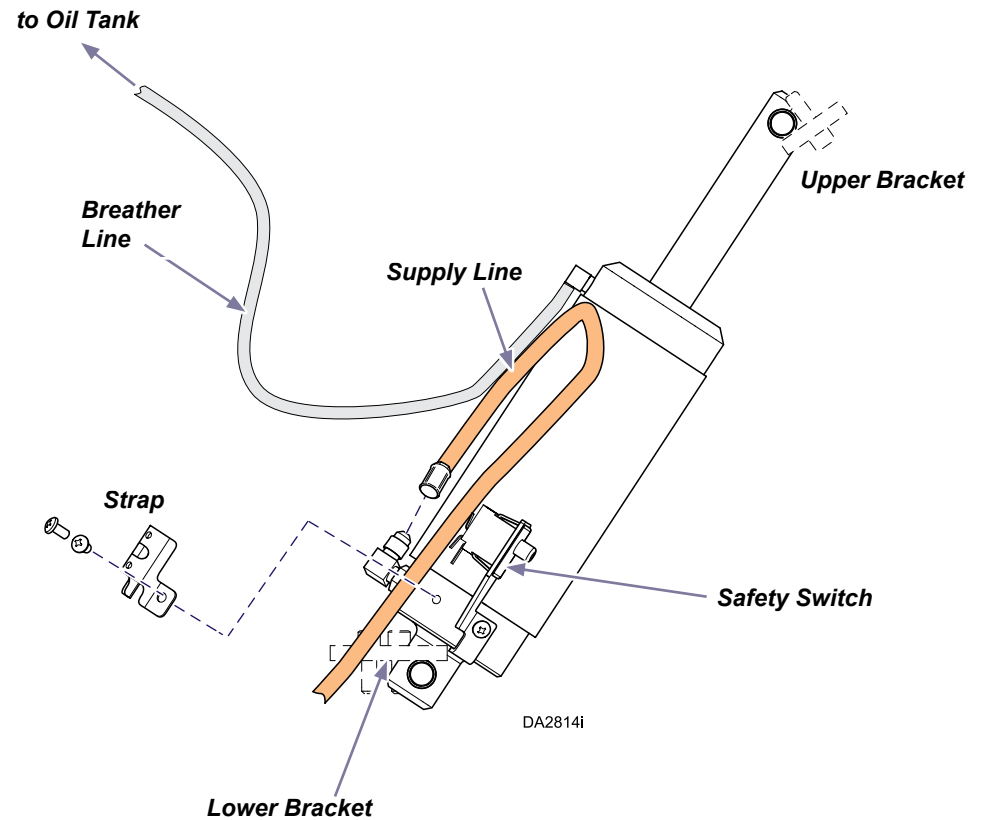
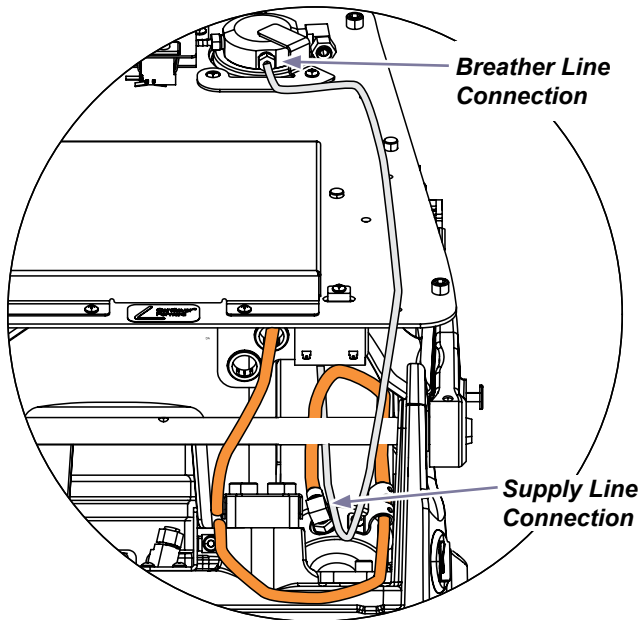

Step 8: Install covers and test.

- A) Raise chair high enough to remove yellow support bar.
- B) Return chair seat to 26-28" above floor.
- C) Check oil level - return to normal level. See Check Oil Level procedure on following pages.
- D) Replace all covers - Step 2
- E) Verify cylinder operation using control buttons.

Check Oil Level Procedure

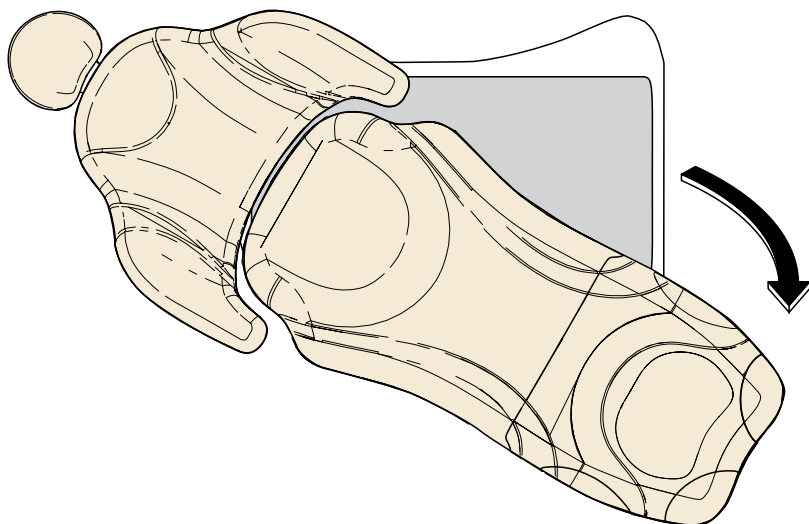

Step 1: Position chair.

- A) Rotate chair to the right for more room to work.
- B) Tap a lift arm cover three times to raise chair to the home position.
- C) Lower back until level with seat.
- D) Disconnect chair from power supply.



WARNING

Always disconnect chair from the power source before removing any covers. Failure to do so may result in personal injury.

Step 2: Remove upper lift arm cover.

- A) Push in with a slotted screwdriver to release upper lift arm cover clips. Lift cover off chair.

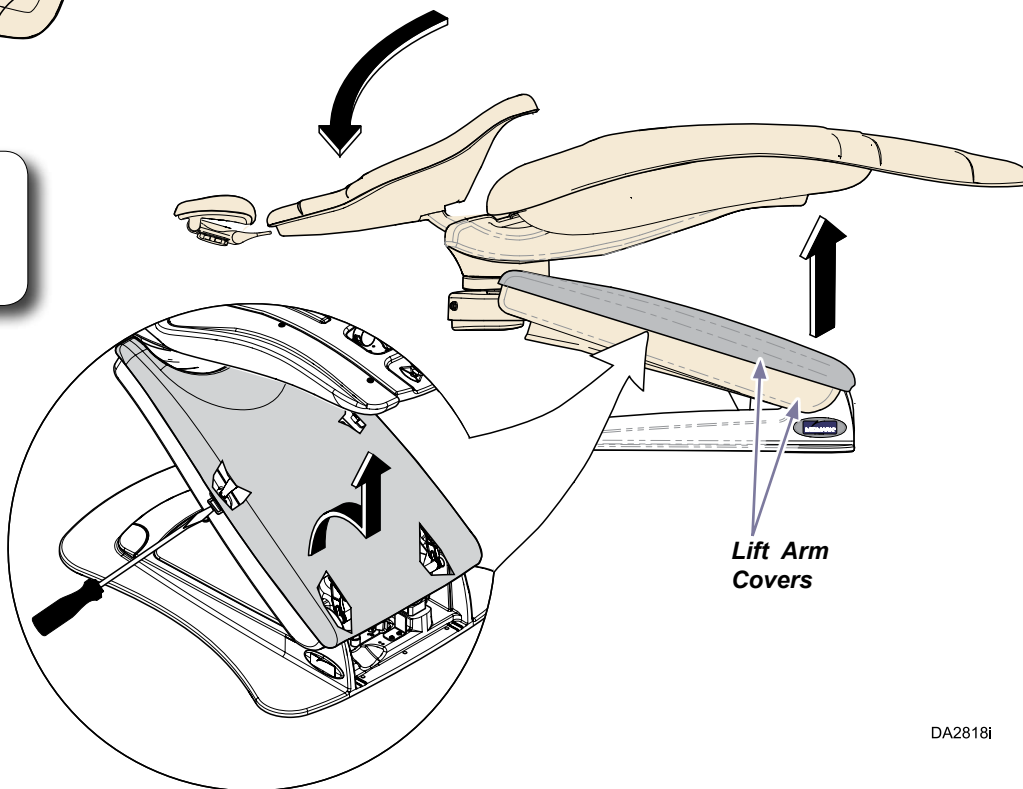

DA2818i

Check Oil Level Procedure - continued

Step 3: Check oil level.

- A) Remove screw in cap bracket and rotate bracket to remove.
- B) Pull up on oil cap to remove from reservoir.
- C) Oil should be level with the base of the oil cap opening.
- D) Add only Hydraulic Oil with Viscosity ISOVG 32. if oil level is low.



Equipment Alert

Factory fill volume: 1.3 - 1.4 U.S. quarts
(1.2 - 1.3 liters).

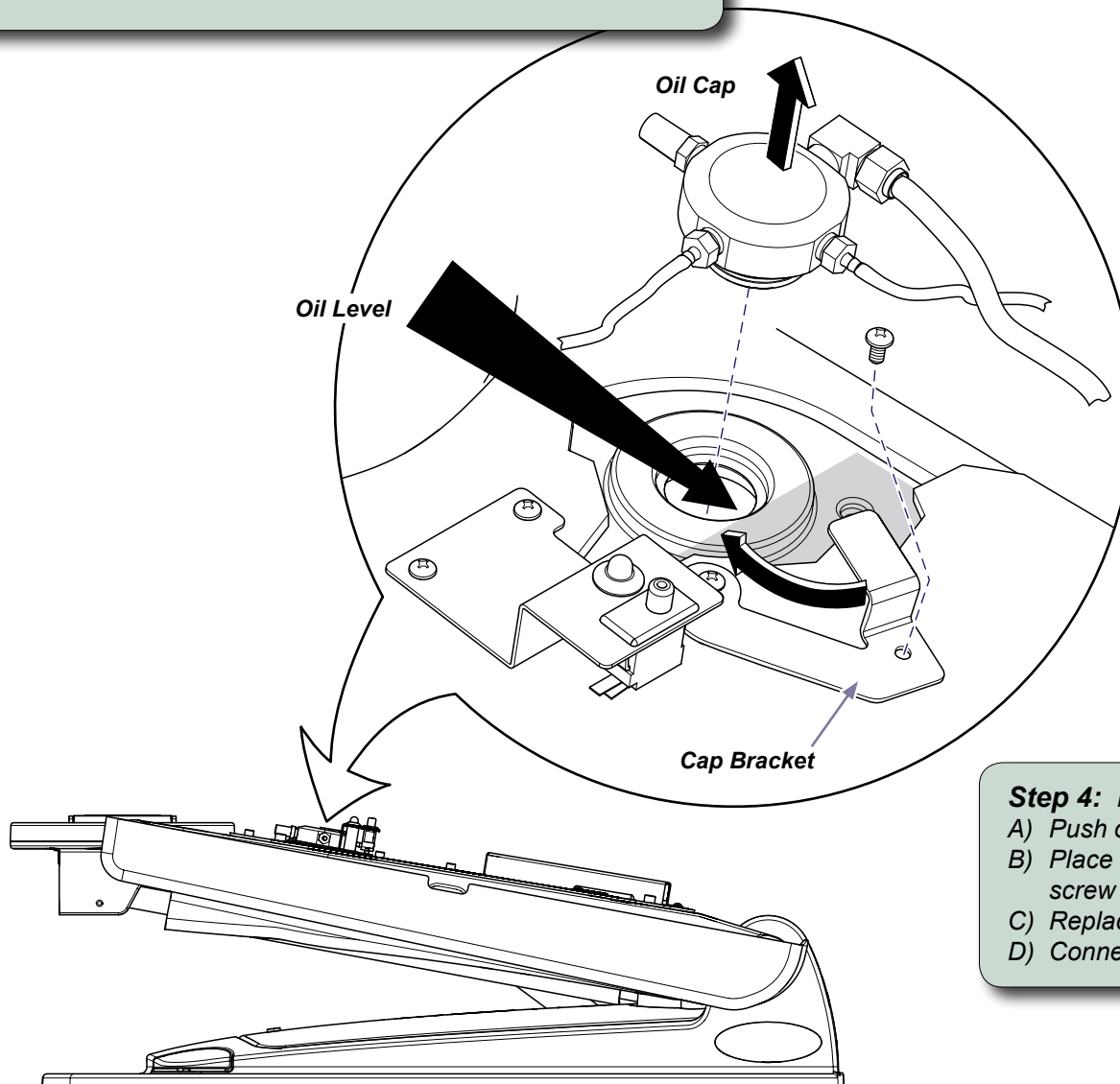

Step 4: Install oil cap, cap bracket and lift arm cover.

- A) Push oil cap into tank opening.
- B) Place bracket over screw, rotate bracket to fit over oil cap and screw into tank.
- C) Replace upper arm lift cover - see Step 2.
- D) Connect chair to power supply.