

# Back Cover for Replacement Monitor [Kit # 002-1543-00]

**Components:**  
 Cover w/Screws..... 1  
 Bracket ..... 1  
 Stereo to RCA  
 Adapter ..... 1

**No Special Tools**

## Step 1: Remove monitor.

- Disconnect facility power to the track.
- Remove monitor cover.
- Disconnect all A/V connections.
- Remove and **KEEP**, four monitor mounting screws in the mount arm.

*Note: Monitor mounting screws are M3 x 14mm long. Do not use any other size.*

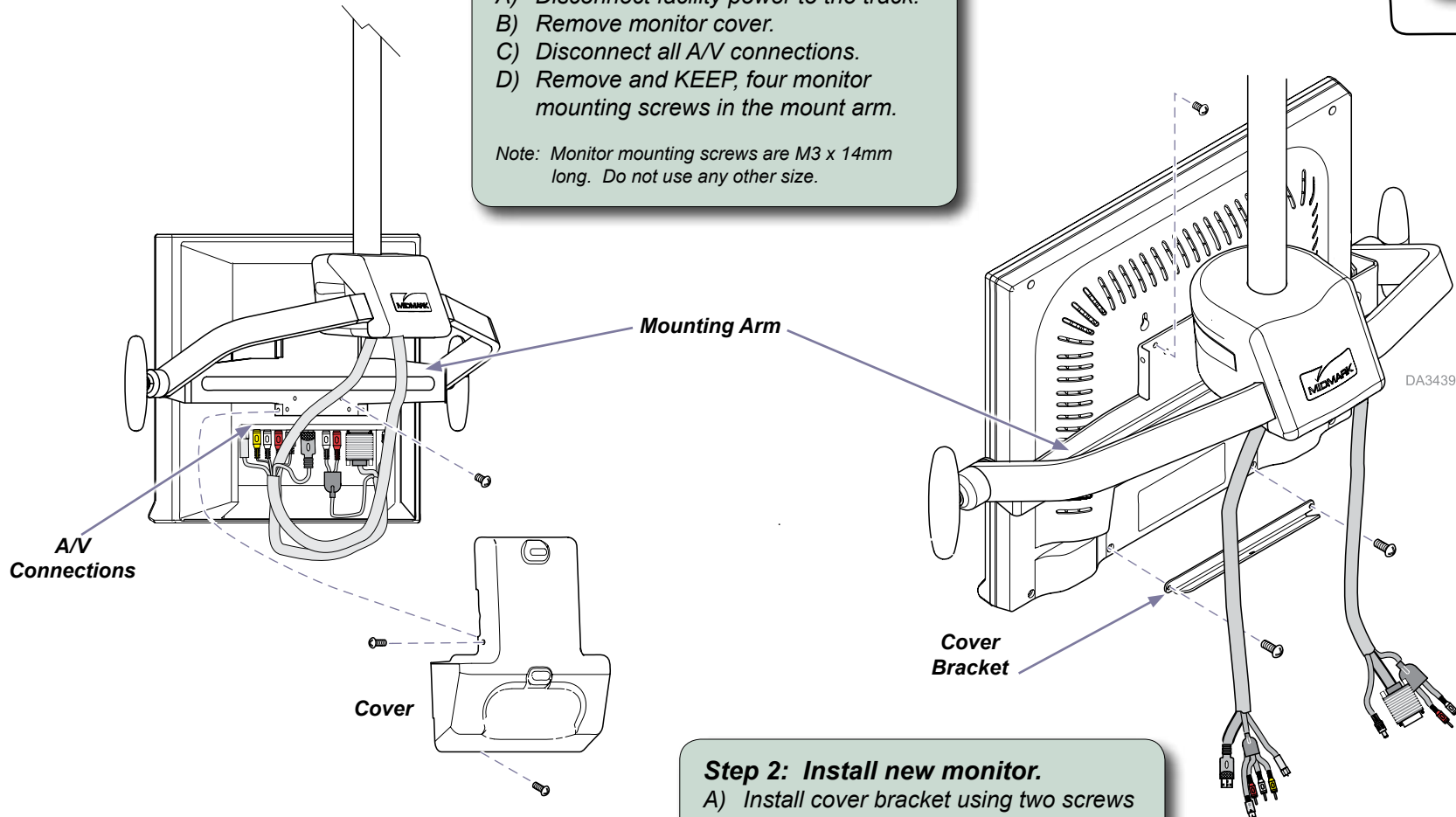

## Step 2: Install new monitor.

- Install cover bracket using two screws removed from the monitor back.
- Attach mounting arm to monitor. Use only M3 x 14mm screws.

### Step 3: Connect new monitor.

- A) Connect harnesses to monitor as shown.
- B) Loop wiring bundles below connections.
- C) Older model wiring harnesses may require the use of a mono audio adapter.

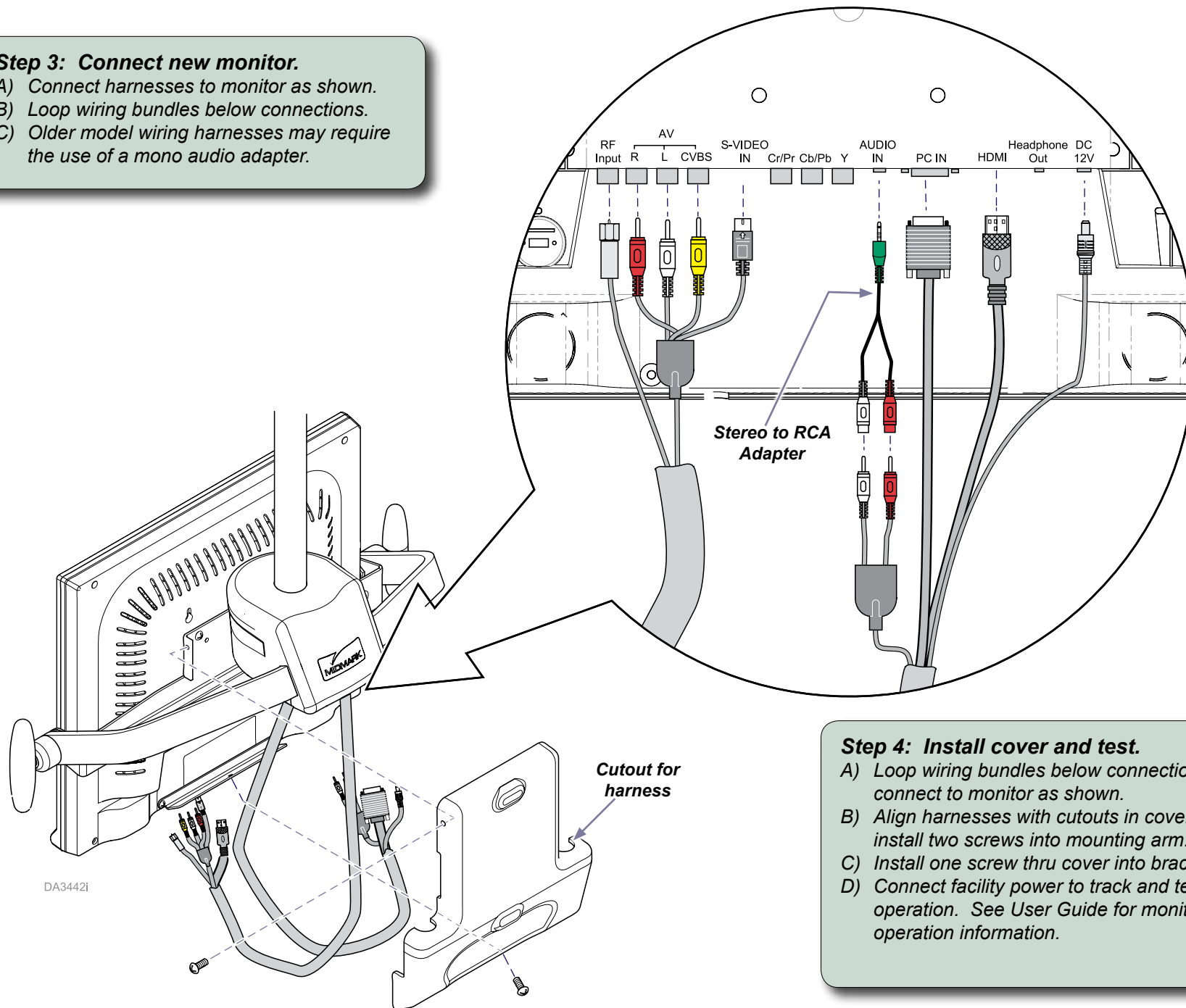

### Step 4: Install cover and test.

- A) Loop wiring bundles below connections and connect to monitor as shown.
- B) Align harnesses with cutouts in cover and install two screws into mounting arm.
- C) Install one screw thru cover into bracket.
- D) Connect facility power to track and test operation. See User Guide for monitor operation information.