

PowerVac G with Solmetex and Mounting Bracket

[002-1524-00]

PowerVac G Mounting Bracket Only

[002-1522-00]

PowerVac with Solmetex and Mounting Bracket

[002-1523-00]

PowerVac Mounting Bracket Only

[002-1521-00]

Contents:

Installation.....1 thru 3

Special Tools:

none

Language of origin: English

Intended Use:

To provide the PowerVac and PowerVac G with an amalgam separator.



WARNING

Equipment is not suitable for use in the presence of a flammable anesthetic mixture.

Left Leg Bracket

Right Leg Bracket

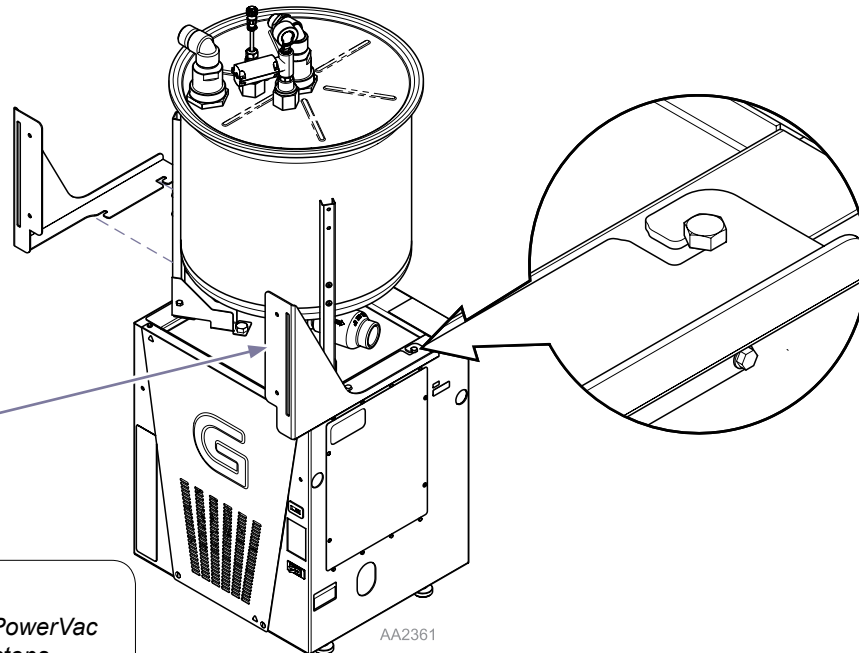

Step 1: Install left and right bracket legs.

- A) Loosen 2 screws on both sides of base unit.
- B) Slide bracket legs under screw heads and tighten.

Note

PowerVac G is shown. PowerVac installation is the same steps.

Step 2: Install front plate.

- A) Secure top and bottom brackets to front plate, do not tighten.
- B) Apply loctite 242 (blue) to four 1/4-20 bolts. (supplied)
- C) Install front plate to right and left brackets.

Note

PowerVac G is shown. PowerVac installation is the same steps.

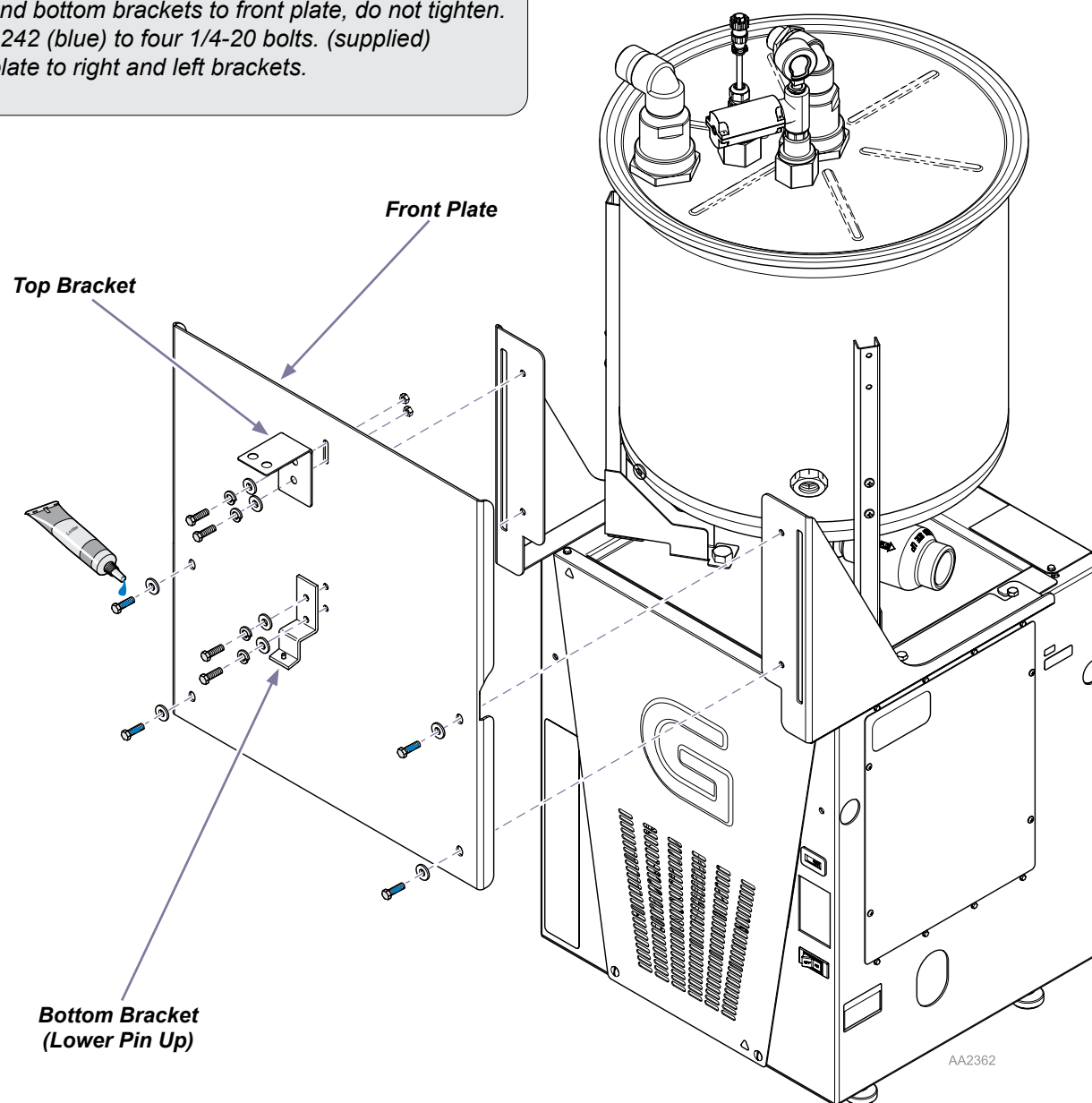

Step 3: Install separator.

- A) Assemble hose, elbow, adapter, and rubber sleeve to the separator inlet.
- B) Engage slot on bottom of separator with pin on bottom bracket.
- C) Push top bracket down over tabs until separator is secure.
- D) Tighten top bracket bolts.
- E) Remove intake hose from operator and reconnect to tank inlet on separator.
- (Use previously supplied intake hose assembly.)

For Twin set-ups go to next page for Steps G and H.

- F) Connect supplied flex hose, (029-5492-00), from separator inlet to operator.
- G) Attach collection container to separator and lock with retaining pins.

Note: The mounting plate packaged with the separator will not be used.

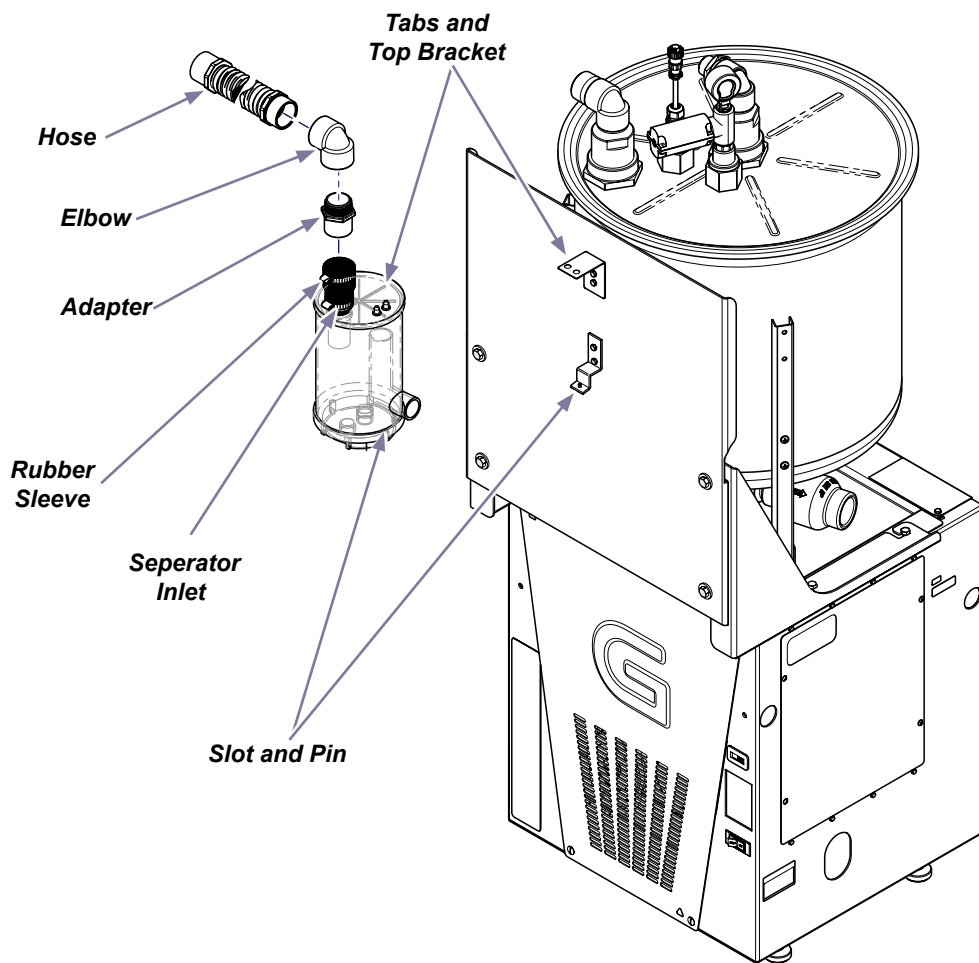

Equipment Alert

Tighten both clamps on rubber sleeve on separator inlet connection. Refer to Solmetex documentation (in separator packaging) for replacement parts, cleaning and maintenance instructions for separator.

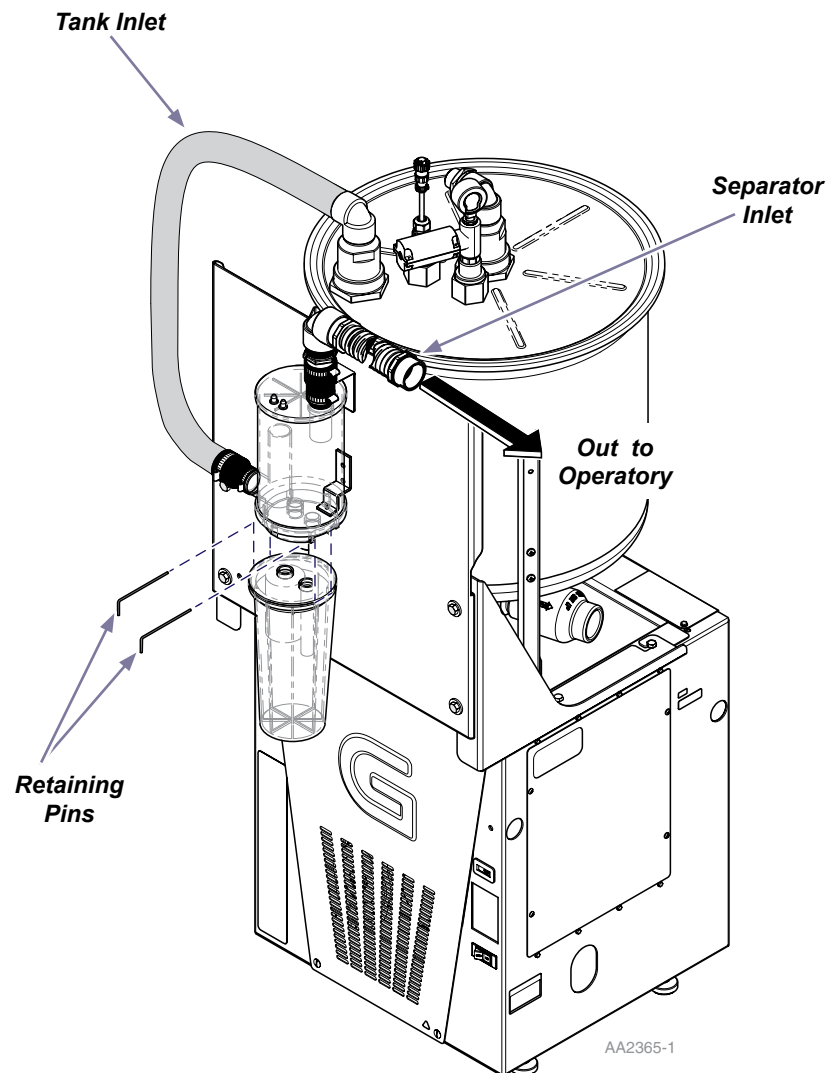

AA2365-1

Step 3: Continued for Twin set-up...

G) Connect supplied flex hose, (029-5492-00), from separator inlet to tee assembly, one unit to each side of tee.

H) Attach collection container to separator and lock with retaining pins.

Note: The mounting plate packaged with the separator will not be used.

