

Lighthouse Assembly Replacement [002-1565-00]

Components:

Lighthouse

Special Tools:

Spanner Wrench
Thin Needle Nose Pliers

Language of origin: English



Warning

Always disconnect power before removing covers.
Failure to do so may result in personal injury.

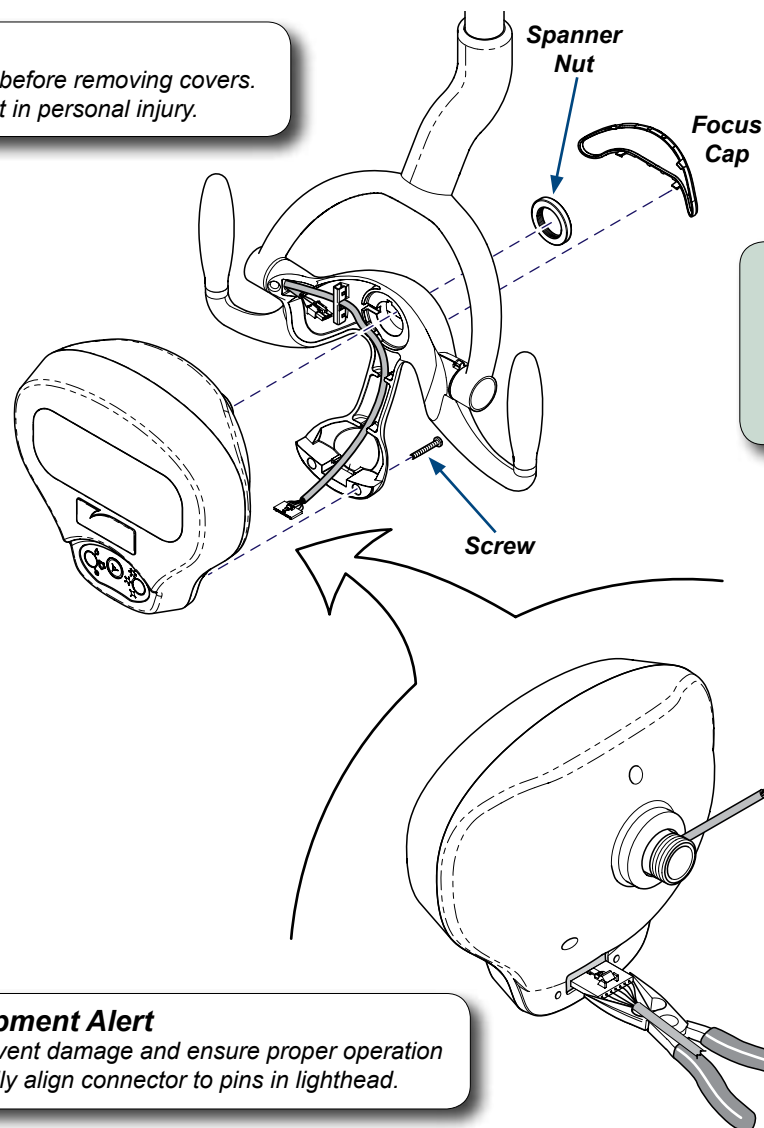

To remove Lighthouse...

- Disconnect power.
- Remove focus cap.
- Remove spanner nut and two screws.
- Disconnect both wire harnesses.



Equipment Alert

To ensure proper operation,
connect wiring harnesses as shown.



Equipment Alert

To prevent damage and ensure proper operation
carefully align connector to pins in lighthouse.

To install Lighthouse...

- Connect wire harnesses as shown.
- Secure lighthouse to light mount with spanner nut and two screws.
- Install focus cap.

DA3588i