

Light Flex Arm PC Board Replacement [002-1566-00]

Components:

PC Board

Special Tools:

Small Screwdriver

Language of origin: English



Warning

Always disconnect power before removing covers.
Failure to do so may result in personal injury.



Equipment Alert

Improperly connecting leads may
permanently damage PC Board.

Step 1: To access PC Board.

- Disconnect power.
- Remove end cap screw and end cap, then slide cover back.
- Disconnect wire connections and remove PC Board.

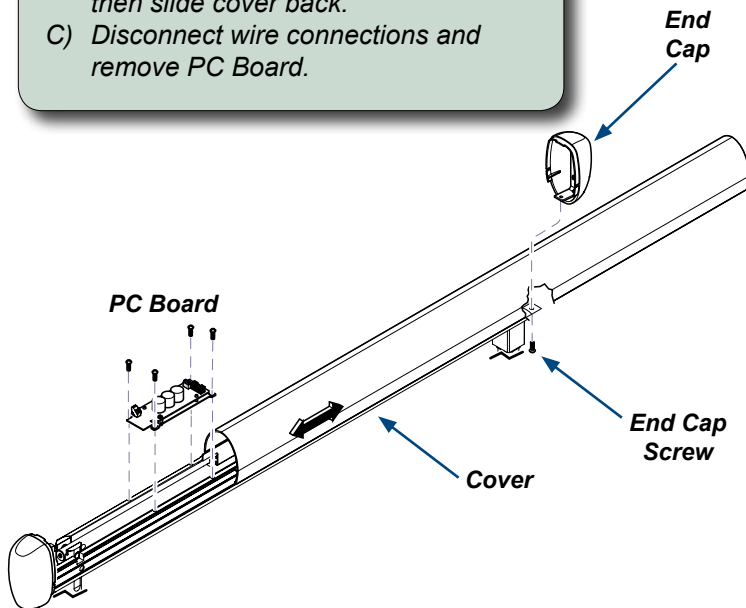

DA3580i

Step 2: Wire Connections.

- Install PC Board.
- Connect wiring as shown.

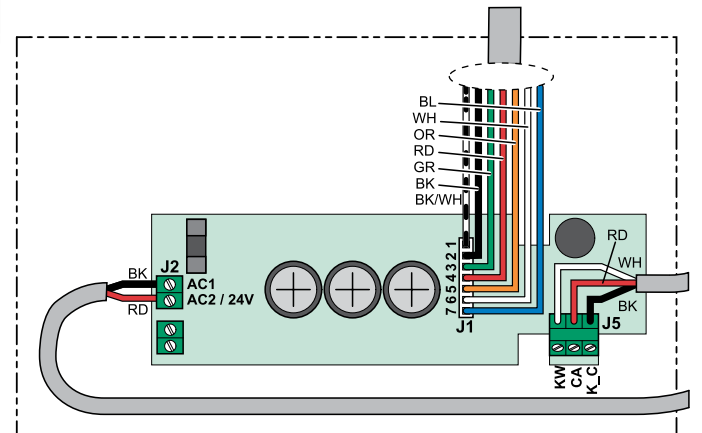
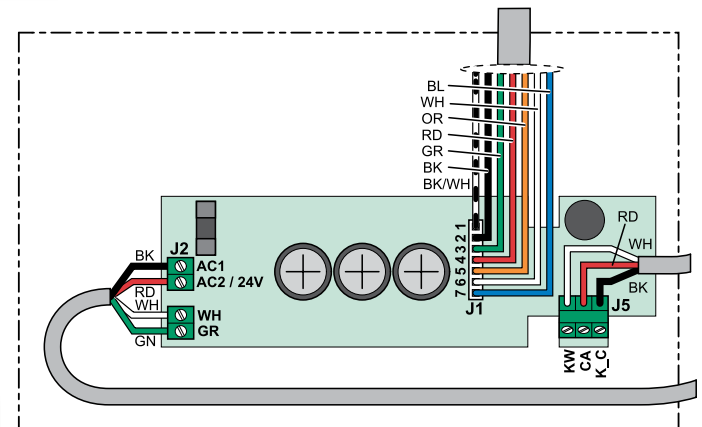

DA4437i

Note

This adjustment allows setting the desired height (when light arm is lowered) of light arm at which AUTO ON mode is activated (light automatically turns on).
On some units both end caps may need to be removed.



WARNING

Use caution when operating equipment with covers removed.

Step 3: To adjust AUTO ON mode.

- A) Position light arm at desired height for AUTO ON mode to activate and hold in this position.
- B) Loosen two screws, slide trigger all the way out, then slowly slide trigger in until lighthouse turns on at set point line.
- C) Tighten two screws to secure trigger.

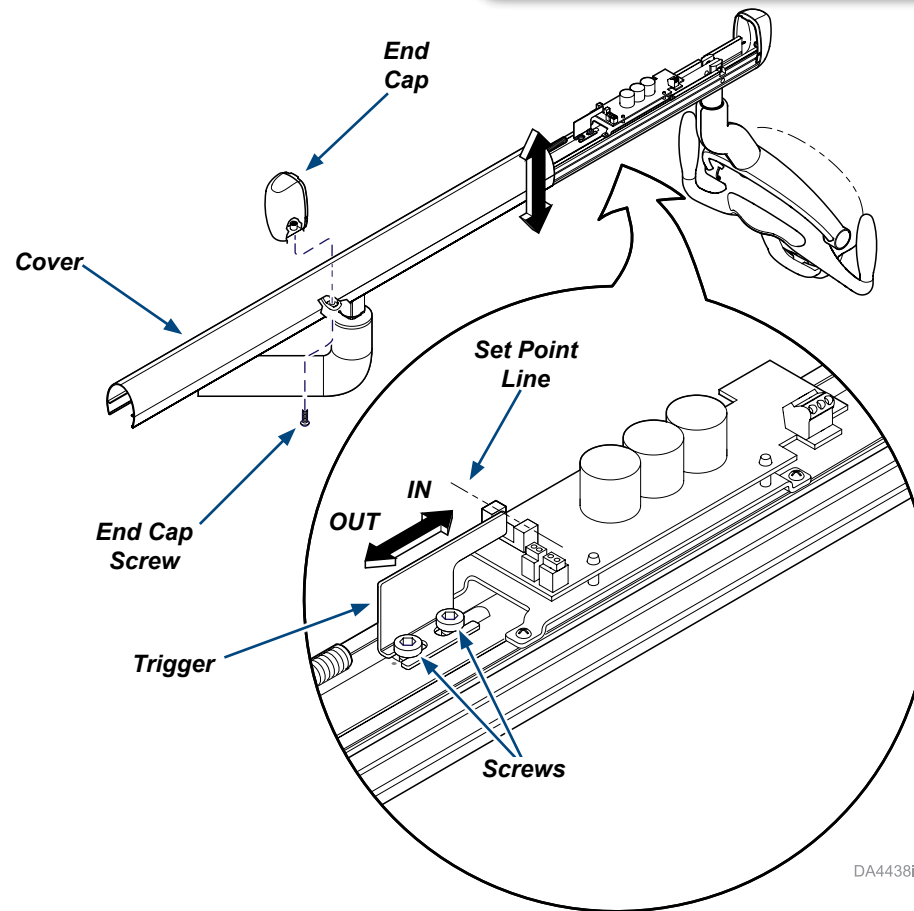

DA4438i

Step 4: To complete installation.

- A) Slide cover into place.
- B) Secure with end cap and screw.