

Lighthouse Touchpad Replacement [002-1568-00]

Components:

Touchpad

Special Tools:

Spanner Wrench

Thin Needle Nose Pliers

Language of origin: English



Warning

Always disconnect power before removing covers.
Failure to do so may result in personal injury.

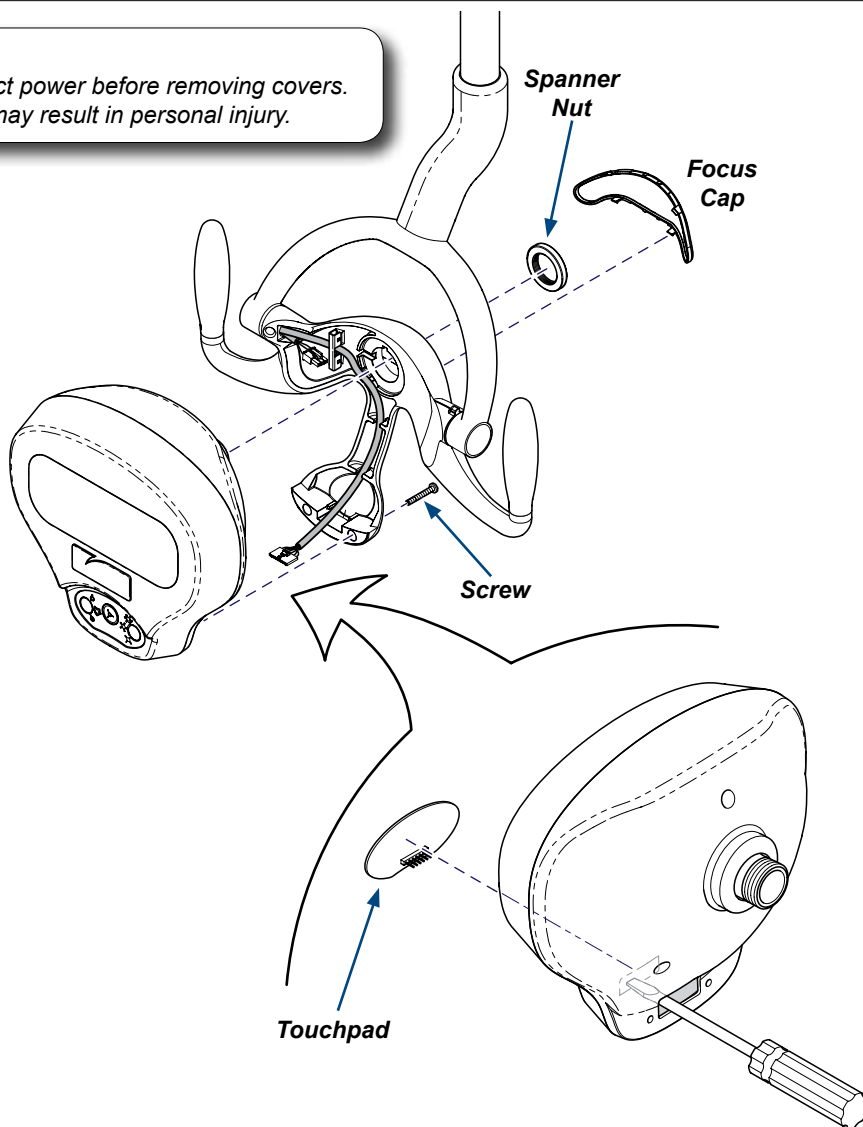

To remove Touchpad...

- Disconnect power.
- Remove focus cap.
- Remove spanner nut and two screws.
- Disconnect both wire harnesses.
- Using a screwdriver, apply pressure to backside of touchpad loosening adhesive.
- Peel touchpad from lighthouse.

DA3598i

Note

If necessary, to keep the touchpad from pushing out, cut approximately 1 1/4" of the heatshrink off the harness.

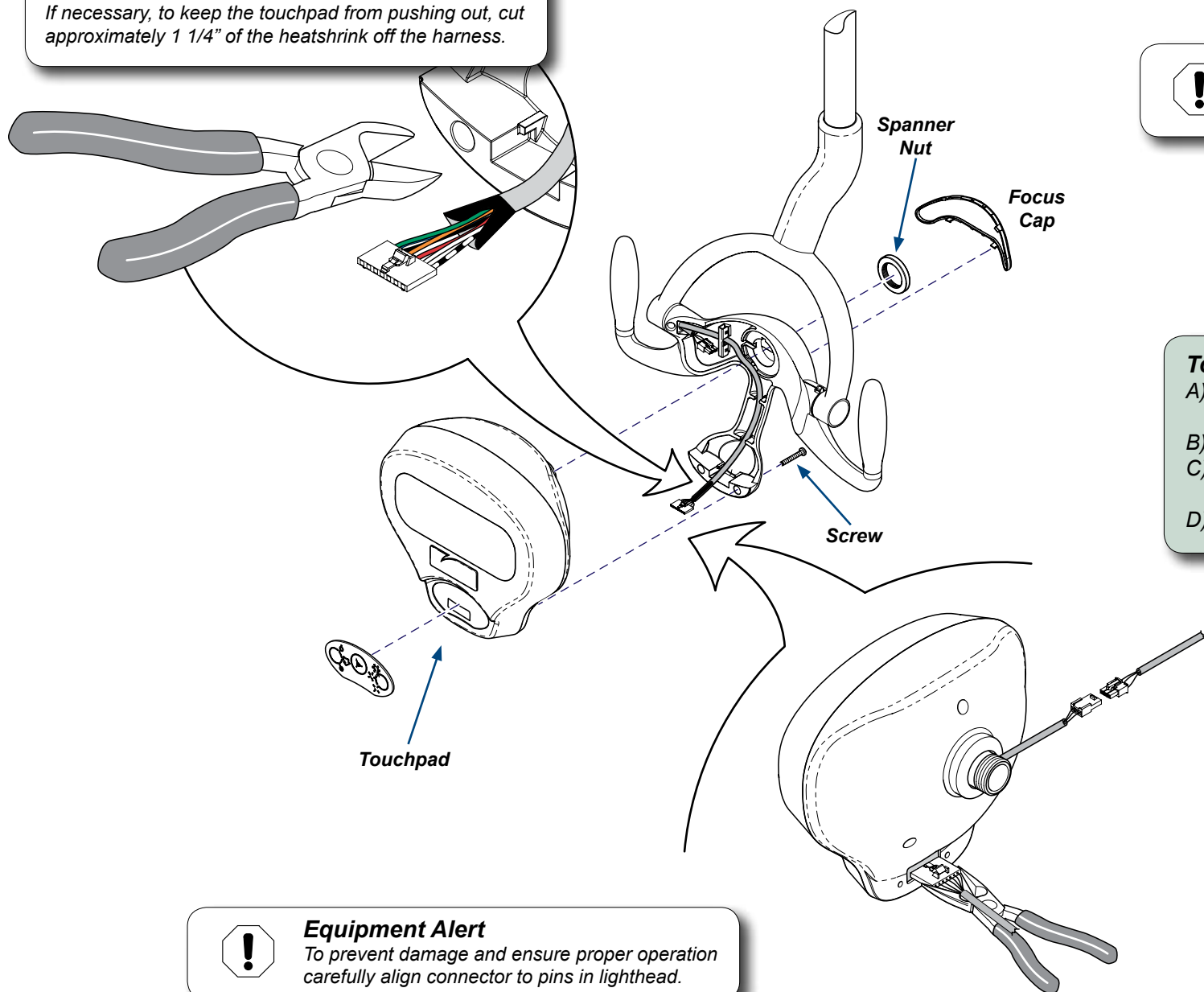

Equipment Alert

To ensure proper operation, connect wiring harnesses as shown.

To install...

- Remove backing from touchpad, then press touchpad into place.
- Connect wire harnesses as shown.
- Secure lighthead to light mount with spanner nut and two screws.
- Install focus cap.



Equipment Alert

To prevent damage and ensure proper operation carefully align connector to pins in lighthead.

DA3599i