



## Light Compatibility Kit [002-1619-00]

### Components:

Harness ..... 2  
PCBoard ..... 1

### Special Tools:

Wire Strippers  
Small Screwdriver

### Note

Applies to specific model lights installed on Ultra chairs.

- **153584, 153771, 153585, 153902, 153911, and 153912** lights on chairs S/N V1314209 - present
- **153914-xxx and 153915-xxx** lights on chairs S/N before V1314209

Steps 1 - 3 only for halogen light models 153584, 153771, 153585, and 153902



### WARNING

Always disconnect light from the power source before removing any covers. Failure to do so may result in personal injury.

### Step 1: Remove PC Board.

- A) Disconnect power source.
- B) Remove end cap screw and end cap, then slide cover back.
- C) Disconnect wire connections and remove PC Board.

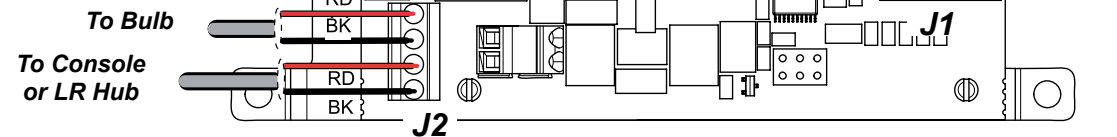
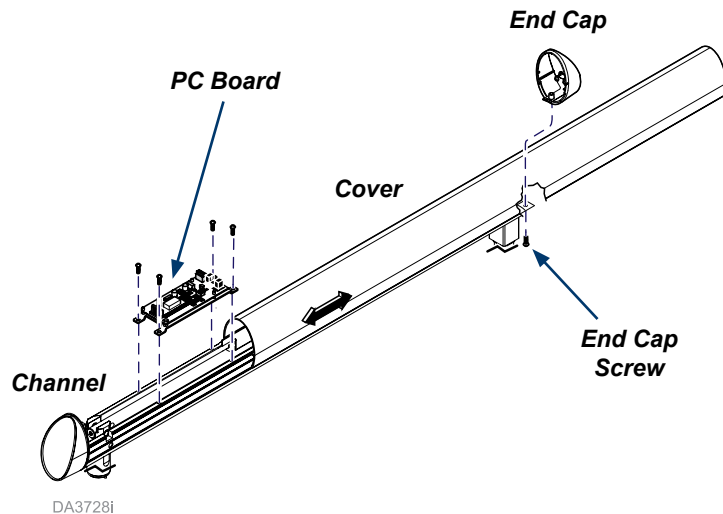

### Step 2: Wire Connections.

- A) Install PC Board.
- B) Connect wiring as shown.

**Note**

This adjustment allows setting the desired height (when light arm is lowered) of light arm at which AUTO ON mode is activated (light automatically turns on). On some units both end caps may need to be removed.



**WARNING**

Use caution when operating equipment with covers removed.

**Step 3: To adjust AUTO ON mode.**

- A) Position light arm at desired height for AUTO ON mode to activate and hold in this position.
- B) Loosen two screws, slide trigger all the way out, then slowly slide trigger in until lighthouse turns on at set point line.
- C) Tighten two screws to secure trigger.

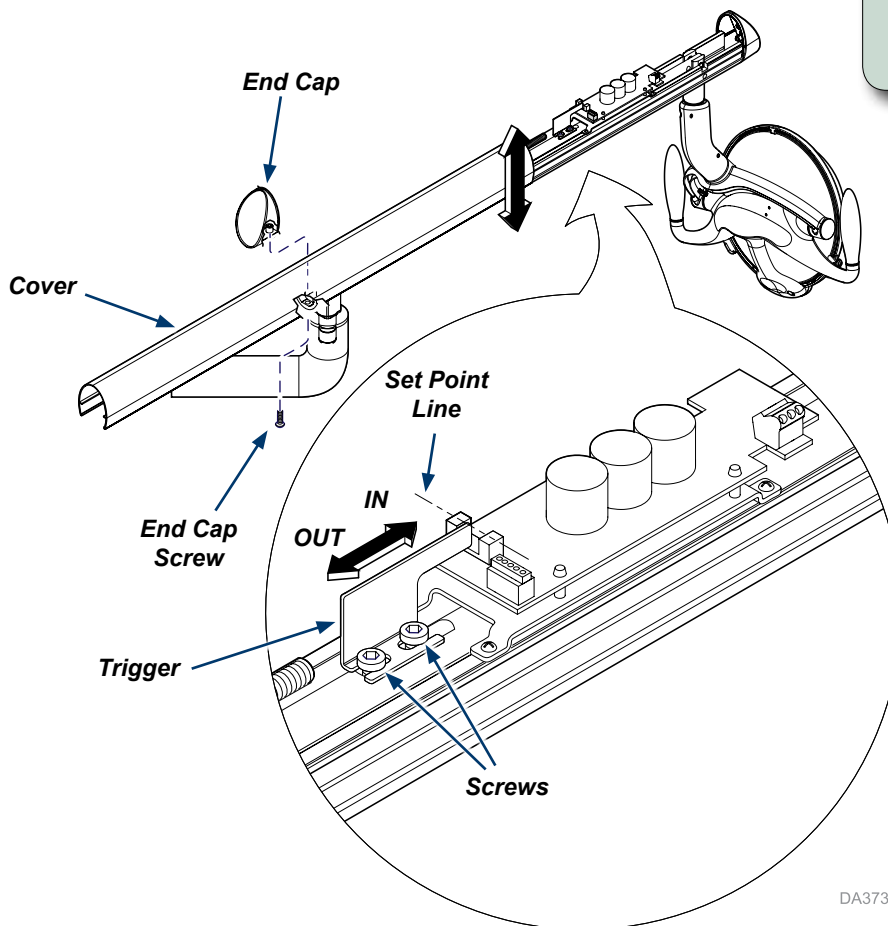

DA3732I

**Note**

Refer to separate LR or Console section in the following pages for remaining steps.



Because we care.

**Step 4: Remove cover.**

A) Remove cover and screws as shown.

**Note:** This step applies to 153584, 153771, 153585, 153902, 153911, and 153912 lights on chair S/N V1314209 to present (harness P/N 015-3177-00) and 153914-xxx and 153915-xxx lights on chairs S/N before V1314209 (015-3176-00).

**Step 5: Install harness.**

A) Connect wire harness to end of light.

B) Connect other harness end to chair umbilical.

**Step 6: Install cover.**

A) Install cover and screws to secure.

**Step 7: Finalize Installation.**

A) Connect power source.

B) Verify operation.

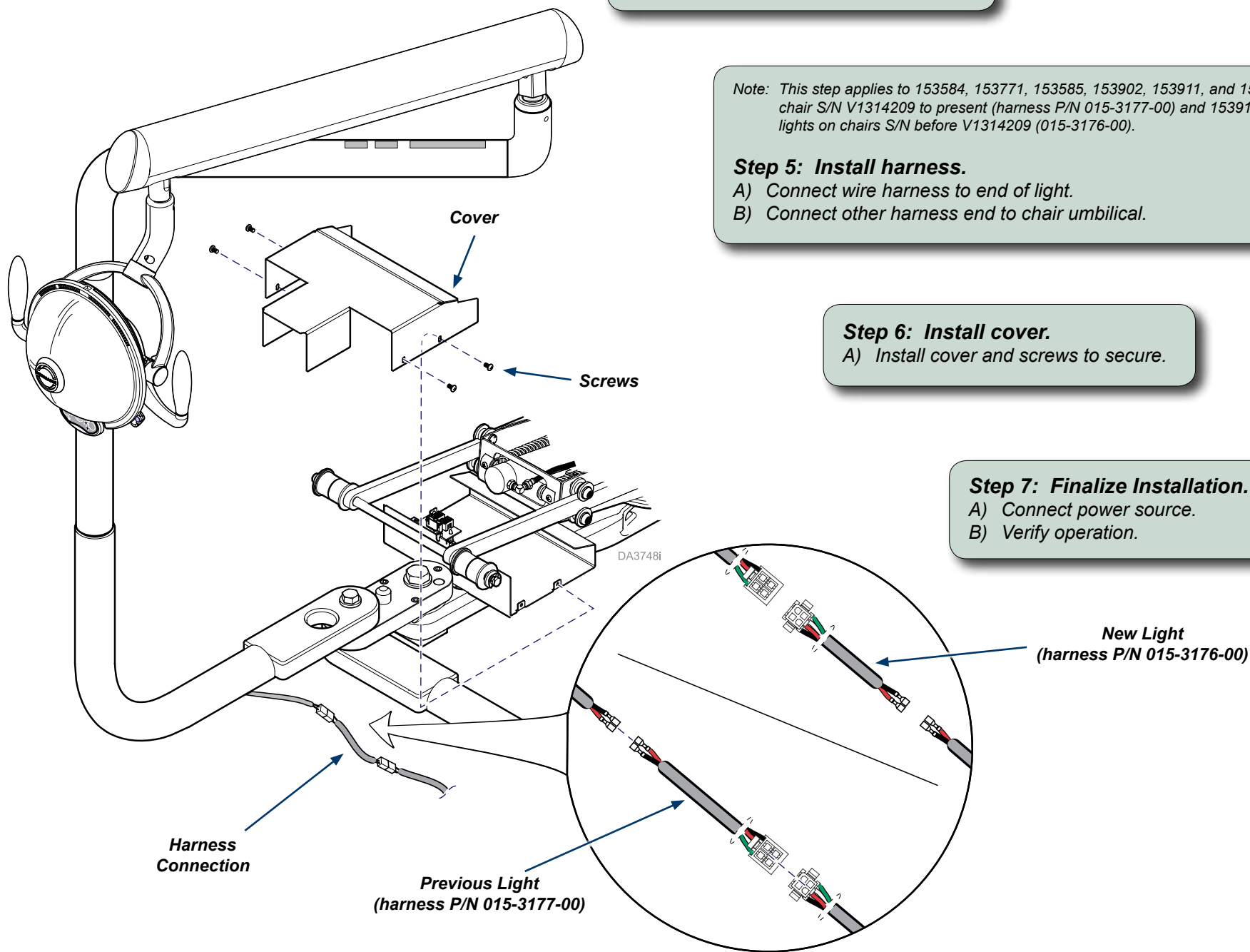

**Step 4: Remove cover.**

A) Remove console side cover.

Note: This step applies to 153584, 153771, 153585, 153902, 153911, and 153912 lights on chair S/N V1314209 to present (harness P/N 015-3177-00) and 153914-xxx and 153915-xxx lights on chairs S/N before V1314209 (015-3176-00).

**Step 5: Install harness.**

A) Connect wire harness to end of light.

B) Connect other harness end to chair umbilical.

**Step 6: Install cover.**

A) Move cover until it snaps into place.

**Step 7: Finalize installation.**

A) Connect power source.

B) Verify operation.

